

F.A.P. RTE.	SECTION	COUNTY	TOTAL SHEETS	SHEET NO.
399	36R-1,37R-2	TAZEWELL	449	93
STA 7+663.000		TO STA 10+097.000		
FED. ROAD DIST. NO. 4		ILLINOIS FED. AID PROJECT		

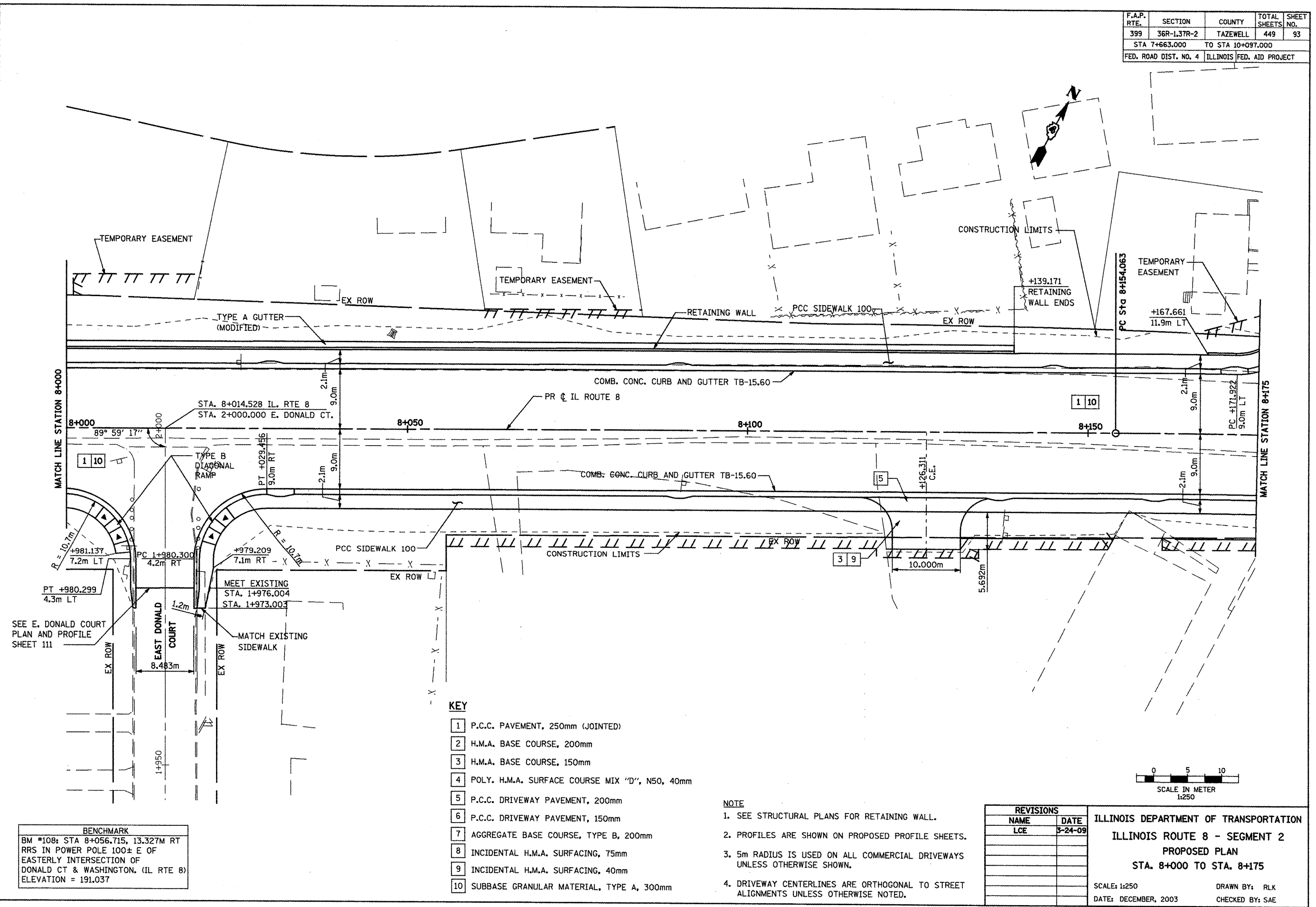

BENCHMARK
 BM #108: STA 8+056.715, 13.327M RT
 RRS IN POWER POLE 100± E OF
 EASTERLY INTERSECTION OF
 DONALD CT & WASHINGTON. (IL RTE 8)
 ELEVATION = 191.037

- KEY**
- 1 P.C.C. PAVEMENT, 250mm (JOINTED)
 - 2 H.M.A. BASE COURSE, 200mm
 - 3 H.M.A. BASE COURSE, 150mm
 - 4 POLY. H.M.A. SURFACE COURSE MIX "D", N50, 40mm
 - 5 P.C.C. DRIVEWAY PAVEMENT, 200mm
 - 6 P.C.C. DRIVEWAY PAVEMENT, 150mm
 - 7 AGGREGATE BASE COURSE, TYPE B, 200mm
 - 8 INCIDENTAL H.M.A. SURFACING, 75mm
 - 9 INCIDENTAL H.M.A. SURFACING, 40mm
 - 10 SUBBASE GRANULAR MATERIAL, TYPE A, 300mm

- NOTE**
1. SEE STRUCTURAL PLANS FOR RETAINING WALL.
 2. PROFILES ARE SHOWN ON PROPOSED PROFILE SHEETS.
 3. 5m RADIUS IS USED ON ALL COMMERCIAL DRIVEWAYS UNLESS OTHERWISE SHOWN.
 4. DRIVEWAY CENTERLINES ARE ORTHOGONAL TO STREET ALIGNMENTS UNLESS OTHERWISE NOTED.

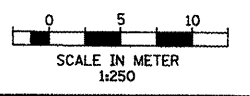

REVISIONS	
NAME	DATE
LCE	3-24-09

ILLINOIS DEPARTMENT OF TRANSPORTATION
ILLINOIS ROUTE 8 - SEGMENT 2
PROPOSED PLAN
STA. 8+000 TO STA. 8+175

SCALE: 1:250
 DATE: DECEMBER, 2003

DRAWN BY: RLK
 CHECKED BY: SAE