

F.A.P. RTE.	SECTION	COUNTY	TOTAL SHEETS	SHEET NO.
399	36R-1,37R-2	TAZEWELL	449	96
STA 7+663.000 TO STA 10+097.000				
FED. ROAD DIST. NO. 4			ILLINOIS FED. AID PROJECT	

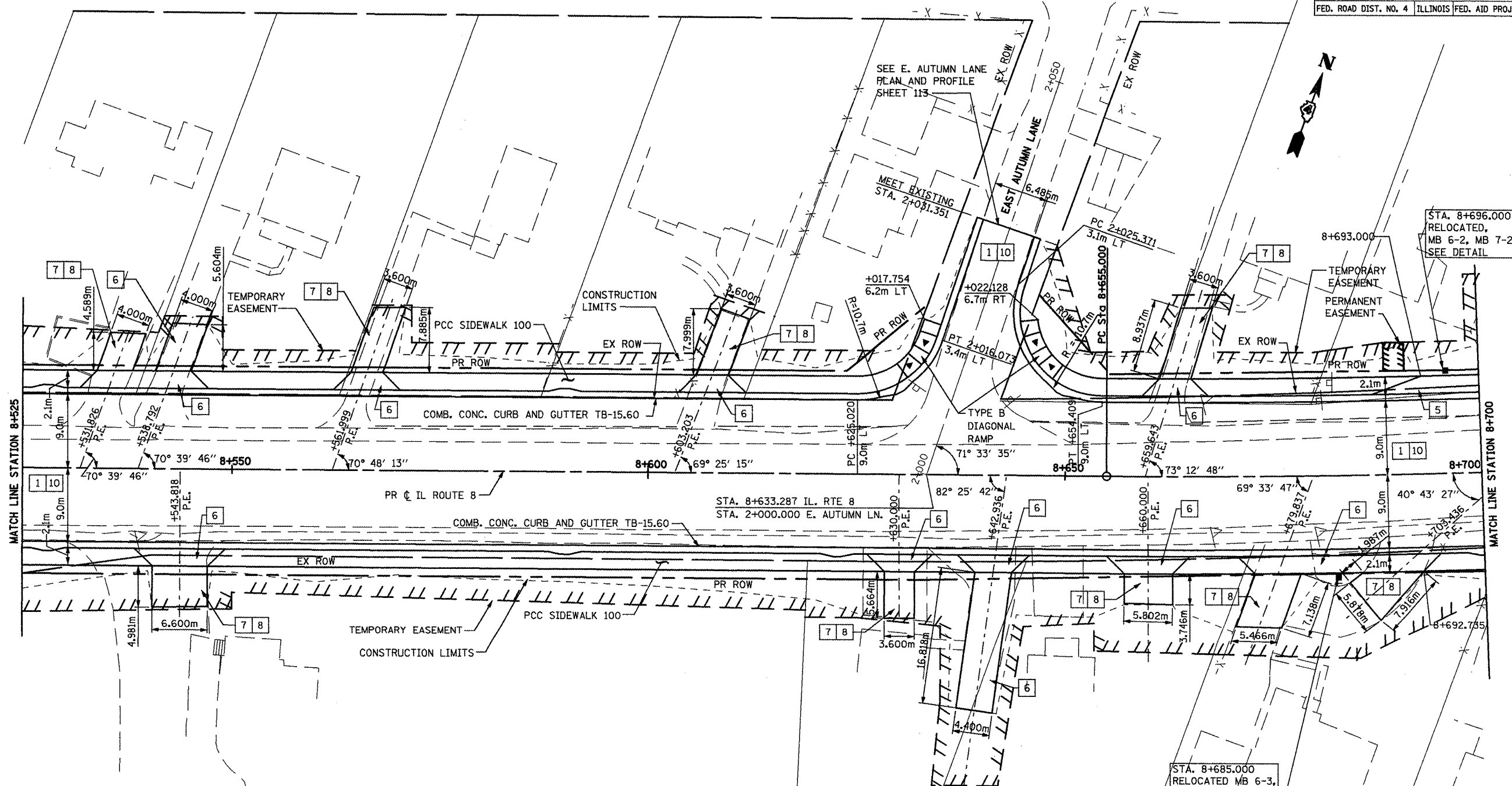

- KEY**
- 1 P.C.C. PAVEMENT, 250mm (JOINTED)
  - 2 H.M.A. BASE COURSE, 200mm
  - 3 H.M.A. BASE COURSE, 150mm
  - 4 POLY. H.M.A. SURFACE COURSE MIX "D", N50, 40mm
  - 5 P.C.C. DRIVEWAY PAVEMENT, 200mm
  - 6 P.C.C. DRIVEWAY PAVEMENT, 150mm
  - 7 AGGREGATE BASE COURSE, TYPE B, 200mm
  - 8 INCIDENTAL H.M.A. SURFACING, 75mm
  - 9 INCIDENTAL H.M.A. SURFACING, 40mm
  - 10 SUBBASE GRANULAR MATERIAL, TYPE A, 300mm

- NOTE**
1. PROFILES ARE SHOWN ON PROPOSED PROFILE SHEETS.
  2. 5m RADIUS IS USED ON ALL COMMERCIAL DRIVEWAYS UNLESS OTHERWISE SHOWN.
  3. DRIVEWAY CENTERLINES ARE ORTHOGONAL TO STREET ALIGNMENTS UNLESS OTHERWISE NOTED.

REVISIONS	
NAME	DATE
LCE	4/29/09
LCE	8/20/09
LCE	9/25/09

ILLINOIS DEPARTMENT OF TRANSPORTATION  
**ILLINOIS ROUTE 8 - SEGMENT 2**  
**PROPOSED PLAN**  
**STA. 8+525 TO STA. 8+700**

SCALE: 1:250  
DATE: DECEMBER, 2003

DRAWN BY: RLK  
CHECKED BY: SAE

