

Bench Mark: BM #108; Sta. 8+056.715, 13.327 m RT RRS in power pole
 100' E of easterly intersection of Donald Ct. & Washington.
 Elevation = 191.037
 Note: All dimensions are in millimeters unless otherwise noted.

F.A.P. RTE.	SECTION	COUNTY	TOTAL SHEETS	SHEET NO.
399	36R-1,37R-2	TAZEWELL	449	198
STA 7+663,000		TO STA 10+011,000		
FED. ROAD DIST. NO. 4		ILLINOIS FED. AID PROJECT		

Contract No. 88859
 SHT. S-01 of S-35

DESIGN SPECIFICATIONS
 2002 AASHTO Specifications, 17th Edition

DESIGN STRESSES

Field Units
 $f'_c = 24 \text{ MPa}$
 $f_y = 420 \text{ MPa (Reinf.)}$
 $f_y = 250 \text{ MPa (M-270M Grade 250) (Soldier Piles)}$

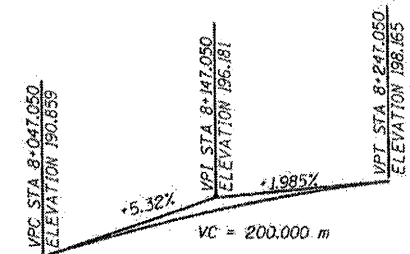

PROFILE GRADE

See Sheets S04 to S11 for
 Pile Tip Elevations, & Pile Sizes.



APPROVED
 For Structural Adequacy Only

Ralph E. Anderson (TSD)
 Engineer of Bridges & Structures

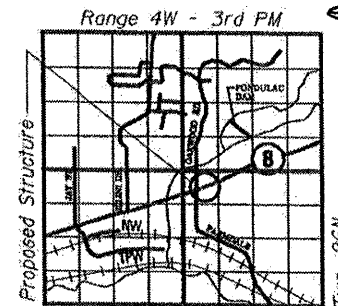

LOCATION SKETCH

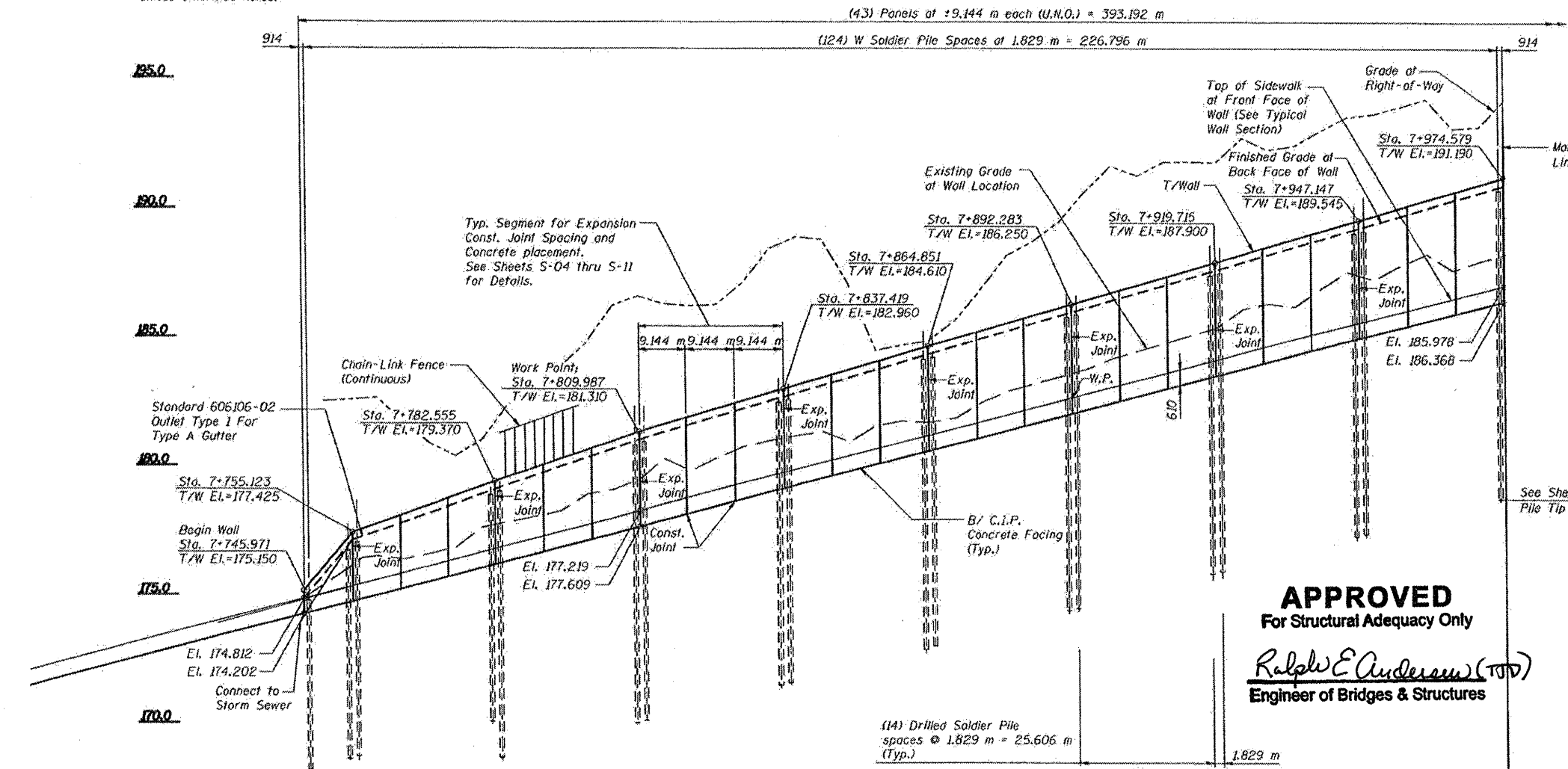

ELEVATION

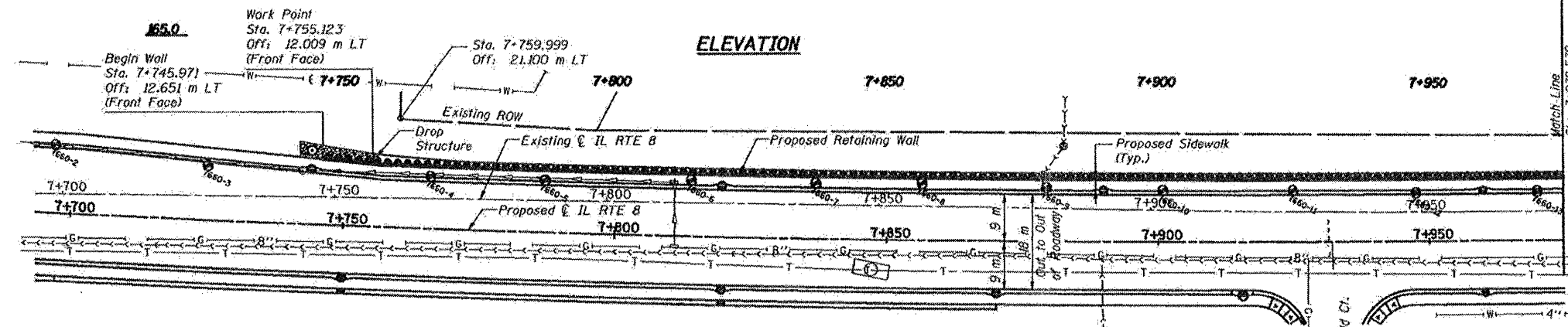

PLAN

HORIZONTAL CURVE DATA

Prop. Curve CURVE_4
 PI Sta. = 7+692.397 L = 535.962m
 $\Delta = 8^\circ 20' 40''$ (LT) E = 9.797m
 T = 268.957m PC Sta. 7+423.441
 R = 3,687.000m PT Sta. 7+960.403

LEGEND

- Soil Boring ϕ_{100-2}
- Sanitary Sewer $\text{---} \text{---} \text{---}$
- Gas Line $\text{---} \text{---} \text{---}$
- Telephone $\text{---} \text{---} \text{---}$
- Water Line $\text{---} \text{---} \text{---}$

REVISIONS	
NAME	DATE
LCE	2-26-10



ILLINOIS DEPARTMENT OF TRANSPORTATION
 IL. RT. 8 - SEG. 2 FAP 399
 SECTION 36R-1, 37R-2 TAZEWELL COUNTY
 DRILLED SOLDIER PILE WALL
 STA 7+750 TO STA 8+150
 S.N. 090-8516
 GENERAL PLAN - 1
 DESIGNED BY: J.NEU DRAWN BY: A.HENGELS
 DATE: 2-05 CHECKED BY: A.HALL CHECKED BY: J.NEU

4/29/2010
 EXPIRES 11/30/2010