

PROP. CURVE SMTCV1
 PI STA. = 11+72.39
 $\Delta = 0^\circ 13' 55''$ (RT)
 $D = 0^\circ 06' 53''$
 $R = 50,000.00'$
 $T = 101.19'$
 $L = 202.39'$
 $E = 0.10'$
 $e = \text{N.C.}$
 P.C. STA. = 10+71.19
 P.T. STA. = 12+73.58

PROP. CURVE IL8CURV9
 PI STA. = 202+21.64
 $\Delta = 3^\circ 02' 07''$ (LT)
 $D = 0^\circ 34' 23''$
 $R = 10,000.00'$
 $T = 264.95'$
 $L = 529.78'$
 $E = 3.51'$
 $e = \text{---}$
 $T.R. = \text{---}$
 $S.E. \text{ RUN} = \text{---}$
 P.C. STA. = 199+56.69
 P.T. STA. = 204+86.47

LEGEND:

- 1 H-M-A BASE COURSE 6"
- 2 POLYMERIZED H-M-A SURFACE COURSE, MIX "E", N50
- 3 INCIDENTAL H-M-A SURFACING, 1.5"
- 4 P.C.C PAVEMENT 10" (JOINTED)
- 5 P.C.C DRIVEWAY PAVEMENT, 8"
- 6 P.C.C SIDEWALK, 4"
- 7 P.C.C SIDEWALK 4" SPECIAL
- 8 P.C.C SIDEWALK 6"
- 9 P.C.C SIDEWALK 6" SPECIAL
- 10 COMB. C.C.&G., TYPE B-6.12
- 11 COMB. C.C.&G., TYPE B-6.24
- 12 CONCRETE CURB TYPE B
- 13 CONC. MEDIAN, TYPE SM-6.12
- 14 PRECAST MODULAR BLOCK WALL

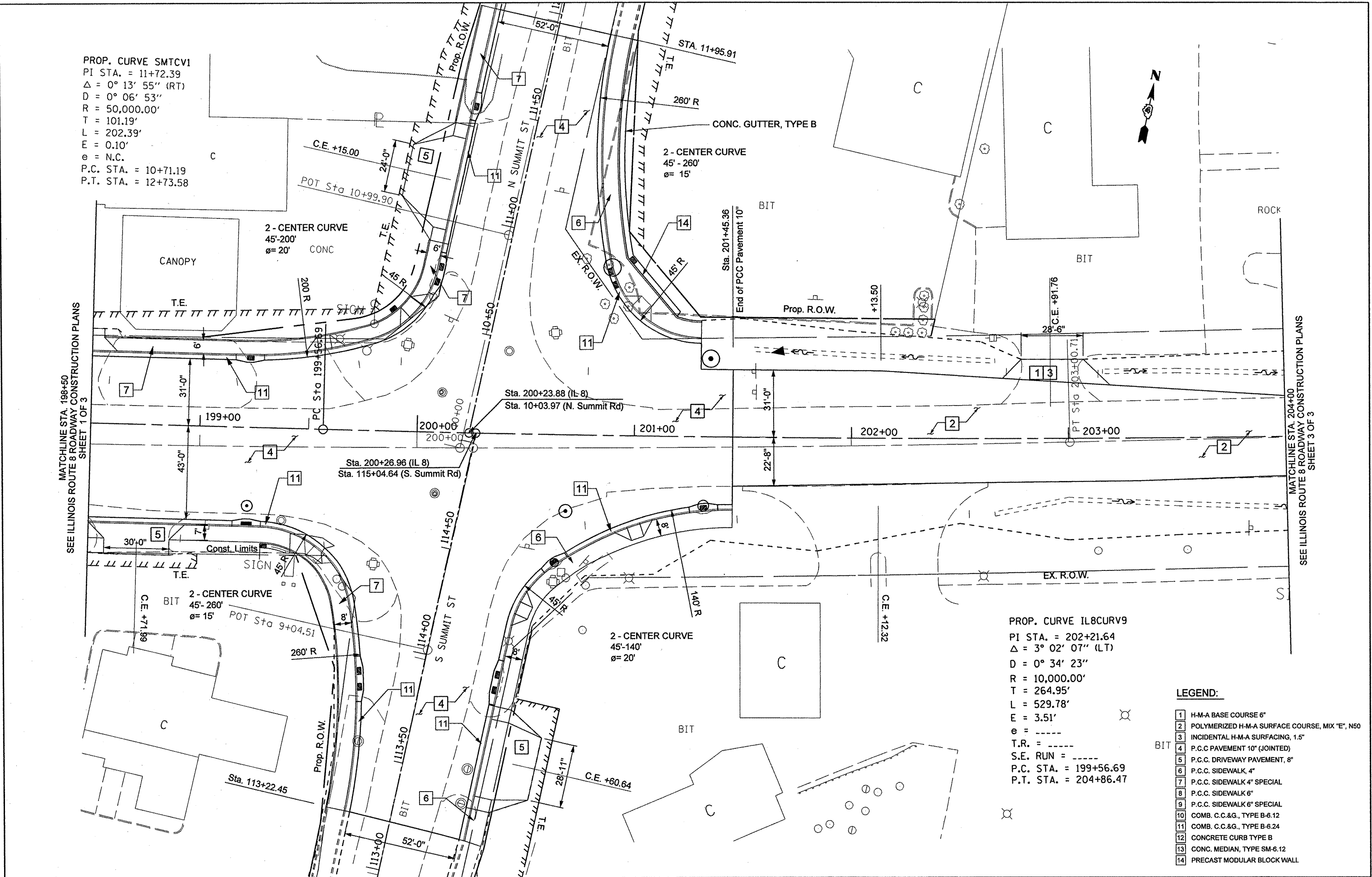

MATCHLINE STA. 198+50
SEE ILLINOIS ROUTE 8 ROADWAY CONSTRUCTION PLANS
SHEET 1 OF 3

MATCHLINE STA. 204+00
SEE ILLINOIS ROUTE 8 ROADWAY CONSTRUCTION PLANS
SHEET 3 OF 3

FILE NAME =	USER NAME = #USER#	DESIGNED -	REVISED -	STATE OF ILLINOIS DEPARTMENT OF TRANSPORTATION	ILLINOIS ROUTE 8 ROADWAY CONSTRUCTION PLAN			F.A.U. RTE.	SECTION	COUNTY	TOTAL SHEETS	SHEET NO.
#FILE#		DRAWN -	REVISED -		SCALE: 1" = 20'	SHEET NO. 2 OF 3 SHEETS	STA. 198+50.00 TO STA. 204+00.00	6775	04-00141-00-FP	TAZEWELL	187	50
	PLOT SCALE = #SCALE#	CHECKED -	REVISED -		CONTRACT NO. 89352							
	PLOT DATE = #DATE#	DATE	REVISED -		FED. ROAD DIST. NO. 4 [ILLINOIS] FED. AID PROJECT							