

LEGEND - DRIVEWAYS

- PORTLAND CEMENT CONCRETE DRIVEWAY PAVEMENT, 6"
- PORTLAND CEMENT CONCRETE DRIVEWAY PAVEMENT, 8"
- INCIDENTAL HOT-MIX ASPHALT SURFACING
- AGGREGATE SURFACE COURSE, TYPE A
- DETECTABLE WARNING
- CLASS D PATCHES, TYPE IV
- P.C.C. SIDEWALK, 4"
- TEMPORARY EASEMENT

LEGEND

- EXISTING STORM STRUCTURE
- STORM STRUCTURE
- STORM SEWER

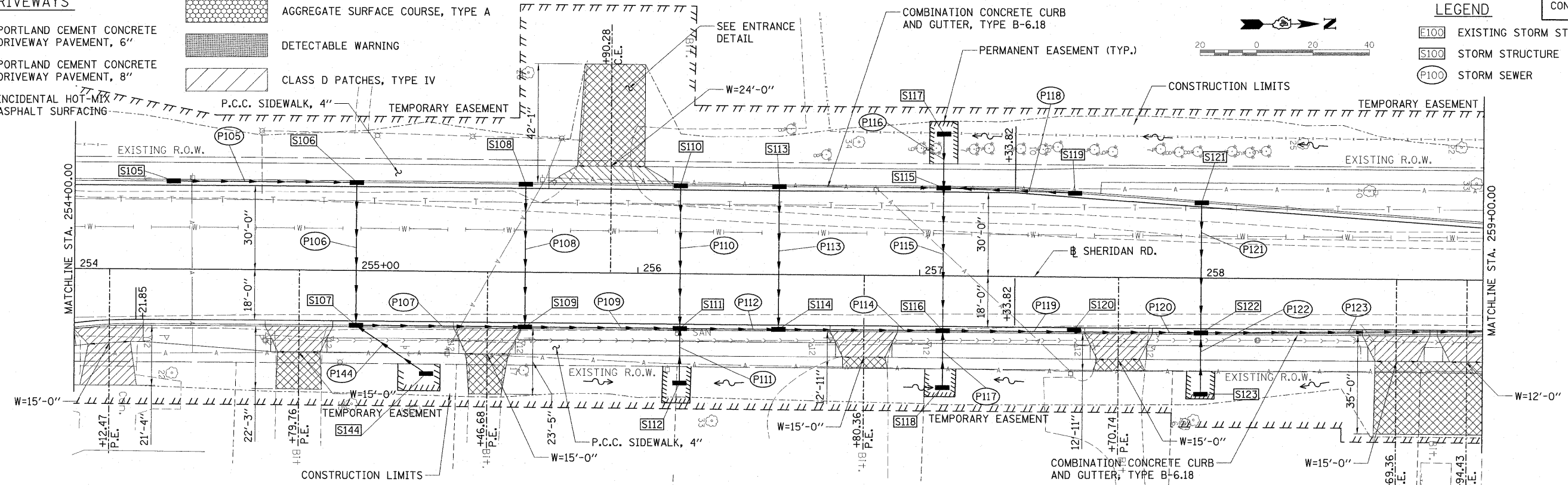
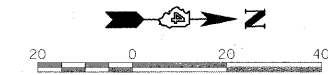

STRUCTURE NUMBER	STATION	OFFSET	TYPE	RIM ELEVATION	INVERT ELEVATIONS			
					N	S	E	W
S105	254+35.00	30.83	INLETS, TYPE G-1	796.33	791.58			
S106	255+00.00	30.83	INLETS, TYPE G-1	795.98	791.23	791.13		
S107	255+00.00	18.83	INLET-MANHOLE, TYPE G-1, 4' DIAMETER	796.22	790.80	790.90	793.73	
S108	255+60.00	30.83	INLETS, TYPE G-1	795.65		790.77		
S109	256+60.00	18.83	INLETS, TYPE G-1	795.89	790.44	790.44	790.54	
S110	256+15.00	30.83	INLETS, TYPE G-1	795.34		790.50		
S111	256+15.00	18.83	INLETS, TYPE G-1	795.58	790.19	790.29	790.19	792.72
S112	256+15.00	38.80	INLETS, TYPE A, TYPE 8 GRATE	794.39				792.89
S113	256+50.00	30.83	INLETS, TYPE G-1	795.17		790.34		
S114	256+50.00	18.83	INLETS, TYPE G-1	795.41	790.03	790.13	790.03	
S115	257+08.33	30.83	INLET, TYPE G-1 DOUBLE	795.06	790.19	790.09	790.19	
S116	257+08.33	18.83	INLET, TYPE G-1 DOUBLE	795.30	789.76	789.86	792.22	789.76
S117	257+08.33	50.72	INLETS, TYPE A, TYPE 8 GRATE	793.00				792.40
S118	257+08.33	39.64	INLETS, TYPE A, TYPE 8 GRATE	793.90		790.42		
S119	257+55.00	29.38	INLETS, TYPE G-1	795.16		790.41		
S120	257+55.00	18.83	INLETS, TYPE G-1	795.38	789.55	789.55		
S121	258+00.00	26.29	INLETS, TYPE G-1	795.41		790.56		
S122	258+00.00	18.83	INLETS, TYPE G-1	795.59	789.35	789.45	792.06	789.35
S123	258+00.00	41.27	INLETS, TYPE A, TYPE 8 GRATE	793.75				792.25
S144	255+25.00	36.36	INLETS, TYPE A, TYPE 8 GRATE	795.50	794.00			

PIPE NUMBER	FROM STRUCTURE	U/S INVERT	TO STRUCTURE	D/S INVERT	CLASS/TYPE	DIAMETER	LENGTH	SLOPE	TRENCH BACKFILL
P106	S106	791.13	S107	790.90	STORM SEWERS, (WATER MAIN REQUIREMENTS) TYPE 2	12	47.0	0.49%	32.7
P107	S107	790.80	S109	790.44	STORM SEWERS, CLASS A, TYPE 2	12	57.0	0.63%	43.3
P108	S108	790.77	S109	790.54	STORM SEWERS, (WATER MAIN REQUIREMENTS) TYPE 2	12	47.0	0.49%	34.2
P109	S109	790.44	S111	790.19	STORM SEWERS, CLASS A, TYPE 2	12	52.0	0.48%	39.5
P110	S110	790.50	S111	790.29	STORM SEWERS, (WATER MAIN REQUIREMENTS) TYPE 2	12	47.0	0.45%	32.7
P111	S112	792.89	S111	792.72	STORM SEWERS, CLASS A, TYPE 1	12	17.0	1.00%	3.3
P112	S111	790.19	S114	790.03	STORM SEWERS, CLASS A, TYPE 2	12	32.0	0.50%	24.3
P113	S113	790.34	S114	790.13	STORM SEWERS, (WATER MAIN REQUIREMENTS) TYPE 2	12	47.0	0.45%	32.7
P114	S114	790.03	S116	789.76	STORM SEWERS, CLASS A, TYPE 2	15	54.0	0.50%	36.2
P115	S115	790.09	S116	789.86	STORM SEWERS, (WATER MAIN REQUIREMENTS) TYPE 2	12	47.0	0.49%	34.2
P116	S117	790.42	S115	790.19	STORM SEWERS, CLASS A, TYPE 2	12	17.0	1.35%	5.4
P117	S118	792.40	S116	792.22	STORM SEWERS, CLASS A, TYPE 2	12	18.0	1.00%	2.7
P118	S119	790.41	S115	790.19	STORM SEWERS, CLASS A, TYPE 2	12	42.0	0.52%	27.9
P119	S116	789.76	S120	789.55	STORM SEWERS, CLASS A, TYPE 2	15	42.0	0.50%	34.1
P120	S120	789.55	S122	789.35	STORM SEWERS, CLASS A, TYPE 2	15	42.0	0.48%	37.0
P121	S121	790.56	S122	789.45	STORM SEWERS, (WATER MAIN REQUIREMENTS) TYPE 2	12	42.5	2.61%	33.7
P122	S123	792.25	S122	792.06	STORM SEWERS, CLASS A, TYPE 2	12	19.5	0.97%	3.8
P123	S122	789.35	S125	787.52	STORM SEWERS, CLASS A, TYPE 2	15	232.0	0.79%	220.4
P144	S144	794.00	S107	793.73	STORM SEWERS, CLASS A, TYPE 1	12	27.0	1.00%	0.0

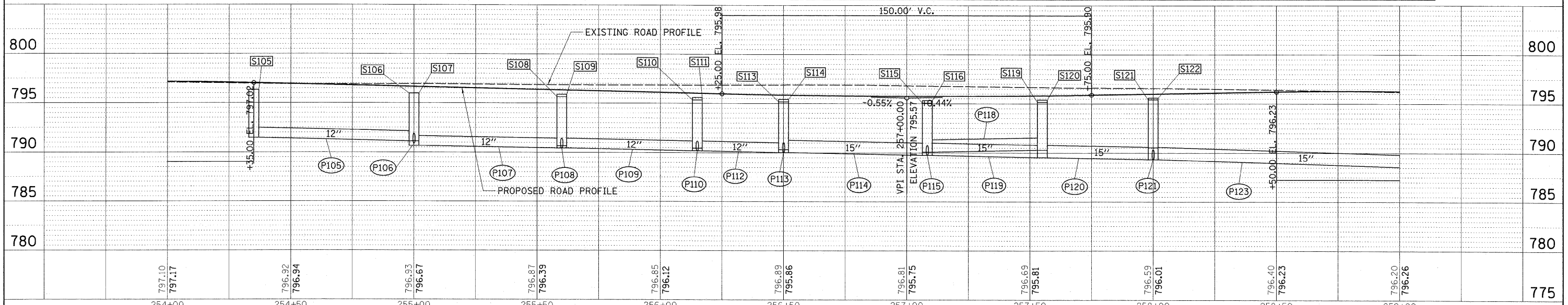

PLAN
 SURVEYED BY: _____ DATE: _____
 NOTE BOOK NO. _____
 ALIGNMENT CHECKED BY: _____
 RT. OF WAY CHECKED BY: _____
 CAD FILE NAME: _____

© Copyright Hanson Professional Services Inc. 2010
HANSON
 Hanson Professional Services Inc.

PROFILE
 SURVEYED BY: _____ DATE: _____
 GRADES CHECKED BY: _____
 B.M. NOTED BY: _____
 STRUCTURE NOTATIONS C/P/D: _____