

SECTION 07-05107-00-BR  
BEGINS  
STATION 58+40.00

PROPOSED STRUCTURE SN 075-3315  
STATION 60+40.13  
SEE SH.#7 THRU 13 FOR DETAILS  
SEE SH.#7 FOR HYDRAULICS

SECTION 07-05107-00-BR  
ENDS  
STATION 62+50.00

PROPOSED LIMITS OF  
CONSTRUCTION (TYP.)

PROPOSED R.O.W.  
LINE (TYP.)

EXISTING STRUCTURE SN 075-3084  
TO BE REMOVED

CURVE DATA  
PI STA. = 62+00.00  
 $\Delta = 1^\circ 33' 49''$  (LT)  
D =  $1^\circ 31' 40''$   
R = 3,750.00'  
T = 51.17'  
L = 102.34'  
E = 0.35'  
P.C. STA. = 61+48.83  
P.T. STA. = 62+51.17  
S.E. RUN = N/A

- LEGEND**
- TRANSITION TO OR FROM EXISTING TO PROPOSED TYPICAL PAVEMENT
  - PROPOSED RIPRAP PLACEMENT
  - SPECIAL DITCH WITH FLOW DIRECTION

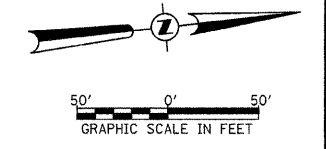

T 5 S, R 5 W, 4th PM  
SECTION 4

|      |                    |      |
|------|--------------------|------|
| PLAN | SURVEYED           | DATE |
|      | PLOTTED            |      |
|      | CHECKED            |      |
|      | BY                 |      |
|      | NO. OF MAG CHECKED |      |
|      | DATE               |      |
|      | FILE NAME          |      |
|      | NO.                |      |

|         |                    |      |
|---------|--------------------|------|
| PROFILE | SURVEYED           | DATE |
|         | PLOTTED            |      |
|         | CHECKED            |      |
|         | BY                 |      |
|         | NO. OF MAG CHECKED |      |
|         | DATE               |      |
|         | FILE NAME          |      |
|         | NO.                |      |

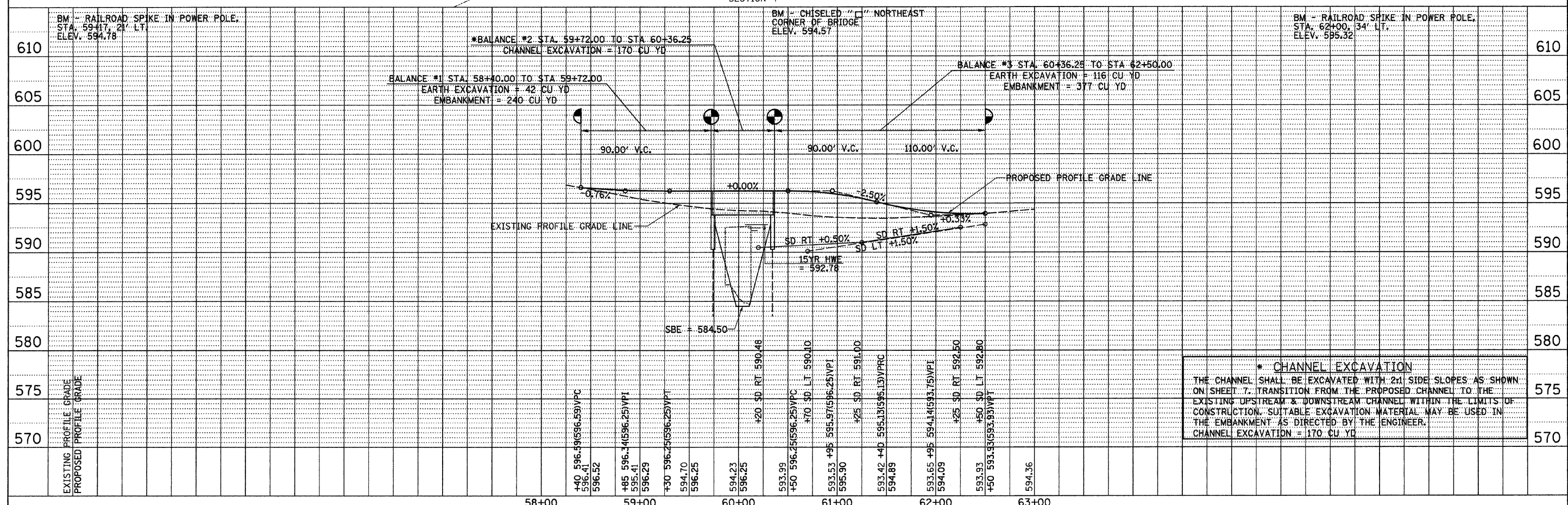

**\* CHANNEL EXCAVATION**  
THE CHANNEL SHALL BE EXCAVATED WITH 2:1 SIDE SLOPES AS SHOWN ON SHEET 7. TRANSITION FROM THE PROPOSED CHANNEL TO THE EXISTING UPSTREAM & DOWNSTREAM CHANNEL WITHIN THE LIMITS OF CONSTRUCTION. SUITABLE EXCAVATION MATERIAL MAY BE USED IN THE EMBANKMENT AS DIRECTED BY THE ENGINEER.  
CHANNEL EXCAVATION = 170 CU YD

|                                                 |                     |            |           |                                                                         |                         |                                                                                       |                |        |              |           |  |
|-------------------------------------------------|---------------------|------------|-----------|-------------------------------------------------------------------------|-------------------------|---------------------------------------------------------------------------------------|----------------|--------|--------------|-----------|--|
| FILE NAME =<br>V:\Bridge\2569-Pike\2569p001.dgn | USER NAME = cthomas | DESIGNED - | REVISED - | <b>PIKE COUNTY<br/>TOWNSHIP ROAD 148 OVER<br/>KISER CREEK TRIBUTARY</b> | <b>PLAN AND PROFILE</b> | RTE.                                                                                  | SECTION        | COUNTY | TOTAL SHEETS | SHEET NO. |  |
|                                                 |                     | DRAWN -    | REVISED - |                                                                         |                         | TR 148                                                                                | 07-05107-00-BR | PIKE   | 18           | 6         |  |
|                                                 |                     | CHECKED -  | REVISED - |                                                                         |                         | SCALE: 1" = 50'-0" SHEET NO. 1 OF 1 SHEETS STA. 58+40.00 TO STA. 62+50.00             |                |        |              |           |  |
|                                                 |                     | DATE -     | REVISED - |                                                                         |                         | CONTRACT NO. 93532<br>FED. ROAD DIST. NO. 7 [ILLINOIS] FED. AID PROJECT BR05-019X0409 |                |        |              |           |  |