

RAIL POST SPACING

- ① Dowel Rods to be grouted after beams are in place and allowed to cure (Min. 24 hr.) prior to grouting the shear keys.
- ② The area between the top of substructure caps and the bottom of the beams shall be filled with non-shrink grout to prevent the beams from rocking.
The cost of all grouting items shall be included with Precast Prestressed Concrete Deck Beams (27" Depth).

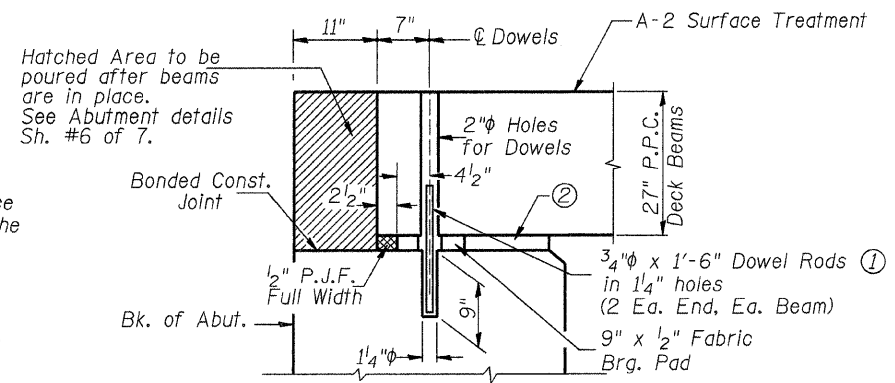

SECTION THRU ABUTMENT
(At Right Angles)

**SUPERSTRUCTURE DETAILS
AND RAIL POST SPACING
PIKE COUNTY
SECTION 07-05107-00-BR
T.R. 148 OVER KISER CREEK TRIBUTARY**

SHEET NO. 5 7 SHEETS	ROUTE NO.	SECTION	COUNTY	TOTAL SHEETS	SHEET NO.
	TR 148	07-05107-00-BR	PIKE	18	11
	S.N. 075-3315		CONTRACT NO. 93532		
FED. ROAD DIST. NO. 7		ILLINOIS	FED. AID PROJECT BROS-0149(040)		