

COUNTY	ROUTE	SECTION	TOTAL SHEETS	SHEET NO.
ADAMS	FAS 1603	10-00205-01-RS	12	11
STATION 315+00 TO STATION 334+36.50				
PROJECT NO. RS-1603(102)				

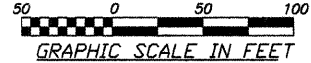

**CURVE DATA**  
 PI STA. 316+50.0  
 $\Delta=11^{\circ}00'00''$   
 $D=4^{\circ}00'00''$   
 $T=138.0'$   
 $R=1432.69'$   
 $L=275.0'$   
 $E=6.63'$   
 PC STA. 315+12.0  
 PT STA. 317+87.0  
 $SE=0.05$  FT./FT.

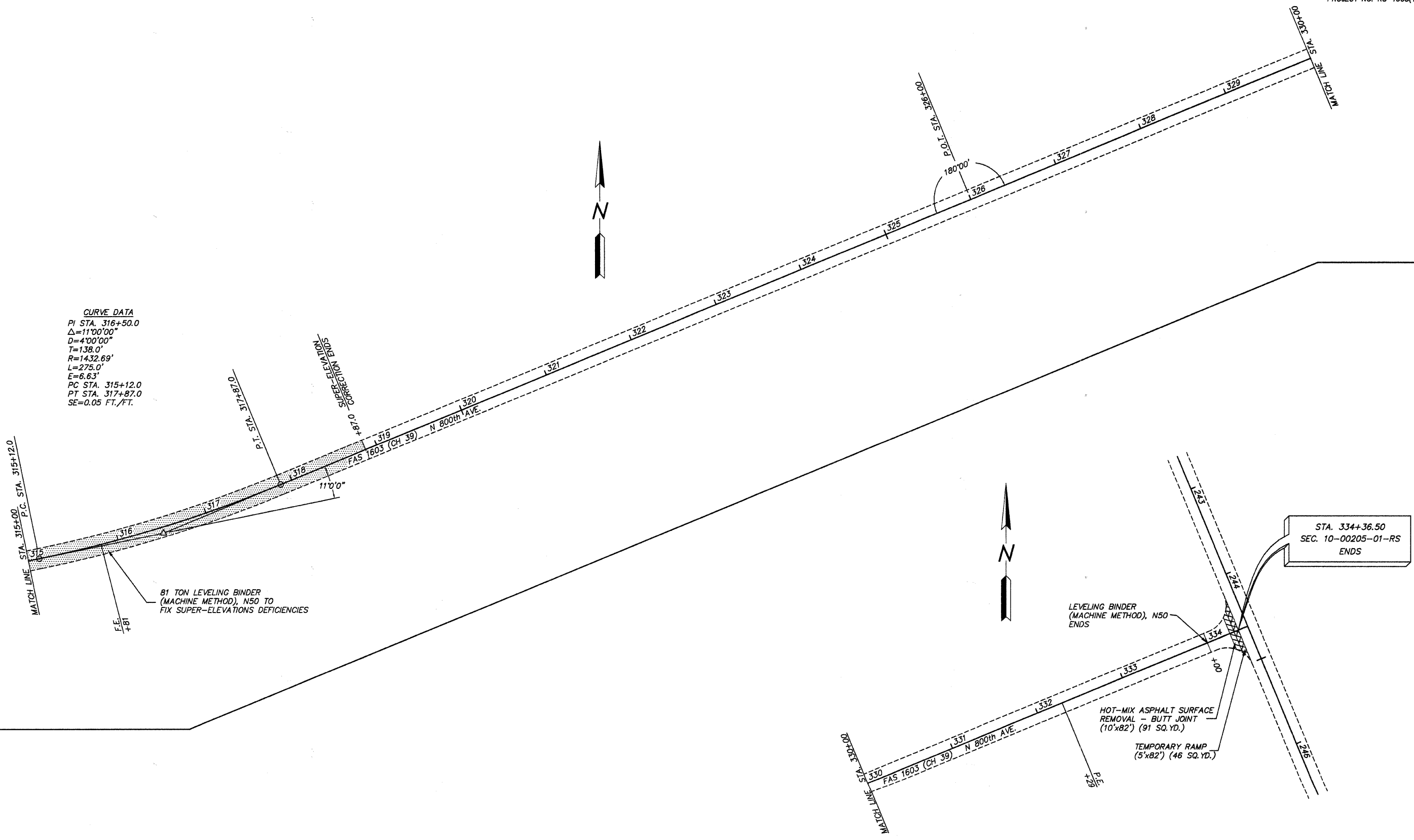

STA. 334+36.50  
 SEC. 10-00205-01-RS  
 ENDS

