

DATE	BY
ORIGINAL SURVEY NO.	SURVEYED
NOTE BOOK NO.	PLOTTED
	TEMPLATE
	AREAS CHECKED

DATE	BY
ORIGINAL SURVEY NO.	SURVEYED
NOTE BOOK NO.	PLOTTED
	TEMPLATE
	AREAS CHECKED

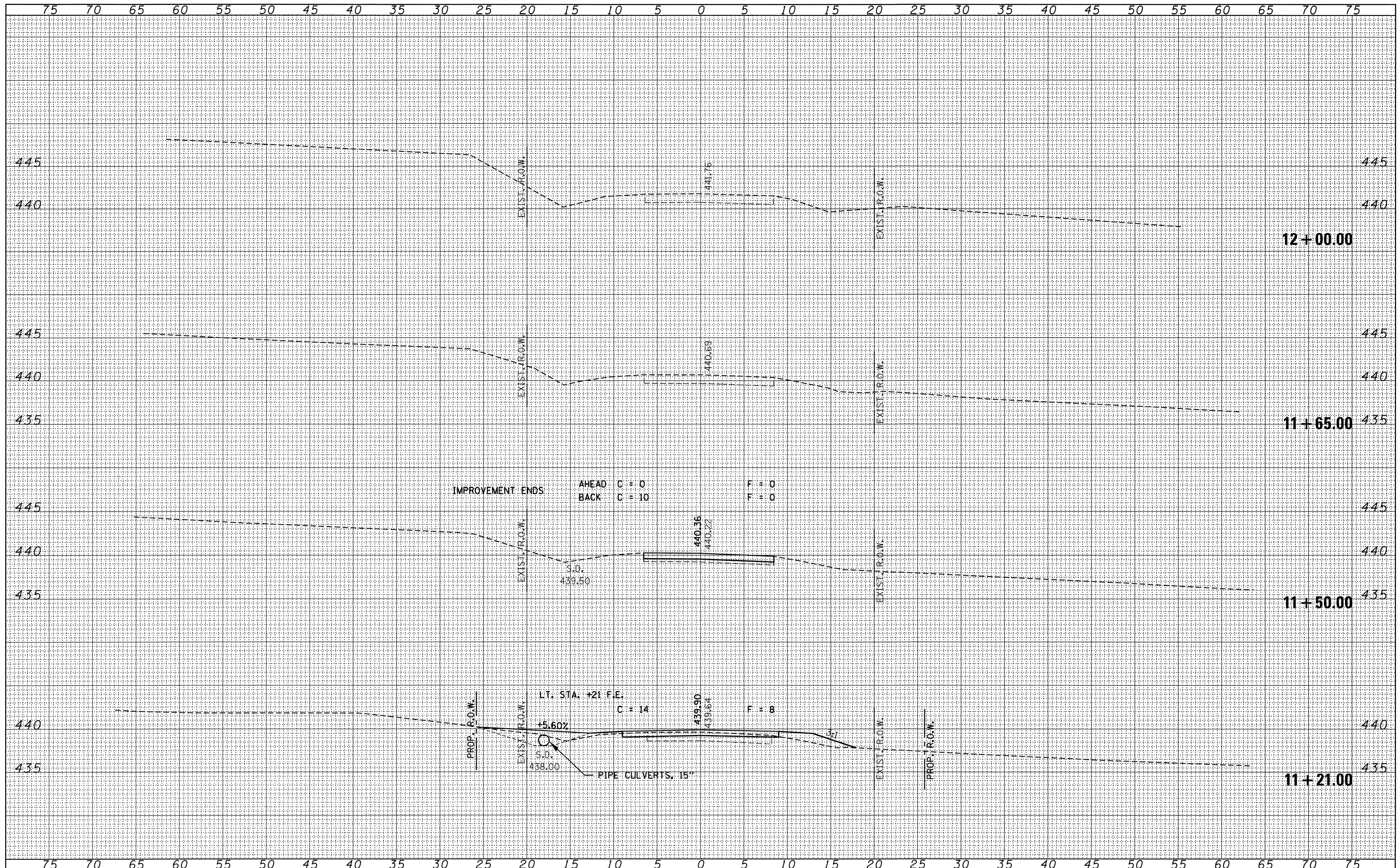

FILE NAME = 090128-sht-xxx.dgn
 USER NAME =
 PLOT SCALE =
 PLOT DATE = 2/18/2010

DESIGNED - A.S.L.	REVISED -
DRAWN - D.T.M.	REVISED -
CHECKED - S.W.M.	REVISED -
DATE - 08/05/09	REVISED -

STATE OF ILLINOIS
 CLAY COUNTY HIGHWAY DEPARTMENT

HLR HAMPTON, LENZINI & RENWICK, INC.
 CIVIL & STRUCTURAL ENGINEERS
 LAND SURVEYORS

CROSS SECTIONS
 MARIGOLD LN.
 SCALE: 5H:5V SHEET NO. OF SHEETS STA. 11+21.00 TO STA. 12+00.00

T.R.	SECTION	COUNTY	TOTAL SHEETS	SHEET NO.
363	06-11129-00-BR	CLAY	16	8
FED. ROAD DIST. NO. [ILLINOIS] FED. AID PROJECT BROS-025(061)			CONTRACT NO. 95621	