

FINAL SURVEY	DATE
SURVEYED	BY
NOTE BOOK	NO.
TEMPLATE	AREAS CHECKED

ORIGINAL SURVEY	DATE
SURVEYED	BY
NOTE BOOK	NO.
TEMPLATE	AREAS CHECKED

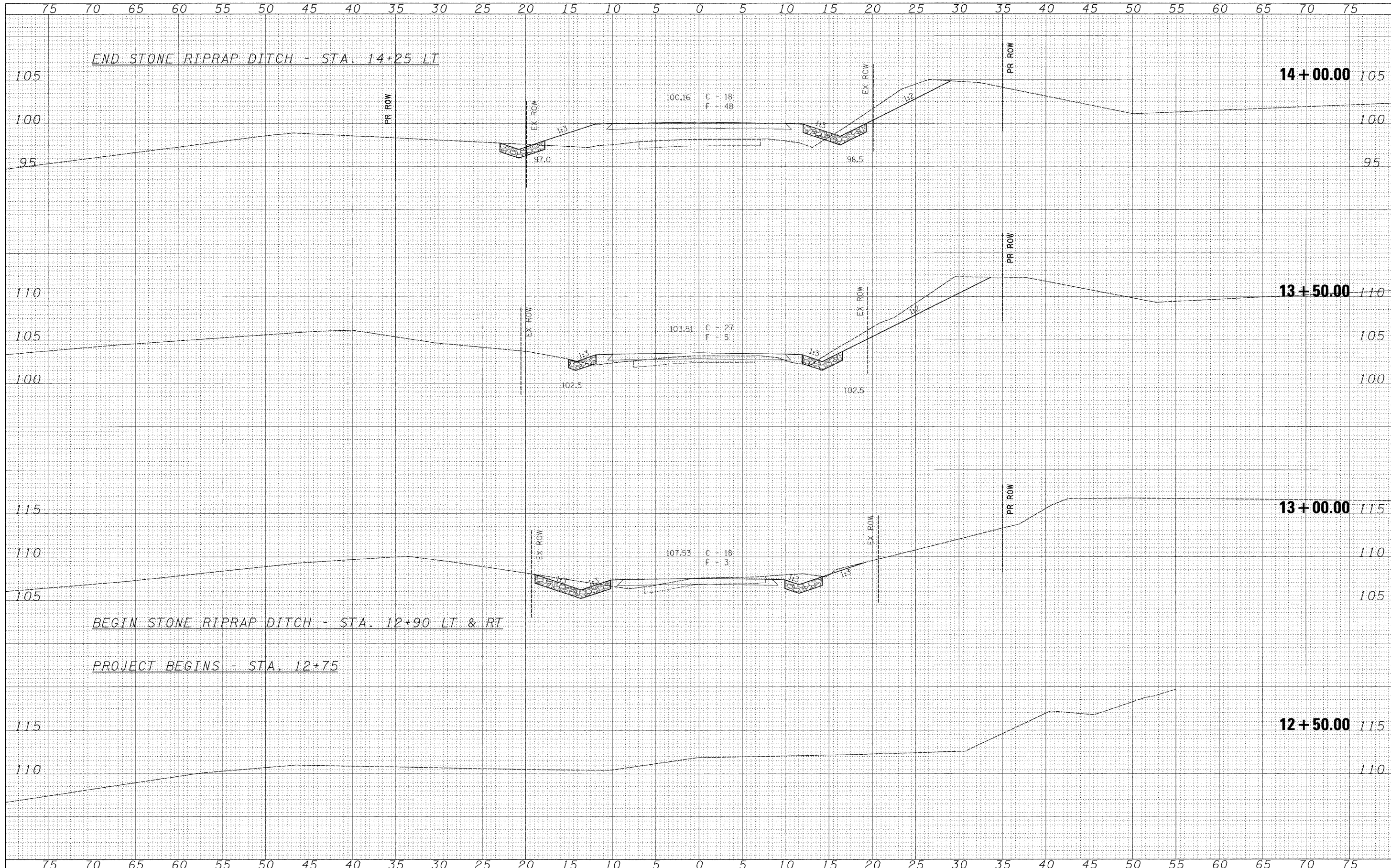

FILE NAME =  
#FILE#

USER NAME = #USER#  
DESIGNED - ---  
DRAWN - ---  
CHECKED - ---  
DATE - ---

REVISOR - ---  
REVISOR - ---  
REVISOR - ---  
REVISOR - ---

REVISOR - ---  
REVISOR - ---  
REVISOR - ---  
REVISOR - ---



**Allen Henderson & Associates, Inc.**  
Civil and Structural Engineers Springfield, IL.  
62703 Phone: (217)544-8033 IL Design Firm  
No. 184-001907

**CROSS SECTIONS**  
SCALE: 1"=5' V & H SHEET NO. 16 OF 19 SHEETS STA. 12+50.00 TO STA. 14+00.00

T.R. RTE.	SECTION	COUNTY	TOTAL SHEETS	SHEET NO.
159	07-18118-00-BR	SHELBY	19	16
FED. ROAD DIST. NO. - [ILLINOIS] FED. AID PROJECT				