

Material: Best quality brass or bronze.
 Border and Lettering: Raised $\frac{1}{8}$ inch. Square cut and not tapered. Top surface polished.
 Fastenings: Four lugs at least three inches long, cast on back of plate.

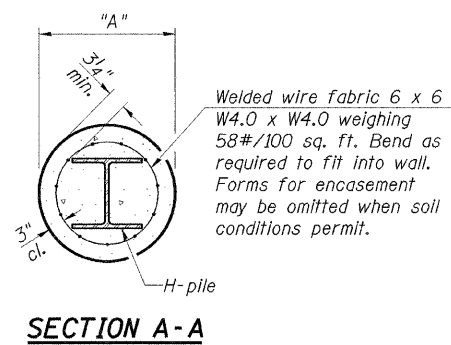
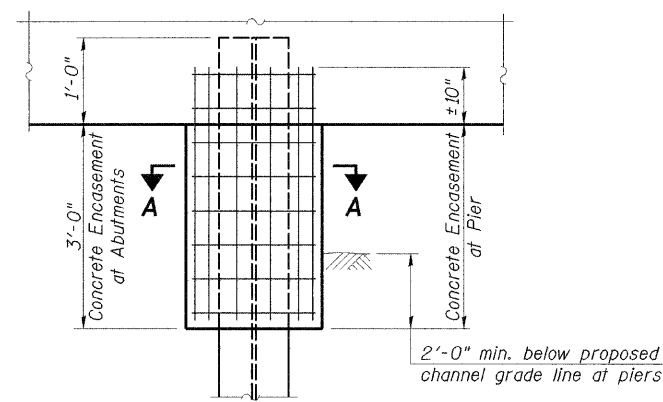

Pile	"A"
HP8	1'-6"
HP10	1'-9"
HP12	2'-0"

PILE ENCASEMENT QUANTITIES
 (Steel Piles)

Pile Size	Item	Unit	Quantity
HP10	Concrete Encasement	Cu Yd.	0.086
HP12	Concrete Encasement	Cu Yd.	0.112

Quantities per foot of Encasement.

AECOM 2524 S. Broadway Salem, Illinois 62881 618.548.3500 IL Design Firm Reg. No. 184-000176 No. 184-003706 www.aecom.com	SLM-CN-CX
	NAME PLATE & PILE ENCASEMENT DETAILS
Date: 03/18/10 Design: WDL Drawn: JSD Job No.: 60097890	