

ROUTE NO	SECTION	COUNTY	TOTAL SHEETS	SHEET NO.
FAU 9314 C.H. 7	09-00034 -01-RS	MONROE	8	1

FEDERAL AID PROJECT
CONTRACT 97443



LOCATION OF SECTION INDICATED THIS:

STATE OF ILLINOIS
DEPARTMENT OF TRANSPORTATION
DIVISION OF HIGHWAYS
PLANS FOR PROPOSED
FEDERAL AID HIGHWAY
FAU 9314 LAKEVIEW DRIVE (CH 7)
LAKEVIEW DRIVE - MAEYSTOWN ROAD
RESURFACING
SECTION 09-00034-01-RS
PROJECT NO. M-5011(314)
CITY OF WATERLOO
COUNTY OF MONROE
JOB NO. C-98-351-10

DESIGN CLASSIFICATION
ROAD CLASSIFICATION = MINOR ARTERIAL (URBAN)
2009 ADT = 5300
2029 DESIGN ADT = 6500
DESIGN SPEED 50 MPH-3R DESIGN STANDARDS

LIST OF STANDARDS

SAFETY	635001-01 635006-03 635011-02 BLR 26-2
TRAFFIC CONTROL	701201-03 701301-03 701306-02 701311-03 701501-05 701901-01
PAVEMENT MARKING	780001-02

SCALES: PLAN - NOT TO SCALE

INDEX OF SHEETS

SHEET NUMBER	DESCRIPTION
1	COVER
2	GENERAL NOTES & SCHEDULE OF QUANTITIES
3	TYPICAL SECTIONS
4	PLAN
5-8	DETAILS AND SCHEDULES

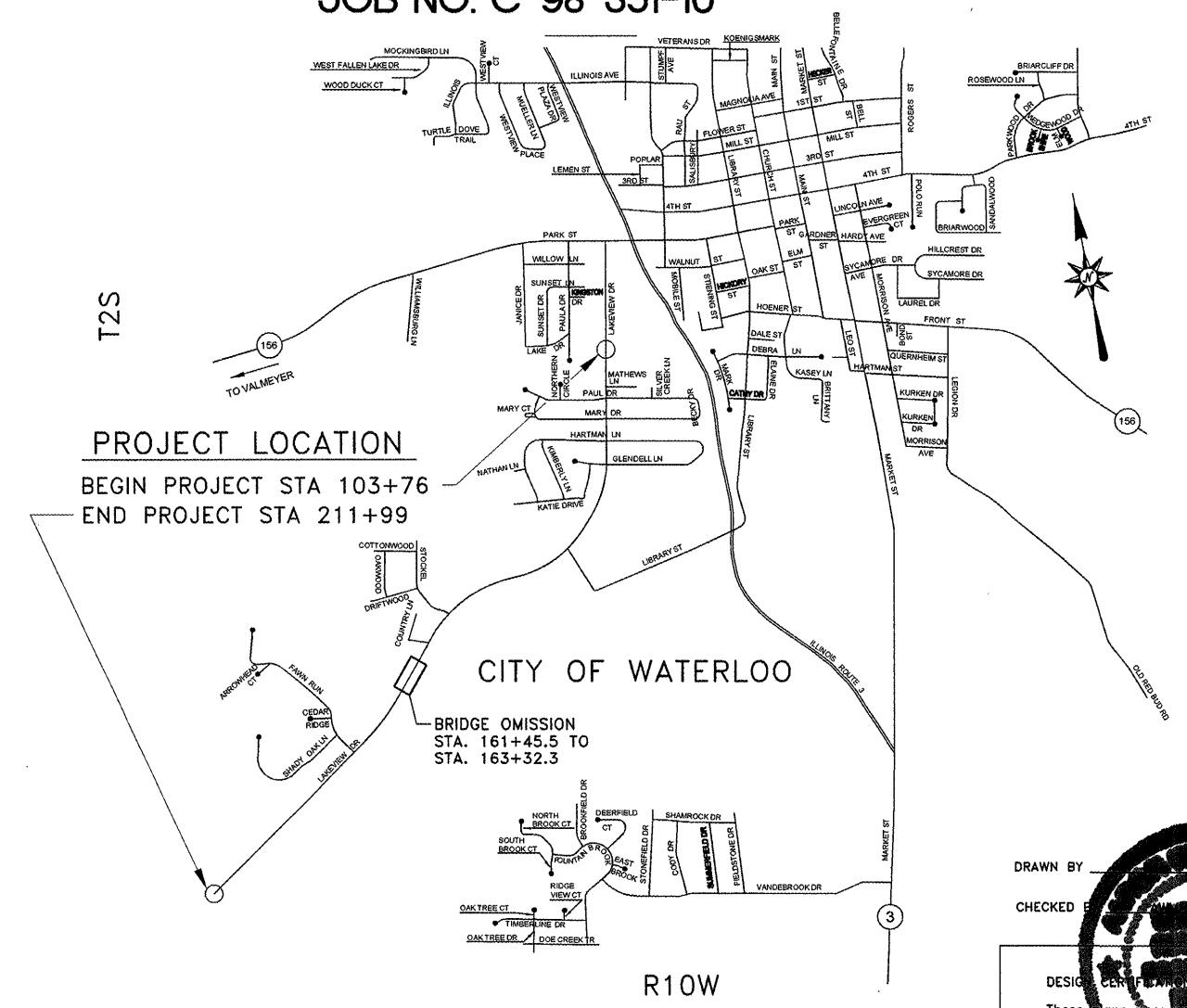

PROJECT LOCATION
BEGIN PROJECT STA 103+76
END PROJECT STA 211+99

BRIDGE OMISSION
STA. 161+45.5 TO
STA. 163+32.3

LOCATION MAP
DRAWING NOT TO SCALE
LENGTH OF PROJECT 10823 FEET - 2.050 MILES
NET LENGTH 10636.2 FEET - 2.014 MILES

UTILITIES
ELECTRIC - CITY OF WATERLOO - (618) 939-8600
GAS - CITY OF WATERLOO - (618) 939-8600
WATER - CITY OF WATERLOO - (618) 939-8600
TELEPHONE - HARRISONVILLE TELEPHONE COMPANY - (888) 482-8355
CABLE TV - CHARTER COMMUNICATIONS - (618) 345-8121
CALL J.U.L.I.E. BEFORE YOU DIG
800-892-0123

STATE OF ILLINOIS
DEPARTMENT OF TRANSPORTATION
DIVISION OF HIGHWAYS

APPROVED April 7, 2010

Monroe County Engineer
Monroe County Highway Department

APPROVED April 7, 2010

Mayor
City of Waterloo

Passed 4-12-10

District 8 Engineer
Local Roads and Streets

Released for
Bid Based on
Limited Review 4-12-10

Deputy Director of Highways
Region 5 Engineer

DRAWN BY 07-23-09
CHECKED BY 01-10

DESIGN CERTIFICATION
These plans were prepared by me or a full time member of my staff under my direct supervision.

Mary C. Lammie
County Engineer Date 07-10
Illinois Registered Professional Engineer No. 055382
Expiration Date: 11/30/11

DRAWING FILE: S:\LAKEVIEW\LAKEVIEWRESURF\COVER1.DWG

ROUTE NO	SECTION	COUNTY	TOTAL SHEETS	SHEET NO.
FAU 9314 C.H. 7	09-00034 -01-RS	MONROE	8	2

FEDERAL AID PROJECT
CONTRACT 97443

1. ALL CONSTRUCTION SHALL BE IN ACCORDANCE WITH ILLINOIS DEPARTMENT OF TRANSPORTATION "STANDARD SPECIFICATIONS FOR ROAD AND BRIDGE CONSTRUCTION" ADOPTED JANUARY 1, 2007 AND THE LATEST SUPPLEMENTAL SPECIFICATIONS AND RECURRING SPECIAL PROVISIONS.
2. THE CONTRACTOR SHALL VERIFY ALL DIMENSIONS AND CONDITIONS IN THE FIELD PRIOR TO CONSTRUCTION AND ORDERING MATERIALS.
3. EXCESS BITUMINOUS REMOVAL SHALL BE PAID FOR ACCORDING TO ARTICLE 109.04 OF THE STANDARD SPECIFICATIONS FOR ROAD AND BRIDGE CONSTRUCTIONS.
4. THE THICKNESS OF THE BITUMINOUS MIXTURE SHOWN ON THE PLANS IS THE NOMINAL THICKNESS, DEVIATIONS FROM THE NOMINAL THICKNESS WILL BE PERMITTED WHEN SUCH DEVIATIONS OCCUR DUE TO IRREGULARITIES IN THE EXISTING SURFACE.
5. THE CONTRACTOR IS RESPONSIBLE FOR CONTACTING MONROE COUNTY (48) HOURS IN ADVANCE PRIOR TO COMMENCEMENT OF ANY CONSTRUCTION ACTIVITIES OR WORK REQUIRING INSPECTION OR APPROVAL.
6. ALL TRAFFIC CONTROL (INCLUDING, BUT NOT LIMITED TO WORK ZONE, TEMPORARY AND PERMANENT) SHALL BE FURNISHED, INSTALLED, MAINTAINED, RELOCATED AND/OR REMOVED IN ACCORDANCE WITH SECTION 701 OF THE LATEST EDITION OF THE IDOT STANDARD SPECIFICATIONS FOR ROAD AND BRIDGE CONSTRUCTION AND THE LATEST EDITION OF THE MANUAL ON UNIFORM TRAFFIC CONTROL DEVICES.
7. NO OVERNIGHT LANE CLOSURES SHALL BE ALLOWED.
8. TRAFFIC CONTROL SIGNS SHALL BE 48" FLOURESCENT ORANGE
9. ALL TEMPORARY PAVEMENT MARKINGS WILL BE PLACED IN SUCH A MANNER SO AS NOT TO INTERFERE WITH THE PLACEMENT OF PERMANENT PAVEMENT MARKINGS.
10. REMOVAL OF EXISTING AGGREGATE SHOULDER AT DRIVES FOR THE PURPOSE OF OBTAINING THE MINIMUM ASPHALT DEPTH (1") WILL NOT BE MEASURED, BUT SHALL BE INCLUDED IN THE UNIT PRICE FOR HOT-MIX ASPHALT REMOVAL - BUTT JOINT.
11. ACCESS SHALL BE PROVIDED FROM PRIVATE ENTRANCES AT ALL LOCATIONS DURING ALL STAGES.
12. APRONS OF DRIVES AND MAILBOX TURNOUTS PAVED WITH EXTENDABLE SCREED WIDENERS WILL BE CONSIDERED AN INTEGRAL PART OF MAINLINE PAVING AND WILL NOT BE MEASURED FOR PAYMENT AS INCIDENTAL HOT-MIX ASPHALT SURFACING.
13. THE CONTRACTOR SHALL BE AWARE OF THE POSSIBILITY OF ON-GOING CONSTRUCTION ON LAKEVIEW DRIVE, CONTRACT NO. 97403, AND SHALL USE WHATEVER MEANS POSSIBLE TO COOPERATE PER ARTICLE 105.08 OF THE STANDARD SPECIFICATIONS.

FACTORS USED FOR QUANTITY CALCULATIONS ARE AS FOLLOWS:
 ALL HOT-MIX ASPHALT - 112 LB/SQ YD PER 1" THICKNESS
 AGGREGATE (PRIME COAT) - 3 LB/SQ YD
 BITUMINOUS MATERIAL (PRIME COAT) OVER ASPHALT - 0.05 GAL/SQ YD
 ALL AGGREGATE - 2.05 TONS/CU YD

SALVAGE: EXISTING GUARDRAIL: INCLUDING RAIL, POSTS, TERMINALS & HARDWARE.
 MILLINGS
 REFER TO SPECIAL PROVISIONS FOR ADDITIONAL INFORMATION

SUMMARY OF QUANTITY

CODE	ITEM	UNIT	QUANT.
40200800	AGGREGATE SURFACE COURSE, TYPE B	TON	43.0
40600100	BITUMINOUS MATERIALS (PRIME COAT)	GALLON	1405
40600300	AGGREGATE (PRIME COAT)	TON	41.1
40600635	LEVELING BINDER (MACHINE METHOD), N70	TON	1092.0
40600982	HOT-MIX ASPHALT SURFACE REMOVAL - BUTT JOINT	SQ. YD.	969.0
40600985	PORTLAND CEMENT CONCRETE SURFACE REMOVAL- BUTT JOINT	SQ.YD.	98.0
40600990	TEMPORARY RAMP	SQ.YD.	68.0
40603340	HOT-MIX ASPHALT SURFACE COURSE, MIX "D", N70	TON	1820.0
40800050	INCIDENTAL HOT-MIX ASPHALT SURFACING	TON	223.5
44000157	HOT-MIX ASPHALT SURFACE REMOVAL, 2"	SQ.YD.	1896.0
44300300	AREA REFLECTIVE CRACK CONTROL TREATMENT SYSTEM A	SQ.YD.	26,121.0
48101200	AGGREGATE SHOULDERS, TYPE B	TON	920.0
48203100	HOT-MIX ASPHALT SHOULDERS	TON	58.0
* 63000003	STEEL PLATE BEAM GUARDRAIL, TYPE A, 9 FOOT POSTS	FOOT	3175.0
* 63100167	TRAFFIC BARRIER TERMINAL, TYPE 1 (SPECIAL) TANGENT	EACH	16.0
63200310	GUARDRAIL REMOVAL	FOOT	3917.0
67100100	MOBILIZATION	L SUM	1.0
70101700	TRAFFIC CONTROL AND PROTECTION	L SUM	1.0
70300100	SHORT-TERM PAVEMENT MARKING	FOOT	3190.0
70300220	TEMPORARY PAVEMENT MARKING - LINE 4"	FOOT	28853.0
70301000	WORK ZONE PAVEMENT MARKING REMOVAL	SQ.FT.	355.0
* 78000200	THERMOPLASTIC PAVEMENT MARKING - LINE 4"	FOOT	28853.0
* 78200410	GUARDRAIL MARKERS, TYPE A	EACH	49.0
* 78201000	TERMINAL MARKER-DIRECT APPLIED	EACH	16.0

* SPECIALTY ITEMS

LAKEVIEW DRIVE RESURFACING
 GENERAL NOTES &
 SUMMARY OF QUANTITIES
 SEC 09-00034-01-RS
 CITY OF WATERLOO
 MONROE COUNTY, ILLINOIS

ROUTE NO	SECTION	COUNTY	TOTAL SHEETS	SHEET NO.
FAU 9314 C.H. 7	09-00034 -01-RS	MONROE	8	3

FEDERAL AID PROJECT
CONTRACT 97443

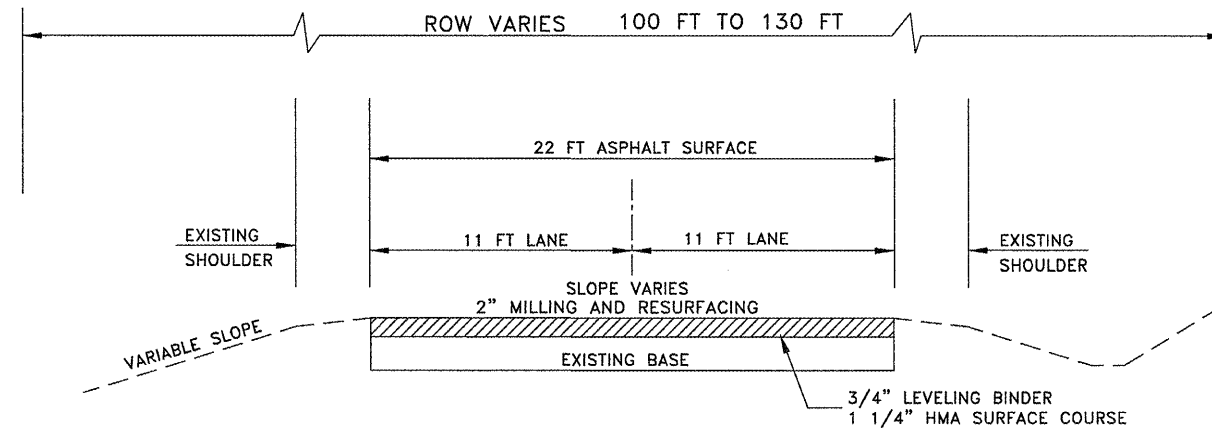
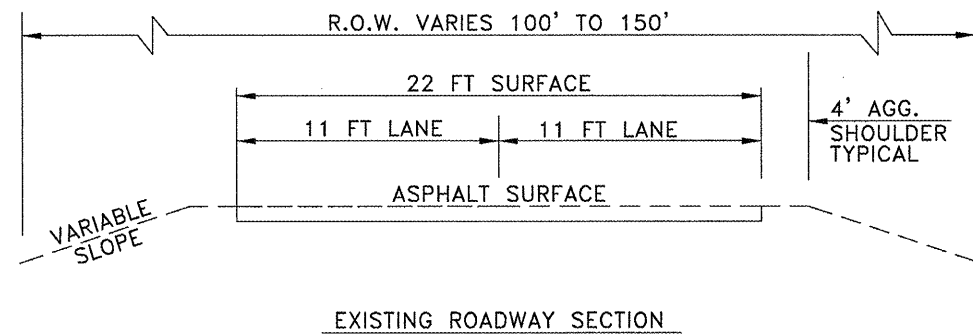

PROPOSED SECTION
STA. 153+70 TO STA. 161+45.5

ASPHALT OVERLAY OMISSION FROM STA. 161+45.5
TO STA. 163+32.3 DUE TO CONCRETE APPROACH PAVEMENT
AND 6\"/>

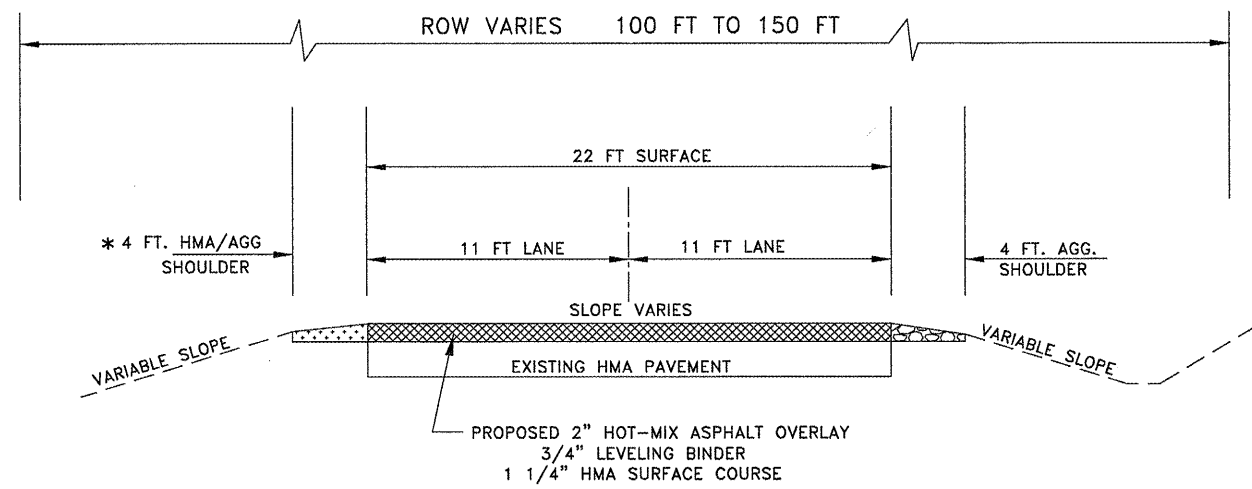

* 4 FT HMA SHOULDERS
2\"/>

PROPOSED SECTION
STA. 103+76 TO STA. 153+70
BUTT JOINTS AT EACH END

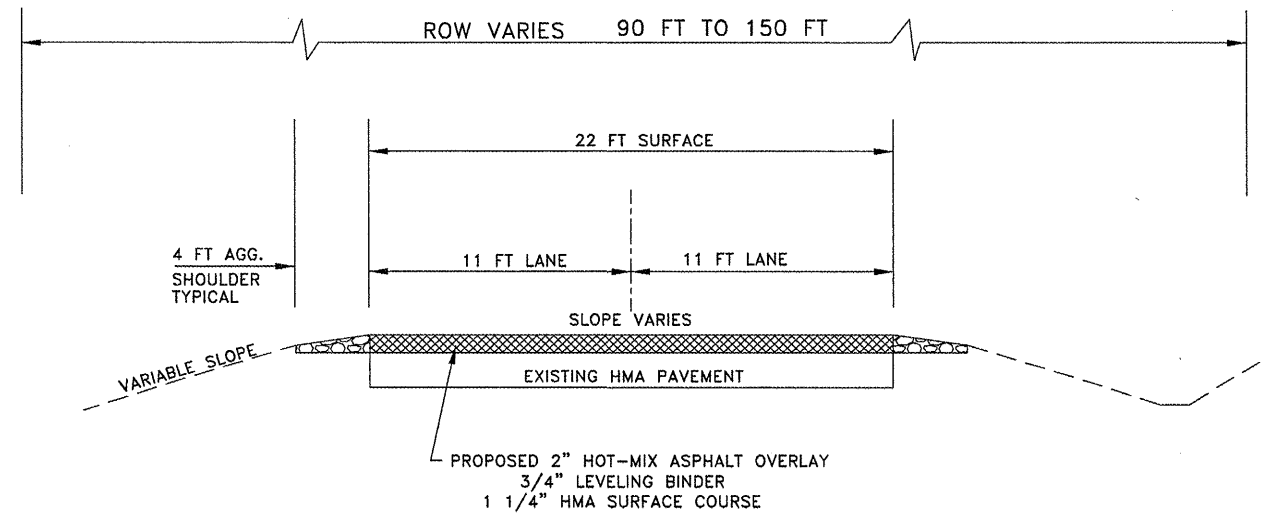

PROPOSED SECTION
STA. 163+32.27 TO STA. 211+99
BUTT JOINTS AT EACH END

AREA REFLECTIVE CRACK CONTROL TO BE PLACED BETWEEN
LEVEL BINDER AND SURFACE, LENGTH OF PROJECT.

REFER TO SHEET 4 FOR GUARDRAIL DETAIL

DRAWING NOT TO SCALE

LAKEVIEW DRIVE RESURFACING
TYPICAL SECTIONS
SEC 09-00034-01-RS
CITY OF WATERLOO
MONROE COUNTY, ILLINOIS

ROUTE NO	SECTION	COUNTY	TOTAL SHEETS	SHEET NO.
FAU 9314 C.H. 7	09-00034 -01-RS	MONROE	8	4

FEDERAL AID PROJECT
CONTRACT 97443

PROJECT LOCATION

BEGIN PROJECT STA 103+76
END PROJECT STA 211+99

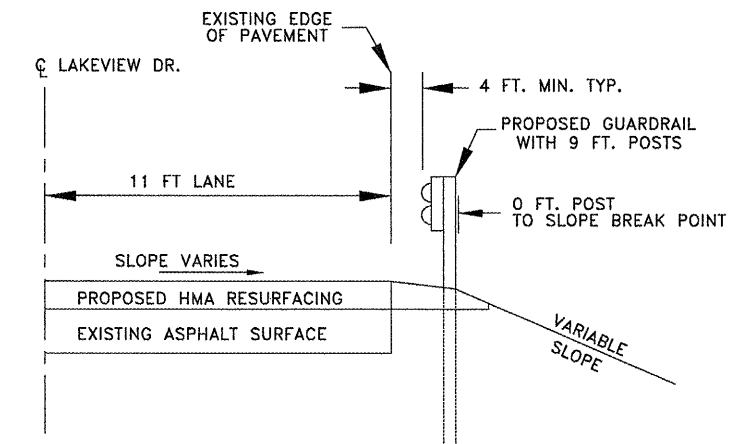
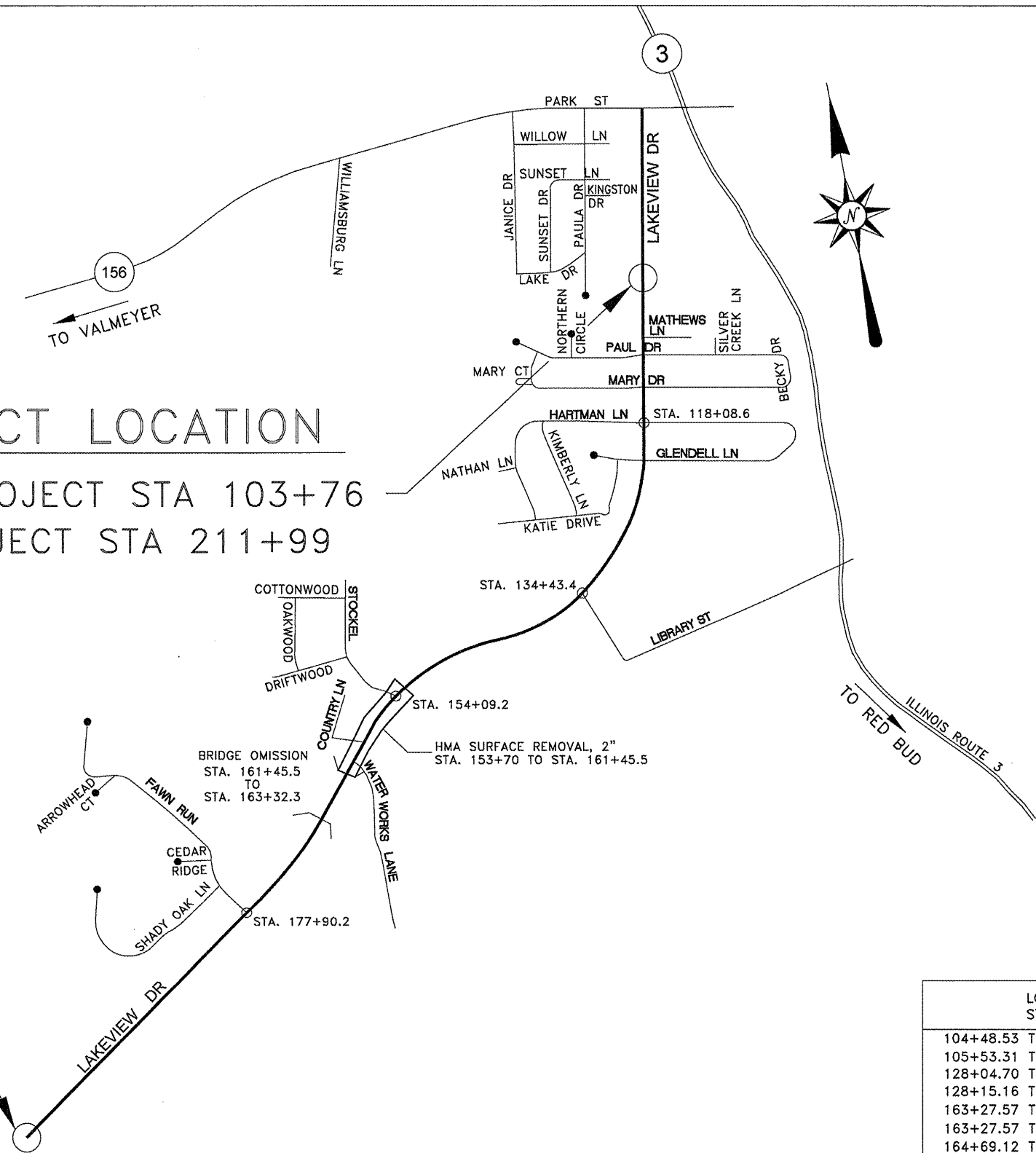

PROPOSED GUARDRAIL SECTION

PER BLR 26-2
EXCEPT AS SHOWN ABOVE

* REFER TO SPECIAL PROVISIONS FOR GUARDRAIL/SHOULDER CONSTRUCTION SEQUENCING

GUARDRAIL SCHEDULE

LOCATION STATION	SIDE LT/RT	GUARDRAIL REMOVAL (FOOT)	STEEL PLATE BEAM GUARDRAIL, TYPE A (FOOT)	TRAFFIC BARRIER TERMINAL, TYPE 1 (SPECIAL) FLARED (EACH)	GUARDRAIL MARKERS, TYPE A (EACH)
104+48.53 TO 108+51.44	RIGHT	403.0	300.0	2	5
105+53.31 TO 107+93.95	LEFT	241.0	137.5	2	3
128+04.70 TO 133+76.22	LEFT	578.0	475.0	2	7
128+15.16 TO 133+73.13	RIGHT	553.0	450.0	2	7
163+27.57 TO 169+40.07	RIGHT	578.0	562.5	1	8
163+27.57 TO 164+35.11	LEFT	103.0	50.0	1	2
164+69.12 TO 171+70.18	LEFT	653.0	600.0	2	8
187+51.62 TO 191+18.37	LEFT	367.0	262.5	2	4
191+45.81 TO 195+87.03	LEFT	441.0	337.5	2	5
TOTALS	LEFT	3917	3175	16	49

CITY OF WATERLOO

LAKEVIEW DRIVE RESURFACING
PLAN, GUARDRAIL SCHEDULE
AND DETAIL
SECT. 09-00034-01-RS
CITY OF WATERLOO
MONROE COUNTY, ILLINOIS

DRAWING FILE: S:\lakeview\lakeviewresurf\cover1.dwg

MAINLINE SURFACING SUMMARY

LOCATION STATION - STATION	HOT-MIX ASPHALT SURFACE COURSE, MIX "D" N70	LEVELING BINDER MIX "C" N70	HOT-MIX ASPHALT SHOULDERS MIX "C" N70	HOT-MIX ASPHALT SURFACE REMOVAL, 2"	HOT-MIX ASPHALT SURFACE REMOVAL - BUTT JOINT	AGGREGATE SHOULDERS	BITUMINOUS MATERIALS (PRIME COAT)	AGGREGATE (PRIME COAT)
UNIT	TON	TON	TON	SQ YD	SQ YD	TON	GAL	TON
STA. 103+76 TO STA. 138+25	590	354	--	--	98	350	422	12.6
STA. 138+25 TO STA. 153+70	264	158	58	--	196	80	223	5.7
STA. 153+70 TO STA. 161+45.5	133	80	--	1896	--	--	95	2.9
STA. 161+45.5 TO STA. 163+32.3				BRIDGE	OMISSION			
STA. 163+32.3 TO STA. 211+99	833	500	--	--	391	490	595	17.8
PROJECT TOTALS	1820	1092	58	1896	685	920	1335	39.0

HOT-MIX ASPHALT MIXTURE REQUIREMENTS

LOCATION(S)	ALL			
MIXTURE USE(S)	SURFACE	LEVELING BINDER	INCIDENTAL	SHOULDERS
AC/PG	PG 64-22	PG 64-22	PG 64-22	PG 64-22
RAP % (MAX)	10%	15%	15%	15%
DESIGN AIR VOIDS	4.0% @ Ndes=70	4.0% @ Ndes=70	4.0% @ Ndes=50	4.0% @ Ndes=70
MIXTURE COMPOSITION (GRADATION MIXTURE)	9.5			
FRICITION AGGREGATE	MIXTURE D	MIXTURE C	MIXTURE C	MIXTURE C

THERMOPLASTIC PAVEMENT MARKINGS

STATION	SKIP-DASH YELLOW 4" (FT)	SOLID YELLOW 4" (FT)		SOLID WHITE 4" (FT)	
		NO PASSING ZONE		EDGELINES	
		LT	RT	LT	RT
103+76 TO 108+70	124	--	494	494	494
108+70 TO 112+00	82	--	--	260	330
112+00 TO 118+61	165	661	--	464	429
118+61 TO 126+00	185	--	--	669	655
126+00 TO 133+70	192	--	770	770	770
133+70 TO 136+69	--	299	299	209	299
136+69 TO 144+30	190	761	--	761	761
144+30 TO 161+45.5	429	--	--	1650	1580
161+45.5 TO 163+32.3	--	--	--	--	--
163+32.3 TO 169+86	163	--	--	654	654
169+86 TO 177+61	194	--	775	775	700
177+61 TO 182+36	--	475	475	475	475
182+36 TO 193+61	281	1125	--	1125	1125
193+61 TO 211+99	460	--	--	1838	1838
SUBTOTALS	2465	3321	2813	10144	10110
TOTALS		28853			

PAVEMENT MARKINGS SHALL MATCH LOCATIONS OF EXISTING PAVEMENT MARKINGS OR LOCATIONS SPECIFIED BY THE ENGINEER.

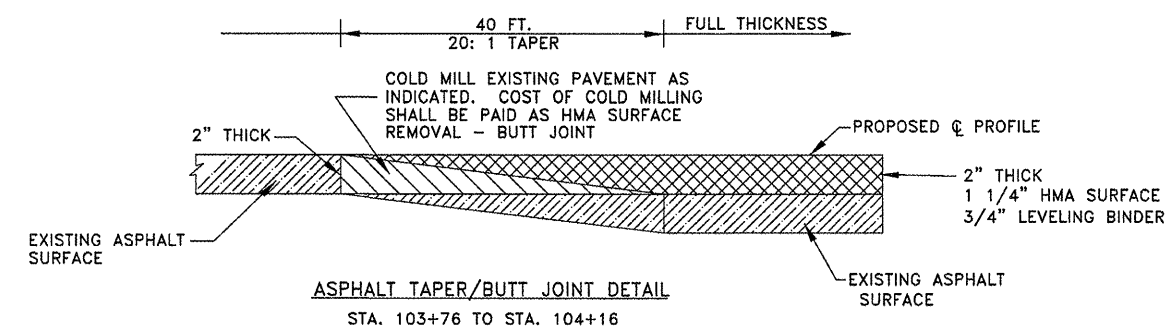
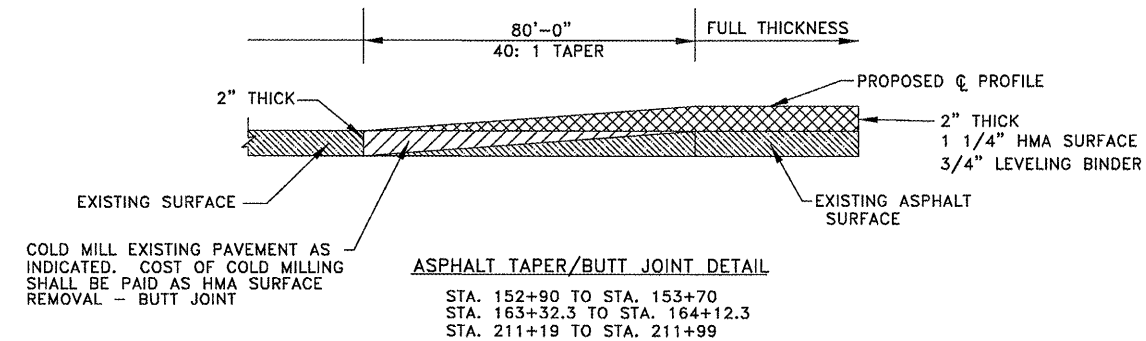

LAKEVIEW DRIVE RESURFACING
DETAILS AND SCHEDULES
SEC 09-00034-01-RS
CITY OF WATERLOO
MONROE COUNTY, ILLINOIS

ENTRANCE SCHEDULE

ROUTE NO.	SECTION	COUNTY	TOTAL SHEETS	SHEET NO.
FAU 9314 C.H. 7	09-00034 -00-RS	MONROE	8	6

FEDERAL AID PROJECT
CONTRACT 97443

LOCATION STATION	SIDE LT/RT	EXISTING SURFACE	TYPE OF ENTRANCE	LENGTH (FT.)	WIDTH (FT.)	INCIDENTAL HMA SURFACING (TON)	BIT. MAT'L (PRIME COAT) (GALLON)	AGGREGATE (PRIME COAT) (TON)	HMA SURFACE REMOVAL - BUTT JOINT (SQ. YD.)	AGGREGATE SURFACE COURSE (TON)
104+30.17	RIGHT	OIL & CHIP	PRIVATE	10.0	22.0	1.1	1.2	0.04	4.9	--
104+78.52	LEFT	ASPHALT	PRIVATE	4.0	20.0	0.8	0.4	0.01	4.4	--
108+18.34	LEFT	OIL & CHIP	PRIVATE	8.0	30.0	1.5	0.7	0.02	--	2.5
110+44.17	RIGHT	CONCRETE	PRIVATE	8.0	24.0	1.8	1.1	0.03	--	--
116+63.85	LEFT	CONCRETE	PRIVATE	7.0	30.0	2.0	1.1	0.03	13.3	--
119+45.48	LEFT	OIL & CHIP	PRIVATE	8.0	20.0	1.0	0.5	0.02	--	1.5
123+86.26	LEFT	OIL & CHIP	PRIVATE	8.0	22.0	1.1	0.5	0.02	--	1.5
127+97.13	RIGHT	ROCK	FIELD	0.0	0.0	0.0	0.0	0.0	--	--
127+98.16	LEFT	TURF	FIELD	0.0	0.0	0.0	0.0	0.0	--	--
138+52.80	RIGHT	ROCK	PRIVATE	8.0	20.0	1.0	0.4	0.01	--	1.5
140+29.93	RIGHT	ROCK	PRIVATE	8.0	30.0	1.5	0.7	0.02	--	2.5
141+39.15	RIGHT	ASPHALT	PRIVATE	4.0	30.0	1.1	0.7	0.02	6.7	--
142+53.86	RIGHT	ROCK	PRIVATE	8.0	30.0	1.5	0.7	0.02	--	2.5
143+60.16	RIGHT	ROCK	PRIVATE	8.0	26.0	1.3	0.6	0.02	--	2.0
144+35.32	RIGHT	ASPHALT	PRIVATE	4.0	30.0	1.1	0.7	0.02	6.7	--
145+10.50	RIGHT	ROCK	PRIVATE	8.0	20.0	1.0	0.4	0.01	--	1.5
145+84.51	RIGHT	CONCRETE	PRIVATE	3.0	24.0	0.7	0.4	0.01	8.0	--
146+57.39	RIGHT	OIL & CHIP	PRIVATE	8.0	24.0	1.8	0.5	0.02	10.7	--
147+72.59	RIGHT	OIL & CHIP	PRIVATE	8.0	42.0	3.1	1.4	0.04	--	4.0
148+33.78	RIGHT	OIL & CHIP	PRIVATE	8.0	30.0	1.5	0.7	0.02	13.3	--
149+07.75	RIGHT	CONCRETE	PRIVATE	5.0	30.0	1.4	0.8	0.02	10.0	--
149+77.23	RIGHT	OIL & CHIP	PRIVATE	8.0	24.0	1.2	0.5	0.02	--	2.0
151+57.25	RIGHT	ROCK	PRIVATE	8.0	28.0	1.4	0.6	0.02	--	2.5
152+66.88	RIGHT	ROCK	PRIVATE	8.0	28.0	1.4	0.6	0.02	--	2.5
153+15.33	RIGHT	CONCRETE	PRIVATE	4.0	20.0	--	--	--	--	--
154+68.12	RIGHT	ROCK	PRIVATE	8.0	24.0	--	--	--	--	--
154+84.54	LEFT	ASPHALT	PRIVATE	4.0	42.0	--	--	--	--	--
155+94.39	RIGHT	ROCK	PRIVATE	8.0	24.0	--	--	--	--	--
157+67.19	RIGHT	ASPHALT	PRIVATE	4.0	28.0	--	--	--	--	--
158+21.24	RIGHT	ROCK	PRIVATE	8.0	22.0	--	--	--	--	--
159+49.15	RIGHT	ROCK	PRIVATE	8.0	20.0	--	--	--	--	--
160+42.96	RIGHT	ROCK	PRIVATE	8.0	20.0	--	--	--	--	--
161+32.69	RIGHT	ASPHALT	PRIVATE	6.0	30.0	--	--	--	--	--
164+52.47	LEFT	TURF	FIELD	0.0	0.0	0.0	0.0	0.0	--	--
174+90.85	RIGHT	ASPHALT	PRIVATE	4.0	28.0	1.0	0.6	0.02	6.2	--
178+67.32	RIGHT	TURF	FIELD	0.0	0.0	0.0	0.0	0.0	--	--
178+67.67	LEFT	ROCK	PRIVATE	8.0	20.0	1.0	0.4	0.01	--	1.5
178+93.63	LEFT	ROCK	PRIVATE	8.0	20.0	1.0	0.4	0.01	--	1.5
179+31.39	LEFT	ROCK	PRIVATE	8.0	20.0	1.0	0.4	0.01	--	1.5
180+38.58	RIGHT	ROCK	PRIVATE	8.0	20.0	1.0	0.4	0.01	--	1.5
182+11.12	RIGHT	ROCK	PRIVATE	8.0	26.0	1.3	0.6	0.02	--	2.0
183+38.09	LEFT	ROCK	PRIVATE	8.0	22.0	1.1	0.5	0.02	--	1.5
184+56.89	LEFT	ASPHALT	PRIVATE	8.0	22.0	1.6	0.5	0.02	9.8	--
186+10.53	RIGHT	ROCK	PRIVATE	8.0	24.0	1.2	0.5	0.02	--	2.0
187+01.62	RIGHT	ROCK	PRIVATE	8.0	36.0	1.8	0.8	0.02	--	3.0
187+37.38	LEFT	TURF	FIELD	0.0	0.0	0.0	0.0	0.0	--	--
190+64.37	RIGHT	ASPHALT	PRIVATE	6.0	26.0	1.5	0.9	0.03	8.7	--
191+29.54	LEFT	TURF	FIELD	0.0	0.0	0.0	0.0	0.0	--	--
194+44.06	RIGHT	ROCK	PRIVATE	8.0	26.0	1.3	0.6	0.02	--	2.0
195+12.92	RIGHT	ASPHALT	PRIVATE	6.0	40.0	2.2	1.3	0.04	13.3	--
196+60.45	RIGHT	ASPHALT	PRIVATE	6.0	40.0	2.2	1.3	0.04	13.3	--
197+83.40	RIGHT	CONCRETE	PRIVATE	2.0	38.0	0.7	0.5	0.02	8.4	--
199+25.34	RIGHT	CONCRETE	PRIVATE	2.0	32.0	0.6	0.5	0.02	7.1	--
201+24.32	RIGHT	ASPHALT	PRIVATE	4.0	32.0	1.1	0.8	0.02	7.1	--
203+98.23	LEFT	ASPHALT	PRIVATE	8.0	36.0	2.7	1.8	0.06	16.1	--
204+85.40	RIGHT	TURF	FIELD	0.0	0.0	0.0	0.0	0.0	--	--
TOTALS						54.6	28.0	0.87	168.0	43.0

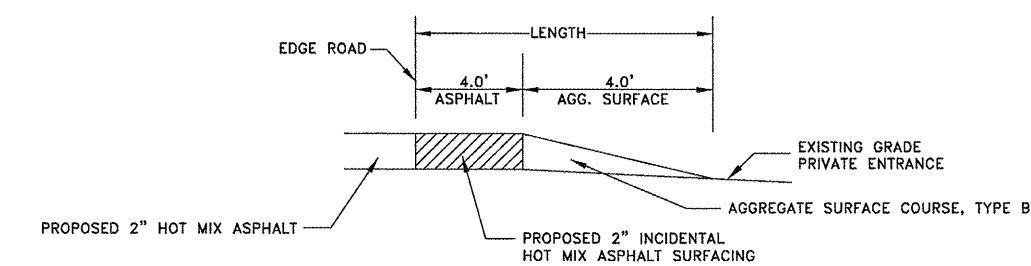
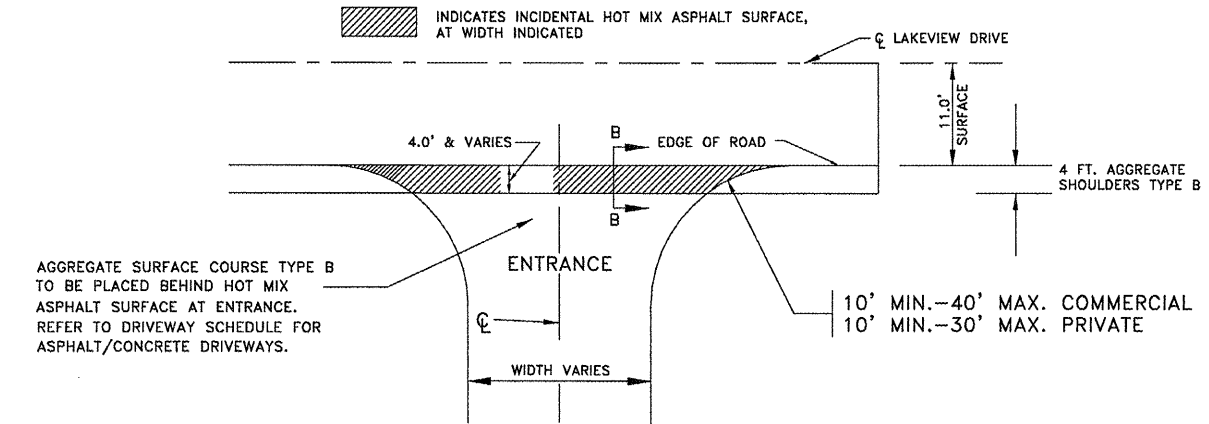

SECTION B-B
TYPICAL SECTION PRIVATE ENTRANCE
AGGREGATE/OIL & CHIP DRIVES

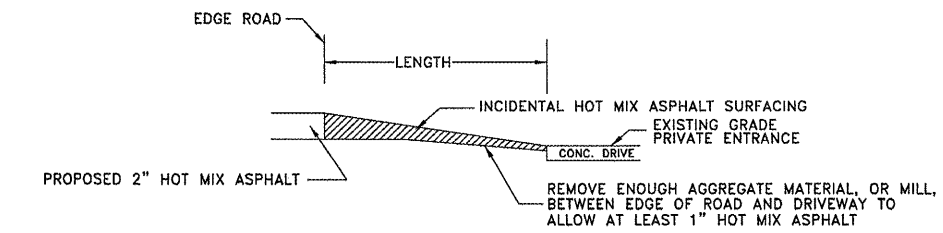

SECTION B-B
TYPICAL SECTION PRIVATE ENTRANCE
CONCRETE DRIVES

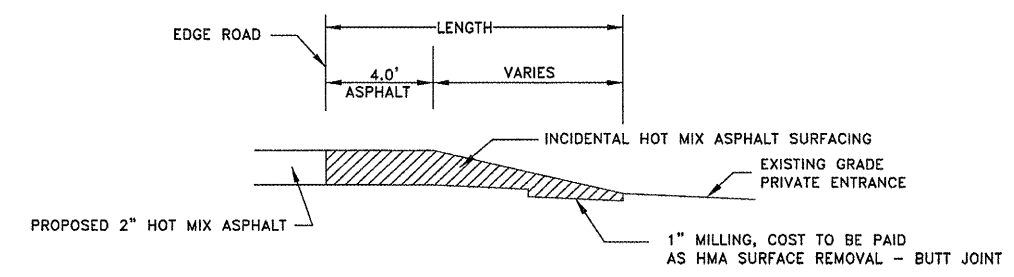

SECTION B-B
TYPICAL SECTION PRIVATE ENTRANCE
ASPHALT DRIVES

LAKEVIEW DRIVE RESURFACING
DETAILS & SCHEDULES
SEC 09-00034-01-RS
CITY OF WATERLOO
MONROE COUNTY, ILLINOIS

DRAWING FILE: S:\lakeview\lakeviewresurf\cover1.dwg

MAILBOX TURNOUT SCHEDULE

LOCATION STATION	SIDE LT/RT	INCIDENTAL HOT MIX ASPHALT SURFACING TONS	BIT. MAT'L (PRIME COAT) GALLON	AGGREGATE (PRIME COAT) TON
104+67.26	LEFT	1.6	0.7	0.02
107+99.71	LEFT	1.6	0.7	0.02
110+23.74	RIGHT	1.6	0.7	0.02
110+28.42	LEFT	1.6	0.7	0.02
116+43.23	LEFT	1.6	0.7	0.02
119+29.14	LEFT	1.6	0.7	0.02
123+63.26	LEFT	1.6	0.7	0.02
140+09.74	RIGHT	1.6	0.7	0.02
141+16.03	RIGHT	1.6	0.7	0.02
142+35.39	RIGHT	1.6	0.7	0.02
143+47.83	RIGHT	1.6	0.7	0.02
144+49.94	RIGHT	1.6	0.7	0.02
145+21.54	RIGHT	1.6	0.7	0.02
145+71.84	RIGHT	1.6	0.7	0.02
146+42.60	RIGHT	1.6	0.7	0.02
147+49.41	RIGHT	1.6	0.7	0.02
147+91.90	RIGHT	1.6	0.7	0.02
148+48.20	RIGHT	1.6	0.7	0.02
149+18.54	RIGHT	1.6	0.7	0.02
149+89.29	RIGHT	1.6	0.7	0.02
151+70.79	RIGHT	1.6	0.7	0.02
153+28.04	RIGHT	---	---	---
154+60.02	RIGHT	---	---	---
156+12.49	RIGHT	---	---	---
157+89.45	RIGHT	---	---	---
158+01.02	RIGHT	---	---	---
159+60.56	RIGHT	---	---	---
160+31.81	LEFT	---	---	---
160+37.51	LEFT	---	---	---
174+94.78	LEFT	1.6	0.7	0.02
178+85.03	LEFT	1.6	0.7	0.02
180+51.96	LEFT	1.6	0.7	0.02
182+03.34	LEFT	1.6	0.7	0.02
183+16.50	LEFT	1.6	0.7	0.02
184+37.27	LEFT	1.6	0.7	0.02
186+38.01	LEFT	1.6	0.7	0.02
186+59.40	LEFT	1.6	0.7	0.02
190+27.98	LEFT	1.6	0.7	0.02
194+04.44	LEFT	1.6	0.7	0.02
196+26.18	LEFT	1.6	0.7	0.02
199+20.24	LEFT	1.6	0.7	0.02
TOTALS		52.8	23.1	0.66

ROUTE NO.	SECTION	COUNTY	TOTAL SHEETS	SHEET NO.
FAU 9314 C.H. 7	09-00034 -01-RS	MONROE	8	7

FEDERAL AID PROJECT
CONTRACT 97443

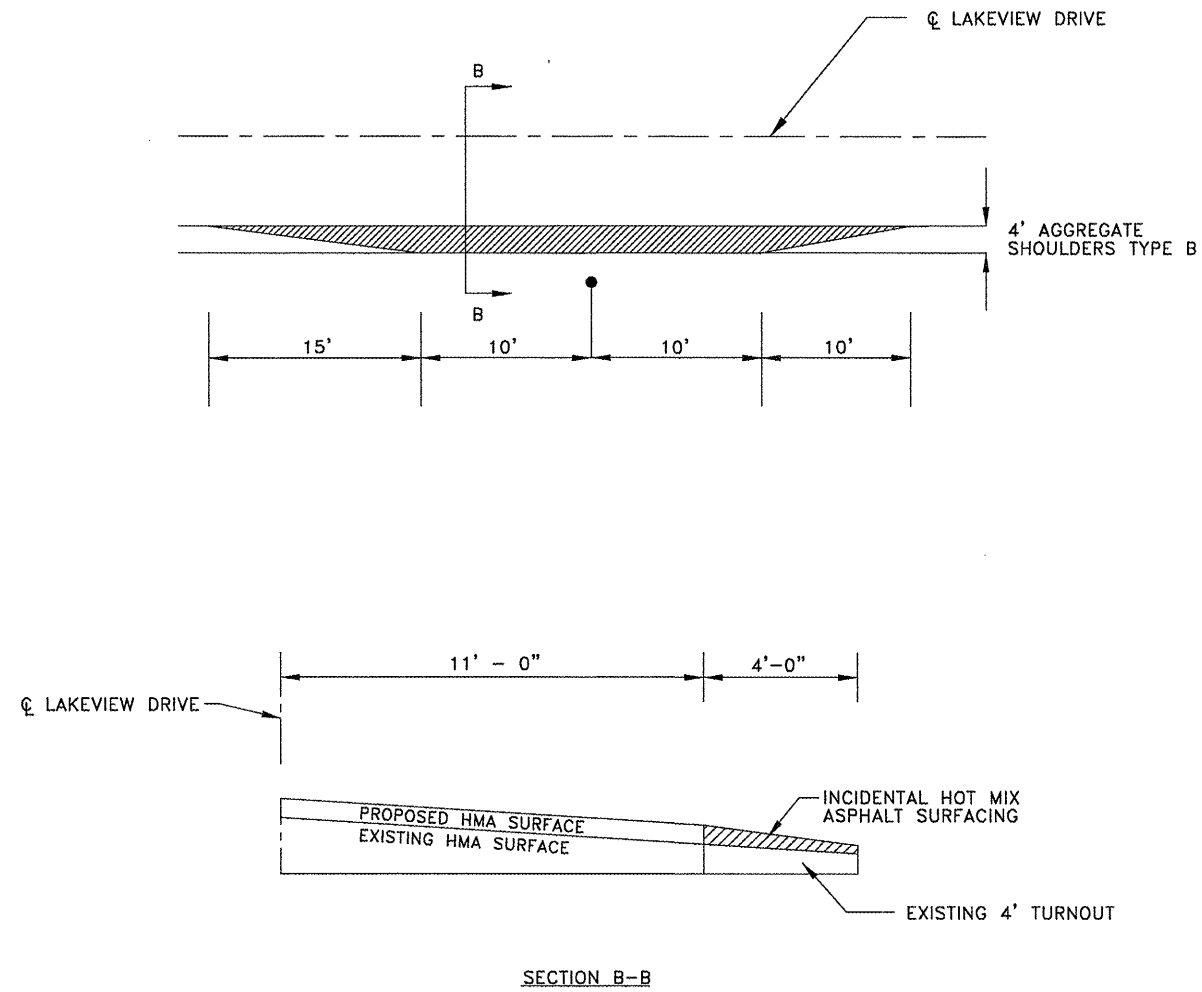

TYPICAL MAILBOX TURNOUT DETAIL

DRAWING FILE: S:\lakeview\lakeviewresurf\cover1.dwg

LAKEVIEW DRIVE RESURFACING
DETAILS & SCHEDULES
SEC 09-00034-01-RS
CITY OF WATERLOO
MONROE COUNTY, ILLINOIS

ROUTE NO	SECTION	COUNTY	TOTAL SHEETS	SHEET NO.
FAU 9314 C.H. 7	09-00034 -01-RS	MONROE	8	8

FEDERAL AID PROJECT
CONTRACT 97443

SIDEROAD SCHEDULE

LOCATION STATION	SIDE LT/RT	EXISTING SURFACE	LENGTH (FT.)	WIDTH (FT.)	INCIDENTAL HOT MIX ASPHALT SURFACING (TONS)	BIT. MAT'L (PRIME COAT) (GALLON)	AGGREGATE (PRIME COAT) (TON)	HMA SURFACE REMOVAL-BUTT JOINT (SQ. YD.)	PCC SURFACE REMOVAL-BUTT JOINT (SQ. YD.)	ROAD NAME
110+53.82	LEFT	OIL & CHIP	4.0	18.0-70.0	2.6	---	---	---	---	MATHEWS LANE
112+09.02	LEFT	ASPHALT	10.0	28.0-63.0	4.5	2.6	0.08	17.8	---	PAUL DRIVE
112+10.05	RIGHT	CONCRETE	12.0	30.0-80.0	6.7	3.8	0.10	---	26.0	PAUL DRIVE
114+92.42	RIGHT	CONCRETE	8.0	30.0-80.0	4.8	2.4	0.08	---	21.0	MARY DRIVE
114+94.67	LEFT	ASPHALT	5.0	28.0-64.0	2.5	1.3	0.05	9.3	---	MARY DRIVE
118+07.28	RIGHT	CONCRETE	9.0	28.0-72.0	5.2	2.6	0.08	---	51.0	HARTMAN DRIVE
118+08.61	LEFT	ASPHALT	10.0	28.0-70.0	5.2	2.8	0.08	46.8	---	HARTMAN DRIVE
121+47.22	LEFT	ASPHALT	10.0	28.0-70.0	5.2	2.8	0.08	23.4	---	GLENDELL DRIVE
121+47.31	RIGHT	CONCRETE	2.0	28.0-84.0	1.6	0.6	0.02	18.7	---	GLENDELL DRIVE
134+43.39	LEFT	OIL & CHIP	60.0	18.0-90.0	65.0	---	---	---	---	SOUTH LIBRARY ST.
154+09.23	RIGHT	CONCRETE	0.0	30.0-81.0	---	---	---	---	---	STOCKEL LANE
159+25.49	RIGHT	OIL & CHIP	0.0	15.0-54.0	---	---	---	---	---	COUNTRY LANE
160+87.61	LEFT	OIL & CHIP	0.0	22.0-66.0	---	---	---	---	---	WATERWORKS ROAD
177+90.21	RIGHT	OIL & CHIP	21.0	22.0-75.0	12.8	---	---	---	---	FAWN RUN
TOTAL					116.1	18.9	0.57	116.0	98.0	

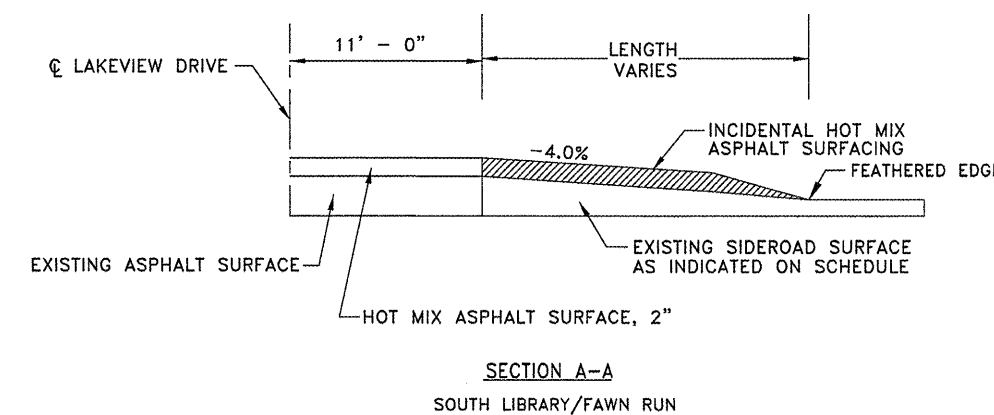
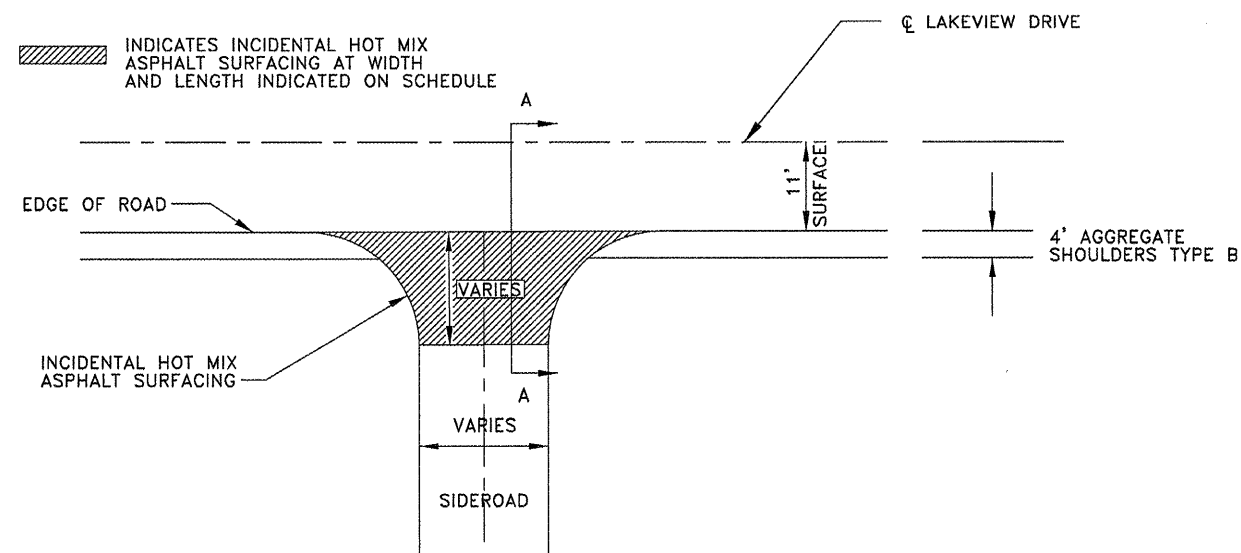
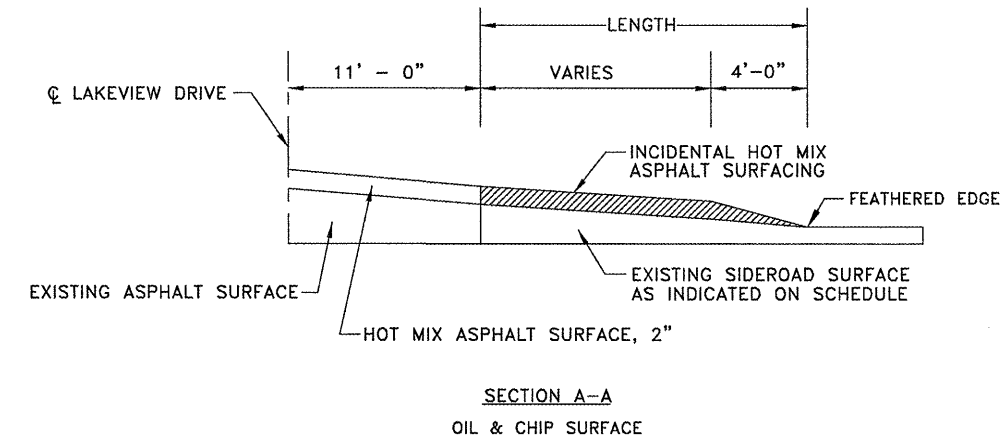
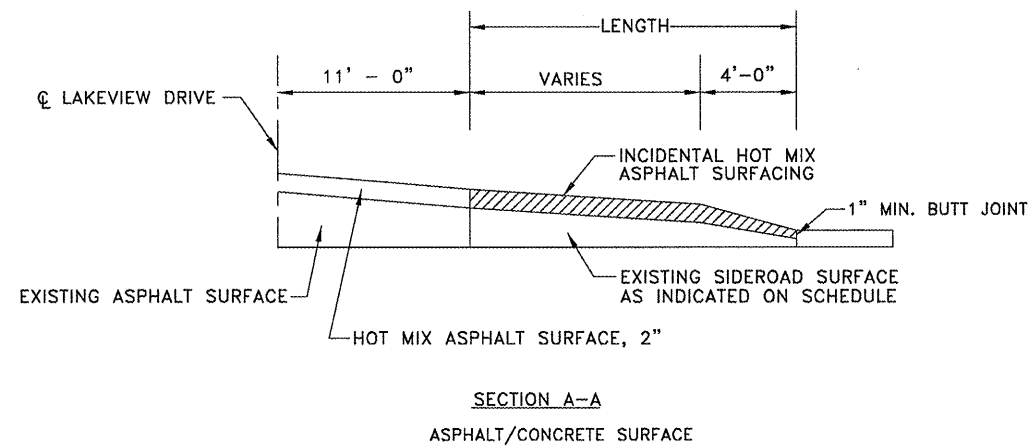

LAKEVIEW DRIVE RESURFACING
DETAILS & SCHEDULES
SEC 09-00034-01-RS
CITY OF WATERLOO
MONROE COUNTY, ILLINOIS