

**INDEX OF SHEETS**

- 1. COVER SHEET
- 2. GENERAL NOTES & MIX REQUIREMENTS
- 3. SUMMARY OF QUANTITIES
- 4-5. SCHEDULE OF QUANTITIES
- 6. TYPICAL SECTIONS
- 7. LINE DIAGRAM
- 8. TRAFFIC CONTROL AND PROTECTION DETAIL
- 9-10. DISTRICT STANDARDS

**HIGHWAY STANDARDS**

001006	701456-05
701411-09	701701-10
701421-08	701901-08
701426-09	780001-05
701428-01	

**DESIGN DESIGNATION**

**US 24 /US 150: PRINCIPAL ARTERIAL**  
 ADT: 37,900 (2018)  
 HCV: 898 (2.37%)  
 SU: 625 (1.65%)  
 MU: 277 (0.73%)

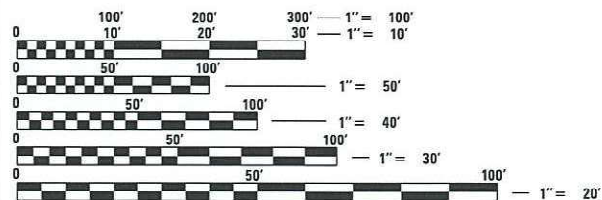

FULL SIZE PLANS HAVE BEEN PREPARED USING STANDARD ENGINEERING SCALES. REDUCED SIZED PLANS WILL NOT CONFORM TO STANDARD SCALES. IN MAKING MEASUREMENTS ON REDUCED PLANS, THE ABOVE SCALES MAY BE USED.

J.U.L.I.E.  
 JOINT UTILITY LOCATION INFORMATION FOR EXCAVATORS  
 1-800-892-0123  
 OR 811

PROJECT ENGINEER: RICH DOTSON (309) 671-3455  
 PROJECT MANAGER: ANNA DEVINE (309) 671-3475

CATALOG NO. 036190-00D  
 CONTRACT NO. 68G26

STATE OF ILLINOIS  
 DEPARTMENT OF TRANSPORTATION

**PROPOSED  
 HIGHWAY PLANS**

FAP ROUTE 317 (US 24 /US 150)  
 SECTION 16PP;17PP-1  
 CONTRACT MAINTENANCE  
 TAZEWELL COUNTY

C-94-047-21

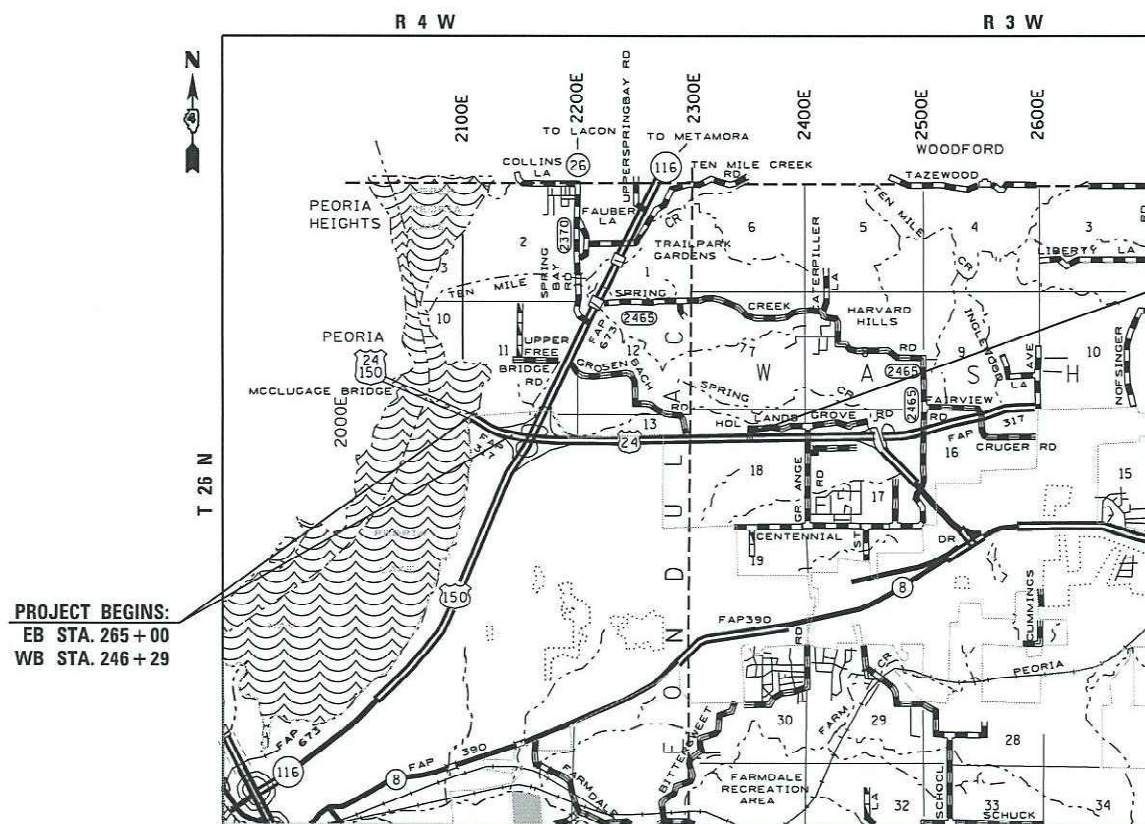

PROJECT BEGINS:  
 EB STA. 265 + 00  
 WB STA. 246 + 29

PROJECT ENDS:  
 EB & WB STA. 373 + 50

F.A.P. RTE.	SECTION	COUNTY	TOTAL SHEETS	SHEET NO.
317	16PP;17PP-1	TAZEWELL	10	1
		ILLINOIS	CONTRACT NO. 68G26	

D-94-028-21

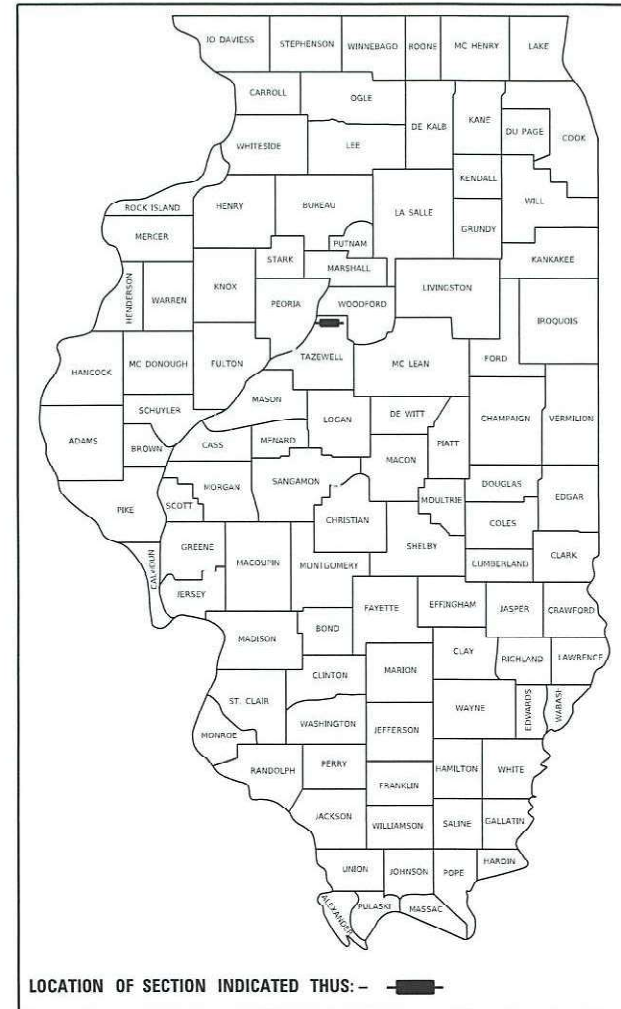

**PROJECT DESCRIPTION:**

PARTIAL DEPTH PATCHING ON US 24 /US 150 FROM THE EAST END OF THE MCCLUGGAGE BRIDGE TO EAST OF HOLLANDS GROVE ROAD IN TAZEWELL COUNTY.

STATE OF ILLINOIS  
 DEPARTMENT OF TRANSPORTATION

SUBMITTED Mar 12, 2021  
Kensel A. Barnett RSD  
 REGION THREE ENGINEER

May 7, 2021 [Signature]  
 ENGINEER OF DESIGN AND ENVIRONMENT

May 7, 2021 [Signature]  
 DIRECTOR OF HIGHWAYS PROJECT IMPLEMENTATION 13

**PRINTED BY THE AUTHORITY  
 OF THE STATE OF ILLINOIS**

GROSS LENGTH = 12,721.00 FT. = 2.409 MILE  
 NET LENGTH = 12,721.00 FT. = 2.409 MILE

**GENERAL NOTES:****107.00 COMMITMENTS**

Commitments are not to be altered without the written approval of all parties to which the commitment was made.

**THERE ARE NO COMMITMENTS INCLUDED IN THIS CONTRACT.**

**107.09A CONSECUTIVE SIDE STREET (ROAD) CLOSURE – PROHIBITED**

1. No two consecutive side streets (roads) may be closed at the same time during construction. The Contractor must alternate streets (roads).
2. Adjacent sideroads will not be closed simultaneously. BLR Standard 21 shall be used for all local road closures without any entrances within the closed area. BLR Standard 22 can be used where it is necessary to allow local traffic access.

**204.00 ENVIRONMENTAL REVIEWS**

Prior to the use of any proposed borrow areas, use areas (temporary access roads, detours, run-arounds, etc.) and/or waste areas, the Contractor shall file the required environmental resource request surveys according to Section 107.22 of the Standard Specifications. These surveys are required in order for the Department to conduct cultural and biological resource surveys for the proposed site.

The required environmental resource documentation shall include the following:

- \* BDE Form 2289 (Borrow Site Review)
- \* BDE Form 2290 (Waste/Use Area Review)
- \* A location map showing the size limits and location of the use area
- \* Color photographs depicting the use area
- \* Borrow Area Entry Agreement form – D4 PI0101

Prior to any waste materials being removed from the construction site the required environmental resource surveys shall be obtained and filed by the Contractor. Excess waste products removed from the construction site shall be disposed of as required in Section 202.03 of the Standard Specifications.

Any protruding metal bars shall be removed prior to the disposal of broken concrete at approved disposal sites.

Please note that a minimum of four weeks shall be allowed for the District to obtain the required waste site environmental clearances and six weeks for the required borrow site environmental clearances.

**701.01 ADDITIONAL SUPPLEMENTAL TRAFFIC CONTROL**

The Department reserves the right at any time to add additional Traffic Control Systems or devices within the active contract limits, by means of an additional contract. All terms of Article 105.08 of the Standard Specifications shall be followed by each Contractor.

**HOT-MIX ASPHALT MIXTURE REQUIREMENTS**

The following mixture requirements are applicable for this project:

Mixture Use(s):	Partial Depth Patch 4" (Two 2" lifts)			
AC/PG:	PG 64-22			
Design Air Voids:	4.0% @ N=50			
Mixture Composition: (Mixture Gradation)	IL 9.5			
Friction Aggregate:	Mix D			
Quality Management Program:	QC/QA			

Note:

- 1) Individual lift thickness of each mix type will be no less than 3 times nominal maximum aggregate size and no more than 6 times nominal maximum aggregate size, unless otherwise approved by the Engineer.
- 2) For design purposes, mixture weight for all mixes is determined to be 112.0 lb/s.y./in., unless otherwise noted.
- 3) Sublot sizes for PFP and QCP mixes will be 1000 tons, unless otherwise agreed to by the Engineer and the paving contractor.

MODEL: Default  
 FILE NAME: \pww\hamon.dwt\Illinois.gov\PWDOT\Documents\DOT\_Office\District 4\Projects\SOULAD\_AUS\_24\_Patch\10524-1cht-cover-notes.dgn

USER NAME = SUSER\$	DESIGNED -	REVISED -
	DRAWN -	REVISED -
PLOT SCALE = 1:100	CHECKED -	REVISED -
PLOT DATE = 3/19/2021	DATE -	REVISED -

**STATE OF ILLINOIS  
DEPARTMENT OF TRANSPORTATION**

**GENERAL NOTES AND MIX REQUIREMENTS**

SCALE: SHEET 1 OF 1 SHEETS STA. TO STA.

F.A.P. RTE.	SECTION	COUNTY	TOTAL SHEETS	SHEET NO.
317	16PP:17PP-1	TAZEWELL	10	2
CONTRACT NO. 68G26				
ILLINOIS FED. AID PROJECT				

MODEL Default  
 FILE: \\server\com\dell\inos\p\DOT\Documents\DOT - District 4\Projects\SDM00\_4\US\_24\_Paving\US24-att-500.dgn

CODE NO.	ITEM	UNIT	TOTAL QUANTITY	CONST. CODE
				0006 PATCHING URBAN 100% STATE TAZEWELL CO.
67100100	MOBILIZATION	L SUM	1	1
70300100	SHORT-TERM PAVEMENT MARKING	FOOT	692	692
70300150	SHORT TERM PAVEMENT MARKING REMOVAL	SQ FT	231	231
* 78001100	PAINT PAVEMENT MARKING - LETTERS AND SYMBOLS	SQ FT	32	32
* 78001110	PAINT PAVEMENT MARKING - LINE 4"	FOOT	3576	3576
* 78001130	PAINT PAVEMENT MARKING - LINE 6"	FOOT	1040	1040
* 78001140	PAINT PAVEMENT MARKING - LINE 8"	FOOT	246	246
X0556100	PARTIAL DEPTH PATCHING (SPECIAL)	SQ YD	4333	4333
X4421000	PARTIAL DEPTH PATCHING	TON	971	971
X7010216	TRAFFIC CONTROL AND PROTECTION (SPECIAL)	L SUM	1	1
70107025	CHANGEABLE MESSAGE SIGN	CAL DA	28	28

\*= SPECIALTY ITEM

USER NAME = *USER*	DESIGNED -	REVISED -
	DRAWN -	REVISED -
PLOT SCALE = 1/100	CHECKED -	REVISED -
PLOT DATE = 3/19/2021	DATE -	REVISED -

**STATE OF ILLINOIS  
 DEPARTMENT OF TRANSPORTATION**

**SUMMARY OF QUANTITIES**

F.A.P. RTE.	SECTION	COUNTY	TOTAL SHEETS	SHEET NO.
317	16PP:17PP-1	TAZEWELL	10	3
				CONTRACT NO. 68G26
ILLINOIS FED. AID PROJECT				



MODEL: Default  
 FILE NAME: p:\illinois\dot\Documents\DOT - Office\District 4\Projects\US24 Patching\US24 Patch Schedule.dgn

LOCATION	PARTIAL DEPTH PATCHING (SPECIAL)			
	TYPE I	TYPE II	TYPE III	TYPE IV
	DRIVING LN	DRIVING LN	DRIVING LN	DRIVING LN
	SQ. YD.	SQ. YD.	SQ. YD.	SQ. YD.
<b>RAMPS</b>				
Ramp B		10.67		
		10.67		
		10.67		
Ramp C		10.67		
			17.78	
			10.67	
				44.44
Ramp D				26.67
		10.67		
		10.67		
		10.67		44.44
				44.44
(Ramp split)				28.44
			21.33	
			21.33	
			17.78	
		10.67		
		10.67		
		10.67		
			17.78	
		10.67		
		8.89		
	4.00			
	4.00			
Ramp E				
			21.33	
			21.33	
			21.33	
Ramp F				
		14.22		
		14.22		
Ramp G				
			17.78	
		11.11		
		10.67		
		10.67		
				44.44
				44.44
(090-0069) Along Shoulder				26.67
			17.78	
Ramp H				
				33.33
				44.44
		10.67		
				26.67
(Merge with ramp G)				
		10.67		
			21.33	
				44.44
(Outside shoulder)				44.44
				28.44
		10.67		
(Merge with WB US 150)				28.44
		11.11		
SUB-TOTAL	12.0	294.2	256.0	582.7
WINTER BREAK UP (5%)	0.6	14.7	12.8	29.1
<b>RAMPS SUBTOTAL</b>	<b>13</b>	<b>309</b>	<b>269</b>	<b>612</b>
<b>TOTAL</b>	<b>SEE PATCHING SCHEDULE FOR TOTALS</b>			

JOBSITE			
LOCATION	MOBILIZATION	TRAFFIC CONTROL AND PROTECTION, (SPECIAL)	CHANGEABLE MESSAGE SIGN*
	L SUM	L SUM	CAL DAY
JOBSITE	1	1	28
<b>TOTAL</b>	<b>1</b>	<b>1</b>	<b>28</b>

\*2 Changeable Message Boards at 14 days each.

PAVEMENT MARKING							
LOCATION	SHORT TERM PAVEMENT MARKING	SHORT TERM PAVEMENT MARKING REMOVAL	PAINT PAVEMENT MARKING - LETTERS AND SYMBOLS	PAINT PAVEMENT MARKING - LINE 4"		PAINT PAVEMENT MARKING - LINE 6"	PAINT PAVEMENT MARKING - LINE 8"
				SOLID	SOLID	SKIP DASH	SOLID
				WHITE SQ FT	YELLOW FOOT	WHITE FOOT	WHITE FOOT
<b>EASTBOUND US 24 / US 150</b>							
RAMP A (EB US 24 TO WB IL 116)							
TO	12.0	4.0		31.0	25.0	20.0	
SN 090-0071 (EB US 24 OVER IL 116)							
TO	20.0	6.7		22.0	22.0	30.0	
SN 090-0073 (EB US 24 OVER RAMP G)							
TO	52.0	17.3		78.0	84.0	70.0	
RAMP D (EB IL 116 TO EB US 24)							
TO	172.0	57.3	15.6	181.0	213.0	260.0	46.0
COLLEGE DRIVE							
TO	80.0	26.7	15.6	68.0	84.0	100.0	200.0
GROSENBACH ROAD							
TO	32.0	10.7		24.0	24.0	40.0	
HOLLANDS GROVE ROAD							
<b>EASTBOUND US 24 / US 150 SUBTOTAL</b>	<b>368.0</b>	<b>122.7</b>	<b>31.2</b>	<b>404.0</b>	<b>452.0</b>	<b>520.0</b>	<b>246.0</b>
<b>WESTBOUND US 24 / US 150</b>							
HOLLANDS GROVE ROAD							
TO	32.0	10.7		42.0	42.0	40.0	
GROSENBACH ROAD							
TO	16.0	5.3		20.0	40.0	20.0	
COLLEGE DRIVE							
TO	132.0	44.0		157.0	176.0	210.0	
RAMP E (WB US 24 TO EB IL 116)							
TO	32.0	10.7		82.0	162.0	80.0	
SN 090-0073 (WB US 24 OVER RAMP G)							
TO	44.0	14.7		73.0	130.0	70.0	
SN 090-0072 (WB US 24 OVER IL 116)							
TO	32.0	10.7		42.0	92.0	50.0	
RAMP G (WB IL 116 TO WB US 24)							
TO	36.0	12.0		42.0	48.0	50.0	
ILLINOIS RIVER BRIDGE							
<b>WESTBOUND US 24 / US 150 SUBTOTAL</b>	<b>324.0</b>	<b>108.0</b>	<b>0.0</b>	<b>458.0</b>	<b>690.0</b>	<b>520.0</b>	<b>0.0</b>
<b>RAMPS</b>							
RAMP B				24.0	24.0		
RAMP C				65.0	65.0		
RAMP D				192.0	192.0		
RAMP E				60.0	60.0		
RAMP F				26.0	26.0		
RAMP G				152.0	152.0		
RAMP H				267.0	267.0		
<b>RAMPS SUBTOTAL</b>	<b>0.0</b>	<b>0.0</b>	<b>0.0</b>	<b>786.0</b>	<b>786.0</b>	<b>0.0</b>	<b>0.0</b>
<b>JOB SUBTOTAL</b>	<b>692.0</b>	<b>230.7</b>	<b>31.2</b>	<b>1,648.0</b>	<b>1,928.0</b>	<b>1,040.0</b>	<b>246.0</b>
<b>TOTAL</b>	<b>692.0</b>	<b>231.0</b>	<b>32.0</b>	<b>3,576.0</b>	<b>3,576.0</b>	<b>1,040.0</b>	<b>246.0</b>

USER NAME = \$USERS	DESIGNED -	REVISED -
	DRAWN -	REVISED -
PLOT SCALE = 1:100	CHECKED -	REVISED -
PLOT DATE = 3/19/2021	DATE -	REVISED -

**STATE OF ILLINOIS  
DEPARTMENT OF TRANSPORTATION**

**SCHEDULE OF QUANTITIES**

SCALE: SHEET 2 OF 2 SHEETS STA. TO STA.

F.A.P. RTE.	SECTION	COUNTY	TOTAL SHEETS	SHEET NO.
317	16PP;17PP-1	TAZEWELL	10	5
CONTRACT NO. 68G26				
ILLINOIS FED. AID PROJECT				

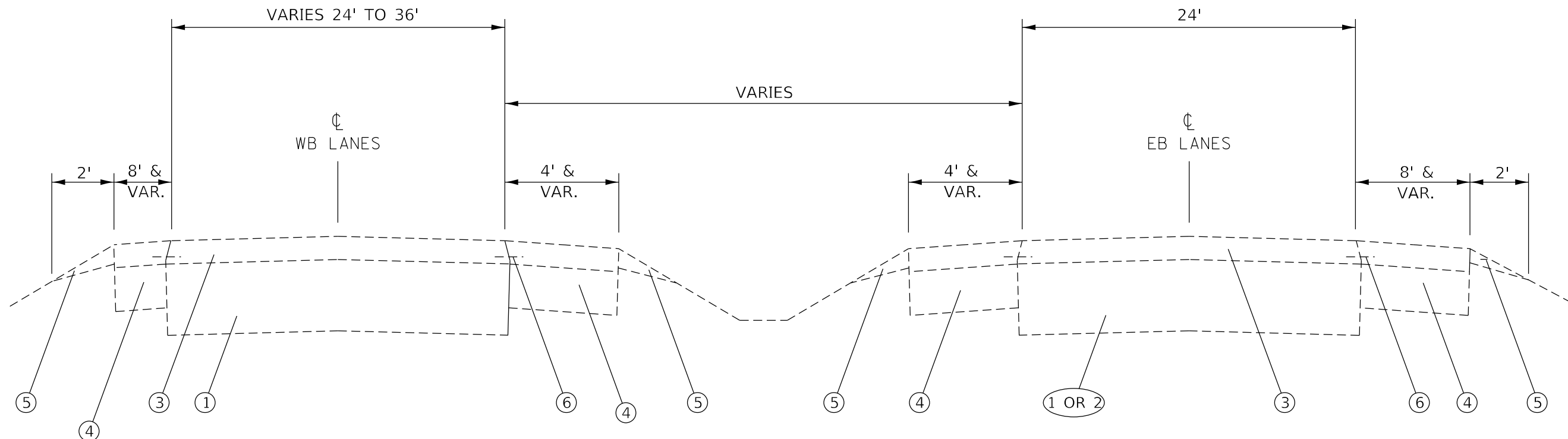

US 24 / US 150  
 WB STA. 246+29 TO STA. 265+00  
 WB & EB STA. 265+00 TO 373+50  
 (GUARDRAIL AND TURNLANES NOT SHOWN)

**LEGEND**

- ① EXIST. P.C.C. PAVEMENT 10"
- ② EXIST. BIT. CONCRETE 14" (EB STA. 352+00 TO 373+50)
- ③ EXIST. BIT. CONCRETE OVERLAY (SEE BREAKDOWN BELOW)
- ④ EXIST. BIT. SHOULDER WITH OVERLAYS
- ⑤ EXIST. AGGREGATE SHOULDER
- ⑥ EXIST. STRIP REFLECT. CRACK CONT. TREAT (INTERMITTENT)

③ ESTIMATED SURFACE THICKNESS, BASED ON OLD PLANS.  
 THICKNESS DOES NOT ACCOUNT FOR EXISTING PATCHES.

<b>2.0-2.5" HMA:</b> WB STA. 342+00 TO 346+00 EB STA. 346+00 TO 352+00	<b>4.25"-4.75" HMA:</b> WB & EB STA. 246+29 TO 253+38 EB STA. 288+00 TO 303+50 EB STA. 352+00 TO 373+50 WB STA. 346+00 TO 373+50
<b>3.25" HMA:</b> EB STA. 253+38 TO 288+00 EB STA. 305+10 TO 342+63 WB STA. 253+38 TO 342+00	<b>6.0"-7.0" HMA:</b> EB STA. 303+50 TO 305+10 EB STA. 342+63 TO 346+00

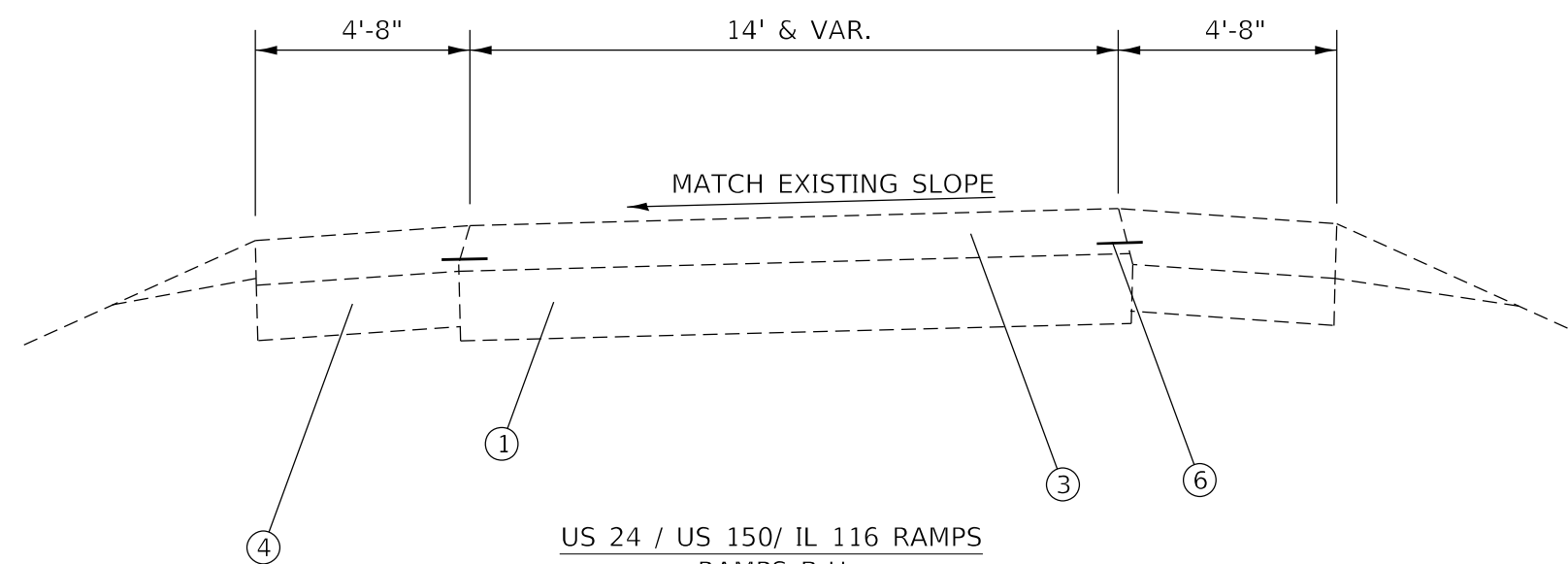

US 24 / US 150 / IL 116 RAMPS  
 RAMPS B-H  
 (GUARDRAIL NOT SHOWN)

DRAWING NOT TO SCALE

MODEL: Default  
 FILE NAME: p:\pub\amr\room.dwt\illinois.gov\PIWDOT\Documents\DOT\_Offices\District\_4\Projects\US150\US24\ch-line-typrical-detail.dgn

USER NAME = \$USERS	DESIGNED -	REVISED -
PLOT SCALE = 1:100	DRAWN -	REVISED -
PLOT DATE = 3/19/2021	CHECKED -	REVISED -
	DATE -	REVISED -

STATE OF ILLINOIS  
 DEPARTMENT OF TRANSPORTATION

**TYPICAL SECTIONS**

SCALE: SHEET 1 OF 1 SHEETS STA. TO STA.

F.A.P. RTE.	SECTION	COUNTY	TOTAL SHEETS	SHEET NO.
317	16PP:17PP-1	TAZEWELL	10	6
CONTRACT NO. 68G26				
ILLINOIS FED. AID PROJECT				

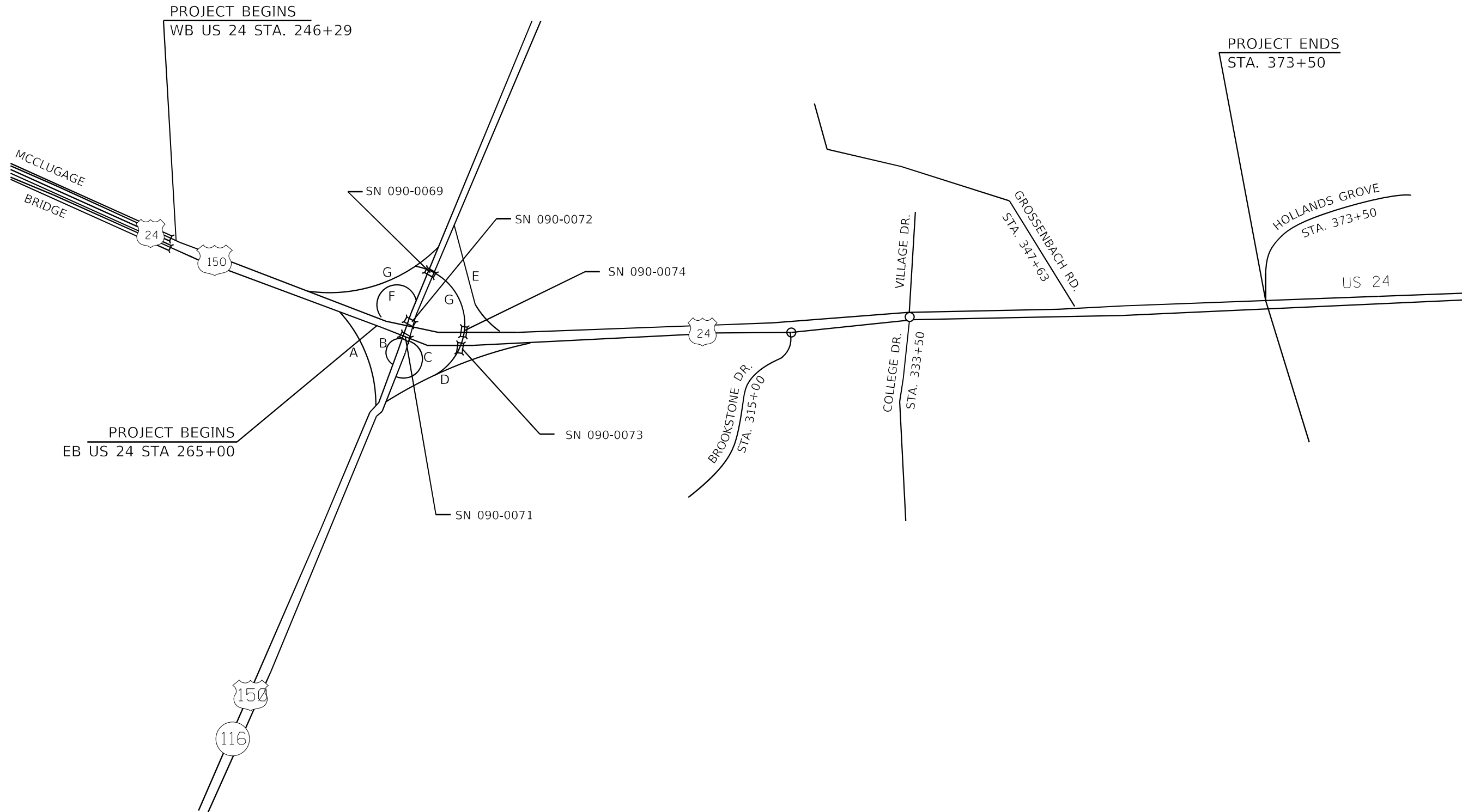

MODEL: Default  
 FILE NAME: p:\pub\mroom.dwg  
 PROJECT: ILLINOIS DOT  
 OFFICE: DISTRICT 4  
 PROJECT: US 24  
 DATE: 3/19/2021

USER NAME = \$USERS	DESIGNED -	REVISED -
PLOT SCALE = 1:100	DRAWN -	REVISED -
PLOT DATE = 3/19/2021	CHECKED -	REVISED -
	DATE -	REVISED -

**STATE OF ILLINOIS  
DEPARTMENT OF TRANSPORTATION**

**LINE DIAGRAM**

SCALE: SHEET 1 OF 1 SHEETS STA. TO STA.

F.A.P. RTE.	SECTION	COUNTY	TOTAL SHEETS	SHEET NO.
317	16PP;17PP-1	TAZEWELL	10	7
CONTRACT NO. 68G26				
ILLINOIS FED. AID PROJECT				



**DETAIL A**

DETAIL A:

LANE CLOSURES REQUIRED FOR WORK IN THE SHADED AREAS AS SHOWN FOR EASTBOUND TRAFFIC SHALL COMMENCE WITH THE TAPER PLACED ON OR BEFORE THE CREST OF THE MCCLUGAGE BRIDGE.



**DETAIL B**

DETAIL B:

LANE CLOSURES REQUIRED FOR WORK IN THE SHADED AREAS AS SHOWN FOR EASTBOUND TRAFFIC SHALL COMMENCE WITH THE TAPER PLACED EAST OF THE EXIT RAMP TO EB IL 116.

MODEL: Default  
 FILE NAME: p:\data\baronm.dwg  
 ILLINOIS DOT Documents\DOT Office\District 4\Projects\SOI\AD\_AUS 24 Data\img\US24-chn-line-traffic-detail.dwg

USER NAME = \$USERS	DESIGNED -	REVISED -
	DRAWN -	REVISED -
PLOT SCALE = 1:100	CHECKED -	REVISED -
PLOT DATE = 3/19/2021	DATE -	REVISED -

**STATE OF ILLINOIS  
DEPARTMENT OF TRANSPORTATION**

**TRAFFIC CONTROL AND PROTECTION DETAIL**

SCALE: SHEET 1 OF 1 SHEETS STA. TO STA.

F.A.P. RTE.	SECTION	COUNTY	TOTAL SHEETS	SHEET NO.
317	16PP:17PP-1	TAZEWELL	10	8
CONTRACT NO. 68G26				
ILLINOIS FED. AID PROJECT				



DESIGNER NOTES:  
1. Include State Standard 780001 (Typical Pavement Markings)

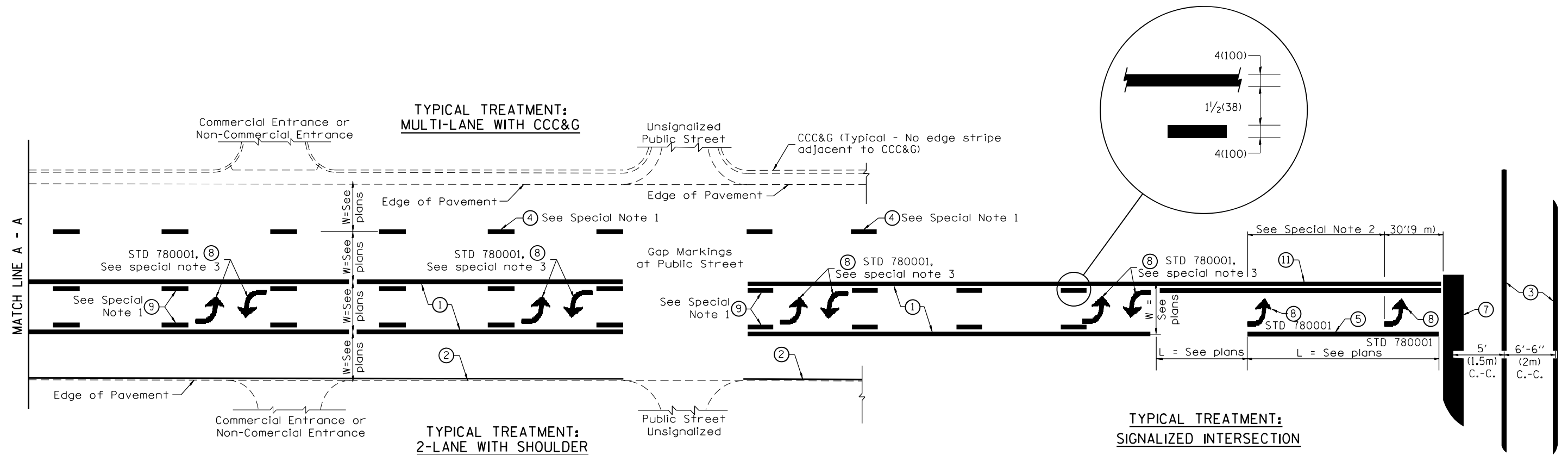

**FLUSH PAVED MEDIAN: TWO-WAY LEFT TURN LANE  
WITH ONE-WAY LEFT TURN LANE AT SIGNALIZED INTERSECTION**

**TYPICAL PAVEMENT MARKING LEGEND**

(Note: This is a District Standard Legend. Some elements may not apply to specific project.)

- ① 4(100) Solid (Yellow)
- ② 4(100) Solid (White)
- ③ 2-6(150) Crosswalk @ 6'-6" (2m)min C.-C. (White)  
2-8(200) Crosswalk @ 6'-6" (2m)min C.-C. (White) (When traffic signals are present.)
- ④ 6(150) Skip-Dash (White) (See Special Note 1)
- ⑤ 8(200) Solid (White)
- ⑥ 12(300) Diagonal (White) (Item ⑥ is shown on Std. 780001)
- ⑦ 24(600) Stop Bar (White)
- ⑧ Letters & Arrows (See Std. 780001 and Special Notes 2 & 3)
- ⑨ 4(100) Skip-Dash (Yellow) (See Special Note 1)
- ⑩ 12(300) Diagonal (Yellow) (See Table A) ⑩
- ⑪ 4(100) Double Solid (Yellow) ⑪

**SPECIAL NOTES**

1. Skip-Dash markings will be centered between both ends of city blocks and shall be placed in alignment transversely across the pavement.
2. The following shall apply to arrows located in one-way left turn lanes:
  - A. A minimum of two (2) arrows is required.
  - B. The maximum spacing between arrows is 80' (24 m).
  - C. Arrows shall be evenly spaced if three (3) or more are required.
3. The following shall apply to arrow pairs located in two-way left turn lanes:
  - A. A minimum of two (2) arrow pairs is required.
  - B. The maximum spacing between arrow pairs is 200' (61 m).
  - C. Arrow pairs shall be evenly spaced if three (3) or more are required.
  - D. The spacing between Bi Directional Left Turn Arrows is 33' (10 m).

**GENERAL NOTES**

1. Refer to State Standard 780001 for additional Pavement Markings including letters & arrows.
2. See Plans for Pavement Markings adjacent to curbed islands and medians, and through lane reductions.
3. Refer to Article 780.13 for letter, number and symbol areas (sq. ft.)
4. Areas are grooved 1" beyond each edge for the following symbols:  
Through Arrow= 14.8 sq. ft.  
Large Left or Right Arrow= 21.9 sq. ft.  
2 Arrow Combination Left (or Right) and Through= 34.9 sq. ft.  
Wrong Way Arrow= 29.5 sq. ft.  
Railroad Crossing Symbol= 69.8 sq. ft.  
(For further information, refer to BDE Special Provision: Grooving for Recessed Pavement Markings)

01-01-97	RENUM. F-8.03, NEW REVISION BOX	T.P.	10-16-06	REVISED TO 2007 SPEC.	
02-07-97	ADD BI DIRECTIONAL DIMENSION	J.A.	2/29/16	ADDED GROOVING AREAS	R.D.
10-97	CORRECT BI DIRECTIONAL DIMENSION	J.A.	07-16-19	SPELLING CORRECTIONS	R.D.
08-02	ADD CROSSWALK DMNS. WITH T.S.	M.A.			

**STATE OF ILLINOIS  
DEPARTMENT OF TRANSPORTATION**

NOT TO SCALE

**TYPICAL PAVEMENT MARKINGS**

SHT. 1 OF 2  
CADD STD. 780001-D4

F.A.P. RTE.	SECTION	COUNTY	TOTAL SHEETS	SHEET NO.
317	16PP:17PP-1	TAZEWELL	10	9
CONTRACT NO. 68G26				
ILLINOIS FED. AID PROJECT				

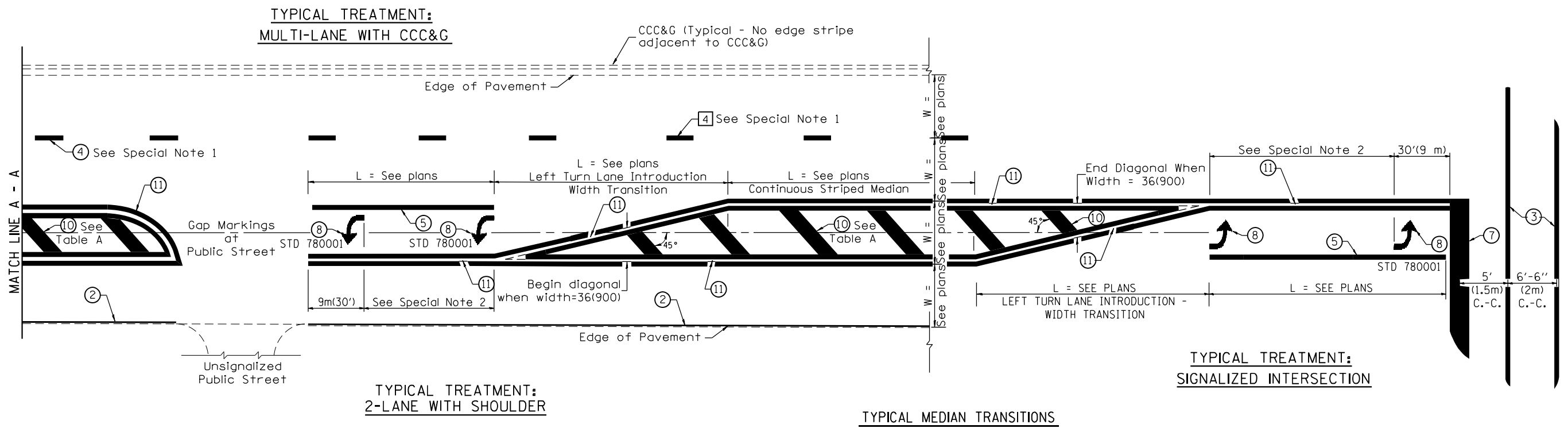

FLUSH PAVED MEDIAN: RESTRICTED LEFT TURN LANE

TABLE A  
RECOMMENDED SPACING BETWEEN DIAGONAL LINES

SPEED LIMIT RANGE	INTERSECTION CHANNELIZATION (Includes Width Transitions for Median and Left Turn Lane Introductions)	
	CONTINUOUS	
Less Than 30 mph (50 km/h)	50' (15m)	15' (5m)
30 - 45 mph (50 - 70 km/h)	75' (23m)	20' (6m)
Over 45 mph (70 km/h)	150' (46m)	30' (9m)

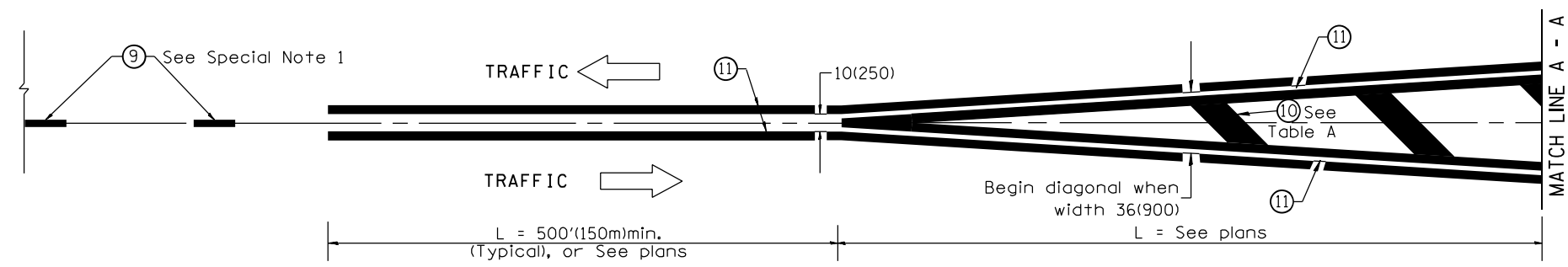

MEDIAN INTRODUCTION - WIDTH TRANSITIONS

All dimensions are in inches (millimeters) unless otherwise noted.