

PROPOSED ROADWAY LEGEND

- ① POLYMERIZED HMA SURFACE COURSE, SMA, 9.5, MIX "F", N80, 1 3/4"
- ② POLYMERIZED HMA BINDER COURSE, IL-19.0, N90, 2 1/4"
- ③ CLASS A PAVEMENT PATCH - 8" CRC
- ④ CLASS B PAVEMENT PATCH - 8" PCC
- ⑤ AGGREGATE SUBGRADE IMPROVEMENT (12")
- ⑥ AGGREGATE SHOULDER, TYPE B, 6"
- PROPOSED PAVEMENT/SHOULDER

PLAN	SURVEYED	DATE
	PLOTTED	BY
NOTE BOOK NO.	GRADES CHECKED	
	STRUCTURE NOTATIONS CHKD	

PROFILE	SURVEYED	DATE
	PLOTTED	BY
NOTE BOOK NO.	GRADES CHECKED	
	STRUCTURE NOTATIONS CHKD	

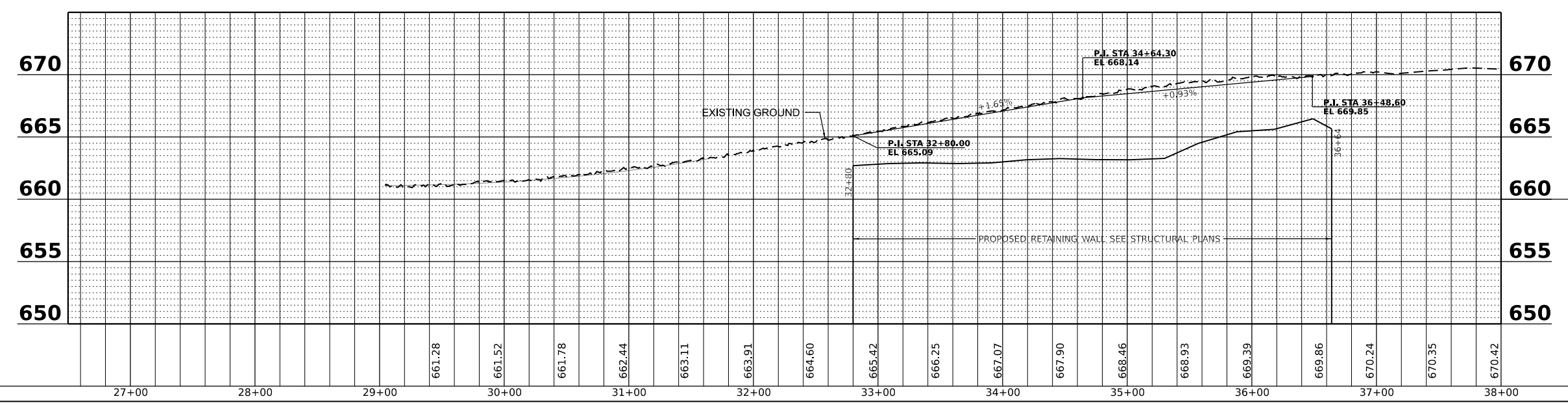
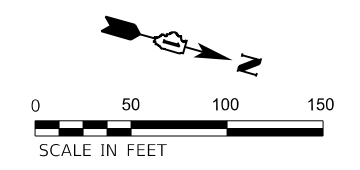
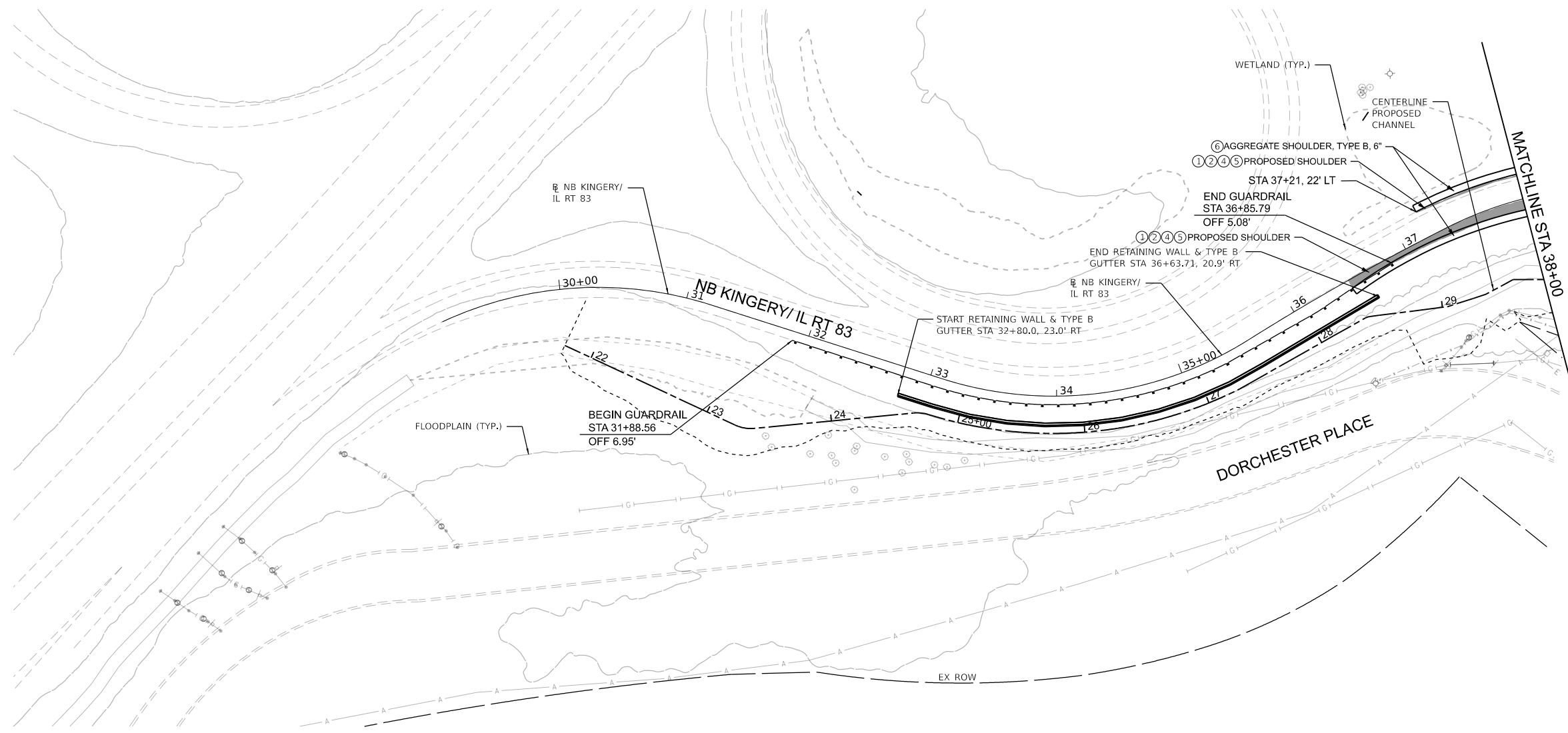

MODEL: Plan 2 (Sheet)
FILE NAME: P:\00055 - IDOT\040608-01\02 (ENG) - FTB 195-016 Phase II for VanEngineering\01 - ILS\11381500 Drawings\502 CADD Sheets\0124169-sh-PlanProfile.dgn

Bowman CONSULTING
311 S. Wacker Drive, Suite 1950
Chicago, IL 60606
312-674-6560
www.bowmanconsulting.com

USER NAME = khejtmanek	DESIGNED - KH	REVISED -
DRAWN - KM	REVISOR -	
PLOT SCALE = 0.1667' / in.	CHECKED - AP	REVISED -
PLOT DATE = 3/10/2021	DATE - 3/11/2021	REVISED -

**STATE OF ILLINOIS
DEPARTMENT OF TRANSPORTATION**

**NB KINGERY/IL RT 83
PLAN AND PROFILE**

SCALE: 1"=50' SHEET 1 OF 2 SHEETS STA. 26+50.00 TO STA. 38+00.00

F.A.P. RTE. 344	SECTION 2020-196-T	COUNTY DUPAGE	TOTAL SHEETS 122	SHEET NO. 30
CONTRACT NO. 62M69			ILLINOIS FED. AID PROJECT	