

DATE	
BY	
SURVEYED	
PLOTTED	
TEMPLATE	
AREAS	
CHECKED	
NO.	
FINAL SURVEY	
NOTE BOOK	
AREAS CHECKED	
NO.	

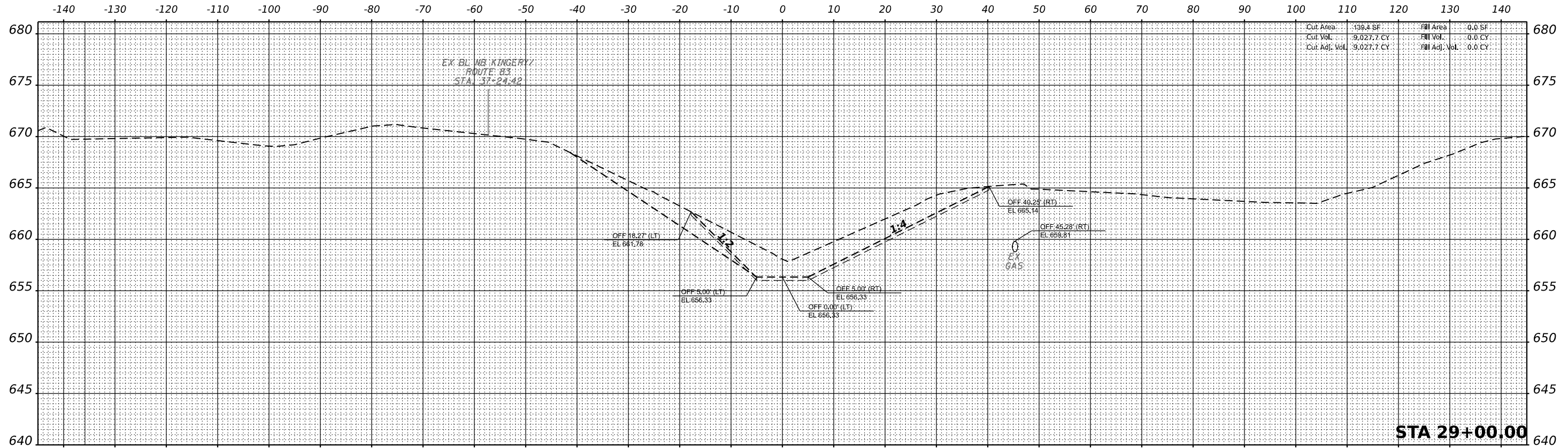

DATE	
BY	
SURVEYED	
PLOTTED	
TEMPLATE	
AREAS	
CHECKED	
NO.	
ORIGINAL SURVEY	
NOTE BOOK	
AREAS CHECKED	
NO.	

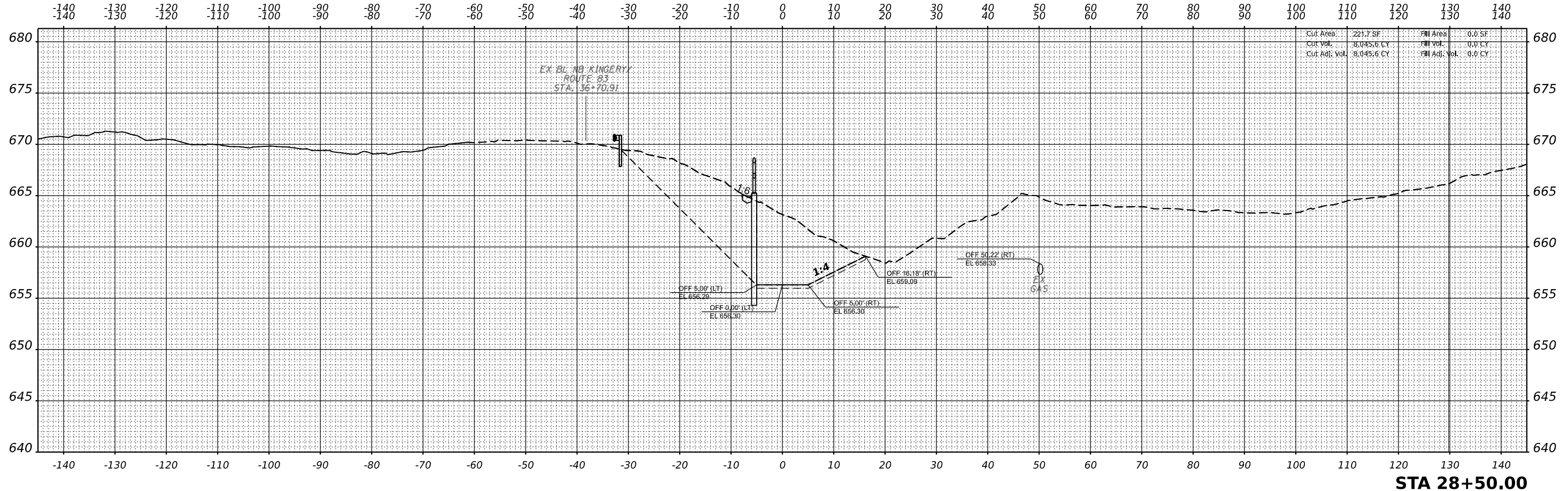

MODEL: 28+50.00 (Sheet)  
 FILE NAME: P:\02028 - DOT\040058-01-002 (ENG) - FTB 195-016 Phase II Var VanEngineering\WO 1 - I183\1138\500 Drawings\502\_CADD Sheets\02\985ent\XSPChannel.dgn



USER NAME = khejtmanek  
 DESIGNED - KH  
 DRAWN - KM  
 CHECKED - AP  
 DATE - 3/11/2021

REVISER -  
 REVISION -  
 REVISION -  
 REVISION -

STATE OF ILLINOIS  
 DEPARTMENT OF TRANSPORTATION

CROSS SECTIONS  
 PROPOSED CHANNEL

SCALE: 1" = 10'(H)  
 1" = 5'(V)  
 SHEET 8 OF 17 SHEETS  
 STA. 28+50.00 TO 29+00.00

F.A.P. RTE.	SECTION	COUNTY	TOTAL SHEETS	SHEET NO.
344	2020-196-T	DUPAGE	122	84
CONTRACT NO. 62M69				
ILLINOIS FED. AID PROJECT				