

F.A.U. RTE.	SECTION	COUNTY	TOTAL SHEETS	SHEET NO.
9177	19-00007-06-RS	ST. CLAIR	15	1
		ILLINOIS	CONTRACT NO. 97756	

06-11-2021 LETTING ITEM 200

**INDEX OF SHEETS**

- 1 COVER SHEET
- 2 GENERAL NOTES, HIGHWAY STANDARDS, COMMITMENTS
- 3-4 SUMMARY OF QUANTITIES
- 5-7 TYPICAL SECTIONS
- 8 SCHEDULE OF QUANTITIES
- 9 LOCATION MAP
- 10 INTERSECTION DETAILS - SEIBERT ROAD & MAIN STREET
- 11 CROSSWALK - BUTT JOINT DETAIL
- 12 INTERSECTION DETAILS - SEIBERT ROAD & KATHY DRIVE
- 13 CURB RAMP DETAILS (KATHY DRIVE)
- 14 CURB RAMP DETAILS (SOUTHRIDGE DRIVE)
- 15 MISCELLANEOUS DETAILS

**STATE OF ILLINOIS  
DEPARTMENT OF TRANSPORTATION  
STP FUNDS**

**PROPOSED  
HIGHWAY PLANS**

**VILLAGE OF SHILOH  
FAU ROUTE 9177 (SEIBERT ROAD)  
SECTION 19-00007-06-RS  
PROJECT XAJN(076)  
HMA RESURFACING  
ST. CLAIR COUNTY**

C-98-009-23

R 7 W

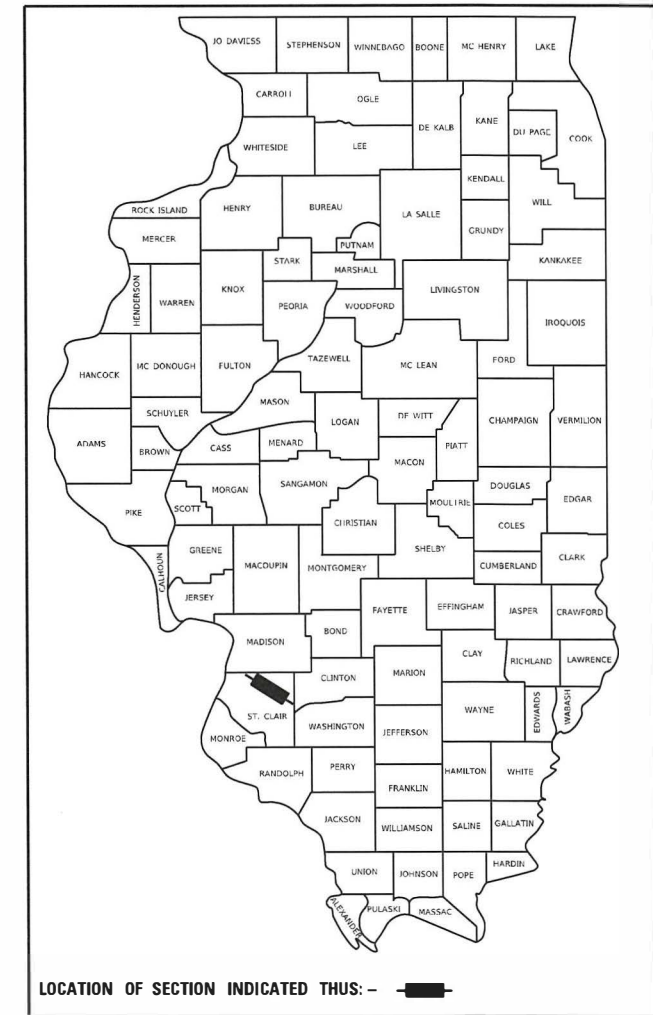

FOR LIST OF HIGHWAY STANDARDS, SEE SHEET NO. 2

**DESIGN DESIGNATION**

CLASSIFICATION: MAJOR COLLECTOR  
DESIGN SPEED: 30 MPH  
CURRENT ADT (2020): 3950  
DESIGN YEAR ADT (2040): 5320

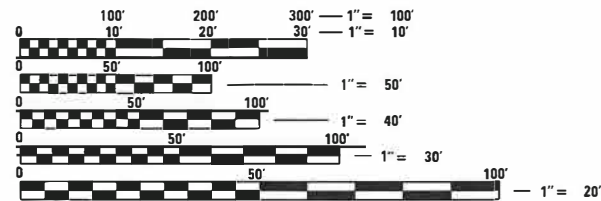

FULL SIZE PLANS HAVE BEEN PREPARED USING STANDARD ENGINEERING SCALES. REDUCED SIZED PLANS WILL NOT CONFORM TO STANDARD SCALES. IN MAKING MEASUREMENTS ON REDUCED PLANS, THE ABOVE SCALES MAY BE USED.

J.U.L.I.E.  
JOINT UTILITY LOCATION INFORMATION FOR EXCAVATION  
1-800-892-0123  
OR 811

**PROJECT MANAGER: TIMOTHY PADGETT**  
**CONTRACT NO. 97756**

**BEGIN IMPROVEMENT  
STA. 0 + 17.00**

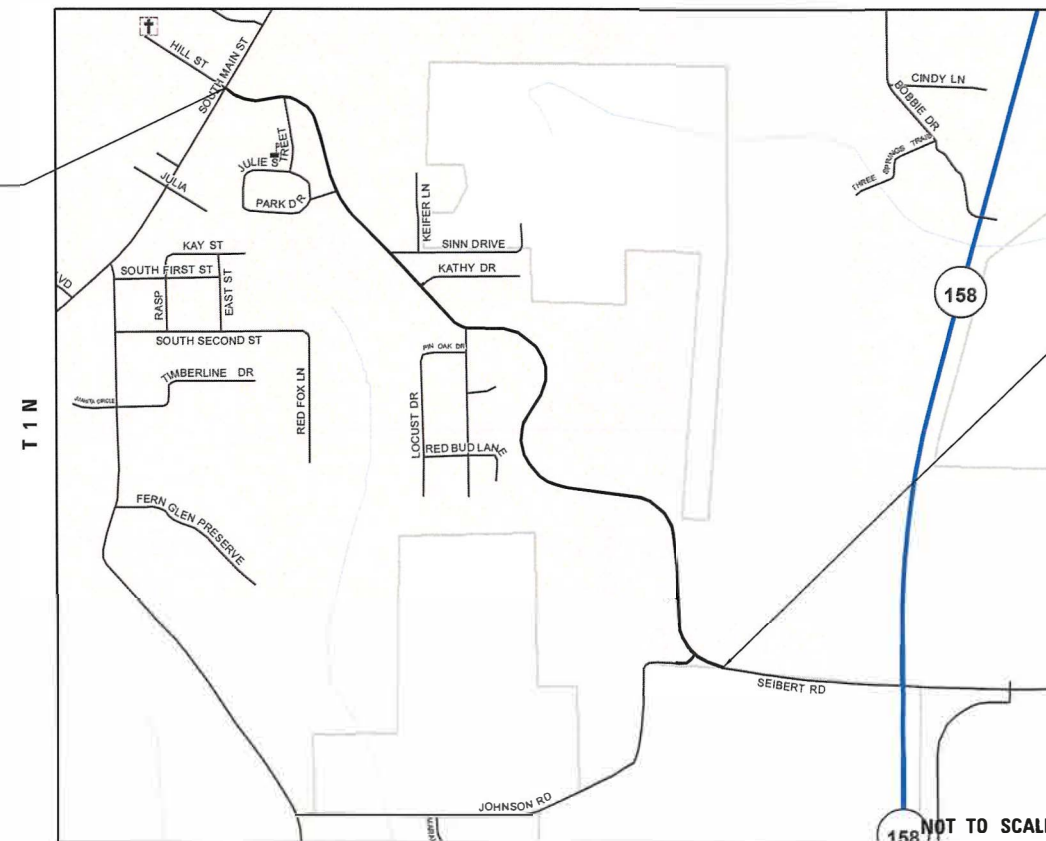

**END IMPROVEMENT  
STA. 58 + 13.25**

GROSS LENGTH = 5796.25 FT. = 1.098 MILE

NET LENGTH = 5796.25 FT. = 1.098 MILE



*Timothy Padgett 3/25/2021*  
TIMOTHY B. PADGETT, PE EXPIRATION DATE  
LICENSE NO. 062-049162 11-30-2021

VILLAGE OF SHILOH	
APPROVED	March 24 20 21 <i>James A. Vornia II</i> VILLAGE OF SHILOH, MAYOR
PASSED	April 6 20 21 <i>Timothy Padgett</i> DISTRICT 8 ENGINEER OF LOCAL ROADS & STREETS for Project Implementation Engineer
RELEASING FOR BID BASED ON LIMITED REVIEW	April 6 20 21 <i>Keith Roberts</i> REGION FIVE ENGINEER

**PRINTED BY THE AUTHORITY  
OF THE STATE OF ILLINOIS**



PLANS PREPARED BY:  
4940 Old Collinsville Road  
Swansea, Illinois 62226  
Tel: 618.624.4488  
www.twm-inc.com  
Illinois Professional Design Firm  
No. 184-001220  
License Expires: 4/30/2021  
ILLINOIS - MISSOURI - TENNESSEE

## GENERAL

FOR CODED PAY ITEM DESCRIPTIONS, INCLUDED ITEMS, AND ALL MATERIAL SPECIFICATIONS, PLEASE REFER TO THE LATEST EDITION OF THE IDOT STANDARD SPECIFICATIONS FOR ROAD AND BRIDGE CONSTRUCTION.

WHERE SECTION OR SUBSECTION MONUMENTS ARE ENCOUNTERED, THE ENGINEER SHALL BE NOTIFIED BEFORE SUCH MONUMENTS ARE REMOVED. THE CONTRACTOR SHALL PROTECT AND CAREFULLY PRESERVE ALL PROPERTY MARKERS AND MONUMENTS UNTIL THE OWNER AND AN AUTHORIZED SURVEYOR OR AGENT, HAVE WITNESSED OR OTHERWISE REFERENCED THEIR LOCATION.

THE CONTRACTOR IS RESPONSIBLE FOR CONTACTING THE VILLAGE OF SHILOH AT LEAST FORTY-EIGHT (48) HOURS IN ADVANCE PRIOR TO COMMENCEMENT OF ANY CONSTRUCTION ACTIVITIES OR WORK REQUIRING INSPECTION OR APPROVAL BY THE AFFECTED UNITS OF GOVERNMENT.

ANY REFERENCE TO AN IDOT HIGHWAY STANDARD IN THESE PLANS SHALL BE INTERPRETED TO MEAN THE EDITION, AS INDICATED BY THE SUB-NUMBER LISTED IN THE INDEX OF SHEETS, OR THE COPY OF THE STANDARD INCLUDED IN THESE PLANS.

IT IS NOT WARRANTED THAT THIS DOCUMENT CONTAINS COMPLETE INFORMATION REGARDING EASEMENTS, RESERVATIONS, RESTRICTIONS, RIGHT-OF-WAYS, BUILDING LINE SETBACKS, AND OTHER ENCUMBRANCES. FOR COMPLETE INFORMATION, A TITLE OPINION OR COMMITMENT FOR TITLE INSURANCE SHOULD BE OBTAINED AND THOROUGHLY REVIEWED.

EXCESS BITUMEN REMOVAL SHALL BE PAID FOR ACCORDING TO ARTICLE 109.04 OF THE STANDARD SPECIFICATIONS.

MIXTURES FOR JOINTS, CRACKS, AND FLANGWAYS SHALL BE PAID FOR ACCORDING TO ARTICLE 109.04 OF THE STANDARD SPECIFICATIONS.

THE USE OF VIBRATORY ROLLERS IS PROHIBITED IN RESIDENTIAL AREAS. THIS DOES NOT RELIEVE THE CONTRACTOR OF DENSITY REQUIREMENTS FOR THE BITUMINOUS PAVEMENTS AS SPECIFIED IN THE APPROPRIATE SECTIONS OF THE STANDARD SPECIFICATIONS.

THE THICKNESS OF BITUMINOUS SURFACE REMOVAL IS THE REMOVAL DEPTH AT THE CENTERLINE AND EDGE OF PAVEMENT. AN ESTIMATED 1979 TONS OF BITUMINOUS SURFACE WILL BE REMOVED.

ALL TEMPORARY PAVEMENT MARKINGS WILL BE PLACED IN SUCH A MANNER SO AS NOT TO INTERFERE WITH THE PLACEMENT OF PERMANENT PAVEMENT MARKINGS.

ALL PATCHING ON THIS PROJECT SHALL BE COMPLETED PRIOR TO BITUMINOUS SURFACE REMOVAL.

ALL SURPLUS EXCAVATION DUE TO THE RECONSTRUCTION OF THE CURB RAMPS, CURB & GUTTER AND SIDEWALKS MUST REMAIN ON THE PROJECT SITE. THE CONTRACTOR SHALL GRADE THE DISPOSED EXCAVATION TO THE SATISFACTION OF THE ENGINEER AND THE AREA MUST BE SEEDED, FERTILIZED, AND MULCHED.

THE EXISTING CROSSWALK ON SEIBERT ROAD AT JOHNSON STREET SHALL NOT BE REPLACED.

PROPOSED PAVEMENT MARKINGS SHALL MATCH EXISTING LOCATIONS AS DIRECTED BY THE ENGINEER.

## UTILITIES

UNLESS NOTED OTHERWISE, THE TYPE, SIZE, DEPTH AND LOCATION OF EXISTING GAS MAINS, SEWERS, ELECTRIC POWER LINES, TELEPHONE LINES AND OTHER UTILITIES AS DELINEATED ON THE PLANS HAVE BEEN DETERMINED BY REVIEW OF AVAILABLE EXISTING "AS-BUILT" OR RECORD DRAWINGS, FIELD SURVEY OF J.U.L.I.E. MARKED UTILITIES, OR FIELD SURVEY OF ABOVE GROUND SURFACE UTILITY FEATURES. THE OWNER AND ENGINEER HAVE NOT UNDERTAKEN SUBSURFACE EXPLORATORY INVESTIGATIONS TO CONFIRM OR VERIFY THE UTILITIES SHOWN ON THESE PLANS; THEREFORE THEIR EXACT LOCATION, SIZE AND FUNCTION MUST BE CONSIDERED APPROXIMATE. THE EXISTING LOCATION OF ALL UNDERGROUND ELECTRIC, UNDERGROUND TELEPHONE, CABLE, SANITARY SEWER LINES, AND UNDERGROUND GAS LINES HAVE BEEN APPROXIMATED AT MINIMUM DEPTHS OF 30", 24", 24", 30", AND 30"-54"; RESPECTIVELY.

THE ENGINEER AND OWNER FURTHER DO NOT WARRANT THAT ALL UTILITIES HAVE BEEN ILLUSTRATED ON THE DOCUMENTS. THE CONTRACTOR IS SOLELY RESPONSIBLE FOR CONTACTING J.U.L.I.E. FOR FIELD VERIFICATION OF ALL UTILITIES ON THE SITE PRIOR TO COMMENCEMENT OF CONSTRUCTION. IF THE CONTRACTOR DETERMINES THAT SUBSTANTIAL DISCREPANCY EXISTS BETWEEN FIELD VERIFIED UTILITIES AND THESE PLANS, WHICH WOULD SIGNIFICANTLY AFFECT THE FUNCTION, COST, OR PERFORMANCE OF THE PROJECT, THE CONTRACTOR SHALL IMMEDIATELY CONTACT THE ENGINEER FOR CLARIFICATION AND PROJECT DIRECTION.

## TRAFFIC CONTROL

NO OVERNIGHT LANE CLOSURES WILL BE PERMITTED.

IF THE HMA SURFACE REMOVAL ON THIS PROJECT PRODUCES A MILLED EDGE ANYWHERE GREATER THAN 1.5 INCHES BETWEEN ADJACENT OPEN LANES OF TRAFFIC, ONE OF THE FOLLOWING SHALL APPLY:

- THE CONTRACTOR SHALL ORGANIZE THE WORK TO AVOID THE MILLED EDGE.
  - THE CONTRACTOR SHALL CONSTRUCT A TEMPORARY HOT MIX ASPHALT WEDGE MINIMUM 1:3) ALONG THE MILLED EDGE.
  - THE CONTRACTOR SHALL CONSTRUCT A MILLED SLOPED EDGE (MINIMUM 1:3 LONG THE MILLED EDGE.
- THE COST OF THIS WORK SHALL BE INCLUDED IN THE COST PER SQUARE YARD OF HOT-MIX ASPHALT SURFACE REMOVAL OF THE DEPTH SPECIFIED.

DURING THE CONSTRUCTION OF KATHY DRIVE INTERSECTION, INGRESS AND EGRESS ACCESS SHALL BE MAINTAINED AT ALL TIMES.

IF THE WORK ON THIS PROJECT PRODUCES AN OVERNIGHT DROP-OFF AT THE EDGE OF THE TRAVEL WAY 12 INCHES OR GREATER, THE FOLLOWING SHALL APPLY:

- THE CONTRACTOR SHALL ORGANIZE THE WORK TO AVOID THE DROP-OFF.
- THE CONTRACTOR SHALL FILL THE DROP-OFF TO LESS THAN 12 INCHES.

THE COST OF THIS WORK SHALL BE INCLUDED IN THE COST PER FOOT FOR COMBINATION CURB AND GUTTER REMOVAL.

## UTILITY CONTACTS

ILLINOIS STATE LAW REQUIRES A FORTY-EIGHT (48) HOUR NOTICE BE GIVEN TO ALL UTILITIES BEFORE DIGGING. FIELD MARKING OF FACILITIES MAY BE OBTAINED BY CONTACTING J.U.L.I.E. OR FOR NON-MEMBERS, THE UTILITY COMPANY DIRECTLY. AGENCIES KNOWN TO HAVE FACILITIES WITHIN THE PROJECT AREA ARE AS FOLLOWS:

AT&T (TELEPHONE)  
618-624-4004

MCI COMMUNICATIONS (TELEPHONE)  
888-624-5622

AMEREN IP (GAS & ELECTRIC)  
618-236-4337

CLEARWAVE COMMUNICATIONS (TELEPHONE)  
618-294-8000

ILLINOIS AMERICAN WATER CO. (WATER)  
618-239-3246

ADB COMPANIES (TELEPHONE)  
314-426-5200

CHARTER COMMUNICATIONS (CABLE)  
866-874-2389

VILLAGE OF SHILOH (SEWER)  
618-632-1022

FIDELITY COMMUNICATIONS (TELEPHONE)  
800-392-8070

## COMMITMENTS

COMMITMENTS FOR THIS PROJECT ARE AS FOLLOWS: NONE

## HIGHWAY STANDARDS

000001-08	STANDARD SYMBOLS, ABBREVIATIONS AND PATTERNS
001006	DECIMAL OF AN INCH AND A FOOT
424001-11	PERPENDICULAR CURB RAMPS FOR SIDEWALKS
424011-04	CORNER PARALLEL CURB RAMPS FOR SIDEWALKS
424016-05	MID-BLOCK CURB RAMPS FOR SIDEWALKS
424021-06	DEPRESSED CORNER FOR SIDEWALKS
602401-07	PRECAST MANHOLE TYPE A 4' (1.22m) DIAMETER
602601-06	PRECAST REINFORCED CONCRETE FLAT SLAB TOP
604006-05	FRAME AND GRATE TYPE 3
606001-07	CONCRETE CURB TYPE B AND COMBINATION CONCRETE CURB AND GUTTER
701001-02	OFF-ROAD OPERATIONS, 2L, 2W, MORE THAN 15' AWAY
701006-05	OFF-ROAD OPERATIONS, 2L, 2W, 15' TO 24" FROM PAVEMENT EDGE
701011-04	OFF-ROAD MOVING OPERATIONS, 2L, W2, DAY ONLY
701301-04	LANE CLOSURE, 2L, 2W, SHORT TIME OPERATIONS
701311-03	LANE CLOSURE, 2L, 2W, MOVING OPERATIONS DAY ONLY
701501-06	URBAN LANE CLOSURE, 2L, 2W, UNDIVIDED
701701-10	URBAN LANE CLOSURE, MULTILANE, INTERSECTION
701801-06	SIDEWALK, CORNER OR CROSSWALK CLOSURE
701901-08	TRAFFIC CONTROL DEVICES
720001-01	SIGN PANEL MOUNTING DETAILS
720006-04	SIGN PANEL ERECTION DETAILS
728001-01	TELESCOPING STEEL SIGN SUPPORT
780001-05	TYPICAL PAVEMENT MARKINGS

## MIX DESIGN CHART

HOT-MIX ASPHALT MIXTURE REQUIREMENTS		
MIXTURE USE	SURFACE	INCIDENTAL
AC / PG	PG64-22	PG64-22
RAP % (MAX)	SEE SPECIAL PROVISIONS	SEE SPECIAL PROVISIONS
DESIGN AIR VOIDS	4.0% @ Ndes = 70	4.0% @ Ndes = 70
MIX COMPOSITION (GRADUATION MIXTURE)	IL 9.5	IL 9.5
FRICTION AGG	MIXTURE "C"	MIXTURE "C"
QUALITY MGMT PROGRAM	QC / QA	QC / QA

NOTE:  
THE UNIT WEIGHT USED TO CALCULATE ALL HMA SURFACE MIXTURE QUANTITIES IS 0.056 TONS/SQ YD/IN.

MODEL: D:\64bit  
FILE NAME: P:\2018\180829\14\_CADD - DWG\44.7\_Tran\CADD\_Sheet\180829-14-CH-0900026.dgn



USER NAME = dlee	DESIGNED - TBP	REVISED -
PLOT SCALE = 40.0000 ' / in.	DRAWN - JCL	REVISED -
PLOT DATE = 4/19/2021	CHECKED - JWS	REVISED -
	DATE - FEBRUARY 2020	REVISED -



VILLAGE OF SHILOH

GENERAL NOTES, HIGHWAY STANDARDS AND COMMITMENTS

SCALE: NONE SHEET 1 OF 1 SHEETS STA. TO STA.

F.A.U. RTE.	SECTION	COUNTY	TOTAL SHEETS	SHEET NO.
9177	19-00007-06-R5	ST. CLAIR	15	2
			CONTRACT NO. 97756	
		ILLINOIS	FED. AID PROJECT	

CODE NO.	PAY ITEM	UNIT	TOTAL QUANTITY
25000210	SEEDING, CLASS 2A	ACRE	0.25
25000400	NITROGEN FERTILIZER NUTRIENT	POUND	23
25000500	PHOSPHORUS FERTILIZER NUTRIENT	POUND	23
25000600	POTASSIUM FERTILIZER NUTRIENT	POUND	23
25100115	MULCH, METHOD 2	ACRE	0.25
28000500	INLET AND PIPE PROTECTION	EACH	2
40201000	AGGREGATE FOR TEMPORARY ACCESS	TON	12
40600290	BITUMINOUS MATERIALS (TACK COAT)	POUND	7910
40600982	HOT-MIX ASPHALT SURFACE REMOVAL - BUTT JOINT	SQ YD	179
40600990	TEMPORARY RAMP	SQ YD	200
40604052	HOT-MIX ASPHALT SURFACE COURSE, IL-9.5, MIX "C", N70	TON	1979
40800025	BITUMINOUS MATERIALS (PRIME COAT)	POUND	485
40800050	INCIDENTAL HOT-MIX ASPHALT SURFACING	TON	17
42400100	PORTLAND CEMENT CONCRETE SIDEWALK 4 INCH	SQ FT	1006
42400800	DETECTABLE WARNINGS	SQ FT	85
44000100	PAVEMENT REMOVAL	SQ YD	97
44000157	HOT-MIX ASPHALT SURFACE REMOVAL, 2"	SQ YD	17275
44000500	COMBINATION CURB AND GUTTER REMOVAL	FOOT	212

CODE NO.	PAY ITEM	UNIT	TOTAL QUANTITY
44000600	SIDEWALK REMOVAL	SQ FT	697
60255900	MANHOLES TO BE ADJUSTED WITH NEW TYPE 3 FRAME AND GRATE	EACH	1
60260500	INLETS TO BE ADJUSTED WITH NEW TYPE 3 FRAME AND GRATE	EACH	1
60605000	COMBINATION CONCRETE CURB AND GUTTER, TYPE B-6.24	FOOT	211
67100100	MOBILIZATION	L SUM	1
70102620	TRAFFIC CONTROL AND PROTECTION, STANDARD 701501	L SUM	1
70102635	TRAFFIC CONTROL AND PROTECTION, STANDARD 701701	L SUM	1
70102640	TRAFFIC CONTROL AND PROTECTION, STANDARD 701801	L SUM	1
70300100	SHORT TERM PAVEMENT MARKING	FOOT	1088
70300150	SHORT TERM PAVEMENT MARKING REMOVAL	SQ FT	181
70300210	TEMPORARY PAVEMENT MARKING LETTERS AND SYMBOLS	SQ FT	250
70300220	TEMPORARY PAVEMENT MARKING - LINE 4"	FOOT	16384
70300260	TEMPORARY PAVEMENT MARKING - LINE 12"	FOOT	2158
70300280	TEMPORARY PAVEMENT MARKING - LINE 24"	FOOT	82
Δ 72000100	SIGN PANEL - TYPE 1	SQ FT	132
Δ 72400500	RELOCATE SIGN PANEL ASSEMBLY - TYPE A	EACH	1
Δ 72800100	TELESCOPING STEEL SIGN SUPPORT	FOOT	264
Δ 78000100	THERMOPLASTIC PAVEMENT MARKING - LETTERS AND SYMBOLS	SQ FT	125

Δ SPECIALTY ITEMS

MODEL: Default  
FILE NAME: \\wmswif1\Projects\2018\180821\1 CADD - DWG\1.7 Tran\CADD Sheets\180821-sh-500.dgn



**TWM, INC.**  
WWW.TWM-INC.COM  
IL DESIGN FIRM  
LICENSE NO:  
184-001220

USER NAME = dlee	DESIGNED - TBP	REVISED -
PLOT SCALE = 40,0000' / in.	DRAWN - JCL	REVISED -
PLOT DATE = 3/23/2021	CHECKED - JWS	REVISED -
	DATE - FEBRUARY 2020	REVISED -



VILLAGE OF SHILOH

SUMMARY OF QUANTITIES

SCALE: NONE SHEET 1 OF 2 SHEETS STA. TO STA.

F.A.U. RTE. 9177	SECTION 19-00007-06-RS	COUNTY ST. CLAIR	TOTAL SHEETS 15	SHEET NO. 3
CONTRACT NO. 97756				
ILLINOIS FED. AID PROJECT				

CODE NO.	PAY ITEM	UNIT	TOTAL QUANTITY
Δ 78000200	THERMOPLASTIC PAVEMENT MARKING - LINE 4"	FOOT	8192
Δ 78000600	THERMOPLASTIC PAVEMENT MARKING - LINE 12"	FOOT	1079
Δ 78000650	THERMOPLASTIC PAVEMENT MARKING - LINE 24"	FOOT	41
Δ 78100100	RAISED REFLECTIVE PAVEMENT MARKER	EACH	73
78300200	RAISED REFLECTIVE PAVEMENT MARKER REMOVAL	EACH	73
Z0033700	LONGITUDINAL JOINT SEALANT	FOOT	5956
X0327036	BIKE PATH REMOVAL	SQ YD	31
X4401198	HOT-MIX ASPHALT SURFACE REMOVAL, VARIABLE DEPTH	SQ YD	124
# Z0076600	TRAINEES	HOURL	500
X7030005	TEMPORARY PAVEMENT MARKING REMOVAL	SQ FT	4017
# Z0076604	TRAINEES TRAINING PROGRAM GRADUATE	HOURL	500

Δ SPECIALTY ITEMS  
# 0042

MODEL: Default  
FILE NAME: I:\msw\51\PROJECTS\2018\181808B14 CADD - DWG\17 Tran\CADD Sheets\1808B14-SH-500.dwg



**TWM, INC.**  
WWW.TWM-INC.COM  
IL DESIGN FIRM  
LICENSE NO:  
184-001220

USER NAME = dlee  
PLOT SCALE = 40.0000' / in.  
PLOT DATE = 3/23/2021

DESIGNED - TBP  
DRAWN - JCL  
CHECKED - JWS  
DATE - FEBRUARY 2020

REVISED -  
REVISED -  
REVISED -  
REVISED -



VILLAGE OF SHILOH

SUMMARY OF QUANTITIES

SCALE: NONE SHEET 2 OF 2 SHEETS STA. TO STA.

F.A.U. RTE.	SECTION	COUNTY	TOTAL SHEETS	SHEET NO.
9177	19-00007-06-R5	ST. CLAIR	15	4
CONTRACT NO. 97756				
ILLINOIS FED. AID PROJECT				

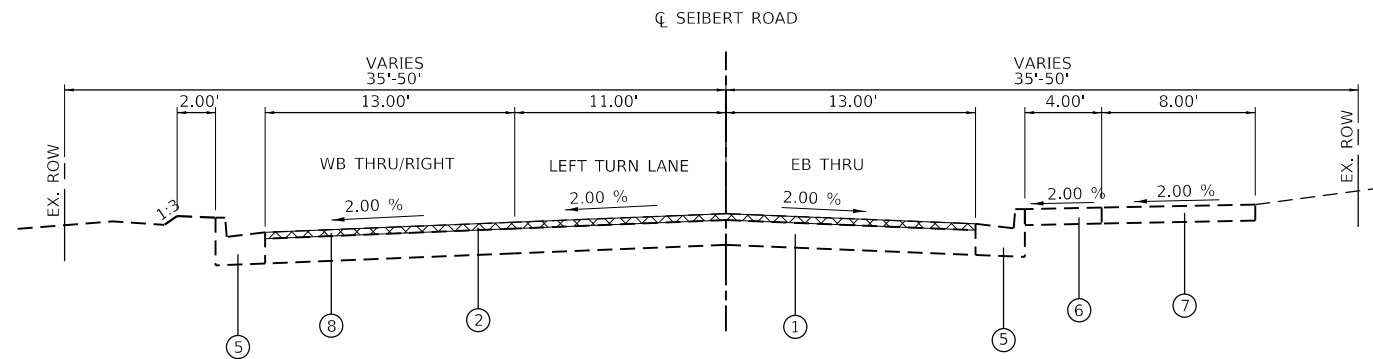

**EXISTING TYPICAL SECTION**

STA. 0+17.00 TO STA. 2+60.00

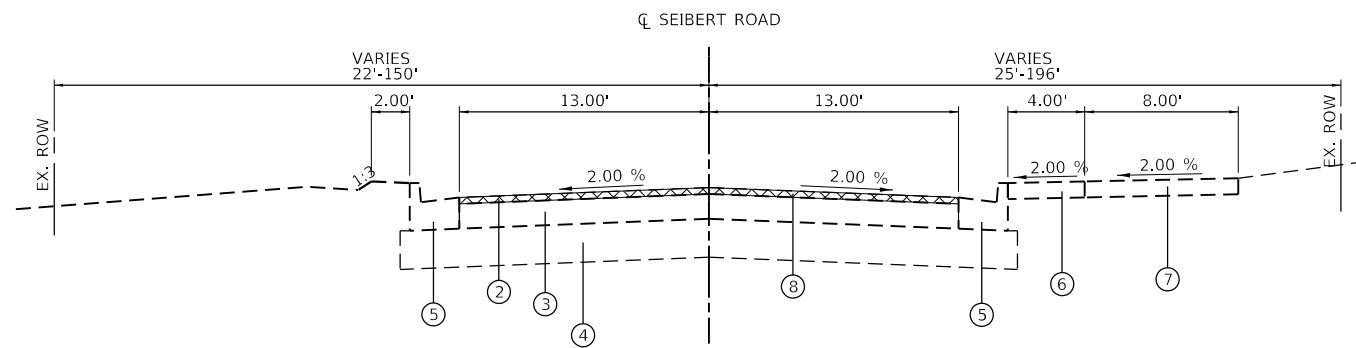

**EXISTING TYPICAL SECTION**

STA. 2+60.00 TO STA. 3+75.00

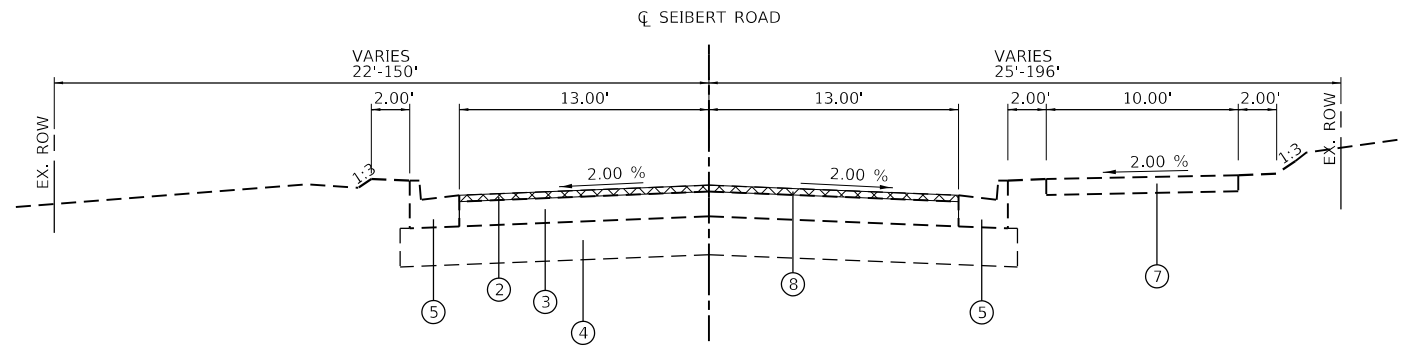

**EXISTING TYPICAL SECTION**

STA. 3+75.00 TO STA. 58+13.25

**LEGEND**

- ① EXISTING PAVEMENT, 10.75"
- ② EXISTING HOT MIX ASPHALT SURFACE, 2"
- ③ EXISTING HOT MIX ASPHALT BINDER, 7.75"
- ④ EXISTING PROCESSING MODIFIED SOIL, 12"
- ⑤ EXISTING COMBINATION CURB & GUTTER, TYPE B-6.24
- ⑥ EXISTING 4" PORTLAND CEMENT CONCRETE SIDEWALK
- ⑦ EXISTING HMA SHARED USE PATH
- ⑧ PROPOSED HMA SURFACE REMOVAL, 2"
- ⑨ PROPOSED HMA SURFACE COURSE, IL-9.5, MIX C, N70, 2"
- ⑩ PROPOSED BITUMINOUS MATERIALS (TACK COAT)
- ⑪ PROPOSED THERMOPLASTIC PAVEMENT MARKING
- ⑫ PROPOSED LONGITUDINAL JOINT SEALANT

MODEL: Default  
FILE NAME: \\mswmsrfs1p06scf2018\180808114\_CADD - DWG\4.7\_Tran\CADD\_Sheets\180808114\_Sht5.dgn



USER NAME = dlcc  
PLOT SCALE = 10.0000" / in.  
PLOT DATE = 3/23/2021

DESIGNED - TBP  
DRAWN - JCL  
CHECKED - JWS  
DATE - FEBRUARY 2020

REVISED -  
REVISED -  
REVISED -  
REVISED -



**VILLAGE OF SHILOH**

**EXISTING TYPICAL SECTIONS  
SEIBERT ROAD**

SCALE: NONE SHEET 1 OF 3 SHEETS STA. TO STA.

F.A.U. RTE.	SECTION	COUNTY	TOTAL SHEETS	SHEET NO.
9177	19-00007-06-R5	ST. CLAIR	15	5
CONTRACT NO. 97756				
ILLINOIS FED. AID PROJECT				

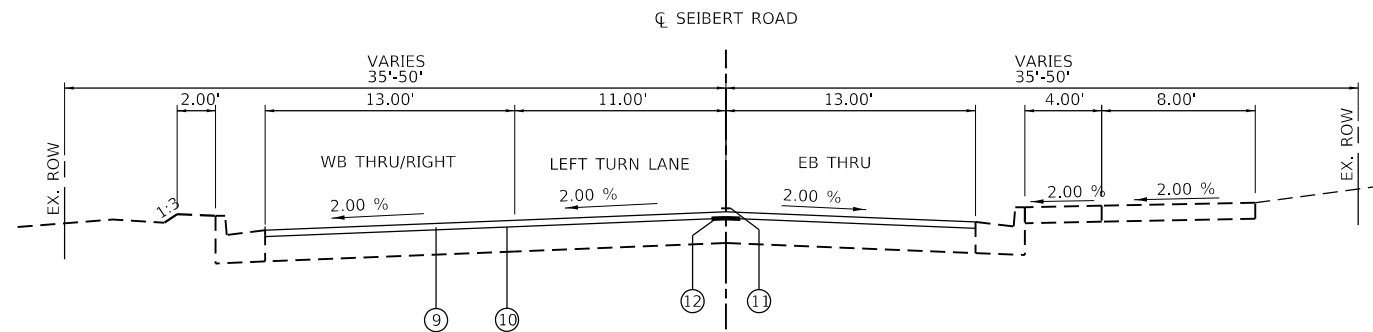

**PROPOSED TYPICAL SECTION**  
STA. 0+17.00 TO STA. 2+60.00

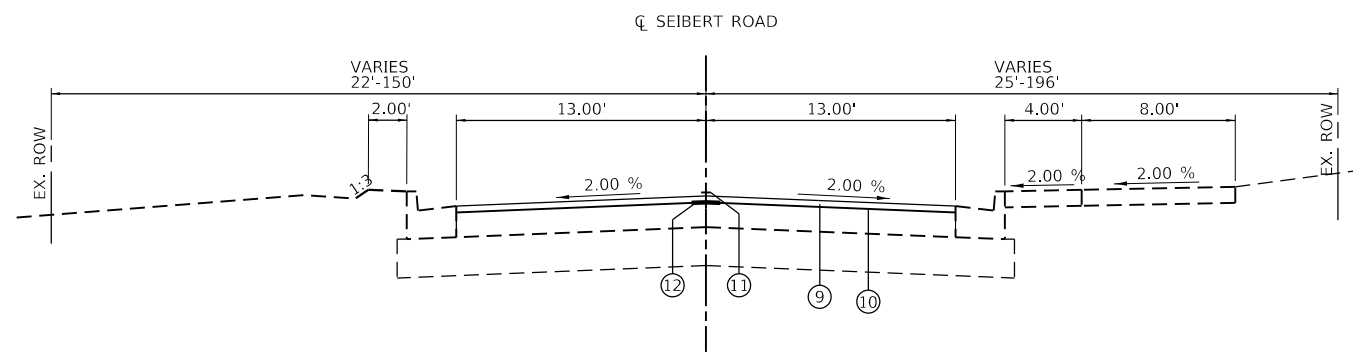

**PROPOSED TYPICAL SECTION**  
STA. 2+60.00 TO STA. 3+75.00

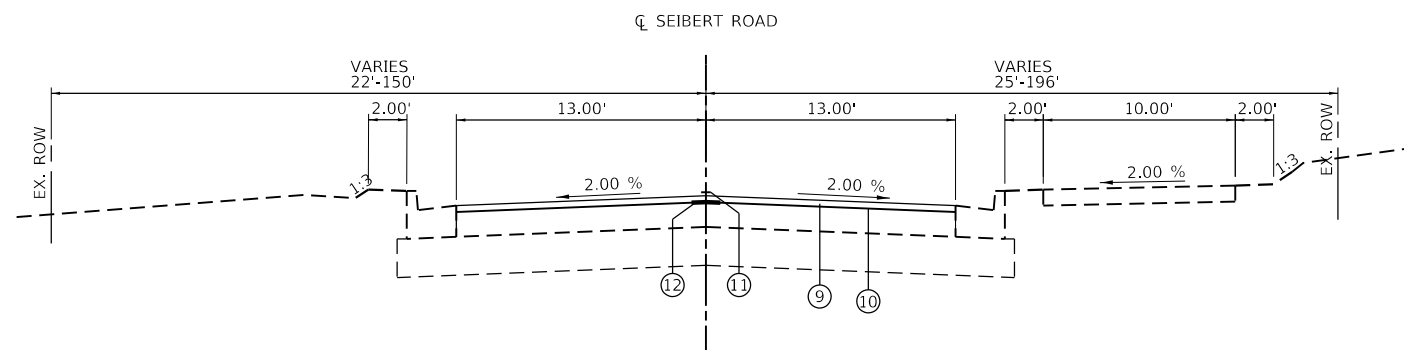

**PROPOSED TYPICAL SECTION**  
STA. 3+75.00 TO STA. 58+13.25

**LEGEND**

- ① EXISTING PAVEMENT, 10.75"
- ② EXISTING HOT MIX ASPHALT SURFACE, 2"
- ③ EXISTING HOT MIX ASPHALT BINDER, 7.75"
- ④ EXISTING PROCESSING MODIFIED SOIL, 12"
- ⑤ EXISTING COMBINATION CURB & GUTTER. TYPE B-6.24
- ⑥ EXISTING 4" PORTLAND CEMENT CONCRETE SIDEWALK
- ⑦ EXISTING HMA SHARED USE PATH
- ⑧ PROPOSED HMA SURFACE REMOVAL, 2"
- ⑨ PROPOSED HMA SURFACE COURSE, IL-9.5, MIX C, N70, 2"
- ⑩ PROPOSED BITUMINOUS MATERIALS (TACK COAT)
- ⑪ PROPOSED THERMOPLASTIC PAVEMENT MARKING
- ⑫ PROPOSED LONGITUDINAL JOINT SEALANT

MODEL: Default  
FILE NAME: twm\mshf519\p05ecf2018\180808114\_CADD - DWG\4.7\_Tran\CADD\_Sheet0180808114.dgn



**TWM, INC.**  
www.twm-inc.com  
IL DESIGN FIRM  
LICENSE NO:  
184-001220

USER NAME = dlee	DESIGNED - TBP	REVISED -
PLOT SCALE = 10.0000' / in.	DRAWN - JCL	REVISED -
PLOT DATE = 3/23/2021	CHECKED - JWS	REVISED -
	DATE - FEBRUARY 2020	REVISED -



**VILLAGE OF SHILOH**

**PROPOSED TYPICAL SECTIONS  
SEIBERT ROAD**

SCALE: NONE SHEET 2 OF 3 SHEETS STA. TO STA.

F.A.U. RTE.	SECTION	COUNTY	TOTAL SHEETS	SHEET NO.
9177	19-00007-06-R5	ST. CLAIR	15	6
CONTRACT NO. 97756				
ILLINOIS		FED. AID PROJECT		

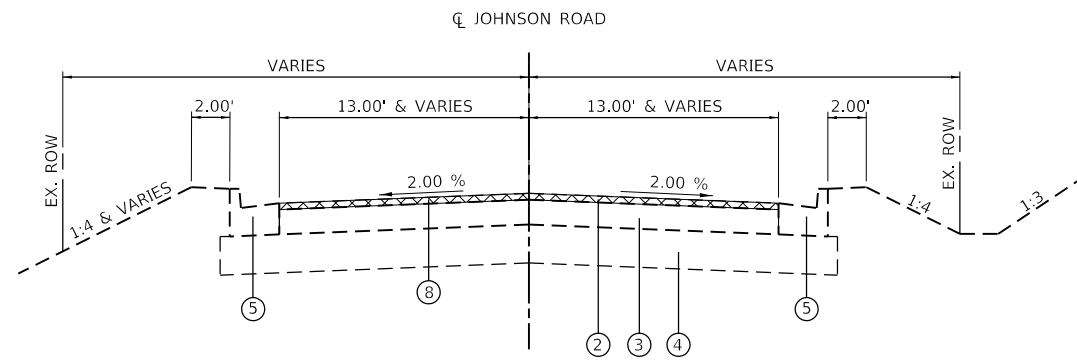

**EXISTING TYPICAL SECTION**

STA. 0+13.00 TO STA. 1+74.00

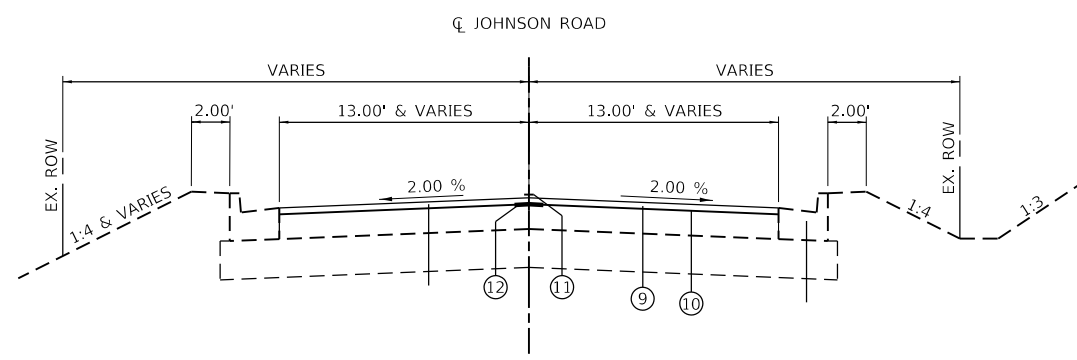

**PROPOSED TYPICAL SECTION**

STA. 0+13.00 TO STA. 1+74.00

**LEGEND**

- ① EXISTING PAVEMENT, 10.75"
- ② EXISTING HOT MIX ASPHALT SURFACE, 2"
- ③ EXISTING HOT MIX ASPHALT BINDER, 7.75"
- ④ EXISTING PROCESSING MODIFIED SOIL, 12"
- ⑤ EXISTING COMBINATION CURB & GUTTER. TYPE B-6.24
- ⑥ EXISTING 4" PORTLAND CEMENT CONCRETE SIDEWALK
- ⑦ EXISTING HMA SHARED USE PATH
- ⑧ PROPOSED HMA SURFACE REMOVAL, 2"
- ⑨ PROPOSED HMA SURFACE COURSE, IL-9.5, MIX C, N70, 2"
- ⑩ PROPOSED BITUMINOUS MATERIALS (TACK COAT)
- ⑪ PROPOSED THERMOPLASTIC PAVEMENT MARKING
- ⑫ PROPOSED LONGITUDINAL JOINT SEALANT

MODEL: Default  
 FILE NAME: \\mswmsrfs1p056c5220181180808114\_CADD - DWG\4.7\_Tran\CADD\_Sheets\180808114\_Sheet3.dgn



USER NAME = dlcc	DESIGNED - TBP	REVISED -
PLOT SCALE = 10.0000 ' / in.	DRAWN - JCL	REVISED -
PLOT DATE = 3/23/2021	CHECKED - JWS	REVISED -
	DATE - FEBRUARY 2020	REVISED -



**VILLAGE OF SHILOH**

**TYPICAL SECTIONS  
JOHNSON ROAD**

SCALE: NONE SHEET 3 OF 3 SHEETS STA. TO STA.

F.A.U. RTE.	SECTION	COUNTY	TOTAL SHEETS	SHEET NO.
9177	19-00007-06-R5	ST. CLAIR	15	7
ILLINOIS FED. AID PROJECT			CONTRACT NO. 97756	

HOT-MIX ASPHALT PAVING SCHEDULE													
LOCATION			REMOVALS				RESURFACING						
			HOT-MIX ASPHALT SURFACE REMOVAL - BUTT JOINT	HOT-MIX ASPHALT SURFACE REMOVAL, 2"	HOT-MIX ASPHALT SURFACE REMOVAL, VARIABLE DEPTH	PAVEMENT REMOVAL	HOT-MIX ASPHALT SURFACE COURSE, IL-9.5FG, MIX "C", N70	BITUMINOUS MATERIALS (PRIME COAT)	BITUMINOUS MATERIALS (TACK COAT)	TEMPORARY RAMP	INCIDENTAL HOT-MIX ASPHALT SURFACING	LONGITUDINAL JOINT SEALANT	AGGREGATE FOR TEMPORARY ACCESS
STATION	TO	STATION	SQ YD	SQ YD	SQ YD	SQ YD	TON	POUND	POUND	SQ YD	TON	FOOT	TON
<b>SEIBERT ROAD</b>													
+17.00	TO	+27.00								100.0			
58+06.58	TO	58+13.25								19.3			
+17.00	TO	+29.13	121.3				10.2		54.6				
+29.13	TO	+59.13			124.00		27.51		55.8				
+59.13	TO	2+60.00		825.80			92.49		371.6		5796.3		
2+60.00	TO	58+03.25		16,013.10			1793.47		7205.9				
58+03.25	TO	58+13.25	28.9				3.24		13.0				
<b>JOHNSON ROAD</b>													
1+67.33	TO	1+74.00								19.3			
+13.00	TO	1+64.00		436.2			48.85		196.3			160.0	
1+64.00	TO	1+74.00	28.9				3.24		13.0				
<b>KATHY DRIVE</b>								485			17.0		12.4
<b>PARK DRIVE</b>										20.0			
<b>DIAMOND COURT</b>										16.9			
<b>SINN ROAD</b>										6.7			
<b>SOUTHRIDGE DR</b>										17.8			
<b>TOTAL:</b>			<b>179</b>	<b>17275</b>	<b>124</b>	<b>97</b>	<b>1979</b>	<b>485</b>	<b>7910</b>	<b>200</b>	<b>17</b>	<b>5956</b>	<b>12</b>

CURB AND GUTTER SCHEDULE				
LOCATION		COMBINATION CONCRETE CURB AND GUTTER, TYPE B-6.24	COMBINATION CURB AND GUTTER REMOVAL	
QUADRANT	LT/RT	FOOT	FOOT	
<b>MAIN STREET</b>				
NE QUAD	LT	66.6	66.9	
SE QUAD	RT	57.5	57.6	
<b>KATHY DRIVE</b>				
NE QUAD	LT	35.8	36.2	
SE QUAD	RT	36.2	36.1	
<b>SOUTHRIDGE DRIVE</b>				
	LT	15.0	15.0	
<b>TOTAL:</b>		<b>211</b>	<b>212</b>	

ADJUSTMENT SCHEDULE						
LOCATION			MANHOLES TO BE ADJUSTED WITH NEW TYPE 3 FRAME AND GRATE	INLETS TO BE ADJUSTED WITH NEW TYPE 3 FRAME AND GRATE	INLET AND PIPE PROTECTION	
STATION	OFFSET	LT/RT	EACH	EACH	EACH	
<b>SEIBERT RD</b>						
+19.85	59.81	LT	1		1	
19+55.29	24.38	LT		1	1	
<b>TOTAL:</b>			<b>1</b>	<b>1</b>	<b>2</b>	

SEEDING SCHEDULE							
LOCATION		SEEDING, CLASS 2A	NITROGEN FERTILIZER NUTRIENT	PHOSPHORUS FERTILIZER NUTRIENT	POTASSIUM FERTILIZER NUTRIENT	MULCH, METHOD 2	
STATION	TO	STATION	ACRE	POUND	POUND	POUND	ACRE
<b>SEIBERT ROAD</b>							
+17.00	TO	58+13.25	0.25	22.5	22.5	22.5	0.25
<b>TOTAL:</b>			<b>0.25</b>	<b>22.5</b>	<b>22.5</b>	<b>22.5</b>	<b>0.25</b>
<b>PAY TOTAL:</b>			<b>0.25</b>	<b>23</b>	<b>23</b>	<b>23</b>	<b>0.25</b>

PAVEMENT MARKING SCHEDULE																		
LOCATION				RAISED REFLECTIVE PAVEMENT MARKER	RAISED REFLECTIVE PAVEMENT MARKER REMOVAL	THERMOPLASTIC PAVEMENT MARKING			SHORT TERM PAVEMENT MARKING	SHORT TERM PAVEMENT MARKING REMOVAL	TEMPORARY PAVEMENT MARKING			TEMPORARY PAVEMENT MARKING REMOVAL				
STATION	TO	STATION	LOCATION	TYPE	EACH	EACH	LETTERS AND SYMBOLS	LINE 4"	LINE 12"	LINE 24"	FOOT	SQ FT	FOOT	SQ FT	FOOT	SQ FT		
<b>SEIBERT ROAD</b>																		
+17.00	TO	58+13.25	CENTERLINE		73	73					1056	176						
<b>MAIN ST INTERSECTION</b>				LEFT TURN ARROW										62.4				
				RIGHT/ THRU ARROW											104.0			
				"O"												24.0		
				"N"												28.4		
				"L"												15.2		
			"Y"										7.8					
25+50.00	TO	58+13.25	CENTERLINE	SOLID DOUBLE YELLOW				6700.0						13400.0				
2+40.00	TO	25+50.00	CENTERLINE	SKIP DASH YELLOW				555.0						1110.0				
+17.00	TO	2+40.00	CENTERLINE	SOLID DOUBLE YELLOW				500.0						1000.0				
+17.00	TO	2+40.00	LANE LINE	SOLID WHITE LINE				115.0						230.0				
<b>MAIN ST INTERSECTION</b>				CROSSWALK					150.0						300.0			
				CROSSWALK					80.0							160.0		
				CROSSWALK						52.0							104.0	
				CROSSWALK						60.0							120.0	
				CROSSWALK						52.0							104.0	
				CROSSWALK						52.0							104.0	
				CROSSWALK						213.0							426.0	
				CROSSWALK						113.3							226.6	
				CROSSWALK						74.0							148.0	
				CROSSWALK						85.0							170.0	
				CROSSWALK						74.0							148.0	
				CROSSWALK						74.0							148.0	
<b>JOHNSON ROAD</b>			+13.00	TO	1+74.00	CENTERLINE					32	5.33						
			+13.00	TO	1+74.00	CENTERLINE	SOLID DOUBLE YELLOW			322.0						644.0		215
<b>SEIBERT RD INTERSECTION</b>				STOP BAR												26.0	52	
<b>TOTAL:</b>					<b>73</b>	<b>73</b>		<b>125</b>	<b>8192</b>	<b>1079</b>	<b>41</b>	<b>1088</b>	<b>181</b>	<b>250</b>	<b>16384</b>	<b>2158</b>	<b>82</b>	<b>4017</b>

SIGNAGE SCHEDULE							
LOCATION		DESCRIPTION			SIGN PANEL - TYPE 1	TELESCOPING STEEL SIGN SUPPORT	* RELOCATE SIGN PANEL ASSEMBLY - TYPE A
		SIGN	SIZE	SQ FT	FOOT	EACH	
<b>SEIBERT ROAD</b>							
<b>DIAMOND COURT</b>		W11-2 (PEDESTRIAN SYMBOL)	30 X 30	25.00			
		W16-9P (AHEAD)	24 X 12	4.00	66.0		
		W16-7P (ARROW)	24 X 12	4.00			
<b>NEAR BASEBALL FIELD DUGOUTS</b>		W11-2 (PEDESTRIAN SYMBOL)	30 X 30	25.00			
		W16-9P (AHEAD)	24 X 12	4.00	66.0		
		W16-7P (ARROW)	24 X 12	4.00			
<b>KATHY DRIVE</b>		W11-2 (PEDESTRIAN SYMBOL)	30 X 30	25.00			
		W16-9P (AHEAD)	24 X 12	4.00	66.0		
		W16-7P (ARROW)	24 X 12	4.00			
<b>SOUTHRIDGE DRIVE</b>		W11-2 (PEDESTRIAN SYMBOL)	30 X 30	25.00			
		W16-9P (AHEAD)	24 X 12	4.00	66.0		
		W16-7P (ARROW)	24 X 12	4.00			
23+16.62	17.52	RT	* "S" CURVE SIGN			1	
<b>TOTAL:</b>				<b>132</b>	<b>264</b>	<b>1</b>	

\* SIGN TO BE RELOCATED AS PER THE DIRECTION OF THE ENGINEER TO NOT CONFLICT WITH PR PEDESTRIAN

SIDEWALK SCHEDULE					
LOCATION		PORTLAND CEMENT CONCRETE SIDEWALK, 4 INCH	DETECTABLE WARNINGS	SIDEWALK REMOVAL	BIKE PATH REMOVAL
QUADRANT	LT/RT	SQ FT	SQ FT	SQ FT	SQ YD
<b>MAIN STREET</b>					
NE QUAD	LT	151.0	23.6	115.2	
SE QUAD	RT	465.5	13.8	233.7	31.0
<b>KATHY DRIVE</b>					
NE QUAD	LT	183.5	20.4	167.3	
SE QUAD	RT	115.1	17.4	97.5	
<b>SOUTHRIDGE DRIVE</b>					
	LT	91.3	10.0	83.3	
<b>TOTAL:</b>		<b>1006</b>	<b>85</b>	<b>697</b>	<b>31</b>

MODEL: D:\64\11...  
 FILE NAME: P:\20\18118088\14\_CADD - DWG\4.7\_Twp\CADD\_Sheets\180881-4-PC-Schedule.dwg



**TWM, INC.**  
 www.twm-inc.com  
 IL DESIGN FIRM LICENSE NO: 184-001220

USER NAME = dlee  
 DESIGNED - TBP  
 DRAWN - JCL  
 CHECKED - JWS  
 DATE - FEBRUARY 2020

REVISED -  
 REVISED -  
 REVISED -  
 REVISED -



**VILLAGE OF SHILOH**

**SCHEDULE OF QUANTITIES**

SCALE: NONE SHEET 1 OF 1 SHEETS STA. TO STA.

F.A.U. RTE.	SECTION	COUNTY	TOTAL SHEETS	SHEET NO.
9177	19-00007-06-R5	ST. CLAIR	15	8
CONTRACT NO. 97756				
ILLINOIS		FED. AID PROJECT		



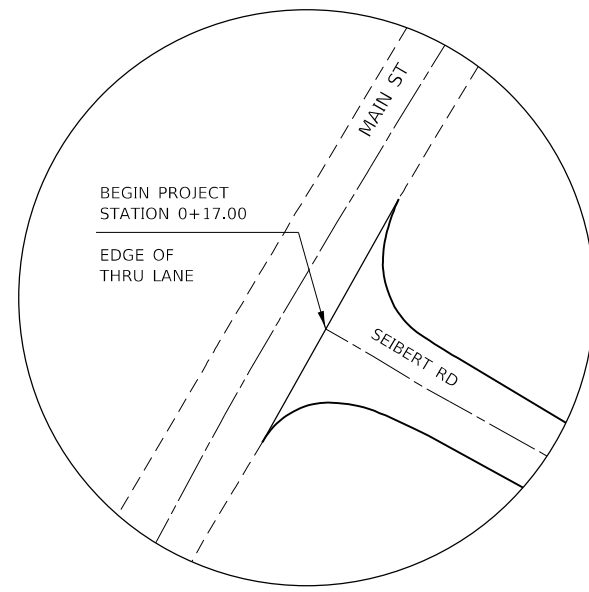
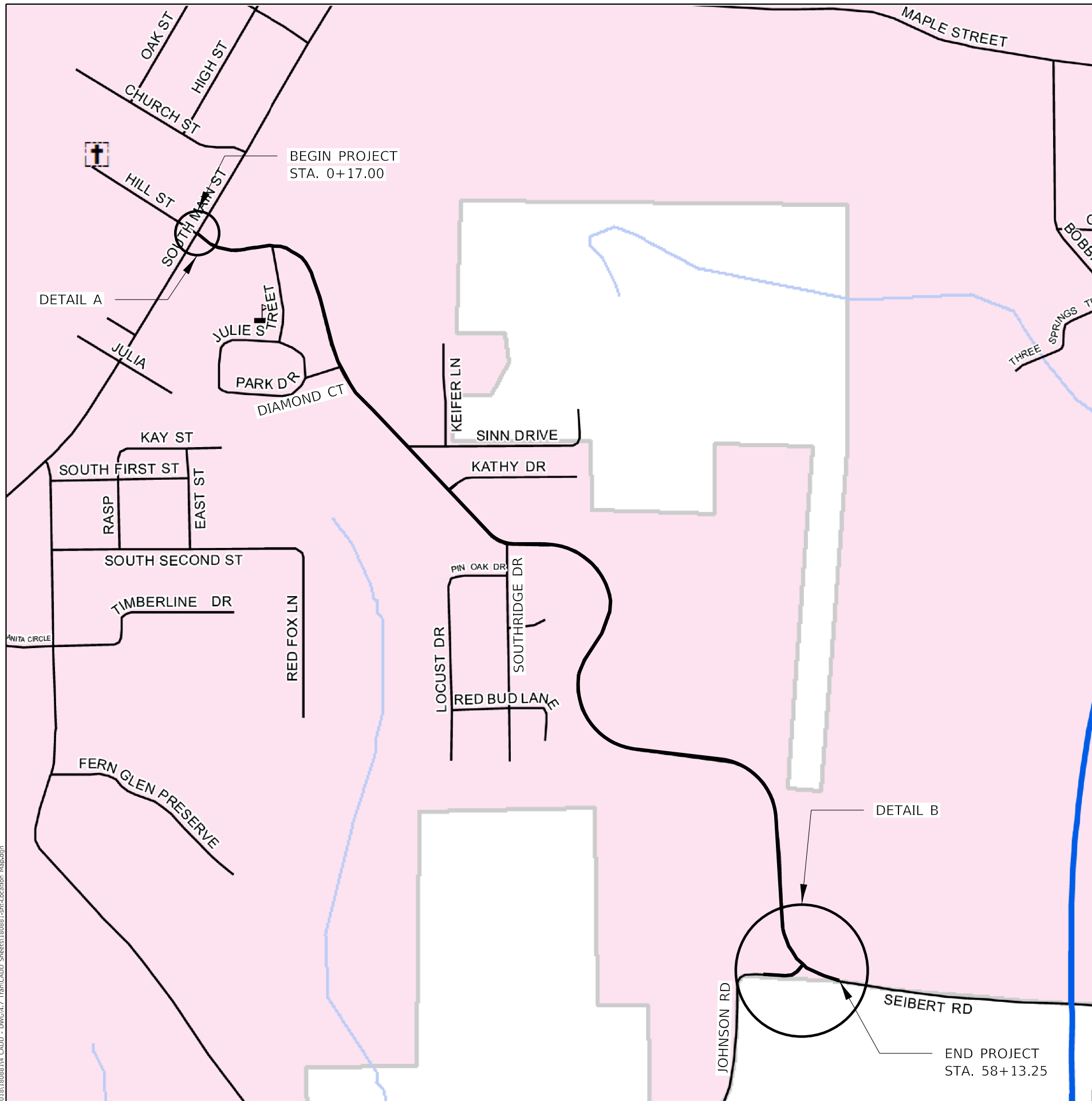

DETAIL A

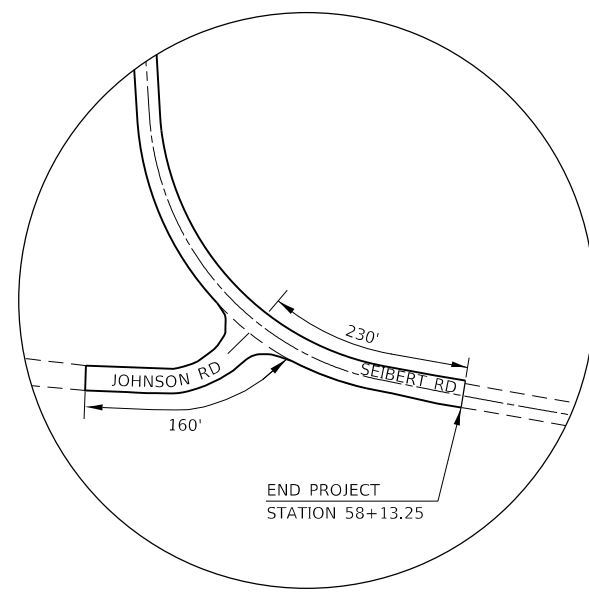

DETAIL B

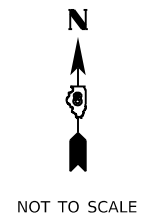

MODEL: D:\dgn\11\110808\11\110808.dwg  
 FILE NAME: P:\2019\110808\11\110808.dwg  
 USER: dlee  
 DATE: 3/23/2021



USER NAME	= dlee
PLOT SCALE	= 500,0000 ' / in.
PLOT DATE	= 3/23/2021

DESIGNED	- TBP
DRAWN	- JCL
CHECKED	- JWS
DATE	- FEBRUARY 2020

REVISED	-
REVISED	-
REVISED	-
REVISED	-



**VILLAGE OF SHILOH**

SCALE: NONE		SHEET 1	OF 1	SHEETS	STA.	TO STA.
-------------	--	---------	------	--------	------	---------

**LOCATION MAP**

F.A.U. RTE.	SECTION	COUNTY	TOTAL SHEETS	SHEET NO.
9177	19-00007-06-RS	ST. CLAIR	15	9
CONTRACT NO. 97756				
ILLINOIS FED. AID PROJECT				

POINT #	NORTHING (Y)	EASTING (X)	ELEV	DESCRIPTION
1	689166.46	2373113.11	652.76	SIDEWALK
2	689162.81	2373110.93	652.65	SIDEWALK
3	689158.39	2373108.59	652.57	SIDEWALK
4	689146.01	2373102.05	651.45	SIDEWALK
5	689144.24	2373101.12	651.42	SIDEWALK
6	689164.41	2373116.46	652.89	SIDEWALK
7	689160.94	2373114.46	652.71	SIDEWALK
8	689156.52	2373112.13	652.63	SIDEWALK
9	689144.14	2373105.59	651.52	SIDEWALK
10	689131.69	2373099.02	651.48	SIDEWALK
11	689136.17	2373096.86	651.52	EOP
12	689126.85	2373096.46	651.57	EOP
13	689064.92	2373058.00	650.30	EOP
14	689067.67	2373065.21	650.37	EOP
15	689051.78	2373049.57	650.51	SIDEWALK
16	689058.47	2373053.07	650.33	SIDEWALK
17	689062.62	2373059.19	650.24	SIDEWALK
18	689065.17	2373065.85	650.31	SIDEWALK
19	689066.15	2373073.19	651.50	SIDEWALK
20	689060.76	2373096.32	651.98	SIDEWALK
21	689049.08	2373053.67	650.56	SIDEWALK
22	689053.94	2373057.01	650.42	SIDEWALK
23	689057.30	2373061.96	650.34	SIDEWALK
24	689059.36	2373067.34	650.41	SIDEWALK
25	689060.15	2373073.28	651.52	SIDEWALK
26	689055.50	2373093.29	652.20	SIDEWALK
27	689051.97	2373064.72	650.44	SIDEWALK
28	689053.55	2373068.84	650.52	SIDEWALK
29	689018.68	2373115.79	651.42	SIDEWALK
30	689050.23	2373090.26	652.14	SIDEWALK

**NOTES**

- EOP ELEVATIONS ARE AT 10' INTERVALS UNLESS OTHERWISE NOTED
- ANY EARTHWORK REQUIRED FOR THE CONSTRUCTION OF THE PROPOSED ADA RAMPS AND SIDEWALK WILL NOT BE PAID FOR SEPARATELY AND THE COSTS SHALL BE INCLUDED IN THE COST PER SQ FT FOR SIDEWALK REMOVAL.
- ANY EARTHWORK REQUIRED FOR THE CONSTRUCTION OF THE PROPOSED CURB AND GUTTER WILL NOT BE PAID FOR SEPARATELY AND THE COST SHALL BE INCLUDED IN THE COST PER FOOT FOR COMBINATION CURB AND GUTTER REMOVAL.

\* SEE SECTION A-A ON PAGE 9.

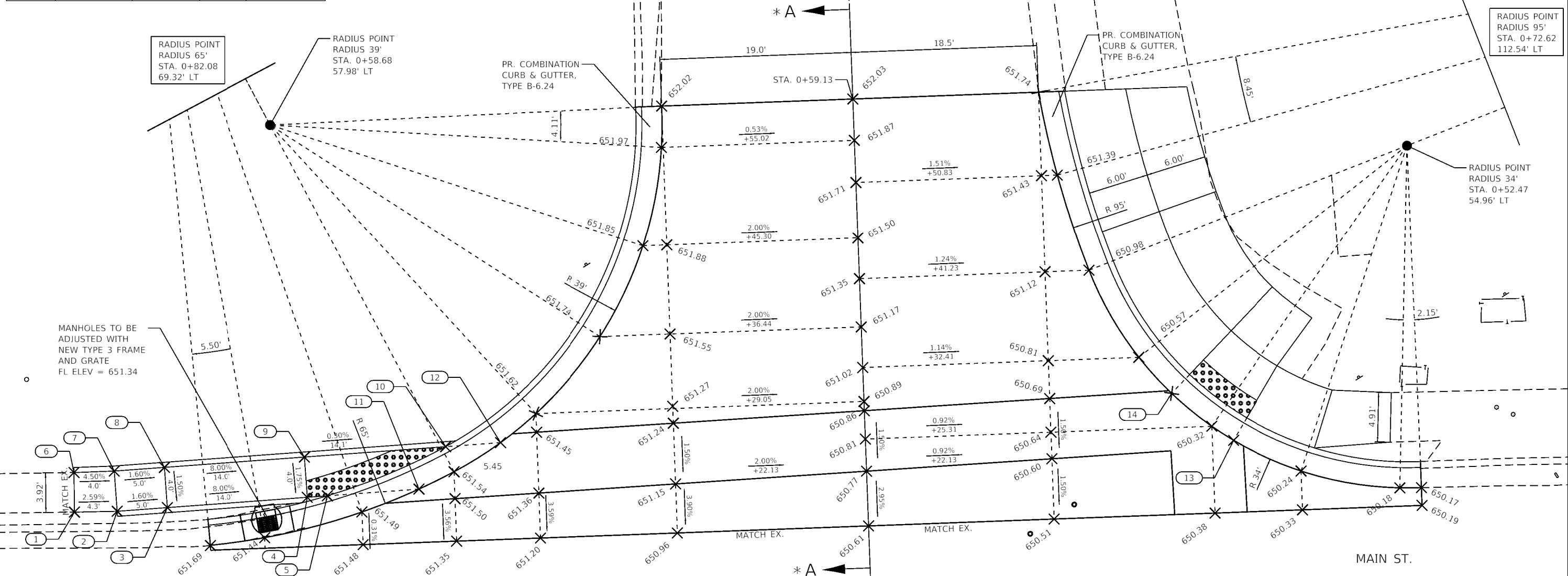
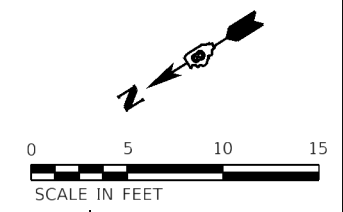

MODEL: D:\dwg\11\11080814.CADD - DWG\11\_TrafficADD\_Sheets\11080814.ctb.dwg\11\_sidewalk\_1.dgn  
 FILE NAME: P:\02\11080814.CADD - DWG\11\_TrafficADD\_Sheets\11080814.ctb.dwg\11\_sidewalk\_1.dgn

 <b>TWM, INC.</b> WWW.TWM-INC.COM ILL DESIGN FIRM LICENSE NO: 184-001220	USER NAME = dllee PLOT SCALE = 10.0000' / 1"	DESIGNED - TBP DRAWN - JCL CHECKED - JWS DATE - FEBRUARY 2020	REVISED - REVISED - REVISED - REVISED -	 <b>VILLAGE OF SHILOH</b>	<b>INTERSECTION DETAILS</b> <b>SEIBERT ROAD &amp; MAIN STREET</b>		F.A.U. RTE. 9177 SECTION 19-00007-06-R5 COUNTY ST. CLAIR TOTAL SHEETS 15 SHEET NO. 10	CONTRACT NO. 97756 ILLINOIS FED. AID PROJECT
	PLOT DATE = 3/23/2021	SCALE: 1"=5' SHEET 1 OF 2 SHEETS STA. TO STA.						

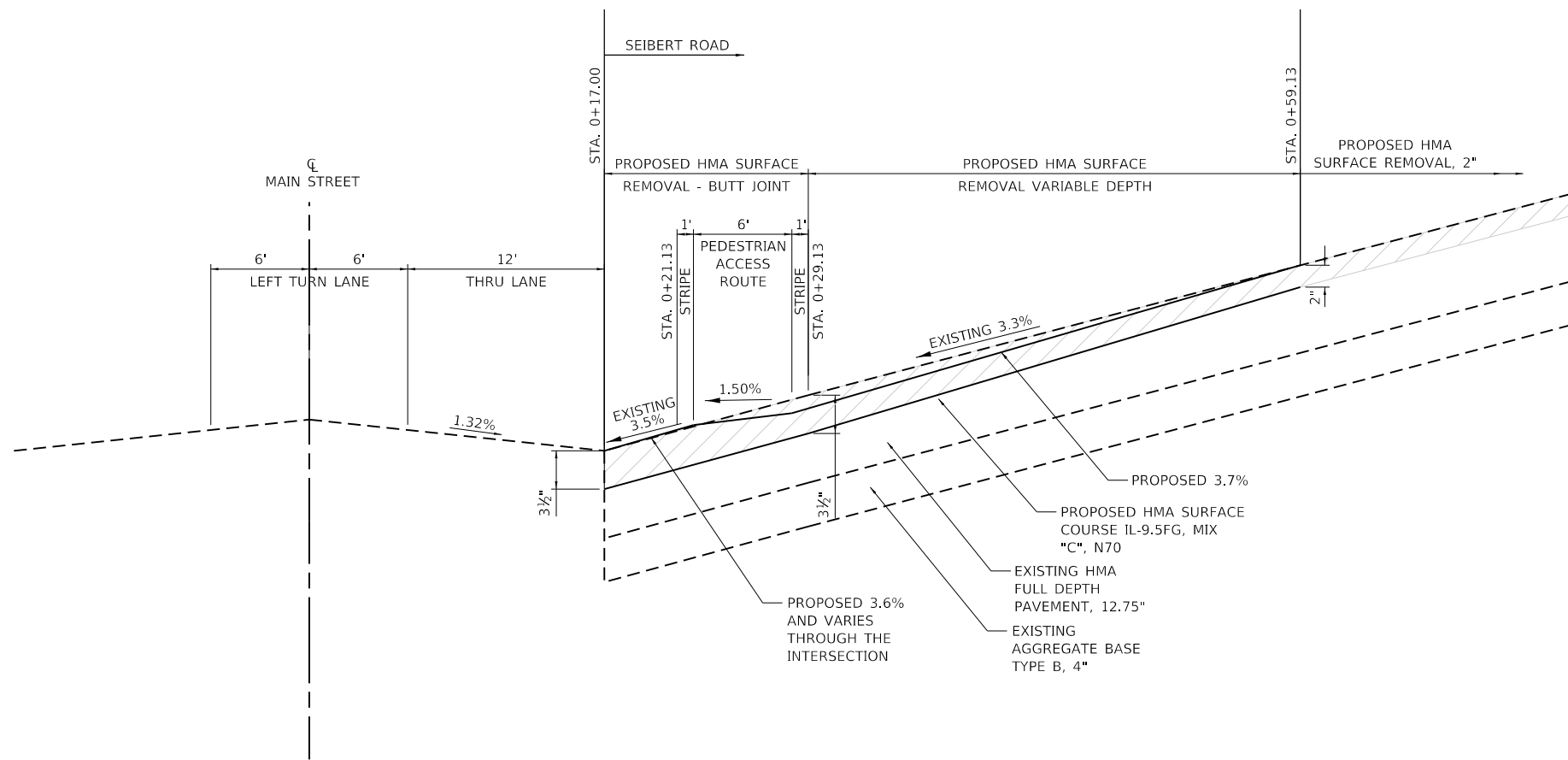

**SECTION A-A**

MODEL: Default  
 FILE NAME: \\mswmsrfs1\p05\sect2\018\18080114\_CADD - DWG\4.7\_Tran\CADD\_Sheets\18080114-h-detail\butt-joint.dgn



USER NAME = dlee	DESIGNED - TBP	REVISED -
PLOT SCALE = 10.0000 ' / in.	DRAWN - JCL	REVISED -
PLOT DATE = 3/25/2021	CHECKED - JWS	REVISED -
	DATE - FEBRUARY 2020	REVISED -



**VILLAGE OF SHILOH**

**CROSSWALK - BUTT JOINT DETAIL  
SEIBERT/MAIN AT CENTERLINE**

SCALE: NTS SHEET 2 OF 2 SHEETS STA. TO STA.

F.A.U. RTE.	SECTION	COUNTY	TOTAL SHEETS	SHEET NO.
9177	19-00007-06-RS	ST. CLAIR	15	11
CONTRACT NO. 97756				
ILLINOIS FED. AID PROJECT				

**NOTES**

1. EOP ELEVATIONS ARE AT 5' INTERVALS UNLESS OTHERWISE NOTED.

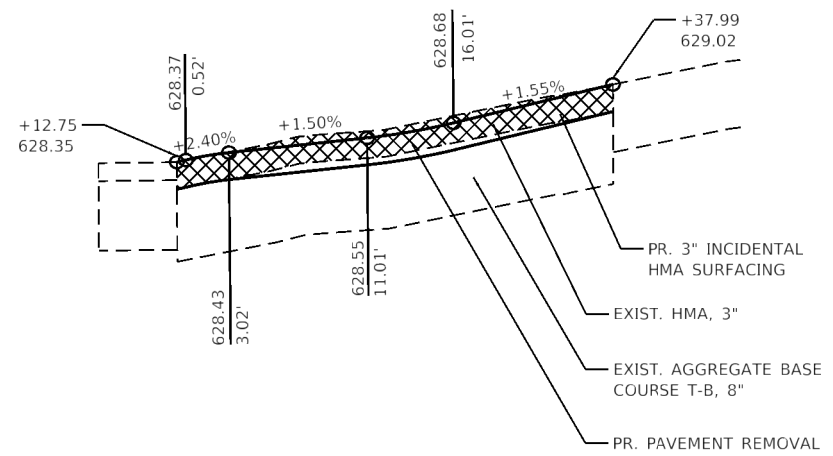
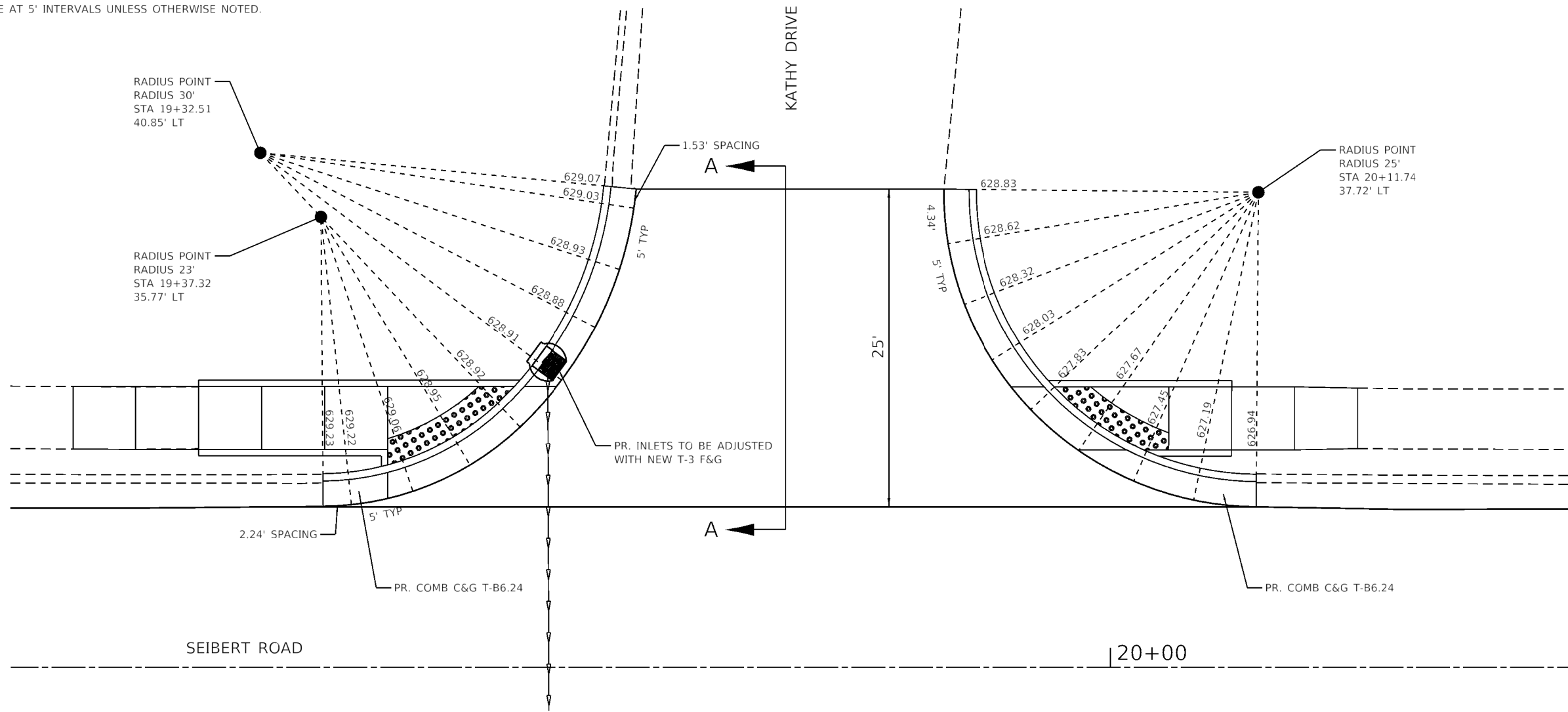

**SECTION A-A**  
NOT TO SCALE

**NOTES**

1. THE CONTRACTOR SHALL EXERCISE CARE WHEN REMOVING THE EXISTING HMA SURFACE. ANY DAMAGE TO THE EXISTING AGGREGATE BASE COURSE SHALL BE REPAIRED BY THE CONTRACTOR AT NO ADDITIONAL COSTS TO THE CONTRACT.
2. THE CONTRACTOR SHALL GRADE THE EXISTING AGGREGATE BASE COURSE TO THE PROPOSED PROFILE OF KATHY DRIVE. THE COSTS OF THIS WORK SHALL BE INCLUDED IN THE PAY ITEM PER TON FOR 3" INCIDENTAL HMA SURFACING.
3. ANY EARTHWORK REQUIRED FOR THE CONSTRUCTION OF THE PROPOSED CURB AND GUTTER WILL NOT BE PAID FOR SEPARATELY AND THE COST SHALL BE INCLUDED IN THE COST PER FOOT FOR COMBINATION CURB AND GUTTER REMOVAL.

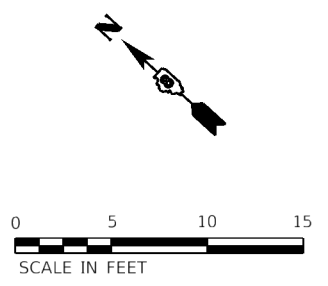

MODEL: D:\dgn\19-00007-06-R5.dwg; FILE NAME: 19-00007-06-R5.dwg; USER: JCL; DATE: 3/23/2021



USER NAME = dllee	DESIGNED - TBP	REVISED -
	DRAWN - JCL	REVISED -
PLOT SCALE = 10.0000' / 1"	CHECKED - JWS	REVISED -
PLOT DATE = 3/23/2021	DATE - FEBRUARY 2020	REVISED -



**VILLAGE OF SHILOH**

**INTERSECTION DETAILS**  
**SEIBERT ROAD & KATHY DRIVE**

SCALE: 1"=5' SHEET 1 OF 2 SHEETS STA. TO STA.

F.A.U. RTE.	SECTION	COUNTY	TOTAL SHEETS	SHEET NO.
9177	19-00007-06-R5	ST. CLAIR	15	12
CONTRACT NO. 97756				
ILLINOIS FED. AID PROJECT				

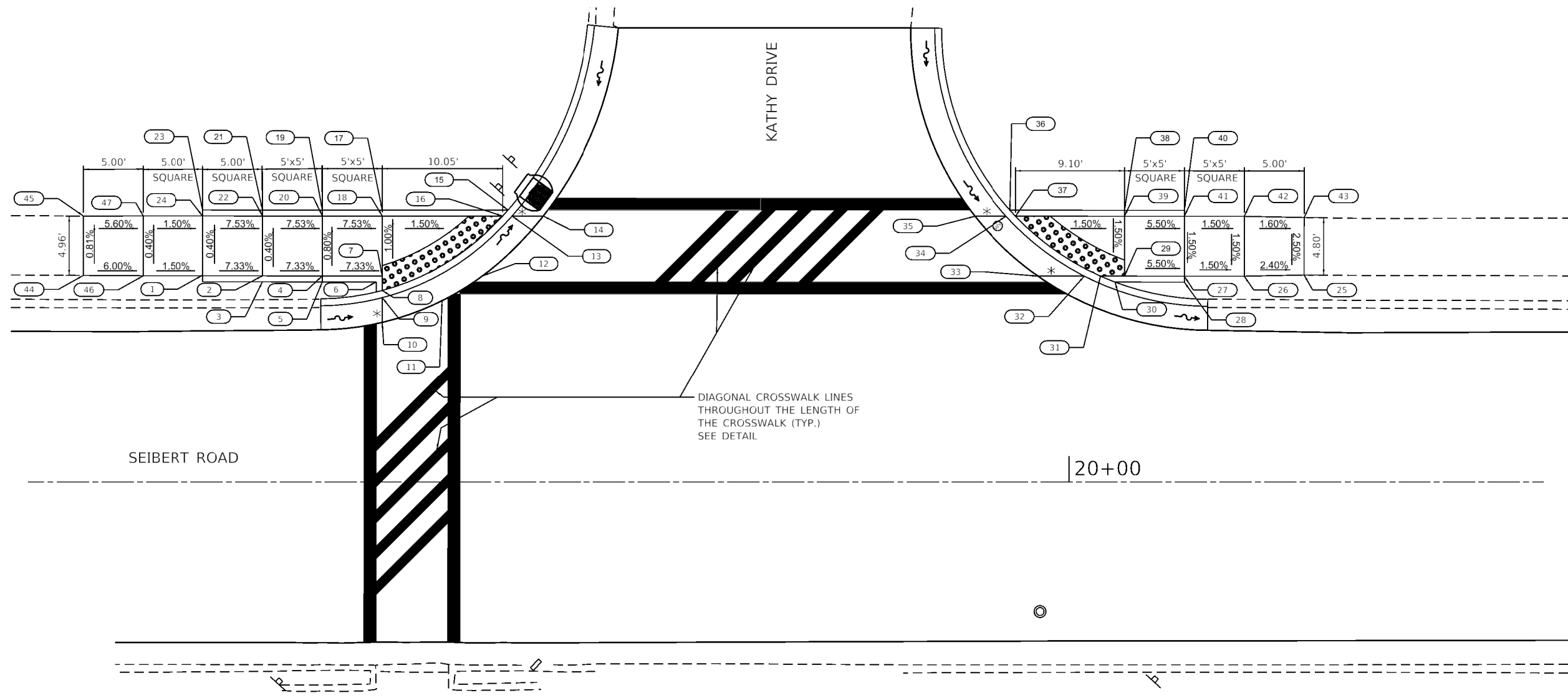

POINT #	NORTHING (Y)	EASTING (X)	ELEV	DESCRIPTION
1	687880.62	2374321.47	630.15	SIDEWALK
2	687876.88	2374324.80	629.78	SIDEWALK
3	687876.55	2374324.43	629.76	TOP OF CURB
4	687873.18	2374328.16	629.42	SIDEWALK
5	687872.85	2374327.79	629.59	TOP OF CURB
6	687869.52	2374330.82	629.42	TOP OF CURB
7	687869.48	2374331.52	629.05	SIDEWALK
8	687868.66	2374330.62	629.07	BK OF DC
9	687868.26	2374330.17	629.03	FL GUT
10	687866.87	2374328.65	629.11	EOP
11	687864.39	2374333.36	628.99	EOP
12	687863.29	2374337.16	628.94	EOP
13	687864.83	2374342.52	628.81	FL GUT
14	687862.90	2374344.27	628.91	EOP
15	687865.41	2374342.66	629.02	TOP OF CURB
16	687865.41	2374341.99	628.85	BK OF DC
17	687873.18	2374335.59	629.58	TOP OF CURB
18	687872.85	2374335.22	629.00	SIDEWALK
19	687876.88	2374332.23	629.80	TOP OF CURB
20	687876.55	2374331.86	629.38	SIDEWALK
21	687880.58	2374328.87	629.96	TOP OF CURB
22	687880.24	2374328.50	629.76	SIDEWALK
23	687884.28	2374325.50	630.18	TOP OF CURB
24	687883.93	2374325.12	630.13	SIDEWALK
44	687888.00	2374314.73	630.53	SIDEWALK
45	687891.34	2374318.40	630.49	SIDEWALK
46	687884.29	2374318.08	630.23	SIDEWALK
47	687887.62	2374321.74	630.21	SIDEWALK

POINT #	NORTHING (Y)	EASTING (X)	ELEV	DESCRIPTION
25	687812.56	2374383.40	627.16	SIDEWALK
26	687816.20	2374379.96	627.28	SIDEWALK
27	687819.90	2374376.60	627.35	SIDEWALK
28	687819.56	2374376.23	627.35	TOP OF CURB
29	687823.60	2374373.24	627.63	SIDEWALK
30	687823.84	2374372.34	628.16	TOP OF CURB
31	687825.08	2374371.89	627.66	BK OF DC
32	687826.08	2374370.98	627.62	FL GUT
33	687828.94	2374368.38	627.67	EOP
34	687834.28	2374370.28	627.80	FL GUT
35	687836.22	2374368.52	627.90	EOP
36	687834.37	2374370.87	628.34	BK OF DC
37	687833.69	2374370.82	627.84	BK OF DC
38	687827.30	2374377.31	628.34	TOP OF CURB
39	687826.96	2374376.94	627.70	SIDEWALK
40	687823.60	2374380.67	627.64	TOP OF CURB
41	687823.26	2374380.30	627.43	SIDEWALK
42	687819.56	2374383.66	627.36	SIDEWALK
43	687815.79	2374386.96	627.28	SIDEWALK

**NOTES**

- \* DENOTES 4.0% GRADE FOR GUTTER SLOPE.
- ANY EARTHWORK REQUIRED FOR THE CONSTRUCTION OF THE PROPOSED ADA RAMPS AND SIDEWALK WILL NOT BE PAID FOR SEPARATELY AND THE COSTS SHALL BE INCLUDED IN THE COST PER SQ FT FOR SIDEWALK REMOVAL.
- ANY EARTH WORK REQUIRED FOR THE CONSTRUCTION OF THE PROPOSED CURB AND GUTTER WILL NOT BE PAID FOR SEPARATELY AND THE COST SHALL BE INCLUDED IN THE COST PER FOOT FOR COMBINATION CURB AND GUTTER REMOVAL.

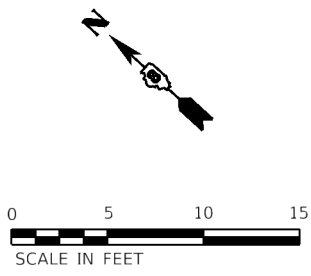

MODEL: D:\default...  
 FILE NAME: P:\2021\18088314\_CADD - DWG\44\_7\_TrafficADD\_Sheets\18088314\_rte\_detail\_sidewalk\_2.dwg



USER NAME = dllee  
 PLGT SCALE = 10.0000' / 1"  
 PLGT DATE = 3/23/2021

DESIGNED - TBP  
 DRAWN - JCL  
 CHECKED - JWS  
 DATE - FEBRUARY 2020

REVISED -  
 REVISED -  
 REVISED -  
 REVISED -



**VILLAGE OF SHILOH**

**CURB RAMP DETAIL**  
**(KATHY DRIVE)**  
 SCALE: 1"=5'  
 SHEET 2 OF 2 SHEETS  
 STA. TO STA.

F.A.U. RTE.	SECTION	COUNTY	TOTAL SHEETS	SHEET NO.
9177	19-00007-06-R5	ST. CLAIR	15	13
CONTRACT NO. 97756				
ILLINOIS FED. AID PROJECT				



SIDE ROAD	DISTANCE X
PARK RD	0'
DIAMOND CT	0'
SINN RD	0'
KATHY DR	SEE INTERSECTION DETAIL
SOUTHRIDGE DR	0'
JOHNSON RD	160'

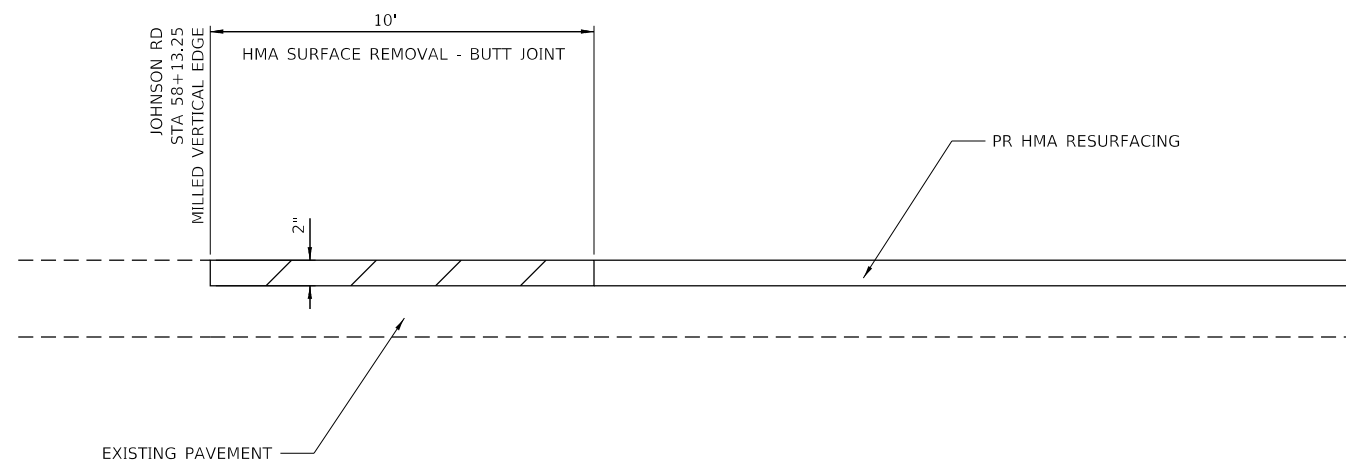

**BUTT JOINT - HMA**

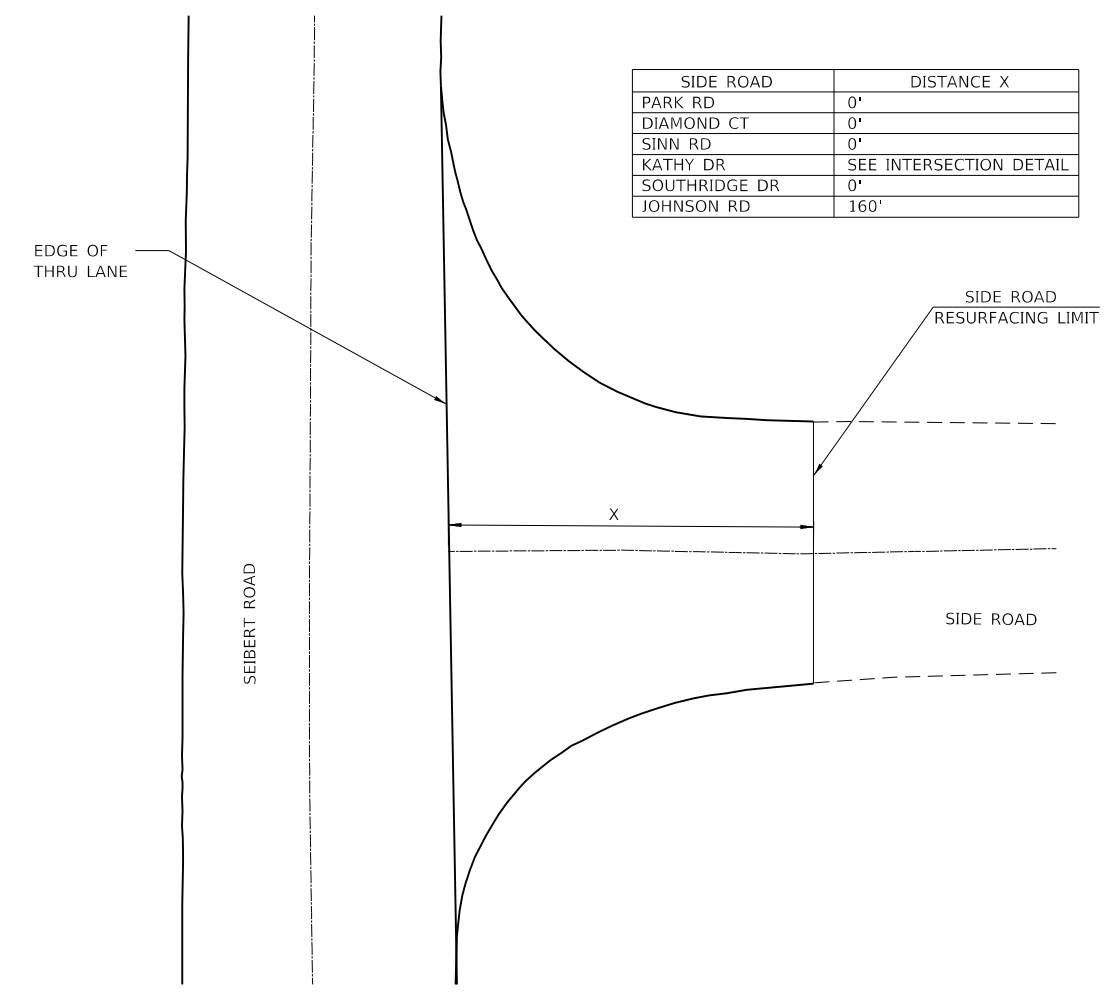

**SIDE ROAD DETAIL AND SCHEDULE**

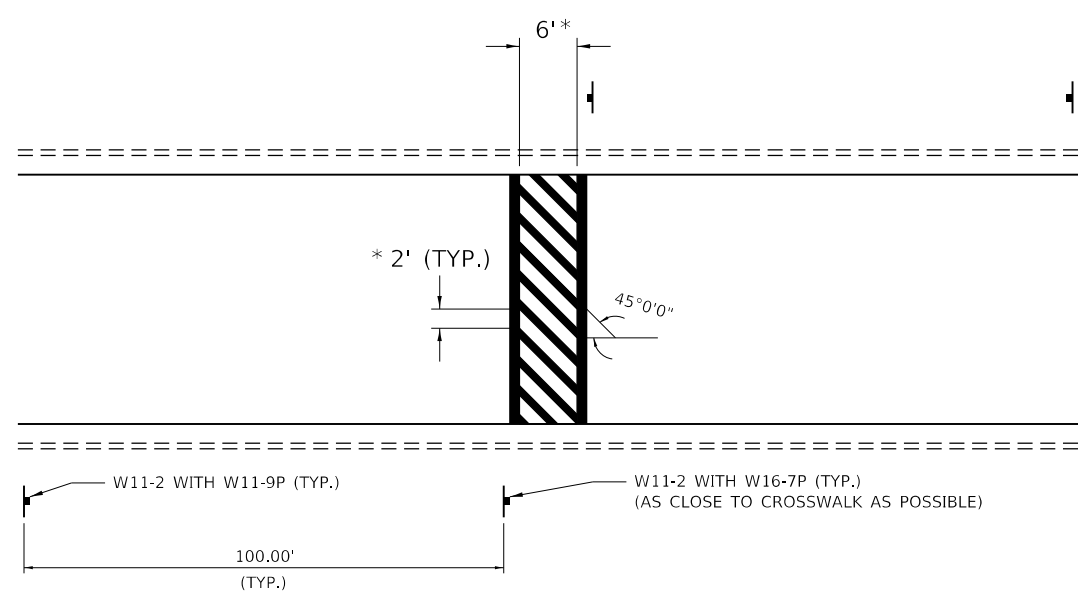

\* MEASURED BETWEEN LINES

**CROSSWALK DETAILS**

DIAMOND COURT  
MIDBLOCK NEAR PARK  
KATHY DRIVE (BOTH)  
SOUTHRIDGE DRIVE

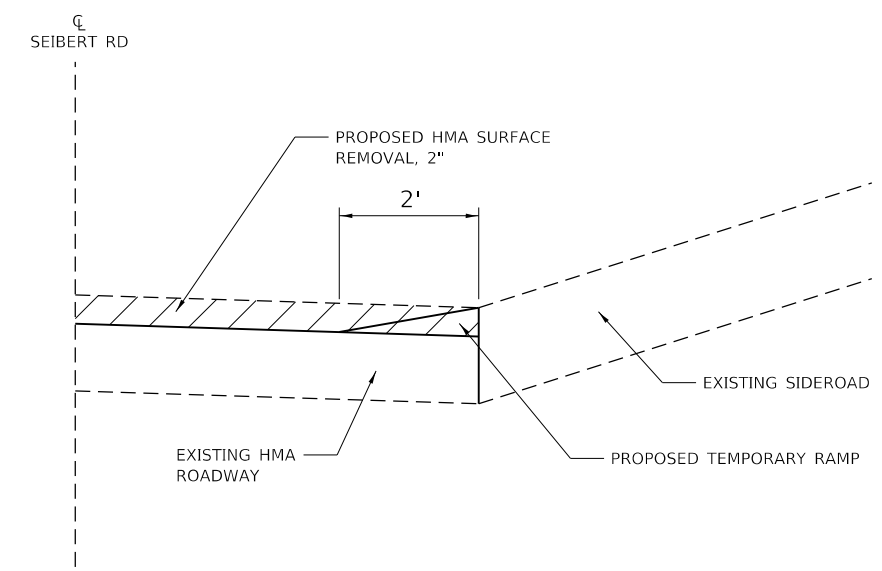

**SIDE ROAD TEMPORARY RAMP**

MODEL: D:\64\11  
FILE NAME: P:\2018\18088\14\_CADD - DWG\4.7\_Tran\CADD\_Sheets\180881-ph-detail.dgn



**TWM, INC.**  
www.twm-inc.com  
IL DESIGN FIRM  
LICENSE NO:  
184-001220

USER NAME = dlee  
DESIGNED - TBP  
DRAWN - JCL  
CHECKED - JWS  
DATE - FEBRUARY 2020

REVISED -  
REVISED -  
REVISED -  
REVISED -



**VILLAGE OF SHILOH**

**MISCELLANEOUS DETAILS**

SCALE: NONE SHEET 1 OF 1 SHEETS STA. TO STA.

F.A.U. RTE.	SECTION	COUNTY	TOTAL SHEETS	SHEET NO.
9177	19-00007-06-RS	ST. CLAIR	15	15
CONTRACT NO. 97756				
ILLINOIS FED. AID PROJECT				