

STATE OF ILLINOIS
DEPARTMENT OF TRANSPORTATION
DIVISION OF HIGHWAYS

PROPOSED HIGHWAY PLANS

FAP 337 (IL 22 - HALF DAY ROAD)
SECTION (19 & 20) LS-5
WO FAP 334 (US 12 - RAND ROAD) TO E/O QUENTIN ROAD
LANDSCAPING
LAKE COUNTY

C-91-130-09
PROJECT: NHF-0337(009)

ELA TOWNSHIP
SW 1/4, T 43 N, R 10 E

F.A.P. RTE.	SECTION	COUNTY	TOTAL SHEETS	SHEET NO.
337	(19 & 20) LS-5	LAKE	17	1
FED. ROAD DIST. NO. 1		ILLINOIS	FED. AID PROJECT	
D-91-130-99		CONTRACT 60F55		

FOR INDEX OF SHEETS,
SEE SHEET NO. 2

PROJECT IS LOCATED
IN LAKE ZURICH

SCALE: 1:500

METRIC RATIOS

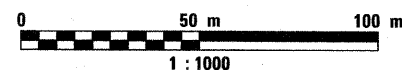
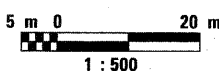
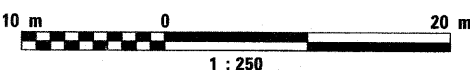
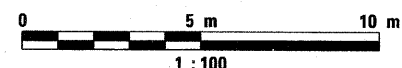
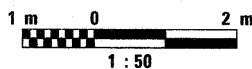

FULL SIZE PLANS HAVE BEEN PREPARED USING STANDARD
ENGINEERING SCALES, REDUCED SIZED PLANS WILL NOT
CONFORM TO STANDARD SCALES, IN MAKING MEASUREMENTS
ON REDUCED PLANS, THE ABOVE SCALES MAY BE USED.

J.U.L.I.E.
JOINT UTILITY LOCATION INFORMATION FOR EXCAVATION
1-800-892-0123

PROJECT BEGINS
STA. 7+600

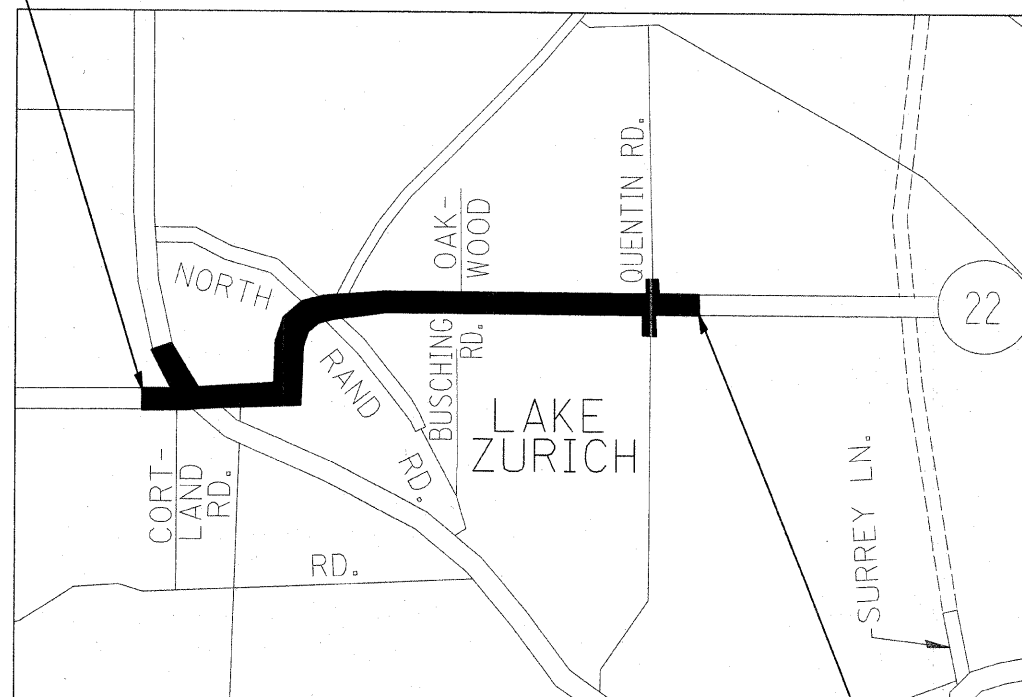

PROJECT LENGTH = 1.6 MILES

PROJECT ENDS
STA. 12+875

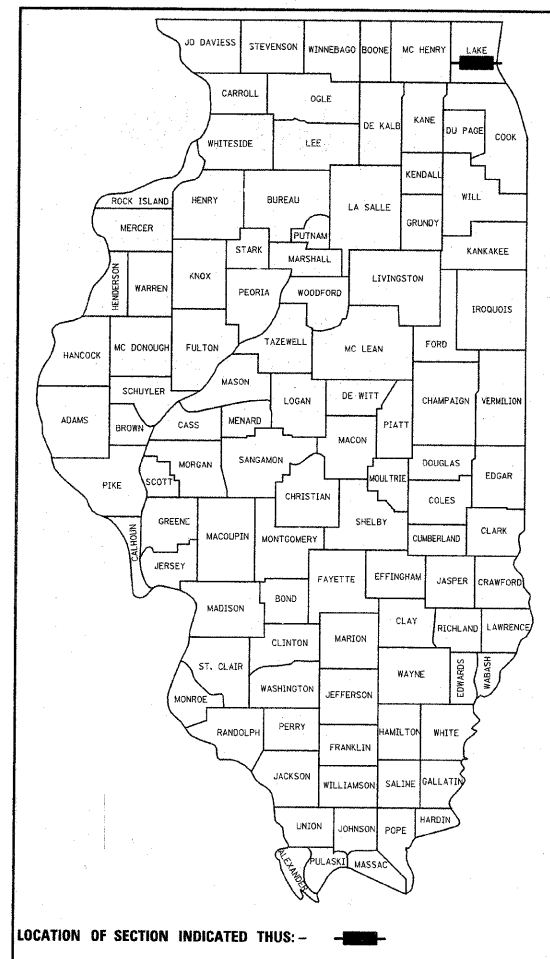

LOCATION OF SECTION INDICATED THUS: -

STATE OF ILLINOIS
DEPARTMENT OF TRANSPORTATION
DIVISION OF HIGHWAYS

SUBMITTED March 25, 2009
Dave O'Neil
DEPUTY DIRECTOR OF HIGHWAYS, REGION ENGINEER
May 8, 2009
Charles J. Ingersoll
ENGINEER OF DESIGN AND ENVIRONMENT
May 8, 2009
Christine M. Reed
DIRECTOR OF HIGHWAYS, CHIEF ENGINEER

DISTRICT ONE BUREAU OF MAINTENANCE: J. STUMPNER
MAINTENANCE LANDSCAPE DESIGNER: R. WANNER /M. DEL ROSARIO (847) 705-4171

CONTRACT NO. 60F55

TRAFFIC DATA
US 12 (RAND RD) TO QUENTIN RD
2009 ADT = 14,200
POSTED SPEED LIMIT = 40 MPH

PRINTED BY THE AUTHORITY
OF THE STATE OF ILLINOIS

F.A.P. RTE.	SECTION	COUNTY	TOTAL SHEETS	SHEET NO.
337	(19&20LS-5	LAKE	17	2
STA.		TO STA.		
FED. ROAD DIST. NO. 1		ILLINOIS FED. AID PROJECT		

CONTRACT 60F55

INDEX OF SHEETS

SHEET NO.	DESCRIPTION
1	TITLE SHEET
2	INDEX OF SHEETS, GENERAL NOTES AND STATE STANDARDS
3-4	SUMMARY OF QUANTITIES
5	CALENDAR OF CONSTRUCTION
6-17	LANDSCAPING PLAN

GENERAL NOTES

- THE LOCATIONS OF EXISTING UTILITIES, AS SHOWN ON THE DRAWINGS, REPRESENT DATA RECEIVED FROM VARIOUS SOURCES. IT IS NOT GUARANTEED TO BE CORRECT OR ALL INCLUSIVE. THE CONTRACTOR MUST CONDUCT HIS OWN INVESTIGATIONS INTO THE LOCATION, SIZE, DEPTH, AND NATURE OF ANY AND ALL EXISTING UTILITIES WHICH MAY IMPACT THE WORK UNDER THIS CONTRACT. ANY EXISTING UTILITIES WHICH ARE TO REMAIN IN SERVICE MUST BE FULLY PROTECTED BY THE CONTRACTOR AND ANY DAMAGE CAUSED BY THE CONSTRUCTION MUST BE IMMEDIATELY REPAIRED AT THE CONTRACTOR'S EXPENSE TO THE SATISFACTION OF THE ENGINEER. THE CONTRACTOR WILL BE RESPONSIBLE FOR THE PROTECTION OF ANY AND ALL SURFACE AND UNDERGROUND UTILITIES, EVEN THOUGH THEY MAY NOT BE IDENTIFIED ON THE PLANS.
- BEFORE STARTING ANY EXCAVATION, THE CONTRACTOR SHALL CALL "J.U.L.I.E." AT (800) 892-0123 FOR FIELD LOCATIONS OF BURIED ELECTRIC, TELEPHONE AND GAS UTILITIES. (48 HOUR NOTIFICATION IS REQUIRED).
- THE CONTRACTOR WILL NOT BE ALLOWED TO SET UP A YARD OR FIELD OFFICE ON STATE PROPERTY WITHOUT WRITTEN PERMISSION FROM IDOT.
- THE CONTRACTOR MUST USE CARE IN GRADING OR EXCAVATING NEAR ANY AND ALL EXISTING ITEMS THAT WILL NOT BE REMOVED. ANY DAMAGE DONE TO EXISTING ITEMS BY THE CONTRACTOR MUST BE REPAIRED BY THE CONTRACTOR AT THE CONTRACTOR'S OWN EXPENSE.
- ANY EXISTING OR PROPOSED STORM SEWER DAMAGED BY THE CONTRACTOR DURING CONSTRUCTION SHALL BE REPLACED TO THE SATISFACTION OF THE ENGINEER AT THE CONTRACTOR'S EXPENSE.
- THE CONTRACTOR SHALL NOT PARK ANY EQUIPMENT OR STORE ANY MATERIAL WITHIN 50 FEET OF ANY RAILROAD.
- IT SHALL BE THE CONTRACTOR'S RESPONSIBILITY TO VERIFY ALL DIMENSIONS AND CONDITIONS EXISTING IN THE FIELD PRIOR TO CONSTRUCTION AND ORDERING OF MATERIALS.
- DO NOT SCALE PLANS FOR CONSTRUCTION DIMENSIONS.
- THE CONTRACTOR MUST TAKE ALL NECESSARY SAFETY PRECAUTIONS TO PROTECT AND PROVIDE ACCESS TO ADJUTING PROPERTY, UTILITIES, PEDESTRIANS, AND VEHICULAR TRAFFIC.
- DURING CONSTRUCTION OPERATIONS, IF ANY LOOSE MATERIAL IS DEPOSITED IN THE FLOW LINE OF DRAINAGE STRUCTURES SUCH THAT THE NATURAL FLOW OF WATER IS OBSTRUCTED, THE MATERIAL SHALL BE REMOVED AT THE CLOSE OF EACH WORKING DAY. AT THE CONCLUSION OF CONSTRUCTION OPERATIONS, ALL UTILITY STRUCTURES SHALL BE FREE FROM DUST AND DEBRIS. THE WORK SPECIFIED ABOVE WILL NOT BE PAID SEPARATELY BUT SHALL BE INCLUDED IN THE COST OF THE CONTRACT.
- APPROVED WATERING EQUIPMENT SHALL BE AT THE SITE OF THE WORK AND IN OPERATIONAL CONDITION PRIOR TO STARTING THE PLANTING OPERATION AND DURING ALL PLANTING OPERATIONS OR PLANTING WILL NOT BE ALLOWED.
- THE CONTRACTOR SHALL PROTECT ALL EXISTING PLANT MATERIAL FROM DAMAGE FOR WHICH THE CONTRACT DOES NOT PROVIDE REMOVAL. THE PROTECTION OF EXISTING PLANT MATERIAL AND THE REPAIR OR REPLACEMENT OF EXISTING PLANT MATERIAL DAMAGED BY THE CONTRACTOR SHALL BE DONE IN ACCORDANCE WITH THE REQUIREMENTS OF SECTION 201 OF THE IDOT STANDARD SPECIFICATIONS UNLESS OTHERWISE NOTED.
- THE CONTRACTOR SHALL REPAIR IN KIND ANY OF THE VARIOUS EXISTING GRASS/ WILDFLOWER AREAS DAMAGED AS A RESULT OF LANDSCAPE OPERATIONS. THIS WORK WILL NOT BE PAID FOR SEPARATELY, BUT THE COSTS SHALL BE CONSIDERED AS INCLUDED IN THE CONTRACT UNIT PRICES FOR THE CONSTRUCTION ITEMS INVOLVED, AND NO ADDITIONAL COMPENSATION WILL BE ALLOWED. THE CONTRACTOR SHALL UTILIZE THE VARIOUS SEED MIXTURES INCLUDED IN THE SPECIFICATIONS.
- THE CONTRACTOR WILL NOT BE ALLOWED TO PROCEED WITH ANY PLANTING WORK UNTIL ALL UTILITY OWNERS FIELD LOCATE THEIR FACILITIES WHICH MAY INTERFERE WITH CONSTRUCTION OPERATIONS. THE ACTUAL LOCATION OF PROPOSED LANDSCAPING WILL BE ADJUSTED IN THE FIELD TO AVOID UTILITIES.
- CONTRACTOR SHALL REPAIR IN KIND ANY OF THE VARIOUS GRASS AREAS DAMAGED AS A RESULT OF LANDSCAPE OPERATIONS.
- THE CONTRACTOR SHALL CONTACT THE DISTRICT ONE TRAFFIC CONTROL SUPERVISOR AT (847) 705-4470 A MINIMUM OF 72 HOURS IN ADVANCE OF BEGINNING WORK.

17. UNDERBRUSH OR DEBRIS AT PLANTING LOCATIONS SHALL BE REMOVED AND DISPOSED OF IN ACCORDANCE WITH SECTION 202.03 OF THE IDOT STANDARD SPECIFICATIONS. THIS WORK WILL NOT BE PAID FOR SEPARATELY, BUT THE COSTS SHALL BE CONSIDERED AS INCLUDED IN THE CONTRACT UNIT PRICES FOR THE CONSTRUCTION ITEMS INVOLVED, AND NO ADDITIONAL COMPENSATION WILL BE ALLOWED.

18. CONTRACTOR SHALL PERFORM DUE DILIGENCE IN LOCATING SPECIFIED PLANT MATERIAL.

19. NO SUBSTITUTIONS OF PLANT MATERIAL, QUANTITIES OR SIZES SHALL BE ALLOWED UNLESS APPROVED BY THE ENGINEER.

20. WHERE MULCH BEDS ARE SPECIFIED, ALL EXISTING GRASS, WEEDS, AND DEBRIS ARE TO BE REMOVED AND THE BEDS TILLED TO A DEPTH OF 6 INCHES PRIOR TO PLACING PROPOSED PLANTS. FOLLOWING PLANTING, BEDS SHALL BE MULCHED TO A DEPTH OF 4 INCHES. THIS WORK WILL BE CONSIDERED INCLUDED IN THE CONTRACT UNIT PRICE FOR THE PLANTING ITEMS.

21. THE PLANT LOCATIONS SHOWN ON THE PLANS ARE APPROXIMATE ONLY. THE EXACT LOCATIONS SHALL BE ADJUSTED AS REQUIRED IN THE FIELD BY THE ENGINEER.

22. LANDSCAPE CONTRACTOR SHALL STAKE THE LOCATION OF ALL TREES, SHRUBS, AND PERENNIAL BEDS BY QUALIFIED PERSONNEL. ENGINEER WILL CONTACT THE ROADSIDE DEVELOPMENT UNIT (847-705-4171) TO APPROVE THE LAYOUT PRIOR TO INSTALLATION. ALLOW A MINIMUM OF SEVEN (7) DAYS PRIOR TO INSTALLATION FOR APPROVAL.

23. TREE PLANTING METHOD WILL BE APPROVED BY THE ENGINEER PRIOR TO FULL SCALE INSTALLATION.

24. NO PLANT MATERIAL IS TO BE INSTALLED ON SITE WITHOUT APPROPRIATE IDOT ORANGE PLANT SEAL.

25. ALL TREE AND SHRUB BEDS SHALL RECEIVE A MINIMUM 4 INCHES OF MULCH. NEWLY INSTALLED TREES NOT LOCATED WITHIN A BED SHALL BE MULCHED WITH A FOUR-FOOT DIAMETER RING. THIS WORK WILL NOT BE PAID FOR SEPARATELY, BUT THE COSTS SHALL BE CONSIDERED AS INCLUDED IN THE CONTRACT UNIT PRICES FOR THE CONSTRUCTION ITEMS INVOLVED, AND NO ADDITIONAL COMPENSATION WILL BE ALLOWED.

26. UNLESS NOTED OTHERWISE, ALL SHRUBS SHALL BE PLANTED IN MULCHED BED. THE EDGE OF THE MULCH BED SHALL EXTEND A MINIMUM OF THREE (3) FEET BEYOND THE CENTERS OF THE PERIPHERAL PLANTS IN THE BEDS.

27. WHEN A TREE IS LOCATED IN A SHRUB BED, THE MINIMUM DISTANCE BETWEEN THE TREE AND THE ADJACENT SHRUBS SHALL BE SIX (6) FEET.

STATE STANDARDS

- | | |
|----------------------|--|
| 000001-05 | STANDARD SYMBOLS, ABBREVIATIONS AND PATTERNS |
| 701001-02 | OFF-RD OPERATIONS, 2L, 2W, MORE THAN 4.5 M (15') AWAY |
| 701006-03 | OFF-RD OPERATIONS, 2L, 2W, 15' TO EOP |
| 701101-02 | OFF-RD OPERATIONS, MULTI LANE, LESS THAN 15' TO EOP |
| 701006-02 | OFF-RD OPERATIONS, MULTI LANE, MORE THAN 15' AWAY |
| 701311-03 | LANE CLOSURE 2L, 2W - MOVING OPERATIONS DAY ONLY |
| 701701-06 | URBAN LANE CLOSURE MULTI LANE INTERSECTION |
| 701901-01 | TRAFFIC CONTROL DEVICES |
| 701201-03 | |
| 701501-05 | |

REVISIONS		ILLINOIS DEPARTMENT OF TRANSPORTATION IL. RTE. 22: W/O US 12 (RAND RD.) TO E/O QUENTIN RD. INDEX OF SHEETS/GENERAL NOTES SCALE: DRAWN BY DATE: 3/26/2009 CHECKED BY
NAME	DATE	

*REF-
*REF-
*REF-

SUMMARY OF QUANTITIES

FIP PLAN	SECTION	COUNTY	TOTAL SHEETS	SHEET NO
337	(19&20)LS-5	LAKE	17	3
STA.		TO STA.		
EXISTING CONDITIONS:				

CONTRACT 60F55

SUMMARY OF QUANTITIES			URBAN 80% FED. 20% STATE TOTAL			CONSTRUCTION TYPE CODE		
CODE NO	ITEM	UNIT	QUANTITIES	Y003				
D2002770	EVERGREEN, PINUS NIGRA ARNOLD'S SENTINEL (ARNOLD'S SENTINEL COLUMNAR AUSTRIAN PINE), 6' HEIGHT, BALLED AND BURLAPPED	EACH	6	6				
20101700	SUPPLEMENTAL WATERING	UNIT	15	15				
25000400	NITROGEN FERTILIZER NUTRIENT	POUND	1	1				
25000500	PHOSPHORUS FERTILIZER NUTRIENT	POUND	1	1				
25000600	POTASSIUM FERTILIZER NUTRIENT	POUND	1	1				
67100100	MOBILIZATION	L SUM	1	1				
A2000320	TREE, ACER MIYABEI MORTON (STATE STREET MIYABE MAPLE), 2-1/2" CALIPER, BALLED AND BURLAPPED	EACH	14	14				
A2002370	TREE, BETULA NIGRA (RIVER BIRCH), 8' HEIGHT, CLUMP FORM, BALLED AND BURLAPPED	EACH	3	3				
A2002820	TREE, CATALPA SPECIOSA (NORTHERN CATALPA), 2-1/2" CALIPER, BALLED AND BURLAPPED	EACH	13	13				
A2002920	TREE, CELTIS OCCIDENTALIS (COMMON HACKBERRY), 2-1/2" CALIPER, BALLED AND BURLAPPED	EACH	26	26				
A2004512	TREE, GINKGO BILOBA AUTUMN GOLD (AUTUMN GOLD GINKGO), 2" CALIPER, BALLED AND BURLAPPED	EACH	16	16				
A2004720	TREE, GLEDITSIA TRIACANTHOS INERMIS SHADEMASTER (SHADEMASTER THORNLESS COMMON HONEYLOCUST), 2-1/2" CALIPER, BALLED AND BURLAPPED	EACH	12	12				
A2005020	TREE, GYMNOCLADUS DIOICUS (KENTUCKY COFFEETREE), 2-1/2" CALIPER, BALLED AND BURLAPPED	EACH	31	31				
A2006520	TREE, QUERCUS BICOLOR (SWAMP WHITE OAK), 2-1/2" CALIPER, BALLED AND BURLAPPED	EACH	16	16				
A2006720	TREE, QUERCUS MACROCARPA (BUR OAK), 2-1/2" CALIPER, BALLED AND BURLAPPED	EACH	21	21				
A2007620	TREE, TAXODIUM DISTICHUM (COMMON BALD CYPRESS), 2-1/2" CALIPER, BALLED AND BURLAPPED	EACH	5	5				
A2007920	TREE, TILIA AMERICANA REDMOND (REDMOND AMERICAN LINDEN), 2-1/2" CALIPER, BALLED AND BURLAPPED	EACH	15	15				
A2008518	TREE, ULMUS MORTON GLOSSY (TRIUMPH ELM), 2" CALIPER, BALLED AND BURLAPPED	EACH	16	16				
A2008818	TREE, ULMUS AMERICANA VALLEY FORGE (VALLEY FORGE AMERICAN ELM), 2" CALIPER, BALLED AND BURLAPPED	EACH	11	11				
A2018720	TREE, ULMUS CARPINIFOLIA MORTON, (ACCOLADE ELM), 2-1/2" CALIPER, BALLED AND BURLAPPED	EACH	18	18				

SUMMARY OF QUANTITIES			URBAN 80% FED. 20% STATE TOTAL			CONSTRUCTION TYPE CODE		
CODE NO	ITEM	UNIT	QUANTITIES	Y003				
B2000766	TREE, AMELANCHIER X GRANDIFLORA AUTUMN BRILLIANCE (AUTUMN BRILLIANCE SERVICE BERRY), 6' HEIGHT, SHRUB FORM, BALLED AND BURLAPPED	EACH	9	9				
B2001620	TREE, CRATAEGUS CRUSGALLI INERMIS (THORN LESS COCKSPUR HAWTHORN), 2-1/2" CALIPER TREE FORM, BALLED AND BURLAPPED	EACH	22	22				
B2004516	TREE, MALUS RED JEWEL (RED JEWEL CRAB APPLE), 2" CALIPER, TREE FORM, BALLED AND BURLAPPED	EACH	21	21				
B2004816	TREE, MALUS SARGENTII (SARGENT CRABAPPLE), 2" CALIPER, TREE FORM, BALLED AND BURLAPPED	EACH	12	12				
B2005416	TREE, PRUNUS VIRGINIANA SCHUBERT (SCHUBERT CHOKEBERRY), 2" CALIPER, TREE FORM, BALLED AND BURLAPPED	EACH	5	5				
B2006120	TREE, SYRINGA PEKINENSIS MORTON (CHINA SNOW PEKING LILAC), 2-1/2" CALIPER, TREE FORM, BALLED AND BURLAPPED	EACH	16	16				
B2006316	TREE, SYRINGA RETICULATA IVORY SILK (IVORY SILK JAPANESE TREE LILAC), 2" CALIPER, TREE FORM, BALLED AND BURLAPPED	EACH	10	10				
C2000436	SHRUB, ARONIA ARBUTIFOLIA BRILLIANT ISSIMA (BRILLANT RED CHOKEBERRY), 3' HEIGHT, BALLED AND BURLAPPED	EACH	225	225				
C2011036	SHRUB, SYRINGA PATULA MISS KIM (MISS KIM MANCHURIAN LILAC), 3' HEIGHT, BALLED AND BURLAPPED	EACH	63	63				
C2012036	SHRUB, VIBURNUM DENTATUM SYNNESTVEDT (CHICAGO LUSTRE ARROWWOOD VIBURNUM), 3' HEIGHT, BALLED AND BURLAPPED	EACH	238	238				
C2C05818	SHRUB, RHUS AROMATICA GRO-LOW (GRO-LOW FRAGRANT SUMAC), 18" WIDTH, CONTAINER	EACH	70	70				
D2001972	EVERGREEN, PICEA GLAUCA DENSATA (BLACK HILLS SPRUCE), 6' HEIGHT, BALLED AND BURLAPPED	EACH	24	24				
D2002172	EVERGREEN, PICEA PUNGENS (COLORADO SPRUCE), 6' HEIGHT, BALLED AND BURLAPPED	EACH	42	42				
D2002472	EVERGREEN, PINUS FLEXILIS VANDERWOLF'S PYRAMID (VANDERWOLF'S PYRAMID LIMBER PINE), 6' HEIGHT, BALLED AND BURLAPPED	EACH	12	12				
D2002560	EVERGREEN, PINUS MUGO (MUGO PINE), 5' HEIGHT, BALLED AND BURLAPPED	EACH	9	9				
D2002772	EVERGREEN, PINUS NIGRA (AUSTRIAN PINE), 6' HEIGHT, BALLED AND BURLAPPED	EACH	46	46				
K0026700	TREE CARE	EACH	80	80				
K0026850	PERENNIAL PLANT CARE	SQ YD	25	25				

Y:\667004\CH201\CH201\BID\DEL ROSA\ARJONES\601030008\137000-INT-INC\delos.dgn

SUMMARY OF QUANTITIES

PIP ROUTE	SECTION	COUNTY	TOTAL SHEETS	SHEET NO
337	(19&20)LS-5	LAKE	17	4
STA.		TO STA.		
EXISTING CONDITIONS:				
CONTRACT 60F55				

SUMMARY OF QUANTITIES			CONSTRUCTION TYPE CODE			
CODE NO	ITEM	UNIT	QUANTITIES	Y003		
K0030450	PERENNIAL PLANTS, DAFFODIL BULBS	UNIT	1	1		
K0038000	PERENNIAL PLANTS, WETLAND EMERGENT TYPE	UNIT	12.54	12.54		
K1003660	MOWING CYCLES	EACH	3	3		
X0301407	PERENNIAL PLANTS, GALLON POT	UNIT	1.3	1.3		
X0322324	WEED CONTROL, TEASEL	POUND	1.3	1.3		
X0322326	WEED CONTROL, THISTLE	POUND	10.5	10.5		
X0323044	COARSE SAND PLACEMENT	SQ YD	25	25		
X0325604	WEED CONTROL, PRE-EMERGENT HERBICIDE	GALLON	1	1		
B2Q07066	TREE, MALUS PURPLE PRINCE (PURPLE PRINCE CRABAPPLE), 2" CALIPER, TREE FORM, BALLED AND BURLAPPED	EACH	18	18		
A2006618	TREE, QUERCUS IMBRICARIA, (SHINGLE OAK) 2-1/2" CALIPER, BALLED AND BURLAPPED	EACH	12	12		

SUMMARY OF QUANTITIES				CONSTRUCTION TYPE CODE		
CODE NO	ITEM	UNIT	TOTAL QUANTITIES			

3/26/2009 9:28 AM \\P01020000\113600-sm1-rndsc.dgn

F.A.P. RTE.	SECTION	COUNTY	TOTAL SHEETS	SHEET NO.
337	(19 & 20) LS-5	LAKE	17	5
STA.		TO STA.		
FED. ROAD DIST. NO. 1		ILLINOIS FED. AID PROJECT		

CONTRACT 60F55

Calendar of Construction and Establishment Work

Phases	Phase I	Phase II				Phase III					Phase IV	Phase V					Phase VI	Phase VII							
Year	2009										2010										2011				
Item	August	September	October	November	December	January	February	March	April	May	June	July	August	September	October	November	December	January	February	March	April	May			
Plant Material																									
Submit completed plant inspection forms to IDOT by Aug 30																									
Place order for perennials																									
Place order for bulbs																									
Perennial Bed Preparation																									
Turf Removal (Round-up or sod cutting) Round-Up: 2 weeks prior to planting																									
Sand Placement																									
Fertilizer Nutrients Placement																									
Perennial Plant Planting																									
Ornamental Herbaceous, Prairie, Wetland Emergent & Sedge Meadow Plants: May 1 - June 15																									
Bulbs: Oct 15 - Nov 30																									
Tree / Shrub Planting																									
Spring plantings of balled and burlapped & container stock: March 15 - May 15																									
Seedlings, broadleaf evergreens, vines & willow, poplar, oak, alder, birch, hawthorn, red maple, cherry & pear only in spring: March 15 - May 15																									
Evergreens (spring): March 15 - April 30																									
Fall planting of balled and burlapped: Oct 15 - Nov 30																									
Evergreens (fall): August 15 - Oct 15																									
Plant Care																									
Perennial Plant Care: June 15 to Oct 15																									
Existing Tree Care: Oct 1- Oct 31																									
Supplemental Watering: as determined by the RE during June 1 - Sept 30																									
Mowing																									
Mowing Cycle (7 hectares each cycle; twice a year): April 15 to Aug 15																									
Herbicides																									
Pre-emergent: Use when planting trees and shrubs																									
Growth Suppressant: Spray 10 days after mowing in late May and late Aug																									
Replacements (if necessary)																									
Place order for perennials and submit inspection forms to IDOT																									
Ornamental Herbaceous, Prairie, Wetland Emergent & Sedge Meadow Plants: Aug 15 - Sept 15																									
Submit completed plant inspection forms to IDOT by Oct 15																									
Fall planting of balled and burlapped: Nov 1 - Nov 30																									
Evergreens (spring): March 15 - April 30																									
Spring plantings of balled and burlapped: March 15 - May 15																									
Seedlings, broadleaf evergreens, vines & willow, poplar, oak, alder, birch, hawthorn, red maple, cherry & pear only in spring: March 15 - May 15																									

REVISIONS	
NAME	DATE

ILLINOIS DEPARTMENT OF TRANSPORTATION
IL. RTE. 22:
W/O US 12 (RAND RD.) TO
E/O QUENTIN RD.
CALENDAR OF CONSTRUCTION
SCALE: DRAWN BY
DATE: 3/26/2009 CHECKED BY

F.A.P. RTE.	SECTION	COUNTY	TOTAL SHEETS	SHEET NO.
337	(19 & 20) LS-5	LAKE	17	6
STA. 7+550		TO STA. 7+900		
FED. ROAD DIST. NO.		ILLINOIS FED. AID PROJECT		
CONTRACT 60F55				

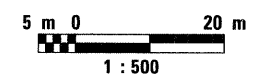
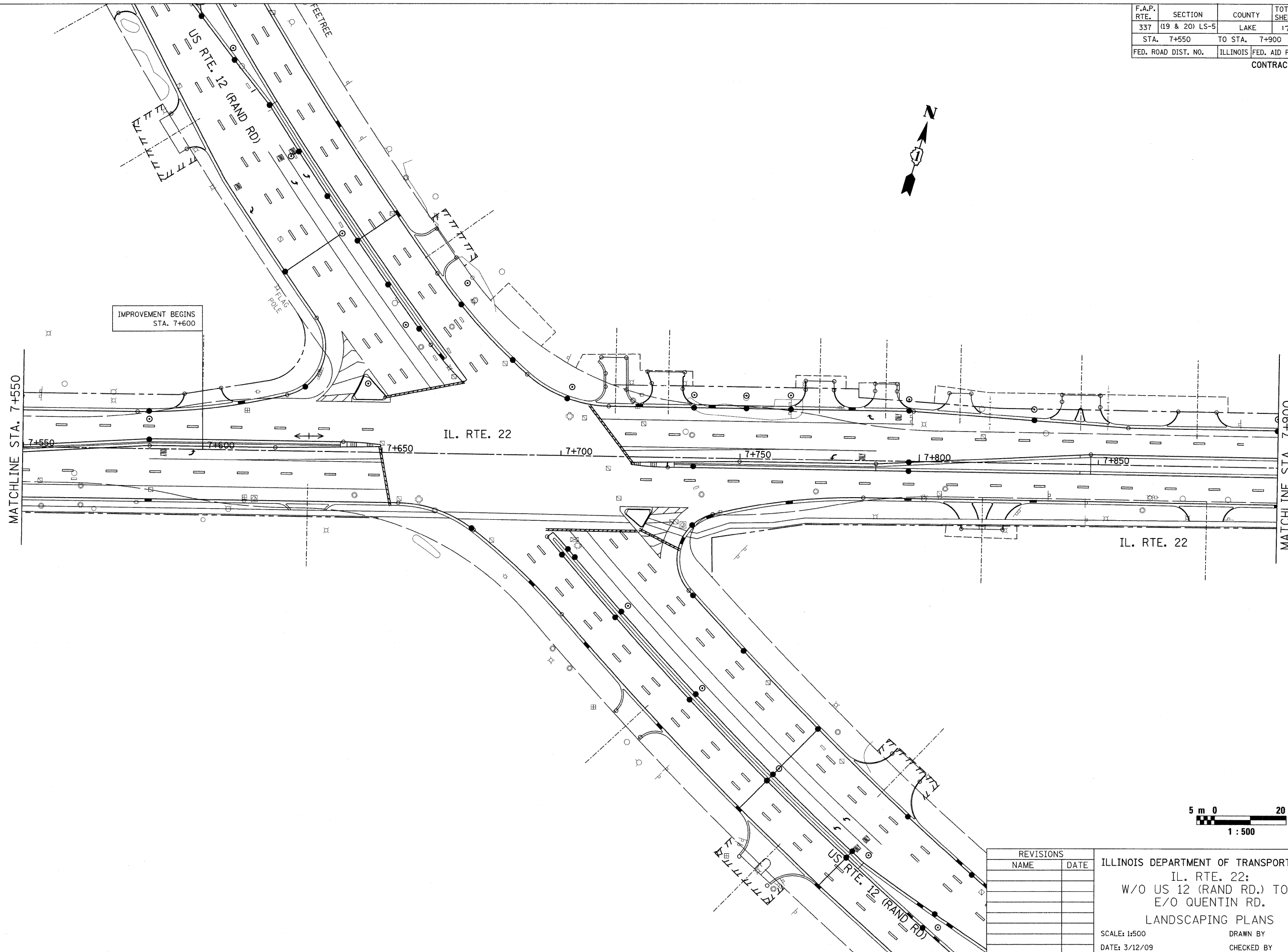

REVISIONS	
NAME	DATE

ILLINOIS DEPARTMENT OF TRANSPORTATION
 IL. RTE. 22:
 W/O US 12 (RAND RD.) TO
 E/O QUENTIN RD.
 LANDSCAPING PLANS
 SCALE: 1:500
 DATE: 3/12/09
 DRAWN BY
 CHECKED BY

F.A.P. RTE.	SECTION	COUNTY	TOTAL SHEETS	SHEET NO.
337	(19 & 20) LS-5	LAKE	17	7
STA. 7+900		TO STA. 8+550		
FED. ROAD DIST. NO.	ILLINOIS	FED. AID PROJECT	CONTRACT 60F55	

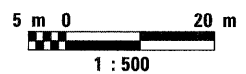
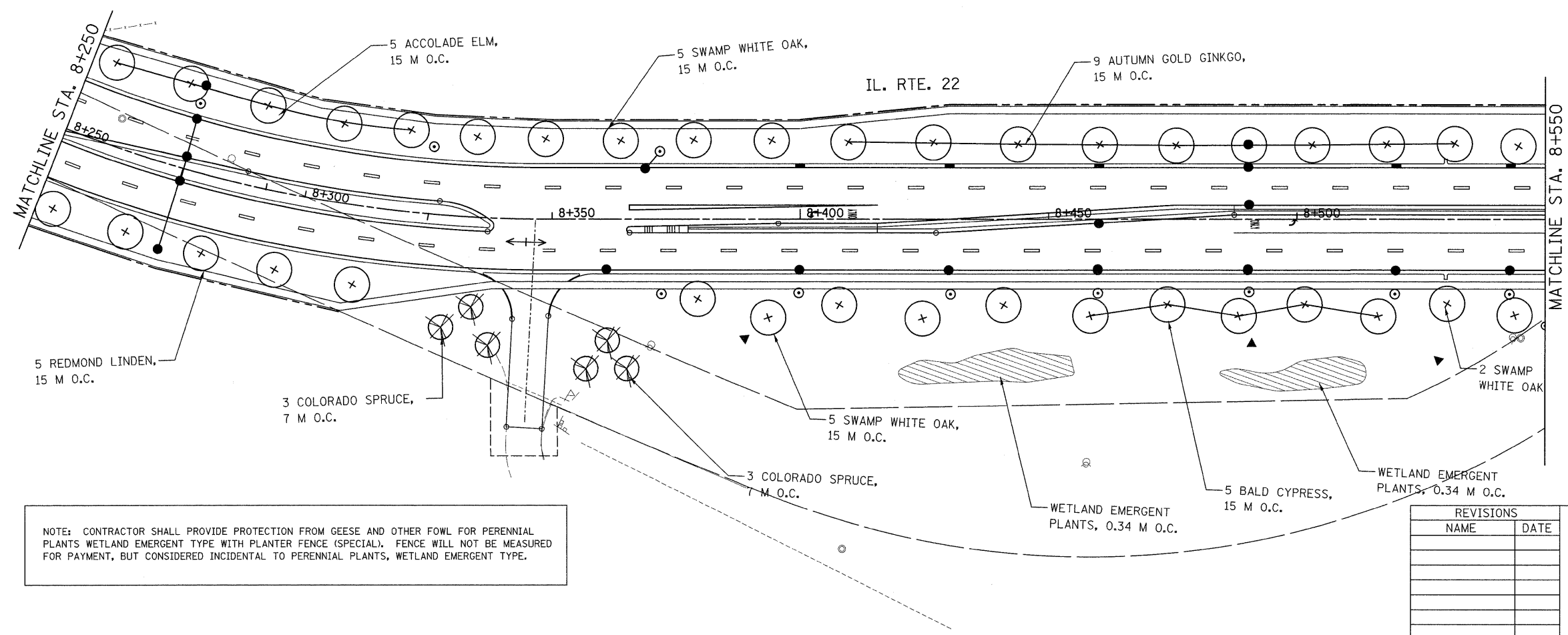
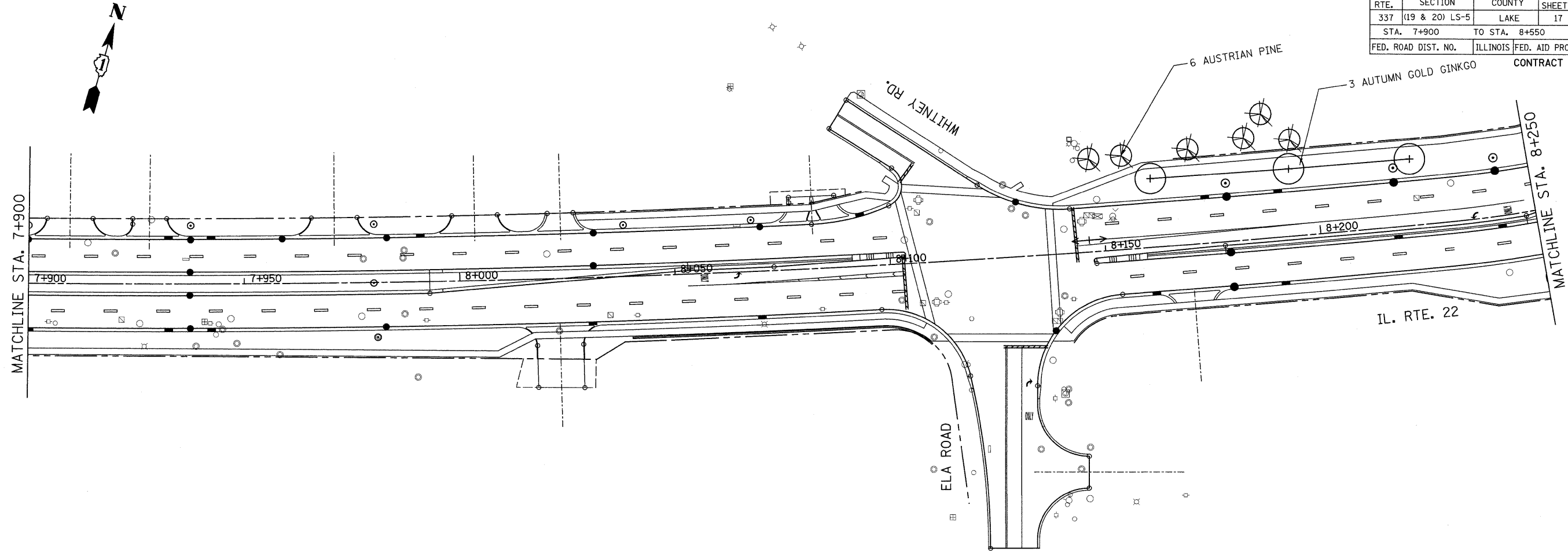

NOTE: CONTRACTOR SHALL PROVIDE PROTECTION FROM GEESE AND OTHER FOWL FOR PERENNIAL PLANTS WETLAND EMERGENT TYPE WITH PLANTER FENCE (SPECIAL). FENCE WILL NOT BE MEASURED FOR PAYMENT, BUT CONSIDERED INCIDENTAL TO PERENNIAL PLANTS, WETLAND EMERGENT TYPE.

REVISIONS	
NAME	DATE

ILLINOIS DEPARTMENT OF TRANSPORTATION
 IL. RTE. 22:
 W/O US 12 (RAND RD.) TO
 E/O QUENTIN RD.
 LANDSCAPING PLANS
 SCALE: 1:500
 DATE: 3/12/09
 DRAWN BY
 CHECKED BY

F.A.P. RTE.	SECTION	COUNTY	TOTAL SHEETS	SHEET NO.
337	(19 & 20) LS-5	LAKE	17	8
STA. 8+550		TO STA. 8+900		
FED. ROAD DIST. NO.		ILLINOIS	FED. AID PROJECT	
CONTRACT 60F55				

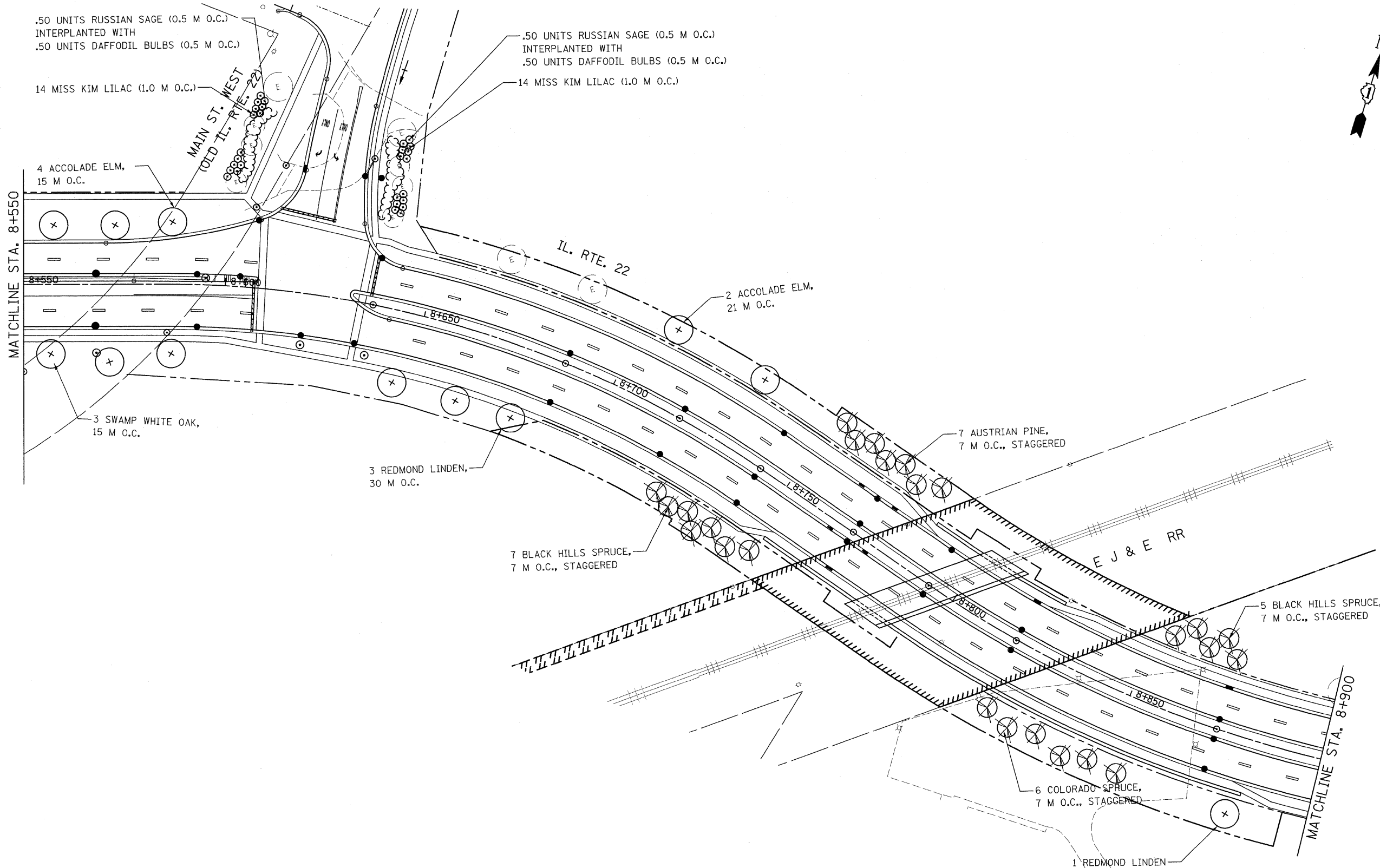

NOTE: DAFFODIL BULBS SHALL BE 'CEYLON,' TOP SIZE.

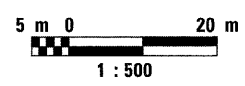

REVISIONS	
NAME	DATE

ILLINOIS DEPARTMENT OF TRANSPORTATION
 IL. RTE. 22:
 W/O US 12 (RAND RD.) TO
 E/O QUENTIN RD.
 LANDSCAPING PLANS
 SCALE: 1:500
 DATE: 3/12/09
 DRAWN BY
 CHECKED BY

F.A.P. RTE.	SECTION	COUNTY	TOTAL SHEETS	SHEET NO.
337	(19 & 20) LS-5	LAKE	17	9
STA. 8+900		TO STA. 9+550		
FED. ROAD DIST. NO.	ILLINOIS	FED. AID PROJECT		
CONTRACT 60F55				

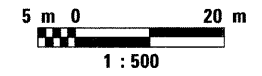
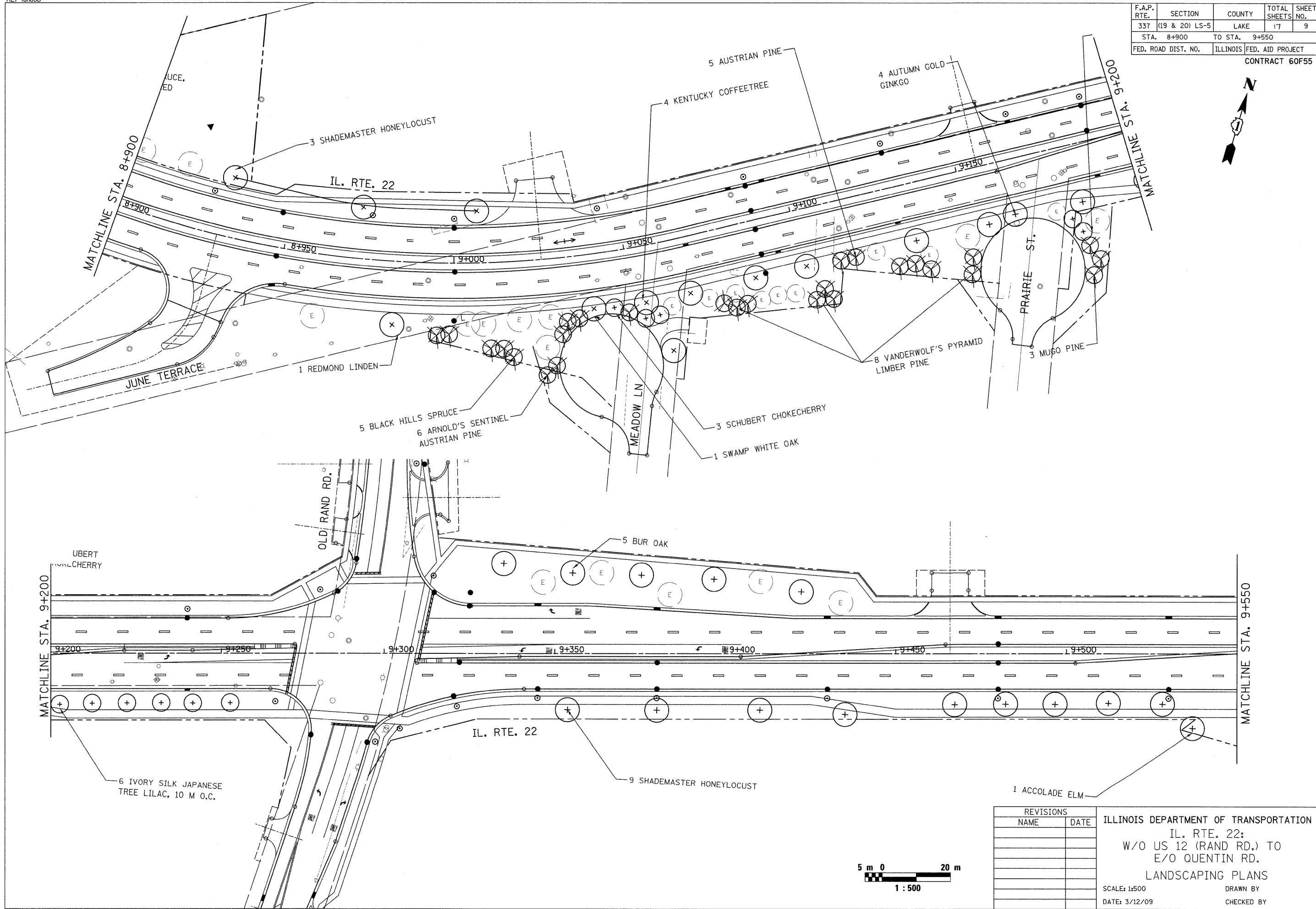

REVISIONS	
NAME	DATE

ILLINOIS DEPARTMENT OF TRANSPORTATION
 IL. RTE. 22:
 W/O US 12 (RAND RD.) TO
 E/O QUENTIN RD.
 LANDSCAPING PLANS

SCALE: 1:500
 DATE: 3/12/09

DRAWN BY
 CHECKED BY

F.A.P. RTE.	SECTION	COUNTY	TOTAL SHEETS	SHEET NO.
337	(19 & 20) LS-5	LAKE	17	10
STA. 9+550		TO STA. 9+900		
FED. ROAD DIST. NO.		ILLINOIS	FED. AID PROJECT	
CONTRACT 60F55				

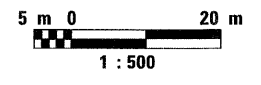
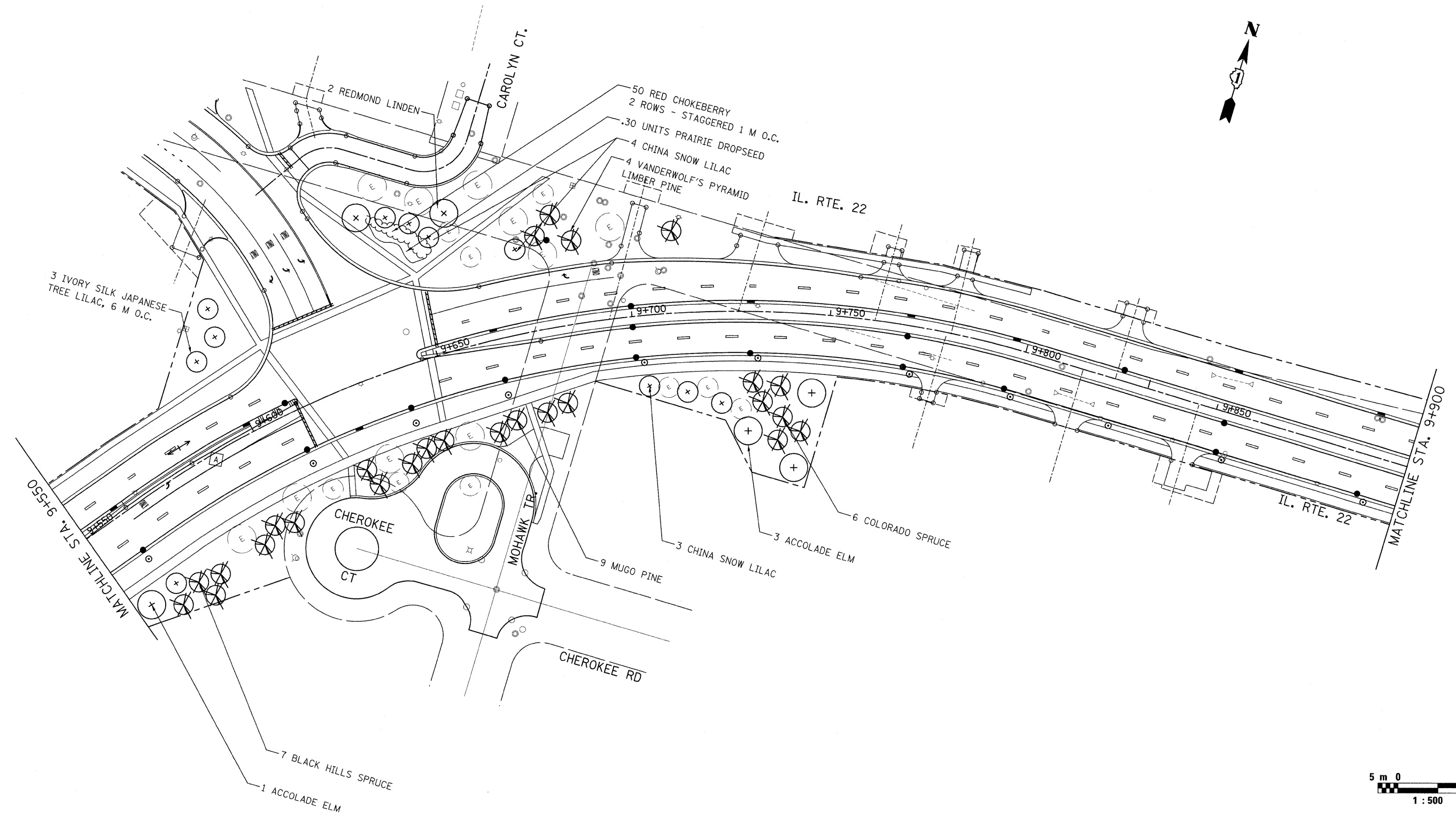

REVISIONS	
NAME	DATE

ILLINOIS DEPARTMENT OF TRANSPORTATION
 IL. RTE. 22:
 W/O US 12 (RAND RD.) TO
 E/O QUENTIN RD.
 LANDSCAPING PLANS
 SCALE: 1:500 DRAWN BY
 DATE: 3/12/09 CHECKED BY

F.A.P. RTE.	SECTION	COUNTY	TOTAL SHEETS	SHEET NO.
337	(19 & 20) LS-5	LAKE	17	11
STA. 9+900	TO STA. 10+100			
FED. ROAD DIST. NO.	ILLINOIS	FED. AID PROJECT		
CONTRACT 60F55				

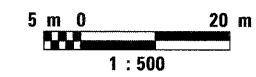
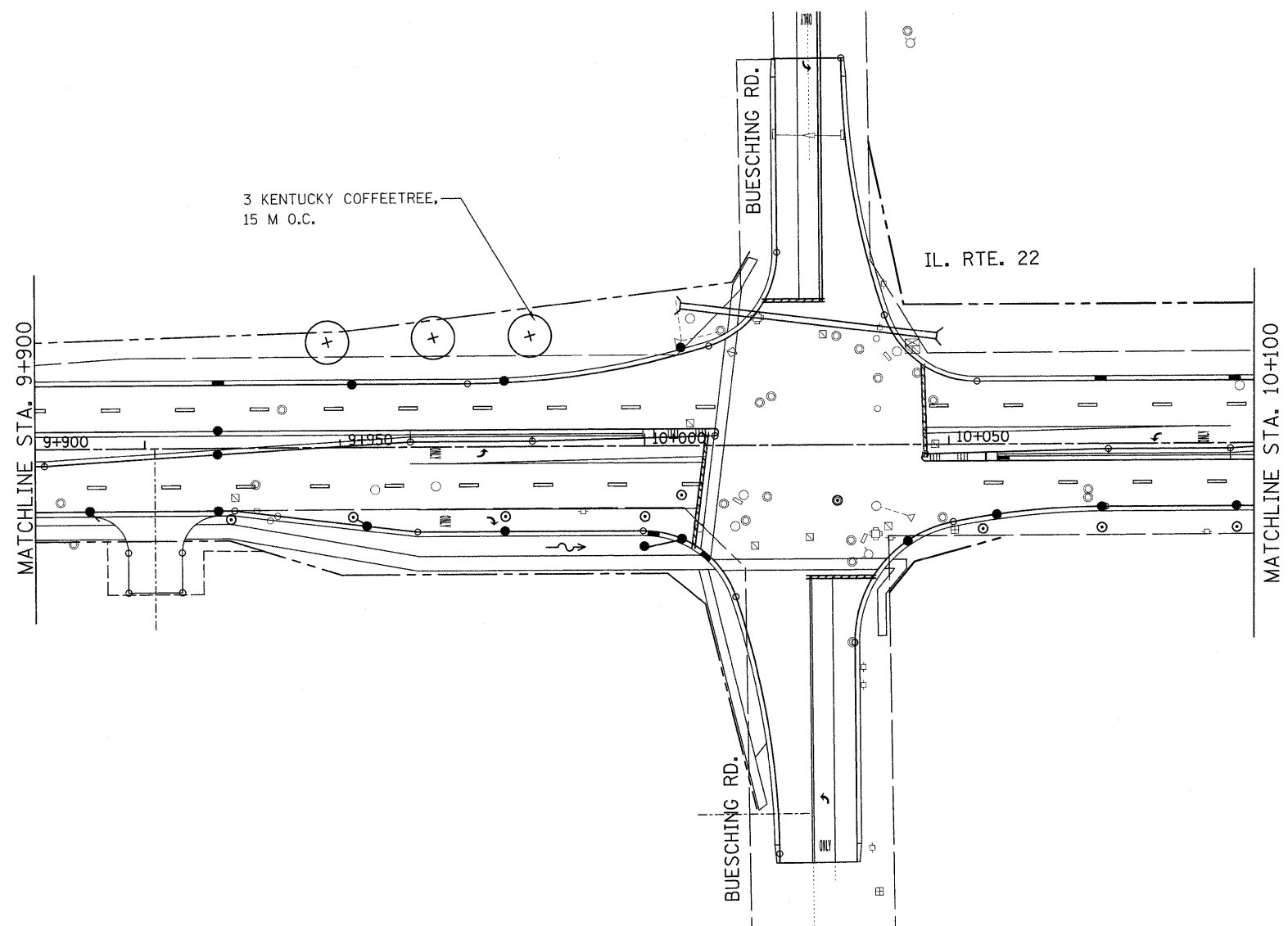

REVISIONS		ILLINOIS DEPARTMENT OF TRANSPORTATION IL. RTE. 22: W/O US 12 (RAND RD.) TO E/O QUENTIN RD. LANDSCAPING PLANS
NAME	DATE	

SCALE: 1:500
DATE: 3/12/09

DRAWN BY
CHECKED BY

F.A.P. RTE.	SECTION	COUNTY	TOTAL SHEETS	SHEET NO.
337	(19 & 20) LS-5	LAKE	17	12
STA.		TO STA.		
FED. ROAD DIST. NO.		ILLINOIS	FED. AID PROJECT	
CONTRACT 60F55				

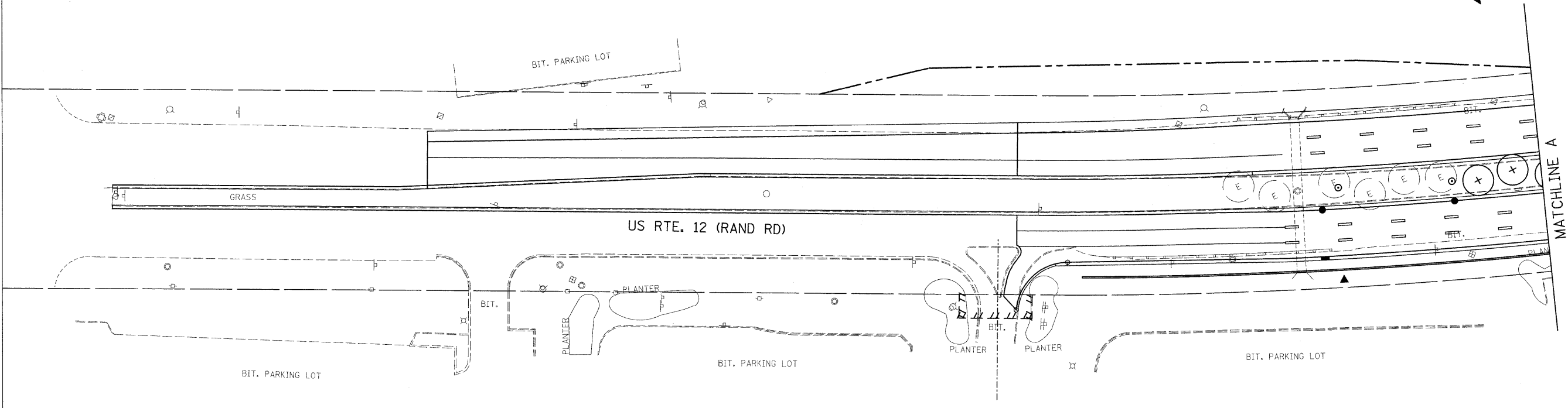
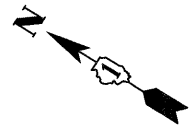

FOR ILL ROUTE 22
SEE SHEET 6

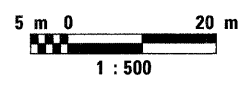
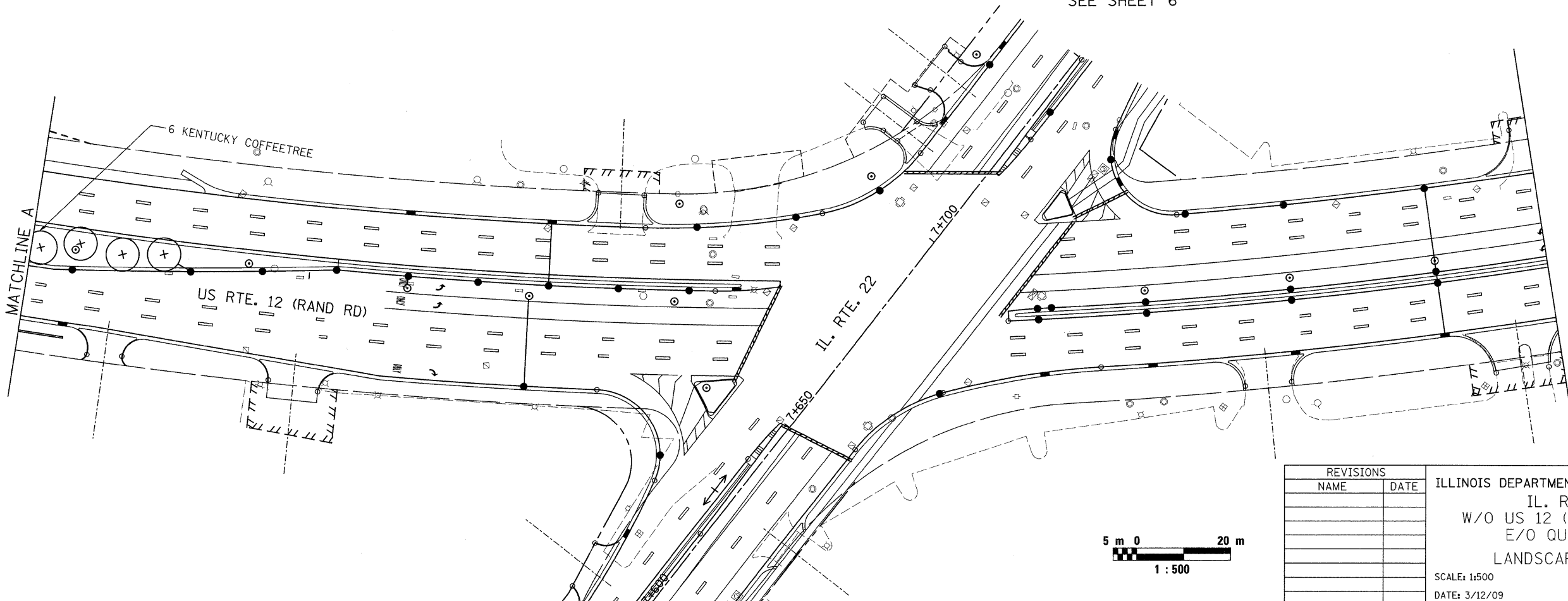

REVISIONS	
NAME	DATE

ILLINOIS DEPARTMENT OF TRANSPORTATION
 IL. RTE. 22:
 W/O US 12 (RAND RD.) TO
 E/O QUENTIN RD.
 LANDSCAPING PLANS
 SCALE: 1:500
 DATE: 3/12/09
 DRAWN BY
 CHECKED BY

F.A.P. RTE.	SECTION	COUNTY	TOTAL SHEETS	SHEET NO.
337	(19 & 20) LS-5	LAKE	17	13
STA. 10+100		TO STA. 10+750		
FED. ROAD DIST. NO.		ILLINOIS FED. AID PROJECT		
CONTRACT 60F55				

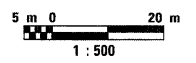
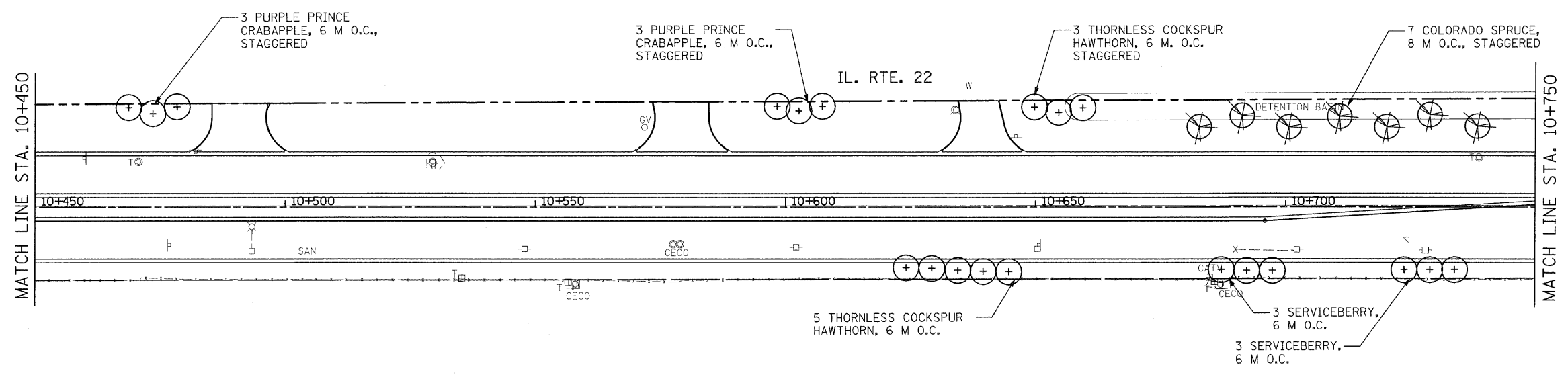
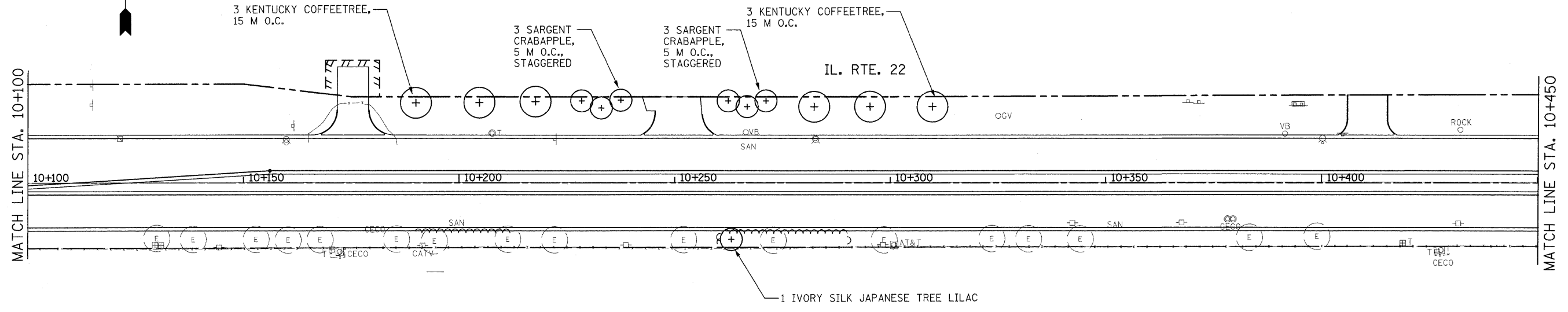

REVISIONS		ILLINOIS DEPARTMENT OF TRANSPORTATION IL. RTE. 22: W/O US 12 (RAND RD.) TO E/O QUENTIN RD. LANDSCAPING PLANS
NAME	DATE	
		SCALE 1:500 DATE 3/12/09 DRAWN BY CHECKED BY

F.A.P. RTE.	SECTION	COUNTY	TOTAL SHEETS	SHEET NO.
337	(19 & 20) LS-5	LAKE	17	14
STA. 10+750		TO STA. 11+450		
FED. ROAD DIST. NO.	ILLINOIS	FED. AID PROJECT		
CONTRACT 60F55				

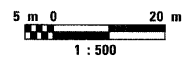
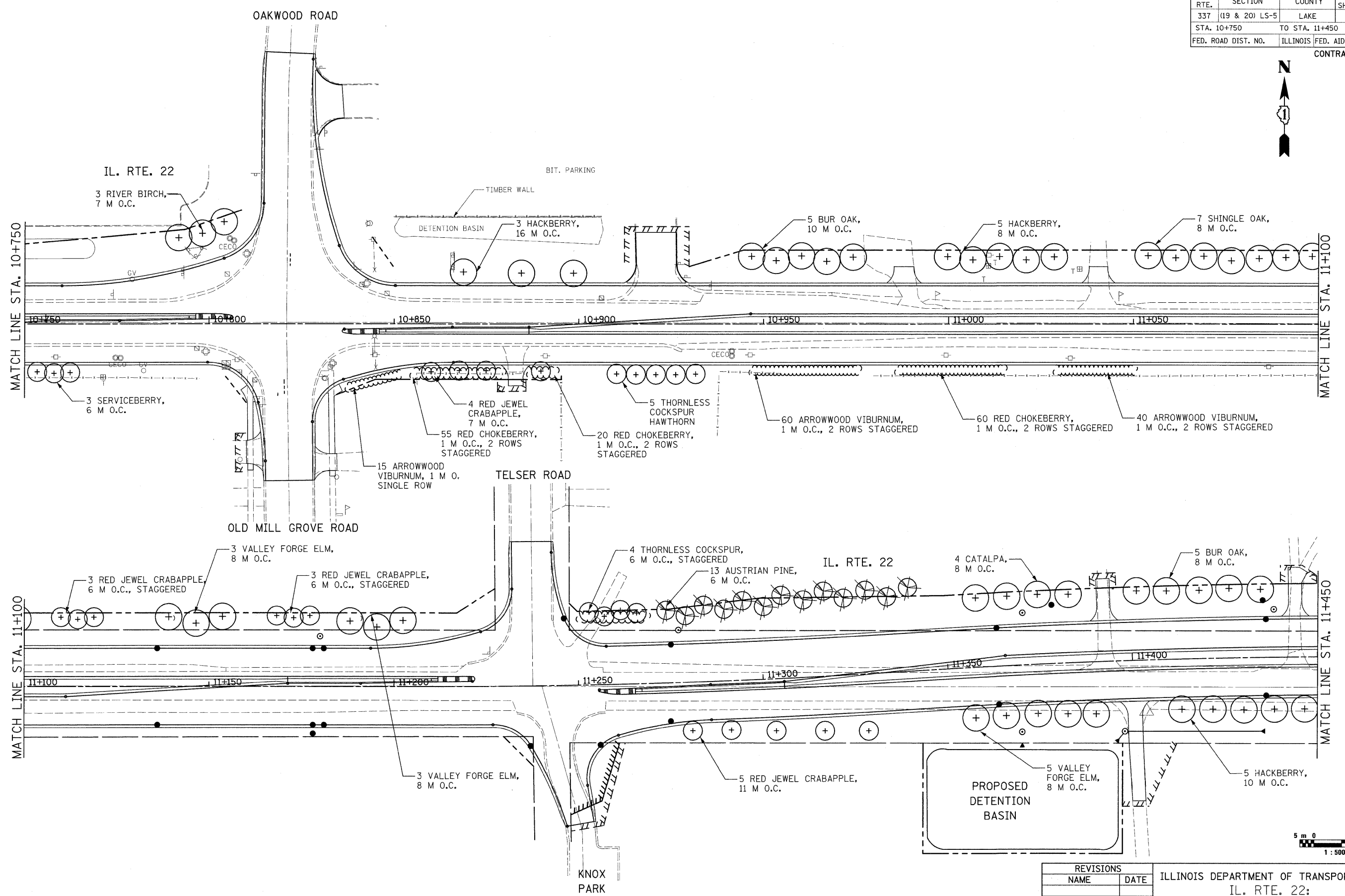

REVISIONS	
NAME	DATE

ILLINOIS DEPARTMENT OF TRANSPORTATION
 IL. RTE. 22:
 W/O US 12 (RAND RD.) TO
 E/O QUENTIN RD.
 LANDSCAPING PLANS

SCALE 1:500
 DATE 3/12/09
 DRAWN BY
 CHECKED BY

F.A.P. RTE.	SECTION	COUNTY	TOTAL SHEETS	SHEET NO.
337	(19 & 20) LS-5	LAKE	17	15
STA. 11+450		TO STA. 12+150		
FED. ROAD DIST. NO.	ILLINOIS	FED. AID PROJECT		
CONTRACT 60F55				

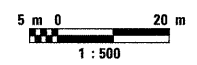
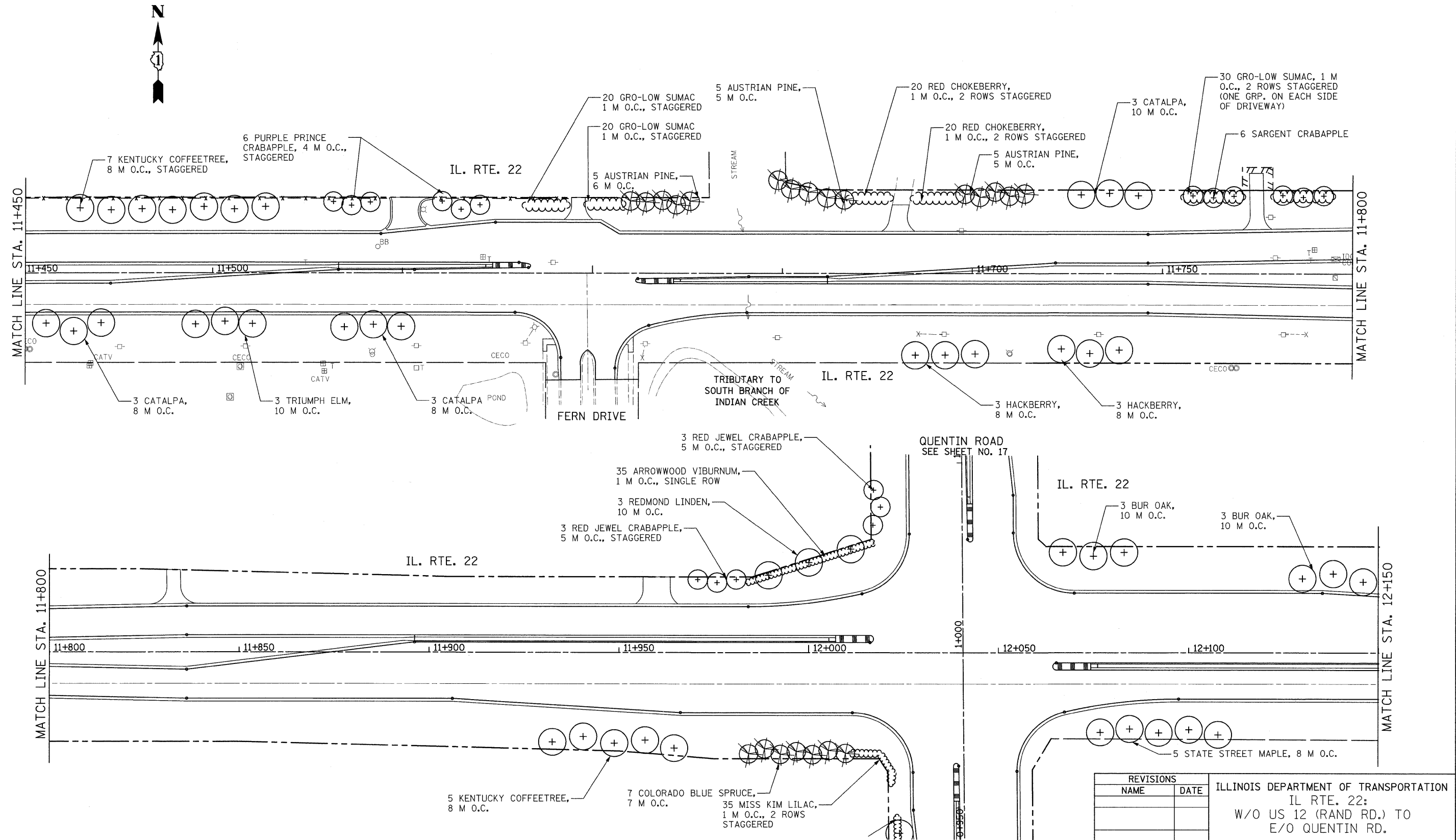

REVISIONS	
NAME	DATE

ILLINOIS DEPARTMENT OF TRANSPORTATION
 IL. RTE. 22;
 W/O US 12 (RAND RD.) TO
 E/O QUENTIN RD.
 LANDSCAPING PLANS
 SCALE 1:500 DRAWN BY
 DATE 3/12/09 CHECKED BY

QUENTIN ROAD
 SEE SHEET NO. 17

F.A.P. RTE.	SECTION	COUNTY	TOTAL SHEETS	SHEET NO.
337	(19 & 20) LS-5	LAKE	17	16
STA. 12+150		TO STA. 12+900		
FED. ROAD DIST. NO.	ILLINOIS FED. AID PROJECT		CONTRACT 60F55	

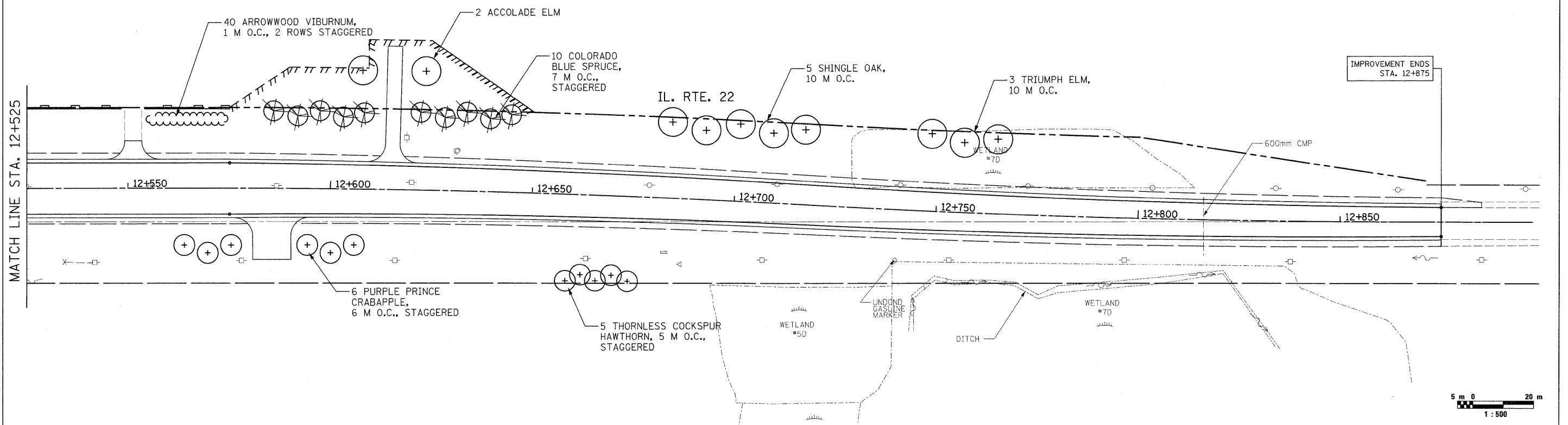
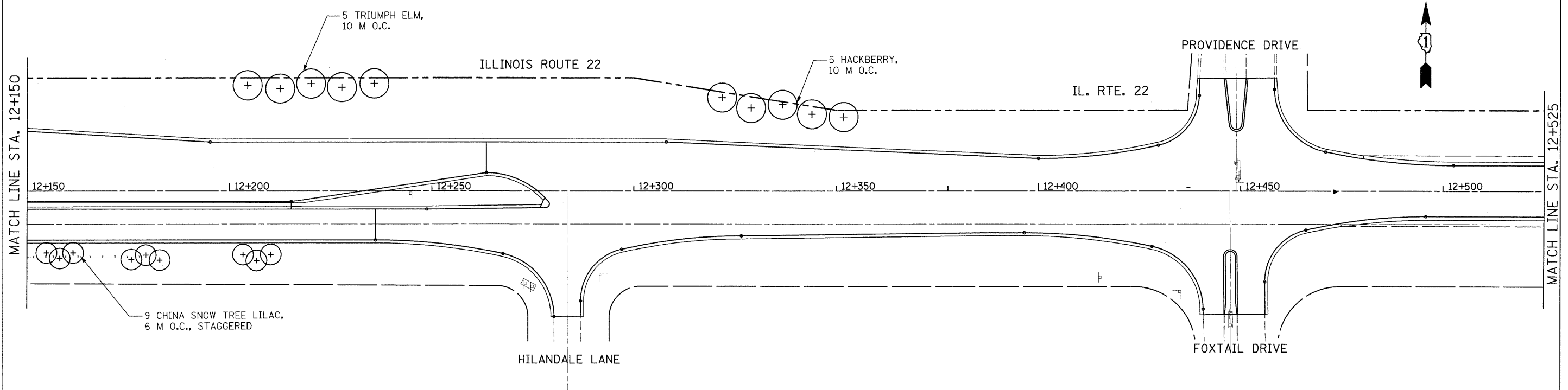

REVISIONS		ILLINOIS DEPARTMENT OF TRANSPORTATION IL. RTE. 22: W/O US 12 (RAND RD.) TO E/O QUENTIN RD. LANDSCAPING PLANS
NAME	DATE	
		SCALE 1:500 DATE 3/12/09 DRAWN BY CHECKED BY

F.A.P. RTE.	SECTION	COUNTY	TOTAL SHEETS	SHEET NO.
337	(19 & 20) LS-5	LAKE	17	17
STA. 0+600		TO STA. 1+375		
FED. ROAD DIST. NO.		ILLINOIS FED. AID PROJECT		
CONTRACT 60F55				



18 ARROWWOOD VIBURNUM
1 M O.C., 2 ROWS STAGGERED

5 STATE STREET MAPLE,
8 M O.C.

30 ARROWWOOD
VIBURNUM, 1 M O.C.,
2 ROWS STAGGERED

IMPROVEMENT BEGINS
STA. 0+600

QUENTIN ROAD

0+600 0+650 0+700 0+750 0+800 0+850 0+900 0+950

4 STATE STREET MAPLE,
8 M O.C.

FOR IL ROUTE 22
SEE SHEET NO. 15

FOR IL ROUTE 22
SEE SHEET NO. 15

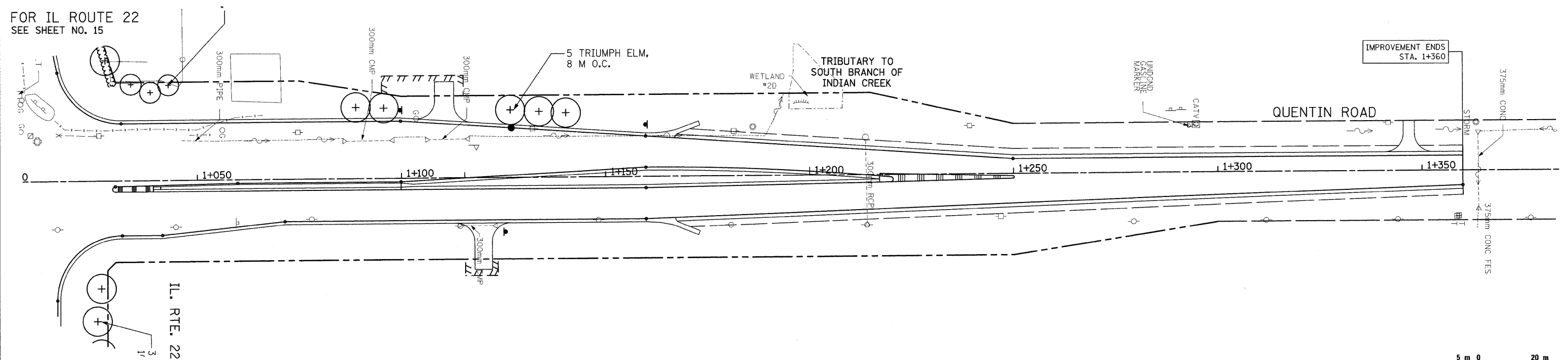

5 m 0 20 m
1 : 500

REVISIONS	
NAME	DATE

ILLINOIS DEPARTMENT OF TRANSPORTATION
IL. RTE. 22:
W/O US 12 (RAND RD.) TO
E/O QUENTIN RD.
LANDSCAPING PLANS
SCALE 1:500 DRAWN BY
DATE: 3/12/09 CHECKED BY