

**CP 216**

N 1729135.49  
 E 1022659.53  
 STA 951+93.54  
 OFF 18.00' RT  
 ELEV 550.56

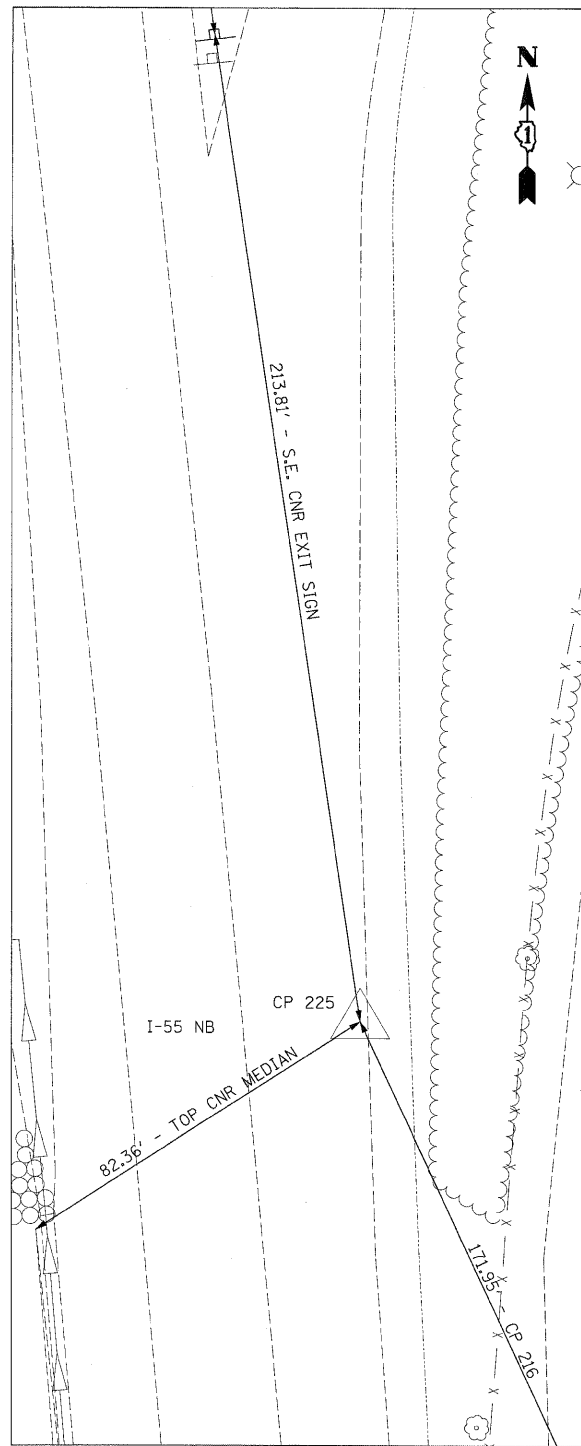

**CP 225**

N 1729291.64  
 E 1022587.53  
 STA 953+46.35  
 OFF 53.40' LT  
 ELEV 549.30

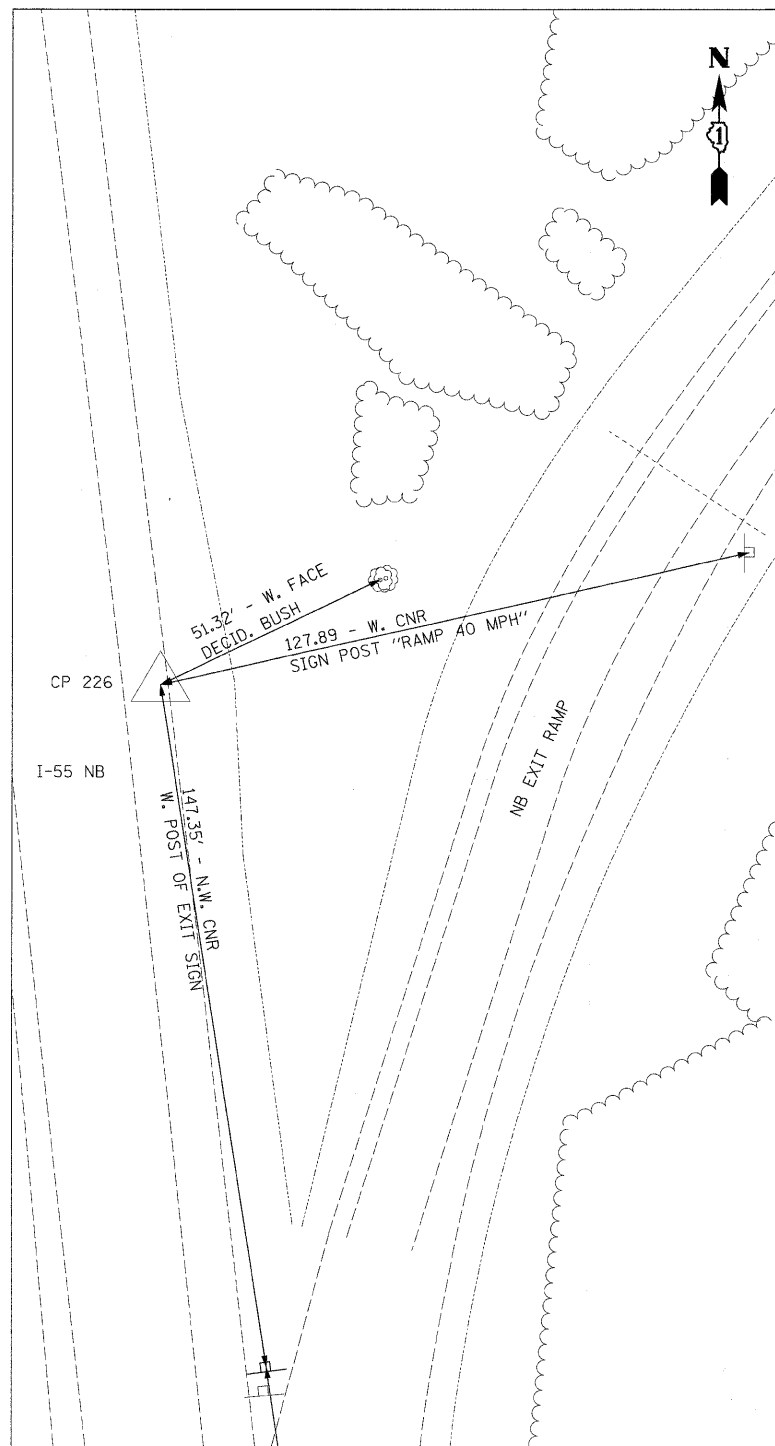

**CP 226**

N 1729649.45  
 E 1022533.85  
 STA 11+93.41  
 OFF 85.33' LT  
 ELEV 548.92

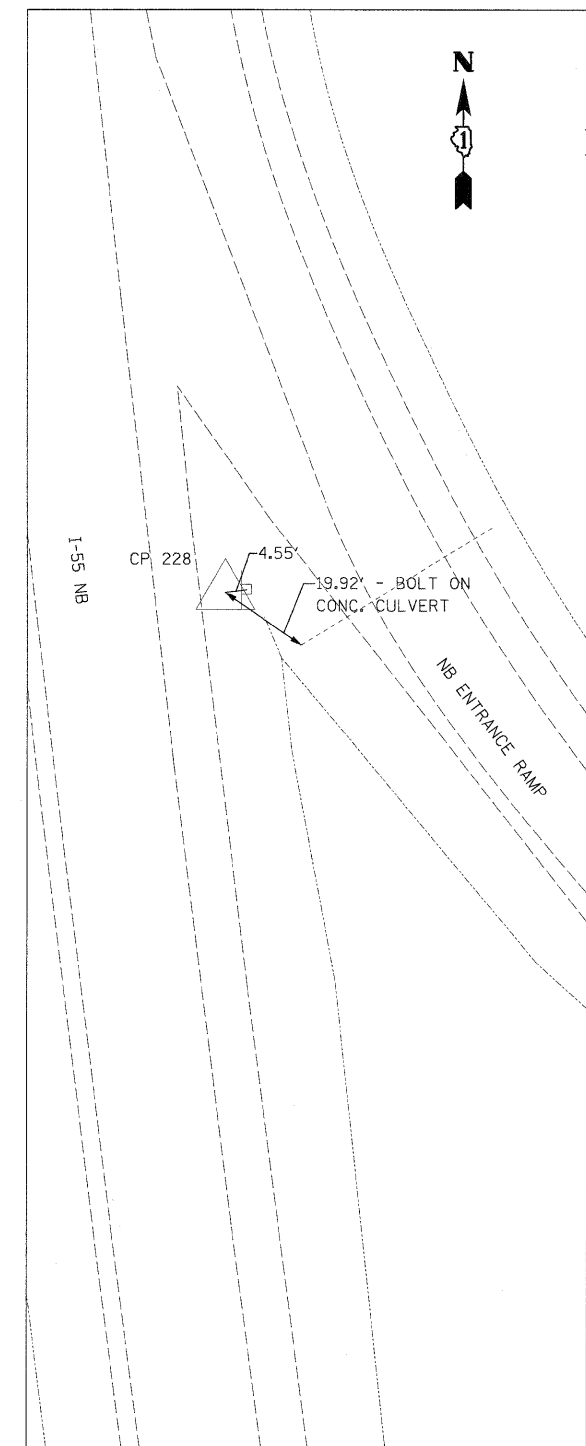

**CP 228**

N 1730192.79  
 E 1022473.00  
 STA 33+93.74  
 OFF 43.17' LT  
 ELEV 545.76

**McDonough Associates Inc.**  
 Engineers / Architects  
 130 East Randolph Street Chicago, Illinois 60601

FILE NAME =	USER NAME = TK.uegal
D:\6071-SHT-ATB06.dgn	
PLDT SCALE = 1:20	
PLDT DATE = 3/28/2009	

DESIGNED - TRK	REVISOR -
DRAWN - TRK	REVISOR -
CHECKED - DLT	REVISOR -
DATE - 03/20/09	REVISOR -

DESIGNED - TRK	REVISOR -
DRAWN - TRK	REVISOR -
CHECKED - DLT	REVISOR -
DATE - 03/20/09	REVISOR -

**STATE OF ILLINOIS  
 DEPARTMENT OF TRANSPORTATION**

<b>ALIGNMENTS, TIES, AND BENCHMARKS</b>	
SCALE: 1"=20'	SHEET NO. 6 OF 7 SHEETS
STA.	TO STA.

F.A.I. RTE.	SECTION	COUNTY	TOTAL SHEETS	SHEET NO.
55	99-2HB-2-R	WILL	171	19
CONTRACT NO. 60F71				
FED. ROAD DIST. NO. 1 ILLINOIS FED. AID PROJECT				

**FINAL**