

PLAN SURVEYED BY DATE  
 ALIGNED CHECKED  
 RT. OF WAY CHECKED  
 NO. PLOTTED FILE NAME

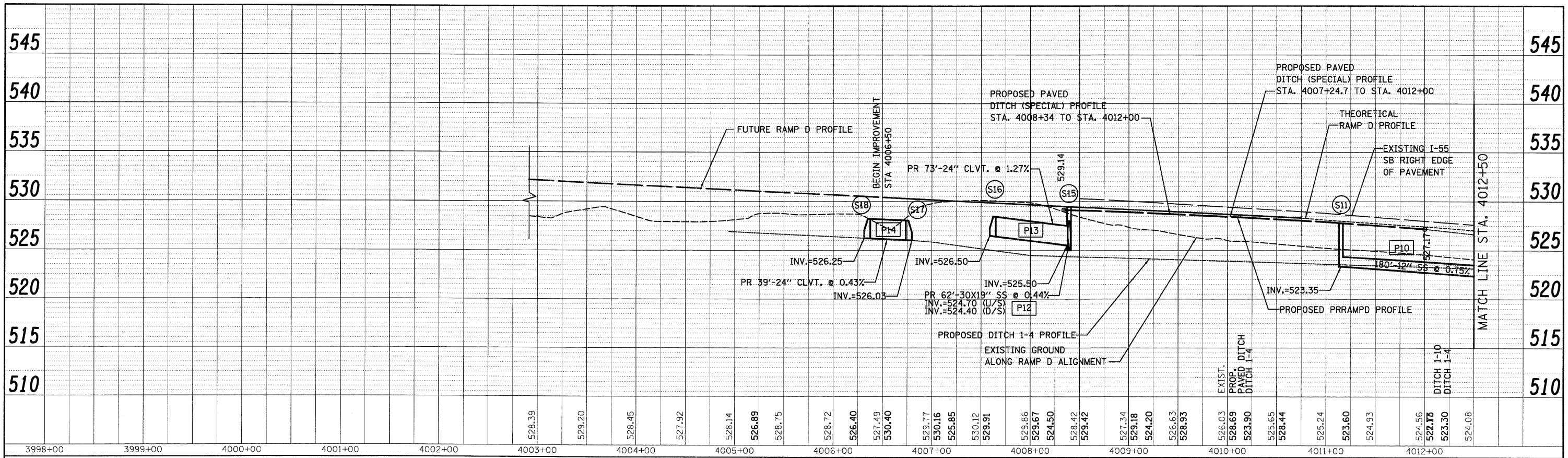

PROFILE SURVEYED BY DATE  
 GRADES CHECKED  
 RAW NOTES CHECKED  
 NO. STRUCTURE NOTATIONS CHFD

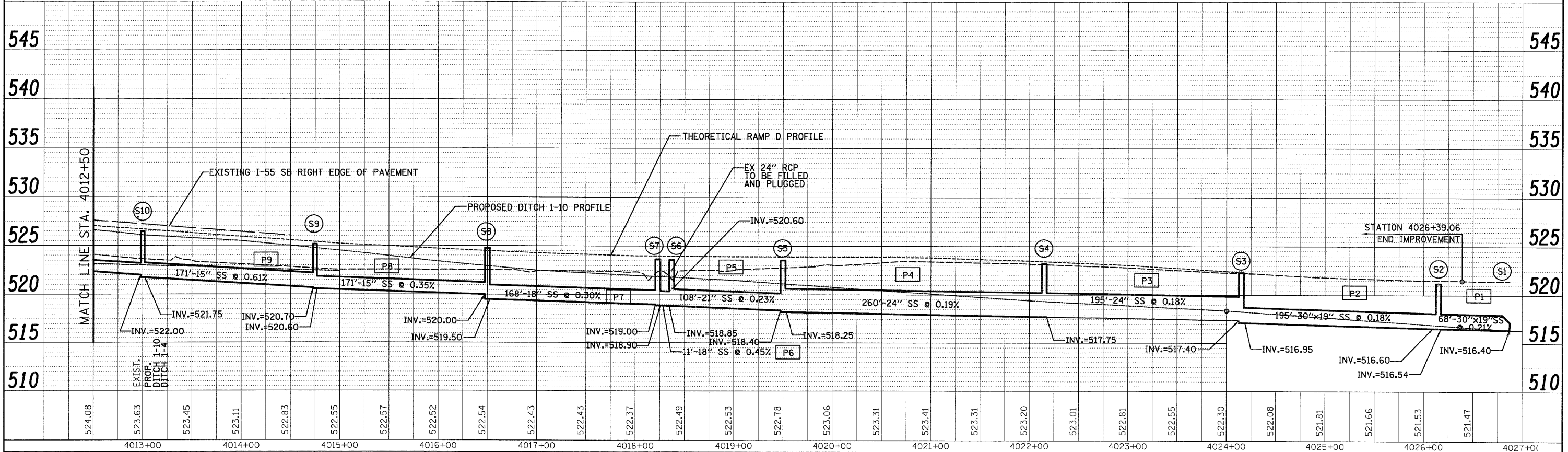

300 W. ADAMS ST.  
 CHICAGO, IL 60606  
 TEL: (312) 629-0240  
 SINGH & ASSOCIATES, INC.  
 CONSULTING ENGINEERS  
 FAX: (312) 629-8449

FILE NAME = D:\B0F71-SHT-DRAIN2.dgn	USER NAME = TKLuegel	DESIGNED - VP	REVISED -	<b>STATE OF ILLINOIS</b> <b>DEPARTMENT OF TRANSPORTATION</b> <b>I-55 AT ARSENAL ROAD - DRAINAGE PROFILE</b> SCALE: 1"=50' H1"=10' V SHEET NO. 1 OF 1 SHEETS STA. 4006+50 TO STA. 4026+87.35	F.A.I. RTE. 55	SECTION 99-2HB-2-R	COUNTY WILL	TOTAL SHEETS 171	SHEET NO. 83
PLOT SCALE = 1:50	CHECKED - PKT	DATE = 03/20/09	REVISED -		CONTRACT NO. 60F71				
PLOT DATE = 3/28/2009	DATE = 03/20/09	REVISED -	REVISED -		FED. ROAD DIST. NO. 1 ILLINOIS FED. AID PROJECT				

FINAL