

STATE OF ILLINOIS
 DEPARTMENT OF TRANSPORTATION
 DIVISION OF HIGHWAYS
PROPOSED HIGHWAY PLANS

FOR INDEX OF SHEETS, SEE SHEET NO. 2

F.A.I. RTE.	SECTION	COUNTY	TOTAL SHEETS	SHEET NO.
55	2009-017 I	WILL	16	1
ILLINOIS			CONTRACT NO. 60G16	

* 16+1=17

IMPROVEMENT LOCATED IN THE VILLAGE OF BOLINGBROOK.

FAI 55: INTERSTATE 55
 NORTHBOUND BOLINGBROOK WEIGH STATION
 SECTION: 2009-017 I
 WEIGH STATION IMPROVEMENT
 WILL COUNTY
 C-91-346-09

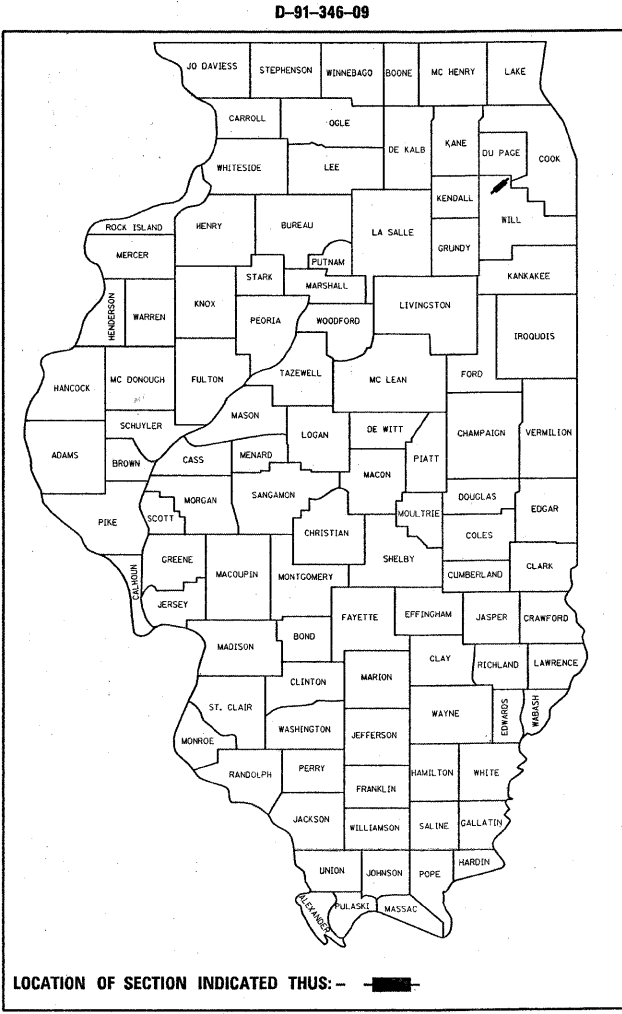

IMPROVEMENT LOCATION

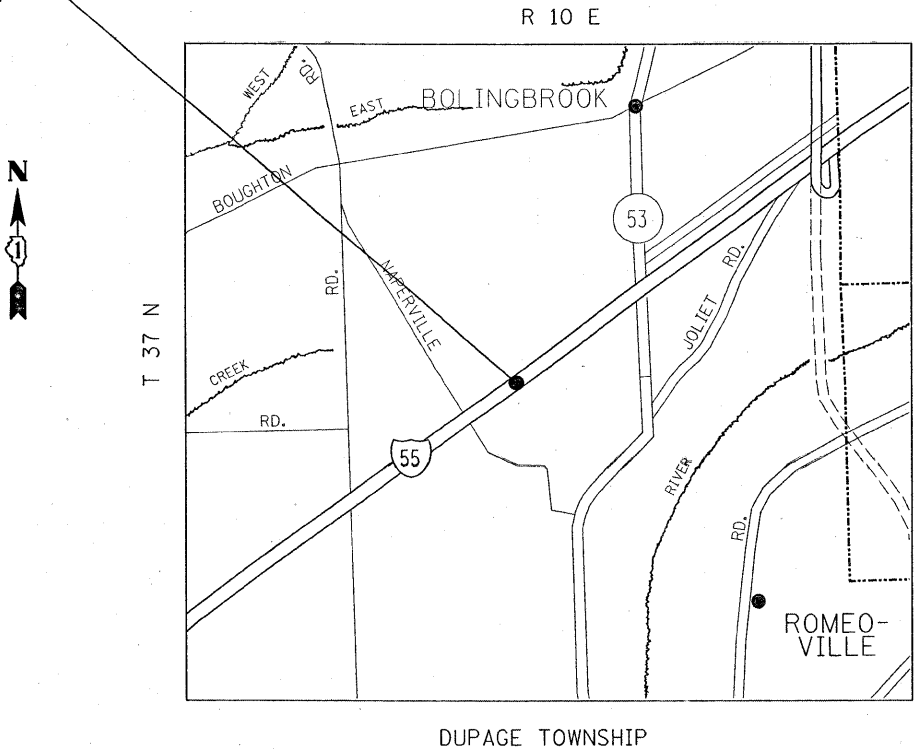

TRAFFIC DATA
 2007 ADT = 104,500
 SPEED LIMIT = 55 MPH

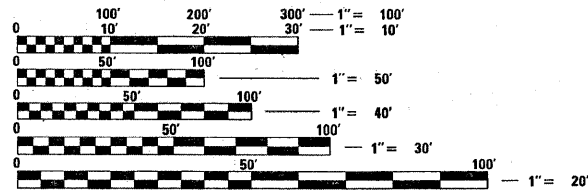

FULL SIZE PLANS HAVE BEEN PREPARED USING STANDARD ENGINEERING SCALES. REDUCED SIZED PLANS WILL NOT CONFORM TO STANDARD SCALES. IN MAKING MEASUREMENTS ON REDUCED PLANS, THE ABOVE SCALES MAY BE USED.

J.U.L.I.E.
 JOINT UTILITY LOCATION INFORMATION FOR EXCAVATION
 1-800-892-0123
 OR 811

PROJECT ENGINEER: DAN WILGREEN (847) 705-4240
 PROJECT MANAGER: KEN ENG

CONTRACT NO. 60G16

STATE OF ILLINOIS
 DEPARTMENT OF TRANSPORTATION
 DIVISION OF HIGHWAYS

SUBMITTED MARCH 24, 2009

Diana M. O'Keefe
 DEPUTY DIRECTOR OF HIGHWAYS, REGION ENGINEER

May 8, 2009
Charles J. Ingensoll
 ENGINEER OF DESIGN AND ENVIRONMENT

May 8, 2009
Christine M. Reed
 DIRECTOR OF HIGHWAYS, CHIEF ENGINEER

**PRINTED BY THE AUTHORITY
 OF THE STATE OF ILLINOIS**