

SUMMARY - EASY LAKE COUNTY	HMA 2" MILL & RESURFACE (SY)
IL 43 (US 41 TO 22ND ST.)	4549
IL 120 (IL 41 TO IL 131)	417
IL 137 (IL 21 TO O'PLAINE RD.)	1081
IL 173 (IL 131 TO MILL RD.)	16323
US 41 (0.1 mi. S/O WAUKEGAN RD. to WASHINGTON ST.) AND (IL 21 TO IL-WI STATE LINE)	10672
<b>SUMMARY TOTALS:</b>	<b>33042 SY</b>

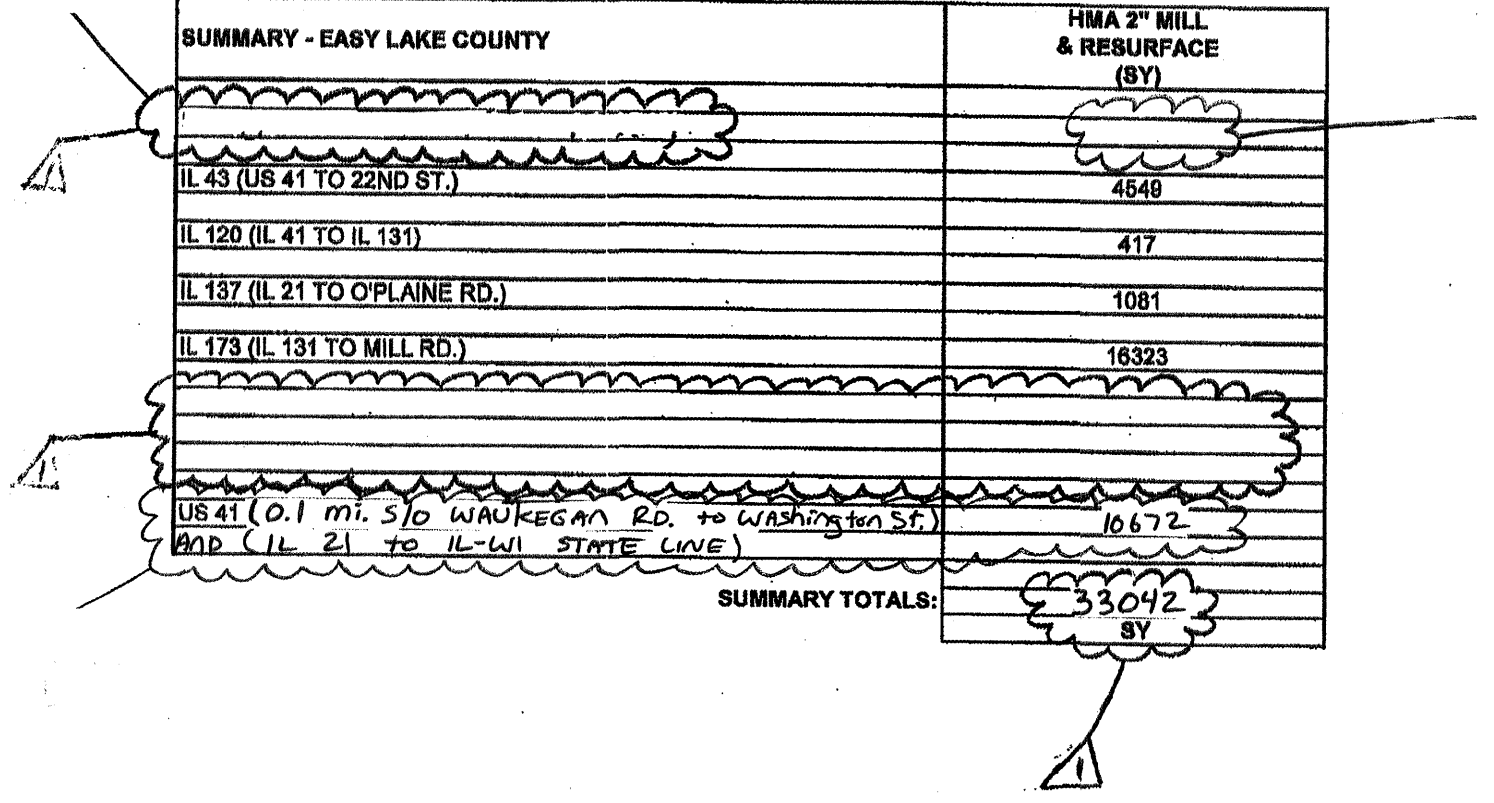

FILE NAME =	USER NAME = utgreendp	DESIGNED -	REVISED - A DW - 4/8/09	<b>STATE OF ILLINOIS DEPARTMENT OF TRANSPORTATION</b>	<b>SUMMARY OF PATCHING SCHEDULE EAST LAKE COUNTY</b>	P.A. RTE.	SECTION	COUNTY	TOTAL SHEETS	SHEET NO.
enp...v...w...d...v...l...e...n...p...v...d...i...s...t...o...r...y.../...a...i...r.../...d...e...s...i...g...n	DRAWN -	REVISED -	VAR.			2009-018 PP	LAKE	32	6	
PLOT SCALE = 1/8" = 1' / IN.	CHECKED -	REVISED -	CONTRACT NO. 60017							
PLOT DATE = 4/8/2009	DATE -	REVISED -	FED. ROAD DIST. NO. 1 (ILLINOIS) FED. AID PROJECT							