

CONSTRUCTION NOTES:

- RELOCATE EXISTING LIGHT DETECTORS AND CONFIRMATION BEACON TO THE NEW MAST ARMS.
- RELOCATE EXISTING LIGHT DETECTOR AMPLIFIER TO NEW CONTROLLER CABINET.
- RELOCATE EXISTING MASTER CONTROLLER TO TEMPORARY TRAFFIC SIGNAL CABINET.
- EXISTING TELEPHONE SERVICE TO BE MAINTAINED. THIS WORK IS INCIDENTAL TO THE PAY ITEM: TEMPORARY TRAFFIC SIGNAL INSTALLATION.

TEMPORARY TRAFFIC SIGNAL LEGEND

- | | | | |
|---|--|-----|--|
| ▲ | TEMPORARY TRAFFIC SIGNAL HEAD SPAN WIRE MOUNTED ORIGINAL LOCATION | ■ | MACHINE VISION PROCESSOR |
| ▲ | TEMPORARY TRAFFIC SIGNAL HEAD SPAN WIRE MOUNTED SECONDARY LOCATION | ⊙ | PEDESTRIAN PUSHBUTTON DETECTOR |
| ⊙ | TEMPORARY WOOD POLE (CLASS 5 OR BETTER) 45 FOOT (13.7m) MINIMUM DOWN GUY | ▶ | EMERGENCY VEHICLE LIGHT DETECTOR CONFIRMATION BEACON |
| ⊠ | TEMPORARY CONTROLLER CABINET | □ | VEHICLE DETECTOR, INDUCTION LOOP |
| — | TEMPORARY SPAN WIRE, TETHER WIRE, AND CABLE | UD | UNIT DUCT |
| ⊠ | TEMPORARY SERVICE INSTALLATION | CT | COMMON TRENCH |
| ■ | TEMPORARY PEDESTRIAN SIGNAL HEAD, BRACKET MOUNTED | — | G.S. CONDUIT IN TRENCH (T) OR PUSHED (P) |
| ⊠ | TEMPORARY RADIO INTERCONNECT | ■ | HANDHOLE |
| | | ■ | HEAVY DUTY HANDHOLE |
| | | "R" | RELOCATE |
| | | "A" | ABANDON |
| | | □ | DETECTION ZONE |

THE FOLLOWING ITEMS SHALL BE REMOVED BY THE CONTRACTOR AND SHALL BE DISPOSED OF BY THEM OUTSIDE THE RIGHT-OF-WAY AT THEIR EXPENSE. THE SALVAGE VALUE OF THE REMOVED EQUIPMENT SHALL BE REFLECTED IN THE CONTRACT BID PRICE.

- | | | |
|---|------|---|
| 1 | EACH | CONTROLLER AND CABINET (COMPLETE) |
| 2 | EACH | SIGNAL HEAD, 1-FACE, 3-SECTION |
| 4 | EACH | SIGNAL HEAD, 1-FACE, 5-SECTION |
| 2 | EACH | SIGNAL HEAD, 2-FACE, 1-3 SECTION, 1-5 SECTION |
| 2 | EACH | SIGNAL HEAD, 3-FACE, 2-3 SECTION, 1-5 SECTION |
| 1 | EACH | STEEL MAST ARM AND POLE |
| 3 | EACH | ALUMINUM MAST ARM AND POLE |
| 7 | EACH | SIGNAL POST |
| 1 | EACH | SERVICE INSTALLATION |
| 4 | EACH | PEDESTRIAN SIGNAL HEAD, 2-FACE |
| 8 | EACH | PEDESTRIAN PUSH-BUTTON |
| 4 | EACH | TRAFFIC SIGNAL BACKPLATE |

NOTE: THE TRAFFIC SIGNAL CONTROLLER EQUIPMENT FOR THIS PROJECT SHALL BE "ECONOLITE" TO MATCH THE EXISTING ADJACENT SYSTEM.

DATE: _____ BY: _____
 SURVEYED: _____ CHECKED: _____
 PLOTTED: _____ PLOT. OF WAY CHECKED: _____
 PLAN NO.: _____ CAD FILE NAME: _____
 PROFILE SURVEYED: _____ CHECKED: _____
 NOTE BOOK NO.: _____ BAL. NOTED: _____
 STRUCTURE NOTATIONS: "CRD"
 CHANGING: _____ NOTATIONS: "CRD"
 DATE: _____ BY: _____
 SURVEYED: _____ CHECKED: _____
 PLOTTED: _____ PLOT. OF WAY CHECKED: _____
 PLAN NO.: _____ CAD FILE NAME: _____
 PROFILE SURVEYED: _____ CHECKED: _____
 NOTE BOOK NO.: _____ BAL. NOTED: _____
 STRUCTURE NOTATIONS: "CRD"
 CHANGING: _____ NOTATIONS: "CRD"

TEMPORARY VIDEO DETECTION MOUNTING DETAIL (NOT TO SCALE)

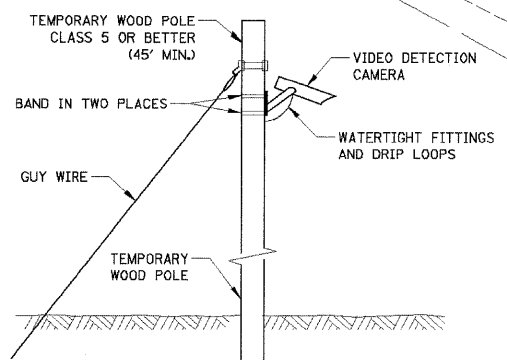

NOTES FOR TEMPORARY TRAFFIC SIGNALS

- ALL CONTROL EQUIPMENT INCLUDING EMERGENCY PRE-EMPTION AND COMMUNICATION DEVICES FOR THE TEMPORARY TRAFFIC SIGNAL(S) SHALL BE FURNISHED BY THE CONTRACTOR.
- ONLY CONTROLLERS SUPPLIED BY ONE OF THE DISTRICT APPROVED CLOSED LOOP EQUIPMENT MANUFACTURERS WILL BE APPROVED FOR USE AT TEMPORARY SIGNAL LOCATIONS. ALL CONTROLLERS USED FOR TEMPORARY TRAFFIC SIGNALS SHALL BE FULLY ACTUATED NEMA MICROPROCESSOR BASED WITH RS232 DATA ENTRY PORTS COMPATIBLE WITH EXISTING MONITORING SOFTWARE APPROVED BY IDOT DISTRICT 1. INSTALLED IN A NEMA TS1 OR TS2 CABINET. ONLY ONE BRAND OF CONTROLLER WILL BE ACCEPTED FOR ANY ONE CONTRACT.
- ALL TRAFFIC SIGNAL SECTIONS AND PEDESTRIAN SIGNAL SECTIONS SHALL BE 12" (300mm). HEADS SHALL BE PLACED AS INDICATED ON THE TEMPORARY TRAFFIC SIGNAL PLAN OR AS DIRECTED BY THE ENGINEER. THE CONTRACTOR SHALL FURNISH ENOUGH CABLE SLACK TO RELOCATE HEADS TO ANY POSITION ON THE SPAN WIRE OR AT LOCATIONS ILLUSTRATED ON THE PLANS FOR CONSTRUCTION STAGING. THE TEMPORARY TRAFFIC SIGNAL SHALL REMAIN IN OPERATION DURING ALL SIGNAL HEAD RELOCATIONS. EACH TEMPORARY TRAFFIC SIGNAL HEAD SHALL HAVE ITS OWN CABLE FROM THE CONTROLLER CABINET TO THE SIGNAL HEAD.
- ALL EXISTING STREET NAME AND INTERSECTION REGULATORY SIGNS SHALL BE REMOVED FROM EXISTING POLES, RELOCATED AND SECURELY FASTENED TO THE SIGNAL SPAN WIRE OR WOOD POLE AS DIRECTED BY THE ENGINEER.
- ANY TEMPORARY SIGNAL WITHIN AN EXISTING CLOSED LOOP TRAFFIC SIGNAL SYSTEM SHALL BE INTERCONNECTED TO THAT SYSTEM USING SIMILAR BRAND CONTROL EQUIPMENT.
- THE TEMPORARY TRAFFIC SIGNAL SHALL HAVE THE SIGNAL HEAD DISPLAYS, SIGNAL HEAD PLACEMENTS AND CONTROLLER PHASING MATCH THE EXISTING TRAFFIC SIGNAL, AT THE TIME OF THE TURN ON, IF NO TRAFFIC STAGING IS IN PLACE OR WILL NOT BE STAGED ON THE DAY OF THE TURN ON.

RESTORATION OF WORK AREA. RESTORATION OF THE TRAFFIC SIGNAL WORK AREA SHALL BE INCIDENTAL TO THE RELATED PAY ITEM SUCH AS FOUNDATION, CONDUIT, HANDHOLE, TRENCH AND BACKFILL, ETC., AND NO EXTRA COMPENSATION SHALL BE ALLOWED. ALL ROADWAY SURFACES SUCH AS SHOULDERS, MEDIANS, SIDEWALKS, PAVEMENT, ETC. SHALL BE REPLACED IN KIND. ALL DAMAGE TO MOWED LAWNS SHALL BE REPLACED WITH AN APPROVED SOD, AND ALL DAMAGE TO UNMOWED FIELDS SHALL BE SEED IN ACCORDANCE WITH STANDARD SPECIFICATIONS 252 AND 250 RESPECTIVELY.

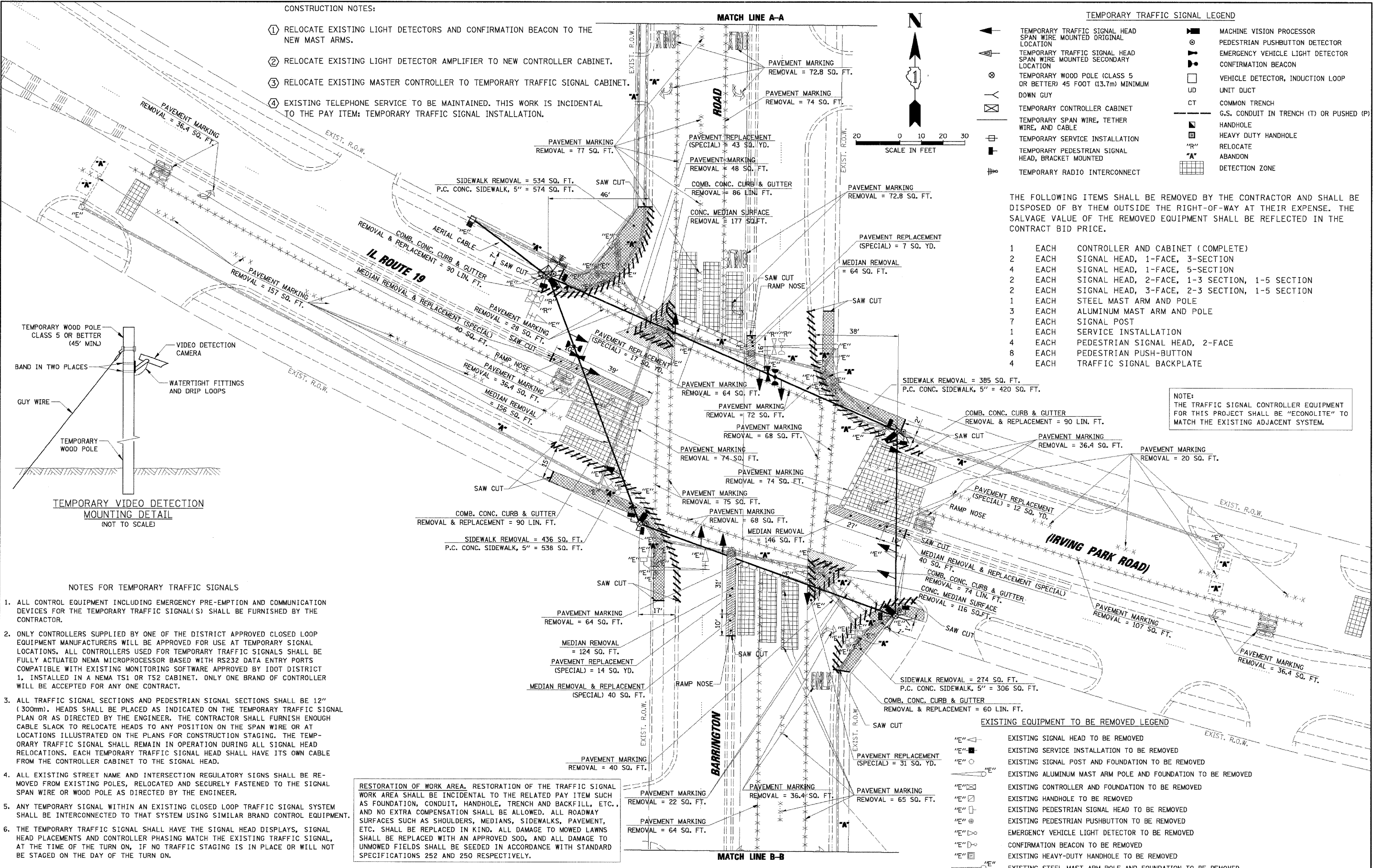

EXISTING EQUIPMENT TO BE REMOVED LEGEND

- | | |
|-------|--|
| "E" ▲ | EXISTING SIGNAL HEAD TO BE REMOVED |
| "E" ■ | EXISTING SERVICE INSTALLATION TO BE REMOVED |
| "E" ⊙ | EXISTING SIGNAL POST AND FOUNDATION TO BE REMOVED |
| "E" ⊠ | EXISTING ALUMINUM MAST ARM POLE AND FOUNDATION TO BE REMOVED |
| "E" ⊠ | EXISTING CONTROLLER AND FOUNDATION TO BE REMOVED |
| "E" □ | EXISTING HANDHOLE TO BE REMOVED |
| "E" ⊠ | EXISTING PEDESTRIAN SIGNAL HEAD TO BE REMOVED |
| "E" ⊙ | EXISTING PEDESTRIAN PUSHBUTTON TO BE REMOVED |
| "E" ⊠ | EXISTING EMERGENCY VEHICLE LIGHT DETECTOR TO BE REMOVED |
| "E" ⊠ | EXISTING CONFIRMATION BEACON TO BE REMOVED |
| "E" ⊠ | EXISTING HEAVY-DUTY HANDHOLE TO BE REMOVED |
| "E" ⊠ | EXISTING STEEL MAST ARM POLE AND FOUNDATION TO BE REMOVED |

FILE NAME =	USER NAME = FPAIONE	DESIGNED - ABR	REVISED -	STATE OF ILLINOIS DEPARTMENT OF TRANSPORTATION				TEMPORARY TRAFFIC SIGNAL INSTALLATION AND REMOVE EXISTING TRAFFIC SIGNAL EQUIPMENT IL ROUTE 19 (IRVING PARK ROAD) AND BARRINGTON ROAD							
...Traffic\TMPL1988Barrington.dgn	DRAWN - FPB / FCP	REVISIONS -						SCALE: 1" = 20'	SHEET NO. OF SHEETS	STA. TO STA.	F.A.U. RTE. 1321	SECTION 2009-034 TS	COUNTY COOK	TOTAL SHEETS 45	SHEET NO. 9
	CHECKED - MJT	REVISIONS -													
	DATE -	REVISIONS -													
	PLOT SCALE = 20'	DATE -						CONTRACT NO. 60639							
	PLOT DATE = 3/18/2009							FED. ROAD DIST. NO. ILLINOIS FED. AID PROJECT							