

CONSTRUCTION NOTES:

PRIOR TO ANY EXCAVATION, THE CONTRACTOR SHALL COORDINATE WITH THE VARIOUS UTILITIES AND CITY OF CHICAGO HEIGHTS FOR ALL BURIED UTILITIES. ALL UTILITIES WILL BE IDENTIFIED AND MARKED IN THE FIELD, CALL 1-800-0123.

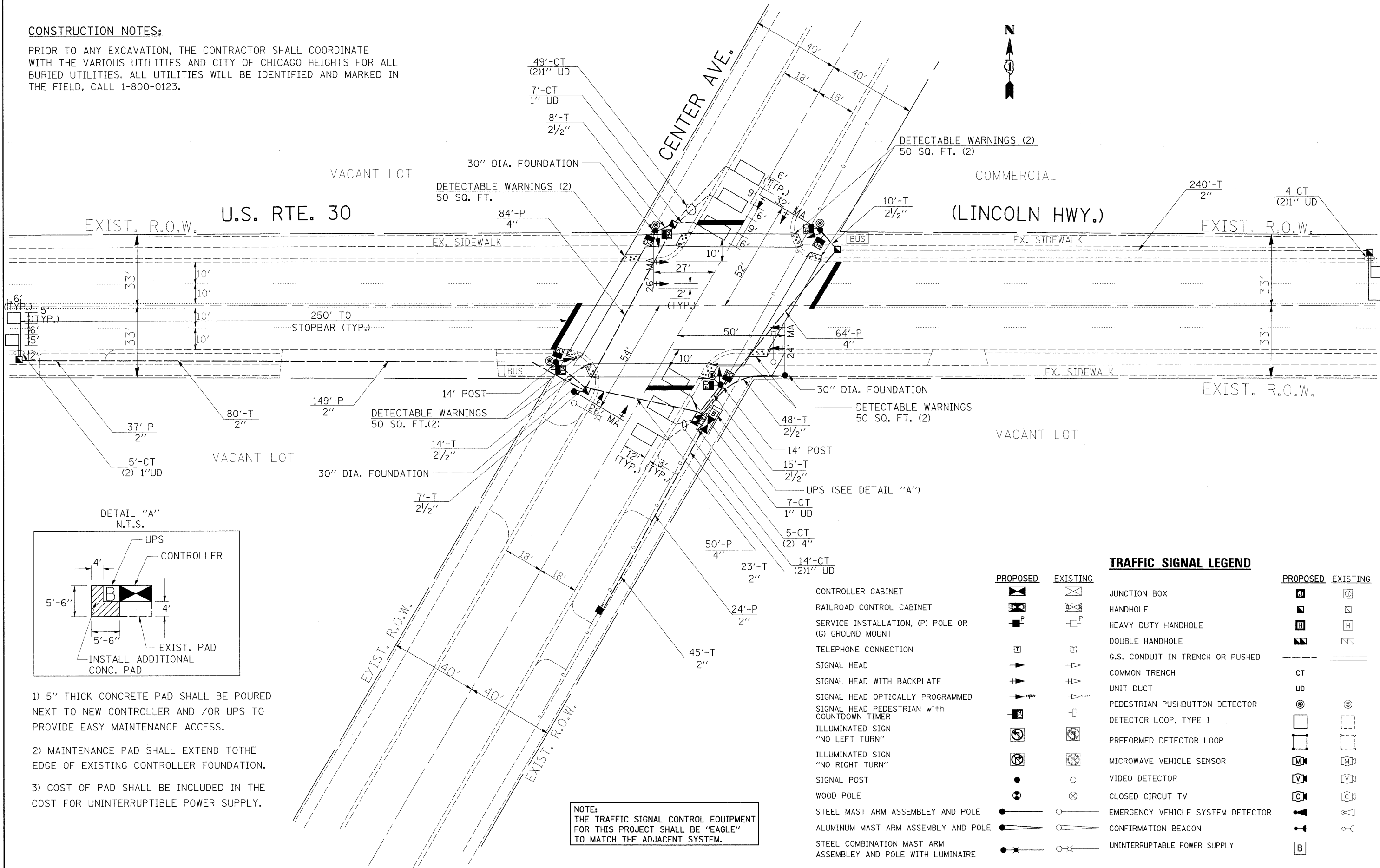

DETAIL "A"
N.T.S.

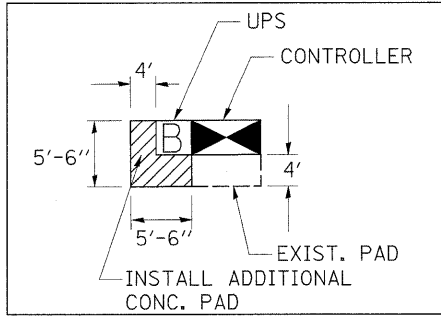

- 1) 5" THICK CONCRETE PAD SHALL BE POURED NEXT TO NEW CONTROLLER AND /OR UPS TO PROVIDE EASY MAINTENANCE ACCESS.
- 2) MAINTENANCE PAD SHALL EXTEND TO THE EDGE OF EXISTING CONTROLLER FOUNDATION.
- 3) COST OF PAD SHALL BE INCLUDED IN THE COST FOR UNINTERRUPTIBLE POWER SUPPLY.

NOTE:
THE TRAFFIC SIGNAL CONTROL EQUIPMENT FOR THIS PROJECT SHALL BE "EAGLE" TO MATCH THE ADJACENT SYSTEM.

- CONTROLLER CABINET
- RAILROAD CONTROL CABINET
- SERVICE INSTALLATION, (P) POLE OR (G) GROUND MOUNT
- TELEPHONE CONNECTION
- SIGNAL HEAD
- SIGNAL HEAD WITH BACKPLATE
- SIGNAL HEAD OPTICALLY PROGRAMMED
- SIGNAL HEAD PEDESTRIAN WITH COUNTDOWN TIMER
- ILLUMINATED SIGN "NO LEFT TURN"
- ILLUMINATED SIGN "NO RIGHT TURN"
- SIGNAL POST
- WOOD POLE
- STEEL MAST ARM ASSEMBLY AND POLE
- ALUMINUM MAST ARM ASSEMBLY AND POLE
- STEEL COMBINATION MAST ARM ASSEMBLY AND POLE WITH LUMINAIRE

TRAFFIC SIGNAL LEGEND		PROPOSED	EXISTING
JUNCTION BOX			
HANDHOLE			
HEAVY DUTY HANDHOLE			
DOUBLE HANDHOLE			
G.S. CONDUIT IN TRENCH OR PUSHED			
COMMON TRENCH			
UNIT DUCT			
PEDESTRIAN PUSHBUTTON DETECTOR			
DETECTOR LOOP, TYPE I			
PERFORMED DETECTOR LOOP			
MICROWAVE VEHICLE SENSOR			
VIDEO DETECTOR			
CLOSED CIRCUIT TV			
EMERGENCY VEHICLE SYSTEM DETECTOR			
CONFIRMATION BEACON			
UNINTERRUPTIBLE POWER SUPPLY			