

CABLE PLAN LEGEND

- | | | | |
|--|--|--|--|
| | | | |
| | | | |
| | | | |
| | | | |
| | | | |
| | | | |

SCHEDULE OF QUANTITIES

SIGN PANEL, TYPE 2
 THERMOPLASTIC PAVEMENT MARKING, LINE-12"
 THERMOPLASTIC PAVEMENT MARKING, LINE-24"
 THERMOPLASTIC PAVEMENT MARKING REMOVAL
 CONDUIT IN TRENCH, 2 1/2" DIA., GALVANIZED STEEL
 CONDUIT PUSHED, 2 1/2" DIA., GALVANIZED STEEL
 MAINTENANCE OF EXISTING TRAFFIC SIGNAL INSTALLATION
 FULL-ACTUATED CONTROLLER AND TYPE IV CABINET, SPECIAL
 ELECTRIC CABLE IN CONDUIT, SIGNAL NO. 14 2C
 ELECTRIC CABLE IN CONDUIT, SIGNAL NO. 14 3C
 ELECTRIC CABLE IN CONDUIT, SIGNAL NO. 14 5C
 ELECTRIC CABLE IN CONDUIT, LEAD-IN, NO. 14 1 PAIR
 TRAFFIC SIGNAL POST, GALVANIZED STEEL 14 FT.
 TRAFFIC SIGNAL POST, GALVANIZED STEEL 16 FT.
 STEEL MAST ARM ASSEMBLY AND POLE, 30 FT.
 CONCRETE FOUNDATION, TYPE A
 CONCRETE FOUNDATION, TYPE E 36-INCH DIAMETER
 DRILL EXISTING HANDHOLE
 SIGNAL HEAD, LED, 1-FACE, 3-SECTION, MAST-ARM MOUNTED
 SIGNAL HEAD, LED, 1-FACE, 3-SECTION, BRACKET MOUNTED
 SIGNAL HEAD, LED, 2-FACE, 3-SECTION, BRACKET MOUNTED
 PEDESTRIAN SIGNAL HEAD, L.E.D., 1-FACE, BRACKET MOUNTED WITH COUNTDOWN TIMER
 TRAFFIC SIGNAL BACKPLATE, LOUVERED, ALUMINUM
 INDUCTIVE LOOP DETECTOR
 DETECTOR LOOP, TYPE 1
 PEDESTRIAN PUSH-BUTTON
 REMOVE ELECTRIC CABLE FROM CONDUIT
 REMOVE EXISTING TRAFFIC SIGNAL EQUIPMENT
 REMOVE EXISTING CONCRETE FOUNDATION
 TEMPORARY INFORMATION SIGNING
 ELECTRIC CABLE IN CONDUIT, GROUNDING, NO. 6 1C
 ELECTRIC CABLE IN CONDUIT, NO. 20 3/C, TWISTED & SHIELDED
 UNINTERRUPTIBLE POWER SUPPLY

| FOUNDATION (DEPTH) | FT. (m) | CABLE SLACK | FT. (m) | VERTICAL | FT. (m) |
|--------------------|----------|------------------|-----------|-------------------|------------|
| TYPE A - POST | 4 (1.2) | HANDHOLE | 6.5 (2.0) | ALL FOUNDATIONS | 3.0 (1.0) |
| D - CONTROLLER | 4 (1.2) | DOUBLE HANDHOLE | 13 (4.0) | MAST ARM (L) POLE | 20.0 (6.0) |
| E - M. ARM POLE | 0 (0.0) | SIGNAL POST | 0 (0.0) | BRACKET MOUNTED | 13 (4.0) |
| 24" (600mm) | 10 (3.0) | CONTROLLER CAB. | 0 (0.0) | PED. PUSH-BUTTON | 6 (2.0) |
| 30" (750mm) | 15 (4.6) | FIBER OPTIC | 13 (4.0) | ELECTRIC SERVICE | 13.5 (4.1) |
| | | ELECTRIC SERVICE | 1 (0.5) | SERVICE TO GROUND | 13.5 (4.1) |
| | | GROUND CABLE | 1 (0.5) | POST MOUNTED | 13 (4.0) |

I.D.O.T
 TRAFFIC SIGNAL INSTALLATION
 ELECTRICAL SERVICE REQUIREMENTS

| TYPE | NO. LAMPS | WATTAGE INCAND. | WATTAGE LED | %OPERATION | TOTAL WATTAGE |
|--------------|-----------|-----------------|-------------|------------|---------------|
| SIGNAL (RED) | 13 | 135 | 17 | 0.50 | 110.5 |
| (YELLOW) | 13 | 135 | 25 | 0.25 | 81.25 |
| (GREEN) | 13 | 135 | 15 | 0.25 | 48.75 |
| ARROW | | 135 | 12 | 0.10 | |
| PED. SIGNAL | 2 | 90 | 25 | 1.00 | 50 |
| CONTROLLER | 1 | 100 | 100 | 1.00 | 100 |
| ILLUM. SIGN | | 84 | | 0.05 | |

FLASHER 0.50

ENERGY COSTS TO: TOTAL = 390.5

ENERGY SUPPLY CONTACT: _____
 PHONE: _____
 COMPANY: COMED

FILE NAME = \MICROST\352072\ IL102@ KAHLER CAB.DGN
 USER NAME = RDS
 DESIGNED - KK
 DRAWN - RDS
 CHECKED - BPT
 PLOT DATE = 03-18-09
 REVISIONS -

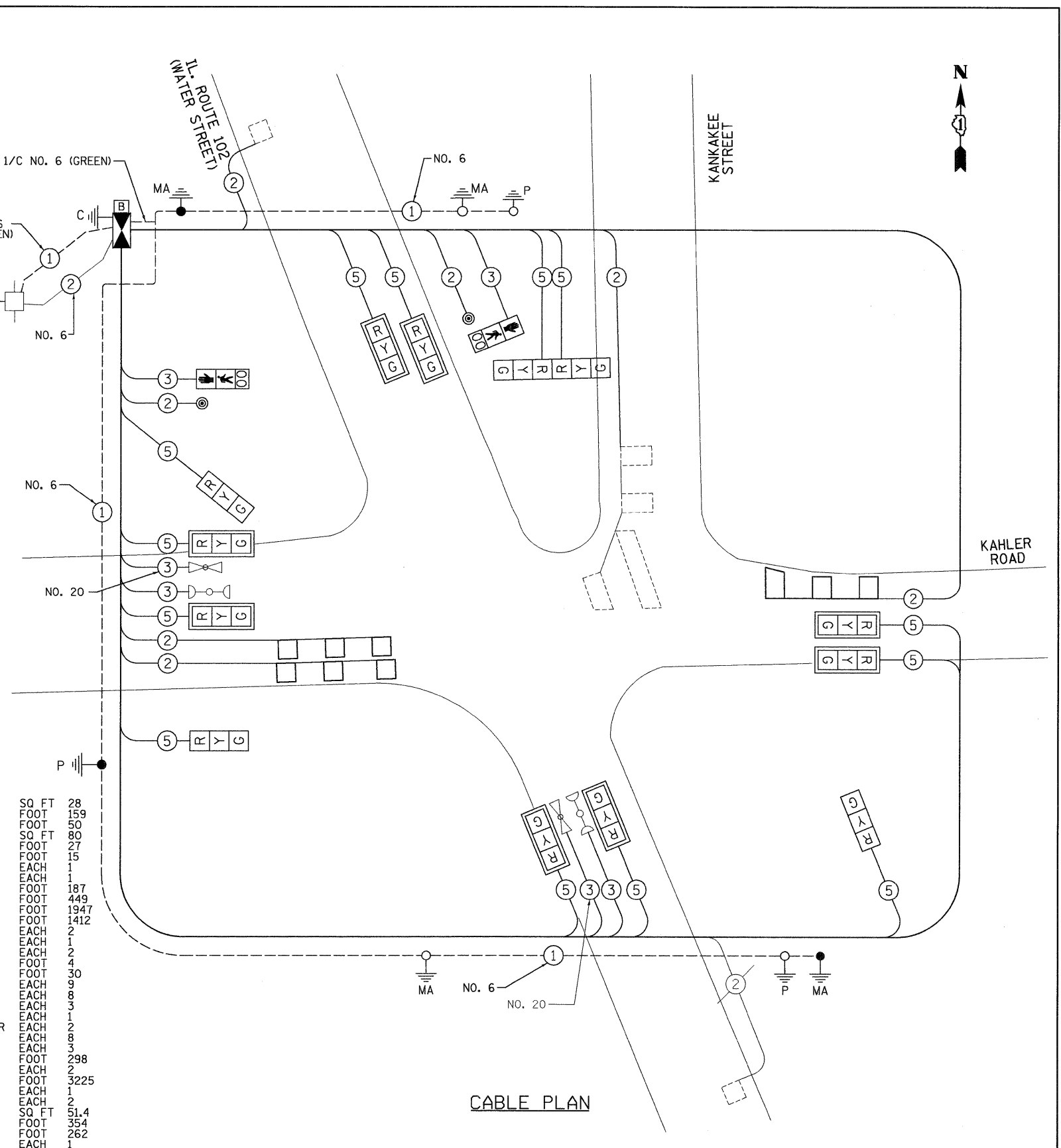

| | |
|-------|------|
| SQ FT | 28 |
| FOOT | 159 |
| FOOT | 50 |
| SQ FT | 80 |
| FOOT | 27 |
| FOOT | 15 |
| EACH | 1 |
| EACH | 1 |
| FOOT | 187 |
| FOOT | 449 |
| FOOT | 1947 |
| FOOT | 1412 |
| EACH | 2 |
| EACH | 1 |
| FOOT | 30 |
| FOOT | 4 |
| FOOT | 30 |
| EACH | 9 |
| EACH | 8 |
| EACH | 3 |
| EACH | 1 |
| EACH | 2 |
| FOOT | 298 |
| EACH | 2 |
| FOOT | 3225 |
| EACH | 1 |
| EACH | 2 |
| SQ FT | 51.4 |
| FOOT | 354 |
| FOOT | 262 |
| EACH | 1 |

CABLE PLAN

STATE OF ILLINOIS
 DEPARTMENT OF TRANSPORTATION

SCHEDULE OF QUANTITIES, CABLE PLAN AND PHASE DESIGNATION DIAGRAM
 IL. ROUTE 102 (WATER STREET) AT KAHLER ROAD

SCALE: N.T.S. SHEET NO. OF SHEETS STA. TO STA.

PREPARED BY:
CEMCON, Ltd.
 Consulting Engineers, Land Surveyors & Planners
 2280 White Oak Circle, Suite 100
 Aurora, Illinois 60504-9675
 Ph: 630.862.2100 Fax: 630.862.2199
 E-Mail: cadd@cemcon.com Website: www.cemcon.com

| F.A.P. RTE. | SECTION | COUNTY | TOTAL SHEETS | SHEET NO. |
|-------------|-------------|--------|--------------|-----------|
| | 2009-036 TS | WILL | 13 | 10 |

CONTRACT NO. 60G41
 FED. ROAD DIST. NO. ILLINOIS FED. AID PROJECT