

F.A.P. RTE.	SECTION	COUNTY	TOTAL SHEETS	SHEET NO.
	2009-037 TS	WILL	21	1
FED. ROAD DIST. NO.	ILLINOIS	CONTRACT NO.	60G42	

D-91-404-09

INDEX OF SHEETS

1. TITLE SHEET
2. GENERAL NOTES
3. SUMMARY OF QUANTITIES
- 4.-7. DISTRICT 1 STANDARD TRAFFIC SIGNAL DESIGN DETAILS
8. PLAN - LED TRAFFIC SIGNAL RETROFIT FLASHER LOCATIONS GOVERNORS HIGHWAY AT STUENKEL ROAD
9. TRAFFIC SIGNAL MODERNIZATION PLAN U.S. RTE. 45 AT WILLOW LN. /195th ST.
10. CABLE PLAN, SCHEDULE OF QUANTITIES AND PHASE DESIGNATION DIAGRAM U.S. RTE. 45 AT 195th ST. (WILLOW LANE)
11. TRAFFIC SIGNAL MODERNIZATION PLAN U.S. RTE. 45 AT LA PORTE RD.
12. CABLE PLAN, SCHEDULE OF QUANTITIES AND PHASE DESIGNATION DIAGRAM U.S. RTE. 45 AT LA PORTE RD.
13. TRAFFIC SIGNAL MODERNIZATION PLAN U.S. RTE. 45 AT LINCOLN-WAY HIGH SCHOOL
14. CABLE PLAN, SCHEDULE OF QUANTITIES AND PHASE DESIGNATION DIAGRAM U.S. RTE. 45 AT LINCOLNWAY LANE
15. TRAFFIC SIGNAL MODERNIZATION PLAN U.S. RTE. 45 AT COLORADO AVE.
16. TEMPORARY CABLE PLAN AND PHASE DESIGNATION DIAGRAM U.S. RTE. 45 AT COLORADO AVE.
17. TEMPORARY TRAFFIC SIGNAL INSTALLATION AND REMOVAL PLAN IL ROUTE 1 (DIXIE HIGHWAY) AT EXCHANGE STREET
18. TEMPORARY CABLE PLAN AND PHASE DESIGNATION DIAGRAM IL ROUTE 1 (DIXIE HIGHWAY) AT EXCHANGE STREET
19. TRAFFIC SIGNAL MODIFICATION PLAN IL ROUTE 1 (DIXIE HIGHWAY) AT EXCHANGE STREET
20. SCHEDULE OF QUANTITIES, CABLE PLAN IL ROUTE 1 (DIXIE HIGHWAY) AT EXCHANGE STREET
21. MAST ARM MOUNTED STREET NAME SIGN IL ROUTE 1 (DIXIE HIGHWAY) AT EXCHANGE STREET

STATE OF ILLINOIS
DEPARTMENT OF TRANSPORTATION
DIVISION OF HIGHWAYS
**PLANS FOR PROPOSED
FEDERAL AID HIGHWAY**

DISTRICT 1
HIGHWAY SAFETY IMPROVEMENT PROJECT
FAP840 Governors Highway @ Stuenkel Road (IL 50)
FAP330 US 45 @ 195th Street
FAP330 US 45 @ LaPorte Road
FAP330 US 45 @ Lincoln Way Lane
FAP330 US 45 @ Colorado Street
FAP876 IL 1 @ Exchange Street
PROJECT: HSI-P-000S(682)

WILL COUNTY
SECTION 2009-037 TS
C-91-404-09

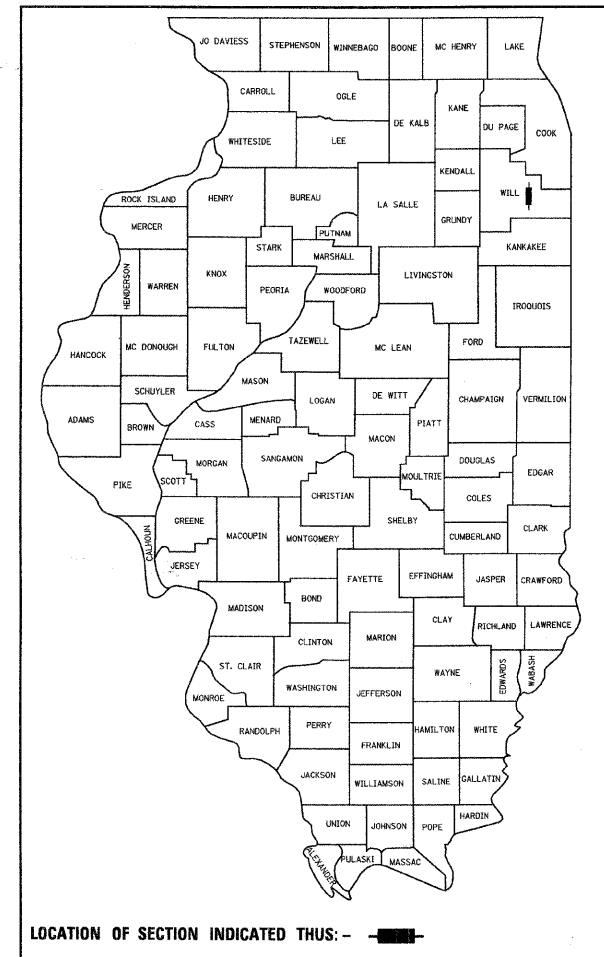

IDOT STANDARDS:

- 424001-05 CURB RAMPS FOR SIDEWALKS
- 701001-02 OFF-RD OPERATIONS, 2L, 2W MORE THAN 15' (4.5m) AWAY
- 701011-02 OFF-RD MOVING OPERATIONS, 2L, 2W, DAY ONLY
- 701101-02 OFF-RD OPERATIONS, MULTILANE, 15' (4.5 m) TO 24' (600 mm) FROM PAVEMENT EDGE
- 701106-02 OFF-RD OPERATIONS, MULTILANE, MORE THAN 15' (4.5 m) AWAY
- 701301-03 LANE CLOSURE, 2L, SHORT TIME OPERATIONS
- 701201-03 LANE CLOSURE, 2L, 2W, DAY ONLY, FOR SPEEDS > 45 MPH
- 701421-02 LANE CLOSURE, MULTILANE, DAY OPERATIONS ONLY, FOR SPEEDS > 45 MPH TO 55 MPH
- 701501-05 URBAN LANE CLOSURE, 2L, 2W, UNDIVIDED
- 701701-06 URBAN LANE CLOSURE, MULTILANE INTERSECTION
- 701801-04 LANE CLOSURE MULTILANE 1W OR 2W CROSSWALK OR SIDEWALK CLOSURE
- 701901-01 TRAFFIC CONTROL DEVICES
- 728001-01 SIGN PANEL MOUNTING DETAILS
- 814001-02 HANDHOLES
- 814006-02 DOUBLE HANDHOLES
- 857001-01 STANDARD PHASE DESIGNATION DIAGRAMS AND PHASE SEQUENCES
- 886001-01 DETECTOR LOOP INSTALLATION
- 862001-01 UNINTERRUPTABLE POWER SUPPLY (UPS)
- 877001-04 STEEL MAST ARM ASSEMBLY AND POLE 16' THROUGH 55'
- 877006-03 STEEL MAST ARM ASSEMBLY AND POLE WITH DUAL MAST ARMS
- 878001-07 CONCRETE FOUNDATION DETAILS
- 880001-01 SPAN WIRE MOUNTED SIGNALS AND FLASHING BEACON INSTALLATION
- 880006-01 TRAFFIC SIGNAL MOUNTING DETAILS

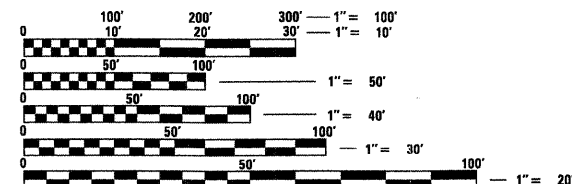

FULL SIZE PLANS HAVE BEEN PREPARED USING STANDARD ENGINEERING SCALES. REDUCED SIZED PLANS WILL NOT CONFORM TO STANDARD SCALES. IN MAKING MEASUREMENTS ON REDUCED PLANS, THE ABOVE SCALES MAY BE USED.

J.U.L.I.E.
JOINT UTILITY LOCATING INFORMATION FOR EXCAVATORS
1-800-892-0123
OR 811

CONTRACT NO. 60G42

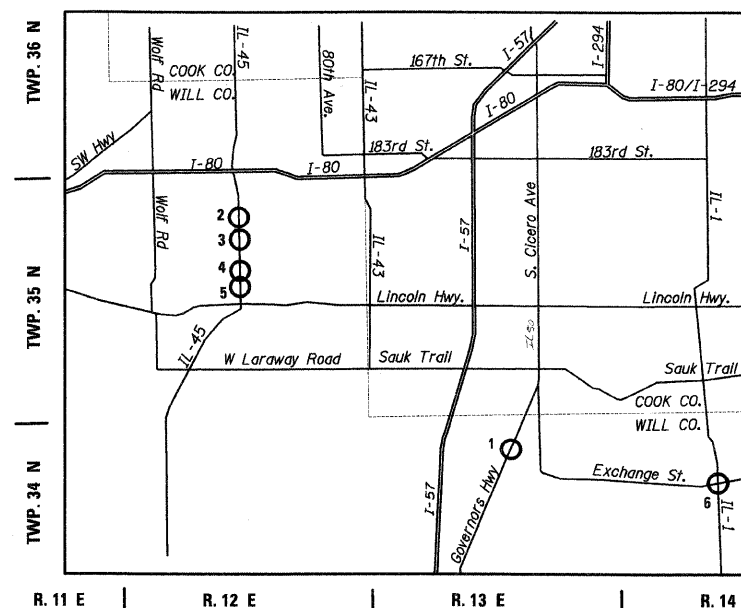

LOCATION MAP



LEGEND:

1. Governors Highway @ Stuenkel Road
2. US 45 @ 195th Street
3. US 45 @ LaPorte Road
4. US 45 @ Lincoln Way Lane
5. US 45 @ Colorado Street
6. IL 1 @ Exchange Street



Bruce P. Talbot
03-18-2009
Expires: 11-30-2009

PREPARED BY:
CEMCON, Ltd.
Consulting Engineers, Land Surveyors & Planners
2880 White Oak Circle, Suite 100
Aurora, Illinois 60504-9675
Ph: 630.882.2100 Fax: 630.882.2199
E-Mail: cadd@cemcon.com Website: www.cemcon.com

STATE OF ILLINOIS
DEPARTMENT OF TRANSPORTATION
DIVISION OF HIGHWAYS

SUBMITTED March 20 2009

Devin M. O'Keefe
DEPUTY DIRECTOR OF HIGHWAYS, REGION ENGINEER

May 8, 2009
Charles J. Ingersoll
ENGINEER OF DESIGN AND ENVIRONMENT

May 8, 2009
Christine M. Reed
DIRECTOR OF HIGHWAYS, CHIEF ENGINEER

**PRINTED BY THE AUTHORITY
OF THE STATE OF ILLINOIS**

BUREAU OF TRAFFIC, DISTRICT ONE: STEPHEN TRAVIA / DARYLE DREW (847) 705-4420