

F.A.P. RTE.	SECTION	COUNTY	TOTAL SHEETS	SHEET NO.
	2009-039 TS	WILL	20	1
FED. ROAD DIST. NO.	ILLINOIS	CONTRACT NO. 60G44		

D-91-406-09

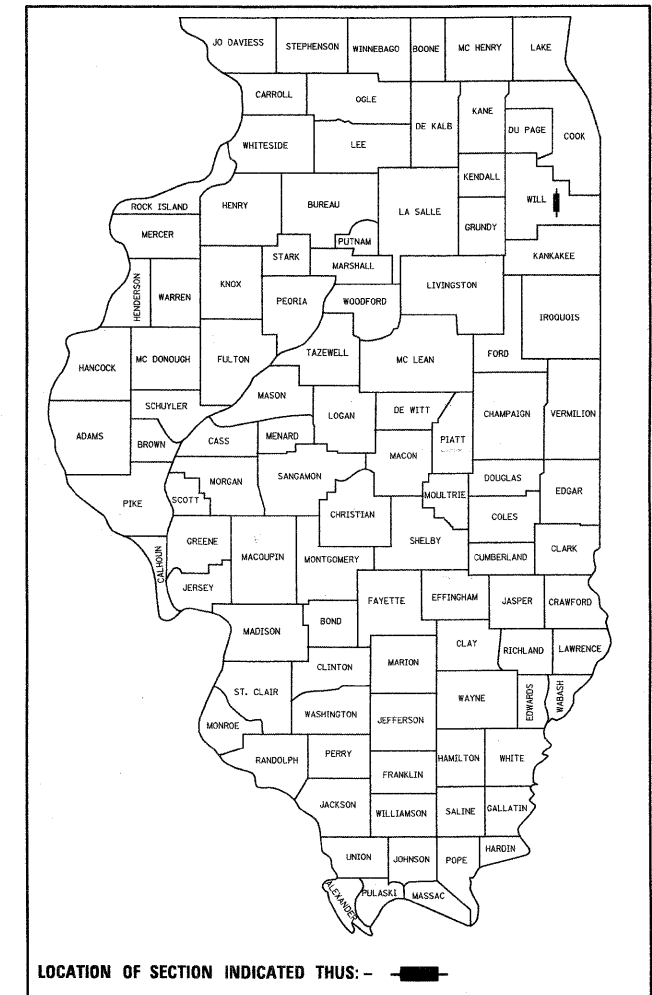

LOCATION OF SECTION INDICATED THUS: - [black rectangle] -

PREPARED BY:
CEMCON, Ltd.
 Consulting Engineers, Land Surveyors & Planners
 2280 White Oak Circle, Suite 100
 Aurora, Illinois 60504-9675
 Ph: 630.862.2100 Fax: 630.862.2199
 E-Mail: cadd@cemcon.com Website: www.cemcon.com

STATE OF ILLINOIS
 DEPARTMENT OF TRANSPORTATION
 DIVISION OF HIGHWAYS

SUBMITTED March 20 2009
Kevin M. O'Keefe
 DEPUTY DIRECTOR OF HIGHWAYS, REGION ENGINEER

May 8, 2009
Charles J. Ingwersen
 ENGINEER OF DESIGN AND ENVIRONMENT

May 8, 2009
Christina M. Reed
 DIRECTOR OF HIGHWAYS, CHIEF ENGINEER

**PRINTED BY THE AUTHORITY
 OF THE STATE OF ILLINOIS**

STATE OF ILLINOIS
 DEPARTMENT OF TRANSPORTATION
 DIVISION OF HIGHWAYS
**PLANS FOR PROPOSED
 FEDERAL AID HIGHWAY**
 DISTRICT 1
 HIGHWAY SAFETY IMPROVEMENT PROJECT

FAU 323(IL 126 @ Essington Road)
FAP 577(IL 171 @ Woodruff Road)
FAP 112 (IL 53 @ Theodore Street
 IL 53 @ Murphy Road
 IL 53 @ Belmont Road
 IL 53 @ Joliet Road)

PROJECT: HSIP-0005(674)

**WILL COUNTY
 SECTION 2009-039 TS
 C-91-406-09**

INDEX OF SHEETS

1. TITLE SHEET
2. GENERAL NOTES
3. SUMMARY OF QUANTITIES
- 4.-7. DISTRICT 1 STANDARD TRAFFIC SIGNAL DESIGN DETAILS
8. PLAN - LED TRAFFIC SIGNAL RETROFIT FLASHER LOCATIONS
IL. ROUTE 126 AT ESSINGTON ROAD
9. TRAFFIC SIGNAL MODERNIZATION PLAN
IL. RTE. 171 AT WOODRUFF RD.
10. CABLE PLAN, SCHEDULE OF QUANTITIES AND PHASE DESIGNATION DIAGRAM
IL. RTE. 171 AT WOODRUFF RD.
11. TRAFFIC SIGNAL MODERNIZATION PLAN
IL. ROUTE 53 AT IL. ROUTE 7 (THEODORE ST.)
12. CABLE PLAN, SCHEDULE OF QUANTITIES AND PHASE DESIGNATION DIAGRAM
IL. ROUTE 53 AT IL. ROUTE 7 (THEODORE ST.)
13. TRAFFIC SIGNAL MODIFICATION PLAN
IL. ROUTE 53 (INDEPENDENCE BLVD.) AT MURPHY DRIVE
14. SCHEDULE OF QUANTITIES, CABLE PLAN AND PHASE DESIGNATION DIAGRAM
IL. ROUTE 53 (INDEPENDENCE BLVD.) AT MURPHY DRIVE
15. TRAFFIC SIGNAL MODIFICATION PLAN
IL. ROUTE 53 (INDEPENDENCE BLVD.) AT BELMONT DRIVE
16. SCHEDULE OF QUANTITIES, CABLE PLAN AND PHASE DESIGNATION DIAGRAM
IL. ROUTE 53 (INDEPENDENCE BLVD.) AT BELMONT DRIVE
17. TRAFFIC SIGNAL MODIFICATION PLAN
IL. ROUTE 53 AT JOLIET ROAD
18. SCHEDULE OF QUANTITIES, CABLE PLAN AND PHASE DESIGNATION DIAGRAM
IL. ROUTE 53 AT JOLIET ROAD
19. INTERCONNECT SCHEMATIC
IL. ROUTE 53 FROM TAYLOR ROAD TO INTERNATIONALE PARKWAY
20. MAST ARM MOUNTED STREET NAME SIGN
IL. ROUTE 53 AT JOLIET ROAD

IDOT STANDARDS:

- 701001-02 OFF-RD OPERATIONS, 2L 2W MORE THAN 15' (4.5m) AWAY
- 701011-02 OFF-RD MOVING OPERATIONS, 2L 2W, DAY ONLY
- 701101-02 OFF-RD OPERATIONS, MULTILANE, 15' (4.5 m) TO 24' (600 mm) FROM PAVEMENT EDGE
- 701106-02 OFF-RD OPERATIONS, MULTILANE, MORE THAN 15' (4.5 m) AWAY
- 701301-03 LANE CLOSURE, 2L 2W, SHORT TIME OPERATIONS
- 701201-03 LANE CLOSURE, 2L 2W, DAY ONLY, FOR SPEEDS > 45 MPH
- 701421-02 LANE CLOSURE, MULTILANE, DAY OPERATIONS ONLY, FOR SPEEDS > 45 MPH TO 55 MPH
- 701501-05 URBAN LANE CLOSURE, 2L 2W, UNDIVIDED
- 701601-06 URBAN LANE CLOSURE, MULTILANE, 1W OR 2W WITH NONTRAVERSABLE MEDIAN
- 701701-06 URBAN LANE CLOSURE, MULTILANE INTERSECTION
- 701901-01 TRAFFIC CONTROL DEVICES
- 720001-01 SIGN PANEL MOUNTING DETAILS
- 814001-02 HANDHOLES
- 814006-02 DOUBLE HANDHOLES
- 857001-01 STANDARD PHASE DESIGNATION DIAGRAMS AND PHASE SEQUENCES
- 886001-01 DETECTOR LOOP INSTALLATIONS
- 862001-01 UNINTERRUPTIBLE POWER SUPPLY (UPS)
- 877001-04 STEEL MAST ARM ASSEMBLY AND POLE 16' THROUGH 55'
- 877011-04 STEEL COMB. MAST ARM ASSEMBLY AND POLE 16' THROUGH 55'
- 878001-07 CONCRETE FOUNDATION DETAILS
- 880001-01 SPAN WIRE MOUNTED SIGNALS AND FLASHING BEACON INSTALLATION
- 880006-01 TRAFFIC SIGNAL MOUNTING DETAILS

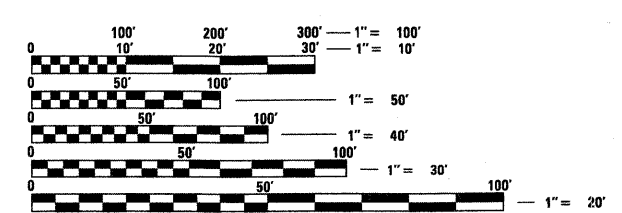

FULL SIZE PLANS HAVE BEEN PREPARED USING STANDARD ENGINEERING SCALES. REDUCED SIZED PLANS WILL NOT CONFORM TO STANDARD SCALES. IN MAKING MEASUREMENTS ON REDUCED PLANS, THE ABOVE SCALES MAY BE USED.

J.U.L.I.E.
 JOINT UTILITY LOCATING INFORMATION FOR EXCAVATORS
 1-800-892-0123
 OR 811

CONTRACT NO. 60G44

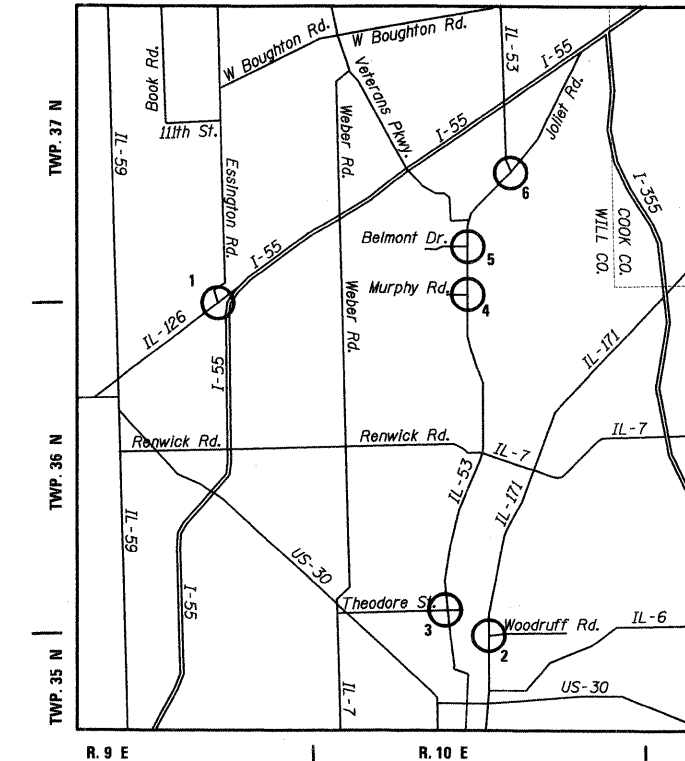

LOCATION MAP

- LEGEND:**
1. IL 126 @ Essington Road
 2. IL 171 @ Woodruff Road
 3. IL 53 @ Theodore Street
 4. IL 53 @ Murphy Road
 5. IL 53 @ Belmont Road
 6. IL 53 @ Joliet Road

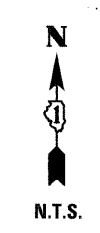

Bruce P. Talbot
 03-18-2009
 Expires: 11-30-2009

BUREAU OF TRAFFIC, DISTRICT ONE: STEPHEN TRAVIA / DARYLE DREW (847) 705-4420