

F.A. ROUTE NO.	SECTION	COUNTY	TOTAL SHEETS	SHEET NO.
866	*	LAKE	554	4
FED. ROAD DIST. NO.		ILLINOIS	FED. AID PROJECT	
*(L-2EW,R);6.6A & 6 EXT) WRS-1				

SUMMARY OF QUANTITIES

PAY ITEM NUMBER	DESCRIPTION	UNIT	URBAN		
			100% FED.	TOTAL QUANTITY	1000-2A QUANTITY
20100110	TREE REMOVAL (6 TO 15 UNIT DIAMETER)	UNIT	2,244	2,244	
20100210	TREE REMOVAL (OVER 15 UNIT DIAMETER)	UNIT	5,914	5,914	
20101000	TEMPORARY FENCE	FOOT	2,433	2,433	
20101100	TREE TRUNK PROTECTION	EACH	196	196	
20101200	TREE ROOT PRUNING	EACH	79	79	
20101300	TREE PRUNING (1 TO 10 INCH DIAMETER)	EACH	56	56	
20101350	TREE PRUNING (OVER 10 INCH DIAMETER)	EACH	140	140	
20200100	EARTH EXCAVATION	CU YD	34,039	34,039	
20201200	REMOVAL AND DISPOSAL OF UNSUITABLE MATERIAL	CU YD	31,512	31,512	
20700400	POROUS GRANULAR EMBANKMENT, SPECIAL	CU YD	16	16	
20700420	POROUS GRANULAR EMBANKMENT, SUBGRADE	CU YD	3,968	3,968	
20800150	TRENCH BACKFILL	CU YD	4,574	4,574	
21101615	TOPSOIL FURNISH AND PLACE, 4"	SQ YD	68,594	68,594	
21101805	COMPOST FURNISH AND PLACE, 2"	SQ YD	30,139	30,139	
25000210	SEEDING, CLASS 2A	ACRE	9.0	9.0	
25000312	SEEDING, CLASS 4A	ACRE	6.3	6.3	
25000400	NITROGEN FERTILIZER NUTRIENT	POUND	1,697	1,697	
25000600	POTASSIUM FERTILIZER NUTRIENT	POUND	1,697	1,697	
25100630	EROSION CONTROL BLANKET	SQ YD	42,759	42,759	
25200110	SODDING, SALT TOLERANT	SQ YD	25,835	25,835	
28000250	TEMPORARY EROSION CONTROL SEEDING	POUND	8,160	8,160	
28000300	TEMPORARY DITCH CHECKS	EACH	89	89	
28000400	PERIMETER EROSION BARRIER	FOOT	47,650	47,650	
28000510	INLET FILTERS	EACH	280	280	
28001000	AGGREGATE (EROSION CONTROL)	TON	687	687	
28100105	STONE RIPRAP, CLASS A3	SQ YD	144	144	
28100109	STONE RIPRAP, CLASS A5	SQ YD	27	27	
28100111	STONE RIPRAP, CLASS A6	SQ YD	15	15	
28200200	FILTER FABRIC	SQ YD	1,875	1,875	
35501308	HOT-MIX ASPHALT BASE COURSE, 6"	SQ YD	4,972	4,972	
35501316	HOT-MIX ASPHALT BASE COURSE, 8"	SQ YD	8,090	8,090	
40201000	AGGREGATE FOR TEMPORARY ACCESS	TON	200	200	▲
40600200	BITUMINOUS MATERIALS (PRIME COAT)	TON	60	60	
40600300	AGGREGATE (PRIME COAT)	TON	289	289	
40600400	MIXTURE FOR CRACKS, JOINTS, AND FLANGEWAYS	TON	87	87	

• DENOTES SPECIALTY ITEM

REVISIONS		ILLINOIS DEPARTMENT OF TRANSPORTATION ILLINOIS ROUTE 83 FROM THE WISCONSIN STATE LINE TO NORTH OF PETITE LAKE ROAD <b>SUMMARY OF QUANTITIES</b> SHEET 1 OF 10 DRAWN BY: GP CHECKED BY: MW DATE: 1/30/09 GRAEF, ANHALT, SCHLOEMER & ASSOCIATES, INC. CHICAGO, ILLINOIS
NAME	DATE	

▲ Rev. 5-27-09

F.A. ROUTE NO.	SECTION	COUNTY	TOTAL SHEETS	SHEET NO.
866	*	LAKE	554	9
FED. ROAD DIST. NO.		ILLINOIS	FED. AID PROJECT	
*(L-21W,R);6,6A & 6 EXT) WRS-1				

SUMMARY OF QUANTITIES

PAY ITEM NUMBER	DESCRIPTION	UNIT	URBAN	
			100% FED. TOTAL QUANTITY	1000-2A QUANTITY
60624600	CORRUGATED MEDIAN	SQ FT	125	125
* 63000001	STEEL PLATE BEAM GUARD RAIL, TYPE A, <i>6 FOOT POSTS</i>	FOOT	1,013	1,013
* 63100085	TRAFFIC BARRIER TERMINAL, TYPE 6	EACH	1	1
* 63100167	TRAFFIC BARRIER TERMINAL, TYPE 1 (SPECIAL) TANGENT	EACH	17	17
63200310	GUARDRAIL REMOVAL	FOOT	202	202
66400105	CHAIN LINK FENCE, 4'	FOOT	134	134
* 66900200	NON-SPECIAL WASTE DISPOSAL	CU YD	1,200	1,200
* 66900450	SPECIAL WASTE PLANS AND REPORT	L SUM	1	1
* 66900530	SOIL DISPOSAL ANALYSIS	EACH	7	7
* 66901000	BACKFILL PLUGS	CU YD	15	15
<i>X6700410</i>	ENGINEERS FIELD OFFICE, TYPE A (SPECIAL)	CAL MO	18	18
67100100	MOBILIZATION	L SUM	1	1
70101800	TRAFFIC CONTROL AND PROTECTION (SPECIAL)	L SUM	1	1
70103815	TRAFFIC CONTROL SURVEILLANCE	CAL DA	273	273
70300210	TEMPORARY PAVEMENT MARKING - LETTERS AND SYMBOLS	SQ FT	323	323
70300220	TEMPORARY PAVEMENT MARKING - LINE 4"	FOOT	8,291	8,291
70300280	TEMPORARY PAVEMENT MARKING - LINE 24"	FOOT	104	104
70300510	PAVEMENT MARKING TAPE, TYPE III - LETTERS AND SYMBOLS	SQ FT	251	251
70300520	PAVEMENT MARKING TAPE, TYPE III - 4"	FOOT	10,824	10,824
70300570	PAVEMENT MARKING TAPE, TYPE III - 24"	FOOT	58	58
70301000	WORK ZONE PAVEMENT MARKING REMOVAL	SQ FT	3,954	3,954
* 78000100	THERMOPLASTIC PAVEMENT MARKING - LETTERS AND SYMBOLS	SQ FT	3,209	3,209
* 78000200	THERMOPLASTIC PAVEMENT MARKING - LINE 4"	FOOT	84,067	84,067
* 78000300	THERMOPLASTIC PAVEMENT MARKING - LINE 5"	FOOT	2,216	2,216
* 78000400	THERMOPLASTIC PAVEMENT MARKING - LINE 6"	FOOT	8,785	8,785
* 78000500	THERMOPLASTIC PAVEMENT MARKING - LINE 8"	FOOT	158	158

\* DENOTES SPECIALTY ITEM

G:\20004024\_N\ms\plan\set\sumquan06.dgn  
5/4/2009 10:54:24 AM

REVISIONS		ILLINOIS DEPARTMENT OF TRANSPORTATION ILLINOIS ROUTE 83 FROM THE WISCONSIN STATE LINE TO NORTH OF PETITE LAKE ROAD  SUMMARY OF QUANTITIES SHEET 6 OF 10  DRAWN BY: GP CHECKED BY: MW DATE: 1/30/09  GRAEF, ANHALT, SCHLOEMER & ASSOCIATES, INC. CHICAGO, ILLINOIS
NAME	DATE	

F.A. ROUTE NO.	SECTION	COUNTY	TOTAL SHEETS	SHEET NO.
866	*	LAKE	554	11
FED. ROAD DIST. NO.		ILLINOIS	FED. AID PROJECT	
*(L-21W.R)6.6A & 6 EXT) WRS-1				

URBAN  
100% FED

CODED PAY NO.	ITEM	UNIT	TOTAL QUANTITY	ROADWAY 1000-2A QUANTITY
* A2002009	TREE, AESCULUS FLAVEA (YELLOW SWEET BUCKEYE), 2 1/2" CALIPER, BALLED AND BURLAPPED	EACH	5	5
* A2000320	TREE, ACER MIYABE MORTON (STATE STREET MIYABE MAPLE), 2-1/2" CALIPER, BALLED AND BURLAPPED	EACH	10	10
* A2002370	TREE, BETULA NIGRA (RIVER BIRCH), 8' HEIGHT, CLUMP FORM, BALLED AND BURLAPPED	EACH	10	10
* A2002916	TREE, CELTIS OCCIDENTALIS (COMMON HACKBERRY), 2" CALIPER, BALLED AND BURLAPPED	EACH	11	11
* A2004716	TREE, GLEDITSIA TRIACANTHOS INERMIS SHADEMASTER (SHADEMASTER THORNLESS COMMON LOCUST), 2" CALIPER, BALLED AND BURLAPPED	EACH	11	11
* A2004614	TREE, GLEDITSIA TRIACANTHOS INERMIS PRINCETON (PRINCETON THORNLESS COMMON HONEYLOCUST), 2 1/2" CALIPER, BALLED AND BURLAPPED	EACH	5	5
* A2005016	TREE, GYMNOCLADUS DIOICUS (KENTUCKY COFFEETREE), 2" CALIPER, BALLED AND BURLAPPED	EACH	11	11
* A2006716	TREE, QUERCUS MACROCARPA (BUR OAK), 2" CALIPER, BALLED AND BURLAPPED	EACH	10	10
* B2005808	TREE, PYRUS CALLERYANA 'NEW BRADFORD' (NEW BRADFORD CALLERY PEAR), 2 1/2" CALIPER, BALLED AND BURLAPPED	EACH	6	6
* C2001420	SHRUB, CORNUS AMOMUM INDIGO (INDIGO SILKY DOGWOOD), 30" HEIGHT, BALLED AND BURLAPPED	EACH	60	60
* C2C06218	SHRUB, RIBES AMERICANUM (WILD BLACK CURRANT), 18" HEIGHT, CONTAINER	EACH	50	50
* A2005120	TREE, JUGLANS NIGRA (BLACK WALNUT), 2 1/2" CALIPER, BALLED AND BURLAPPED	EACH	6	6
* A2005620	TREE, OSTRYA VIRGINIANA (AMERICAN HOPHORNBEAM), 2 1/2" CALIPER, BALLED AND BURLAPPED	EACH	6	6
* A2006516	TREE, QUERCUS BICOLOR (SWAMP WHITE OAK), 2" CALIPER, BALLED AND BURLAPPED	EACH	3	3
* B2005416	TREE, PRUNUS VIRGINIANA SCHUBERT (SCHUBERT CHOKECHERRY), 2" CALIPER, BALLED AND BURLAPPED	EACH	7	7
* B2006316	TREE, SYRINGA RETICULATA IVORY SILK (IVORY SILK TREE LILAC), 2" CALIPER, BALLED AND BURLAPPED	EACH	9	9
* A2016616	TREE, QUERCUS ELLIPSOIDALIS (HILL'S OAK), 2" CALIPER, BALLED AND BURLAPPED	EACH	6	6
* C2001524	SHRUB, CORNUS RACEMOSA (GREY DOGWOOD), 2' HEIGHT, BALLED AND BURLAPPED	EACH	130	130
* A2007916	TREE, TILIA AMERICANA REDMOND (REDMOND AMERICAN LINDEN), 2" CALIPER, BALLED AND BURLAPPED	EACH	10	10
* A2008516	TREE, ULMUS MORTON GLASSY (TRIUMPH ELM), 2" CALIPER, BALLED AND BURLAPPED	EACH	9	9
* B2006116	TREE, SYRINGA PERKINENSIS MORTON (CHINA SNOW PEKING LILAC), 2" CALIPER, BALLED AND BURLAPPED & TREE FORM	EACH	4	4
* D2002172	EVERGREEN, PICEA PUNGENS (COLORADO SPRUCE), 6' HEIGHT, BALLED AND BURLAPPED	EACH	9	9
* K0029622	BROADLEAF WEED CONTROL IN TURF	GALLON	8	8
* K1004595	PRUNING FOR SAFETY AND EQUIPMENT CLEARANCE	L SUM	1	1
* X0322859	WEED CONTROL, PRE-EMERGENT GRANULAR HERBICIDE	POUND	136	136

* C2001124	SHRUB, CEPHALANTHUS OCCIDENTALIS (BUTTON BUSH), 2' HEIGHT, BALLED AND BURLAPPED	EACH	60	60
* C2001424	SHRUB, CORNUS AMOMUM (SILKY DOGWOOD), 2' HEIGHT, BALLED AND BURLAPPED	EACH	24	24
* C2011824	SHRUB, VIBURNUM DENTATUM MORTON (NORTHERN BURGUNDY ARROWWOOD VIBURNUM), 2' HEIGHT, BALLED AND BURLAPPED	EACH	90	90
* C2012424	SHRUB, VIBURNUM LENTAGO (NANNYBERRY VIBURNUM), 2' HEIGHT, BALLED AND BURLAPPED	EACH	60	60
* K0030460	PERENNIAL PLANTS, WETLAND GRASSED AND SEDGES	UNIT	11.52	11.52
X4022000	TEMPORARY ACCESS (COMMERCIAL ENTRANCE)	EACH	130	130
XX004853	TEMPORARY ACCESS (ALLEY)	EACH	1	1
X0021000	TEMPORARY ACCESS (ALLEY)	EACH	108	108



\* Specialty Items

Rev. 5-27-09

REVISIONS		ILLINOIS DEPARTMENT OF TRANSPORTATION ILLINOIS ROUTE 83 FROM THE WISCONSIN STATE LINE TO NORTH OF PETITE LAKE ROAD
NAME	DATE	
		SUMMARY OF QUANTITIES SHEET 8 OF 10
DATE: 1/30/09		DRAWN BY: GP CHECKED BY: MW
		GRAEF, ANHALT, SCHLOEMER & ASSOCIATES, INC. CHICAGO, ILLINOIS

F.A. ROUTE NO.	SECTION	COUNTY	TOTAL SHEETS	SHEET NO.
866	*	LAKE	554	13
FED. ROAD DIST. NO.		ILLINOIS	FED. AID PROJECT	
*(L-21W.R)16.6A & 6 EXT) WRS-1				

CODE NO.	PAY ITEM	UNIT	TOTAL QUANTITY	URBAN 100% FED.	Y031-1F	Y031-3D	Y031-1F	Y031-3D	Y031-1F	Y031-3D	Y031-1F	Y031-3D	Y031-1F
					ILL RTE 83 AND GRASS LAKE ROAD	ILL RTE 83 AND ILL ROUTE 173	ILL RTE 83 AND LAKE STREET	ILL RTE 83 AND ORCHARD STREET	ILL RTE 83 AND NORTH AVE	ILL RTE 83 INTERCONNECT			
* 87700280	STEEL MAST ARM ASSEMBLY AND POLE, 48 FT.	EACH	2	-	-	1	-	-	-	1	-	-	-
* 87700290	STEEL MAST ARM ASSEMBLY AND POLE, 50 FT.	EACH	1	-	-	1	-	-	-	-	-	-	-
* 87700310	STEEL MAST ARM ASSEMBLY AND POLE, 54 FT.	EACH	1	-	-	1	-	-	-	-	-	-	-
* 87800100	CONCRETE FOUNDATION, TYPE A	FOOT	60	24	-	16	-	8	-	12	-	-	-
* 87800150	CONCRETE FOUNDATION, TYPE C	FOOT	16	4	-	4	-	4	-	4	-	-	-
* 87800400	CONCRETE FOUNDATION, TYPE E, 30-INCH DIAMETER	FOOT	128	54	-	-	-	33.5	-	40.5	-	-	-
* 87800415	CONCRETE FOUNDATION, TYPE E, 36-INCH DIAMETER	FOOT	69	-	-	56	-	-	-	13	-	-	-
* 87900200	DRILL EXISTING HANDHOLE	EACH	21	-	-	-	-	-	18	-	-	-	3
* 88030020	SIGNAL HEAD, L E D, 1-FACE, 3-SECTION, MAST-ARM MOUNTED	EACH	22	4	-	4	-	4	-	6	-	4	-
* 88030050	SIGNAL HEAD, L E D, 1-FACE, 3-SECTION, BRACKET MOUNTED	EACH	4	1	-	-	-	2	-	1	-	-	-
* 88030100	SIGNAL HEAD, L E D, 1-FACE, 5-SECTION, BRACKET MOUNTED	EACH	11	2	-	4	-	1	-	-	-	4	-
* 88030110	SIGNAL HEAD, L E D, 1-FACE, 5-SECTION, MAST-ARM MOUNTED	EACH	18	5	-	4	-	1	-	4	-	4	-
* 88030210	SIGNAL HEAD, L E D, 2-FACE, 3-SECTION, BRACKET MOUNTED	EACH	1	-	-	-	-	1	-	-	-	-	-
* 88030240	SIGNAL HEAD, L E D, 2-FACE, 1-3 SECTION, 1-5 SECTION, BRACKET MOUNTED	EACH	7	3	-	-	-	-	4	-	-	-	-
* 88102710	PEDESTRIAN SIGNAL HEAD, L E D, 1-FACE, BRACKET MOUNTED	EACH	10	-	-	4	-	4	-	-	-	2	-
* 88102740	PEDESTRIAN SIGNAL HEAD, L E D, 2-FACE, BRACKET MOUNTED	EACH	5	-	-	-	-	1	-	4	-	-	-
* 88200210	TRAFFIC SIGNAL BACKPLATE, LOUVERED, ALUMINUM	EACH	40	9	-	8	-	5	-	10	-	8	-
* 88500100	INDUCTIVE LOOP DETECTOR	EACH	46	11	-	11	-	5	-	9	-	10	-
* 88600100	DETECTOR LOOP, TYPE I	FOOT	4515	1052	-	1351	-	326	-	792	-	994	-
* 88700200	LIGHT DETECTOR	EACH	8	-	-	2	-	2	-	-	-	2	-
* 88700300	LIGHT DETECTOR AMPLIFIER	EACH	4	-	-	1	-	1	-	-	-	1	-
* 88800100	PEDESTRIAN PUSH-BUTTON	EACH	11	-	-	4	-	5	-	-	-	2	-
* 89000100	TEMPORARY TRAFFIC SIGNAL INSTALLATION	EACH	4	1	-	1	-	1	-	-	-	1	-
* 89100400	ILLUMINATED SIGN, L E D	EACH	4	4	-	-	-	-	-	-	-	-	-
* 89502375	REMOVE EXISTING TRAFFIC SIGNAL EQUIPMENT	EACH	5	1	-	1	-	1	-	1	-	1	-
* 89502380	REMOVE EXISTING HANDHOLE	EACH	38	6	-	15	-	7	-	1	-	9	-
* 89502385	REMOVE EXISTING CONCRETE FOUNDATION	EACH	40	9	-	11	-	8	-	-	-	12	-
* X0322925	ELECTRIC CABLE IN CONDUIT, TRACER, NO. 14 1C	FOOT	6981	-	-	-	-	-	-	-	-	-	6981
* X0323319	POST MOUNTED FLASHING BEACON INSTALLATION (SPECIAL)	EACH	4	-	-	1	-	2	-	-	-	1	-
* X0325737	TEMPORARY TRAFFIC SIGNAL TIMING	EACH	4	1	-	1	-	1	-	1	-	1	-
* X8620020	UNINTERRUPTIBLE POWER SUPPLY	EACH	5	1	-	1	-	1	-	1	-	1	-
* X8050015	SERVICE INSTALLATION-POLE MOUNTED	EACH	4	1	-	1	-	1	-	-	-	1	-
* X8710020	FIBER OPTIC CABLE IN CONDUIT, NO. 62.5/125, MM12F SM12F	FOOT	7049	-	-	-	-	-	-	-	-	-	7049
* X8730027	ELECTRIC CABLE IN CONDUIT, GROUNDING, NO. 6 1C	FOOT	3071.5	920	-	690	-	576.5	-	353	-	532	-
* X8730250	ELECTRIC CABLE IN CONDUIT NO. 20 3/C, TWISTED, SHIELDED	FOOT	1434	-	-	313	-	354	-	479	-	288	-
* XX002264	ELECTRIC CABLE IN CONDUIT, RAILROAD, NO. 14 3C	FOOT	353	353	-	-	-	-	-	-	-	-	-

\*specialty items

Rev. 5-27-09

REVISIONS	
NAME	DATE

ILLINOIS DEPARTMENT OF TRANSPORTATION  
ILLINOIS ROUTE 83  
FROM THE WISCONSIN STATE LINE TO  
NORTH OF PETITE LAKE ROAD

**SUMMARY OF QUANTITIES**  
SHEET 10 OF 10

DATE: 1/30/09      DRAWN BY: GP  
CHECKED BY: MW

GRAEF, ANHALT, SCHLOEMER & ASSOCIATES, INC.  
CHICAGO, ILLINOIS

\* X0324007 OPTIMIZE TRAFFIC SIGNAL SYSTEM EACH 1

G:\20004024\_N\ms\pioneer1\sumquan0.dgn  
1/28/2009 10:52:21AM

F.A. ROUTE NO.	SECTION	COUNTY	TOTAL SHEETS	SHEET NO.
866	*	LAKE	554	101
FED. ROAD DIST. NO.		ILLINOIS FED. AID PROJECT		

\*(L-2[W,R];6,6A & 6 EXT) WRS-1

NOTES:

- TEMPORARY FENCING IS TO BE USED FOR SAFETY PURPOSES FOR THE AREAS SHOWN.
- INLET FILTERS AND INLET FILTER CLEANING WILL CONFORM TO THE APPLICABLE SPECIAL PROVISIONS.
- ALL SILT FENCING SHALL BE ERECTED AT ONE FOOT OFFSET FROM THE RIGHT-OF-WAY OR 5 FEET FROM THE TOE OF THE SIDE SLOPE AS SHOWN ON PLANS.
- ALL TEMPORARY FENCING IN WETLAND AREAS SHALL BE ERECTED WHERE SHOWN ON THE PLANS WITH SILT FENCING ERECTED DIRECTLY IN FRONT OF IT.
- THE CONTRACTOR SHALL INSTALL DEPARTMENT FURNISHED "NO INTRUSION AREA" SIGNS AT LOCATIONS SHOWN ON THE PLANS OR AS DIRECTED BY THE ENGINEER.
- ALL TEMPORARY FENCING IN NON-WETLAND AREAS SHALL BE ERECTED 10 FEET BEHIND THE SILT FENCE.
- TOPSOIL EXCAVATION WILL BE PAID FOR AS REMOVAL AND DISPOSAL OF UNSUITABLE MATERIAL AND MAY NOT BE USED AS EMBANKMENT MATERIAL.
- MAINTENANCE OF ALL EROSION CONTROL ITEMS WILL NOT BE PAID FOR SEPARATELY BUT INCLUDED IN THE COST OF THE VARIOUS ITEMS.
- DITCHES WITHIN 100 FEET OF WETLANDS SHALL BE CONSTRUCTED AND SEEDED PRIOR TO CONSTRUCTION OF THE BALANCE OF THE DITCHES. PLACEMENT OF PERMANENT SEED AND EROSION CONTROL BLANKET SHALL MEET THIS REQUIREMENT.
- THE CONTRACTOR SHALL HAVE ALL WORKING COMPONENTS FOR WATER TREATMENT UNITS ON-HAND AND SHALL INSTALL THEM AS SOON AS POSSIBLE.
- THE CONTRACTOR SHALL PROVIDE PROTECTION FROM GEESE AND OTHER FOWL FOR PERENNIAL PLANTS, WETLAND SEDGES AND GRASSES WITH A GOOSE EXCLOSURE. THE GOOSE EXCLOSURE WILL NOT BE MEASURED FOR PAYMENT, BUT CONSIDERED INCIDENTAL TO PERENNIAL PLANTS, WETLAND GRASSES AND SEDGES.

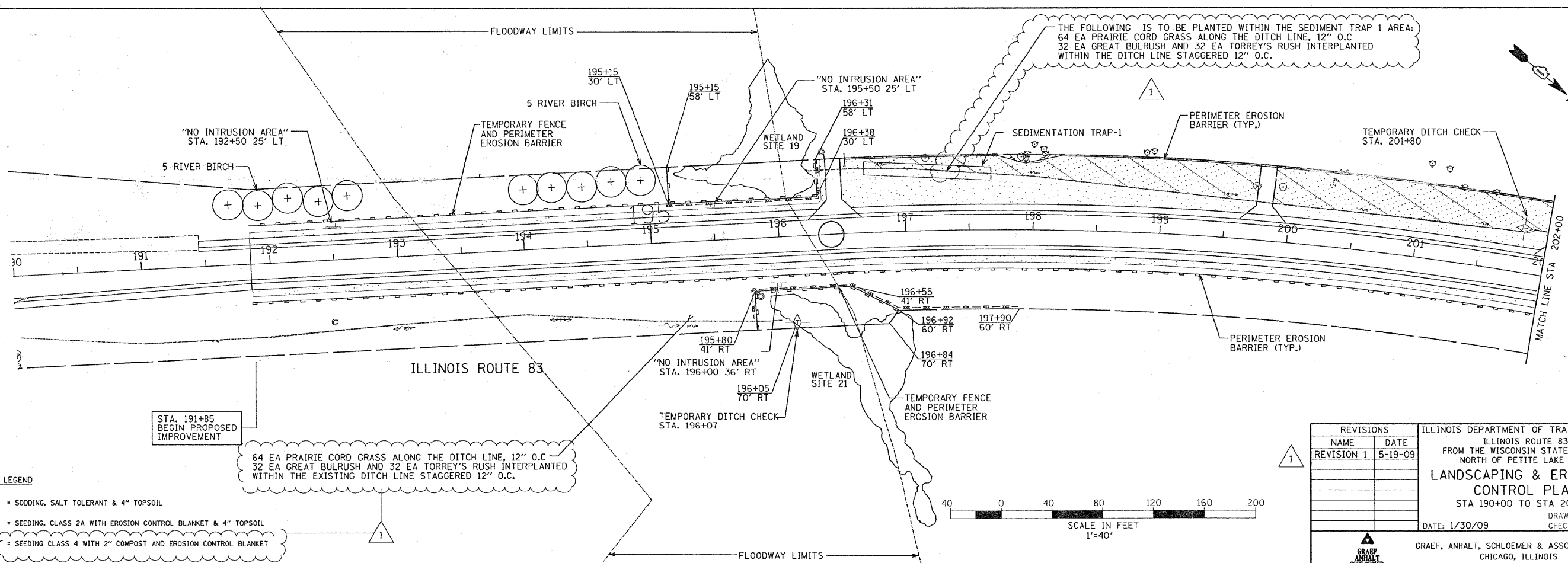

LANDSCAPING LEGEND

[Symbol]	= SODDING, SALT TOLERANT & 4" TOPSOIL
[Symbol]	= SEEDING, CLASS 2A WITH EROSION CONTROL BLANKET & 4" TOPSOIL
[Symbol]	= SEEDING CLASS 4 WITH 2" COMPOST AND EROSION CONTROL BLANKET

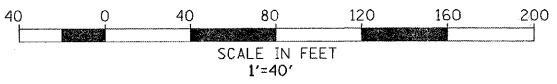

REVISIONS		ILLINOIS DEPARTMENT OF TRANSPORTATION ILLINOIS ROUTE 83 FROM THE WISCONSIN STATE LINE TO NORTH OF PETITE LAKE ROAD <b>LANDSCAPING &amp; EROSION CONTROL PLAN</b> STA 190+00 TO STA 202+00 DATE: 1/30/09 DRAWN BY: EUB CHECKED BY: MW GRAEF, ANHALT, SCHLOEMER & ASSOCIATES, INC. CHICAGO, ILLINOIS
NAME	DATE	
REVISION 1	5-19-09	

G:\2000\04024\N.ms\plan\sheet\er.con02.dgn 2/20/2009 10:06:05 AM

F.A. ROUTE NO.	SECTION	COUNTY	TOTAL SHEETS	SHEET NO.
866	*	LAKE	554	102
FED. ROAD DIST. NO.		ILLINOIS FED. AID PROJECT		
*(L-2(W,R);6,6A & 6 EXT) WRS-1				

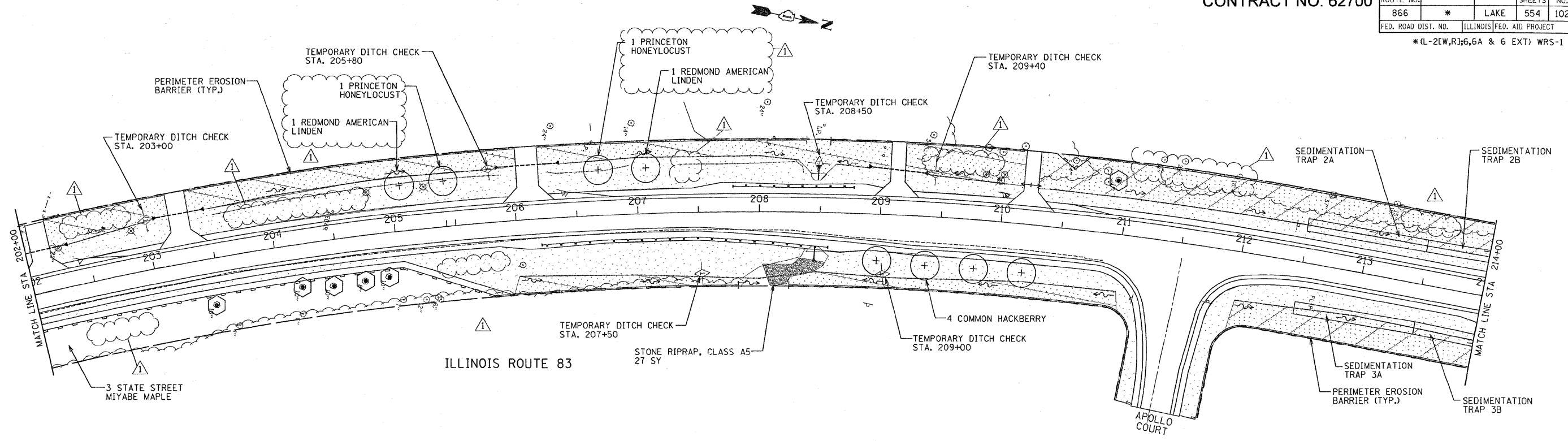

NOTE:  
REFER TO EROSION CONTROL, TREE MAINTENANCE SCHEDULES, & LEGEND SHEET

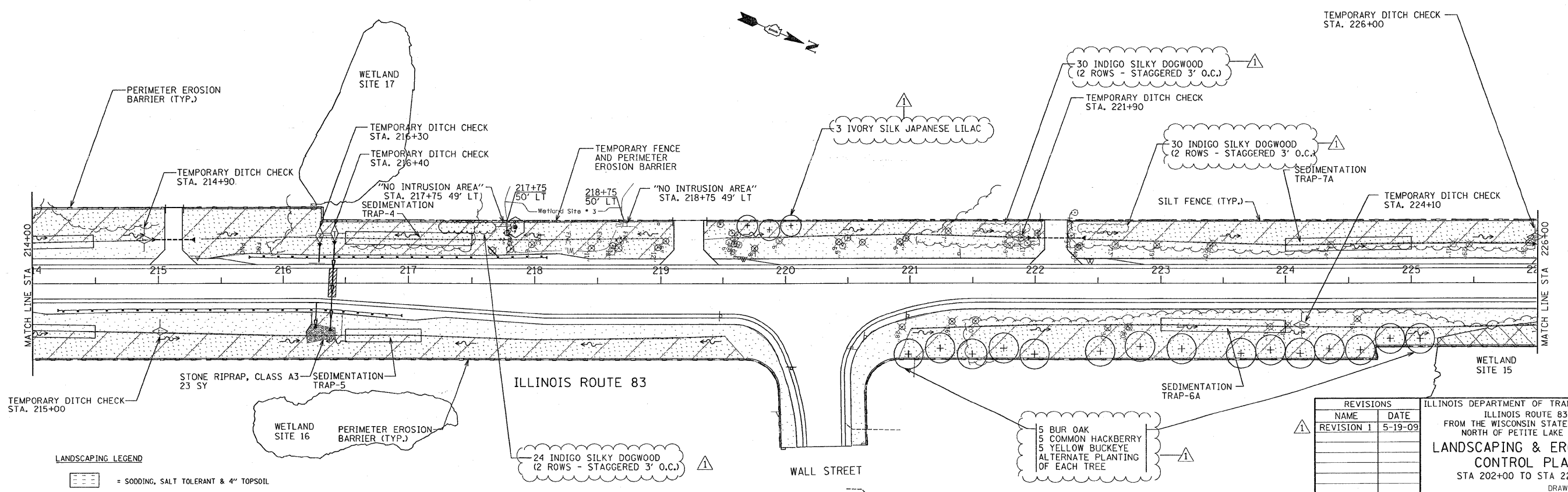

LANDSCAPING LEGEND

	= SODDING, SALT TOLERANT & 4" TOPSOIL
	= SEEDING, CLASS 2A WITH EROSION CONTROL BLANKET & 4" TOPSOIL
	= SEEDING CLASS 4 WITH 2" COMPOST AND EROSION CONTROL BLANKET

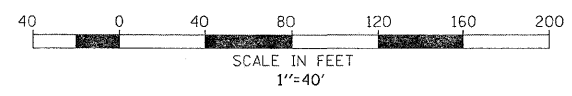

REVISIONS	
NAME	DATE
REVISION 1	5-19-09

ILLINOIS DEPARTMENT OF TRANSPORTATION  
ILLINOIS ROUTE 83  
FROM THE WISCONSIN STATE LINE TO  
NORTH OF PETITE LAKE ROAD  
**LANDSCAPING & EROSION CONTROL PLAN**  
STA 202+00 TO STA 226+00  
DRAWN BY: EUB  
CHECKED BY: MW  
DATE: 1/30/09  
GRAEF, ANHALT, SCHLOEMER & ASSOCIATES, INC.  
CHICAGO, ILLINOIS

G:\2000\04024\_N\mns\_dlg\ercon03.dgn 10:38:43 AM 7/20/2009

F.A. ROUTE NO.	SECTION	COUNTY	TOTAL SHEETS	SHEET NO.
866	*	LAKE	554	103
FED. ROAD DIST. NO.		ILLINOIS FED. AID PROJECT		

\*(L-2(W,R);6,6A & 6 EXT) WRS-1

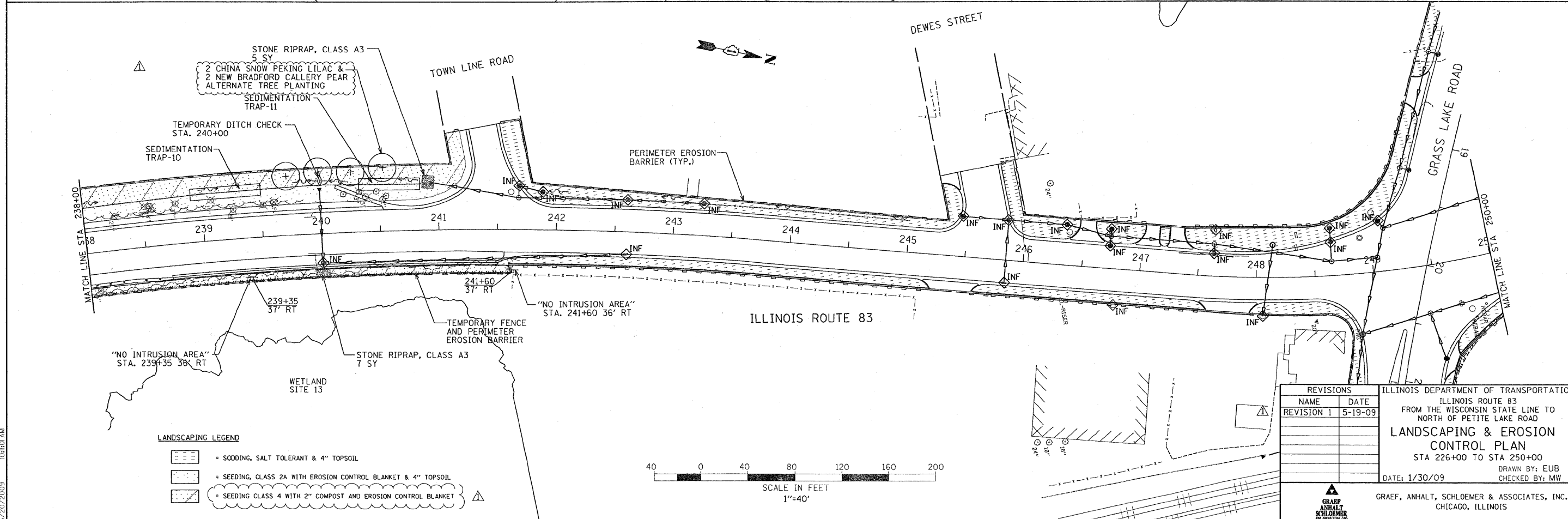
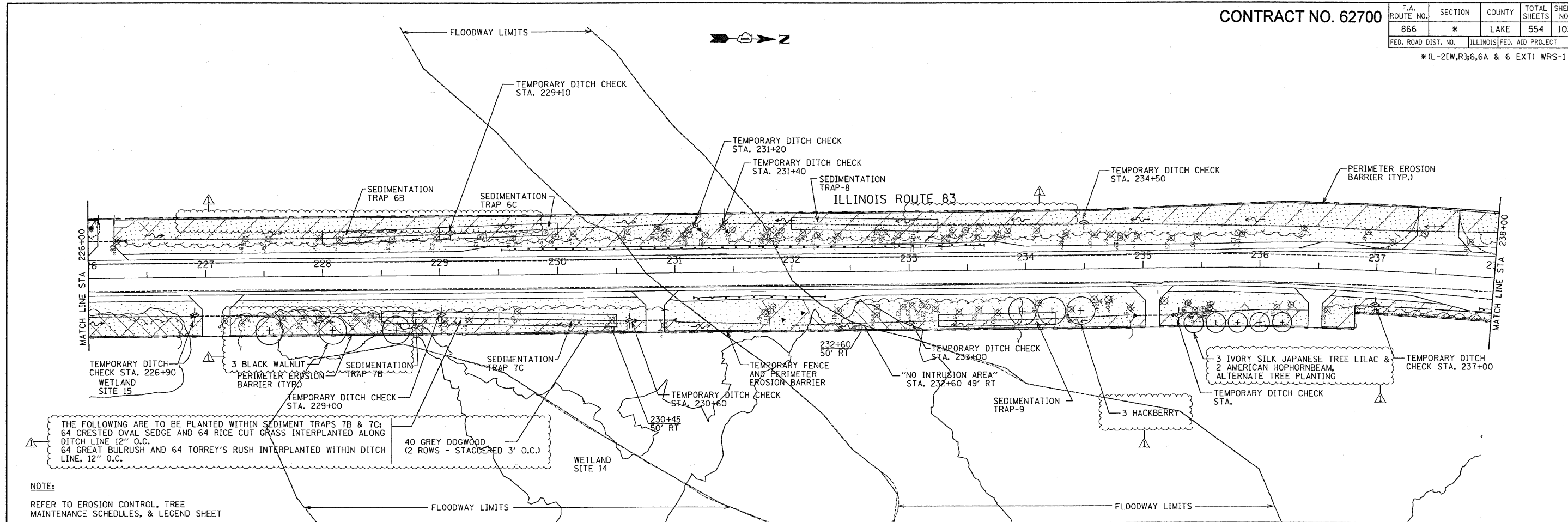

G:\20004024\N.ms\p\cnsae4\_ver.com04.dgn  
5/20/2009 10:00:11 AM

CONTRACT NO. 62700

F.A. ROUTE NO.	SECTION	COUNTY	TOTAL SHEETS	SHEET NO.
866	*	LAKE	554	104
FED. ROAD DIST. NO.	ILLINOIS	FED. AID PROJECT		
*(L-2[W,R],6,6A & 6 EXT) WRS-1				

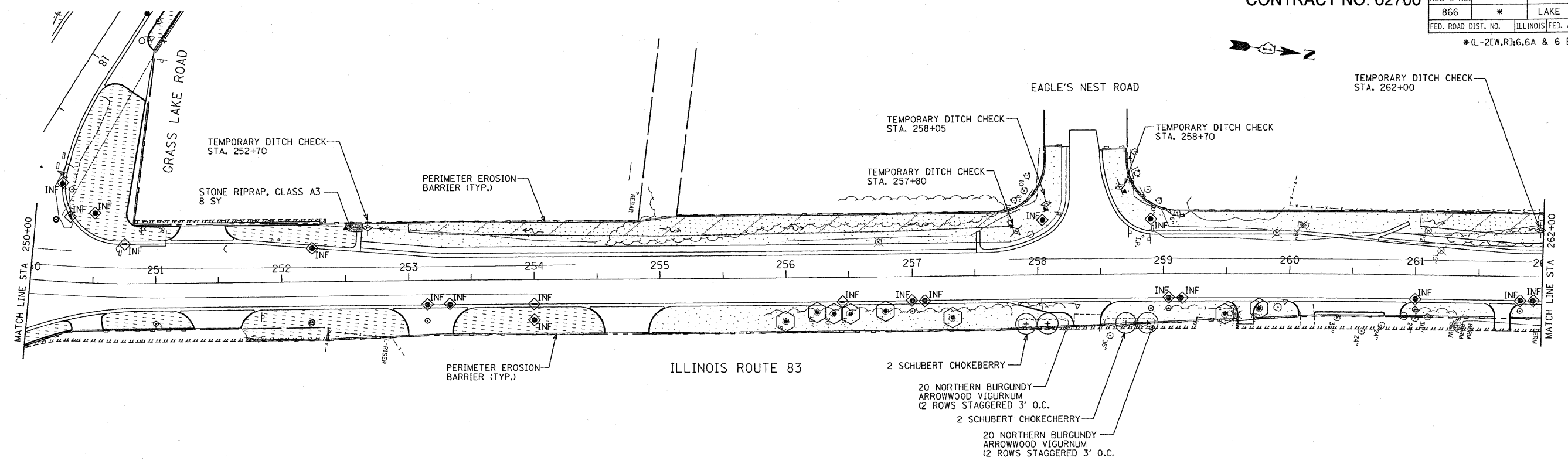

NOTE:  
REFER TO EROSION CONTROL, TREE MAINTENANCE SCHEDULES, & LEGEND SHEET

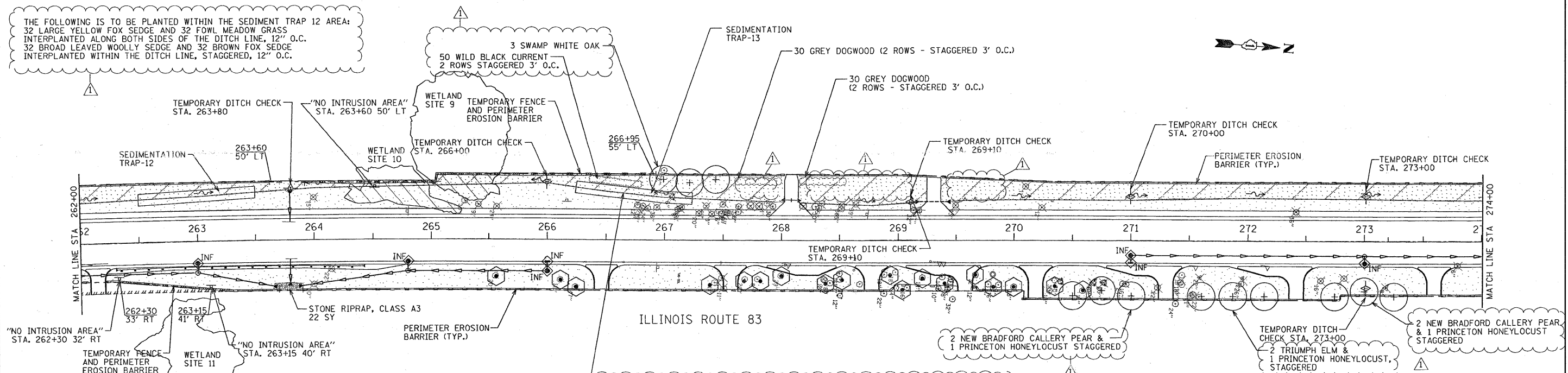

G:\2004\024\_N\ms\p\09091\er\con05.dgn 2/20/2009 10:45:35 AM

LANDSCAPING LEGEND

	= SODDING, SALT TOLERANT & 4" TOPSOIL
	= SEEDING, CLASS 2A WITH EROSION CONTROL BLANKET & 4" TOPSOIL
	= SEEDING CLASS 4 WITH 2" COMPOST AND EROSION CONTROL BLANKET

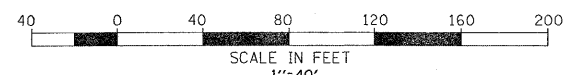

REVISIONS	
NAME	DATE
REVISION 1	5-19-09

ILLINOIS DEPARTMENT OF TRANSPORTATION  
ILLINOIS ROUTE 83  
FROM THE WISCONSIN STATE LINE TO  
NORTH OF PETITE LAKE ROAD  
**LANDSCAPING & EROSION CONTROL PLAN**  
STA 250+00 TO STA 274+00  
DATE: 1/30/09  
DRAWN BY: EUB  
CHECKED BY: MW  
GRAEF, ANHALT, SCHLOEMER & ASSOCIATES, INC.  
CHICAGO, ILLINOIS



F.A. ROUTE NO.	SECTION	COUNTY	TOTAL SHEETS	SHEET NO.
866	*	LAKE	554	105
FED. ROAD DIST. NO.	ILLINOIS FED. AID PROJECT			
*(L-2[W,R];6,6A & 6 EXT) WRS-1				

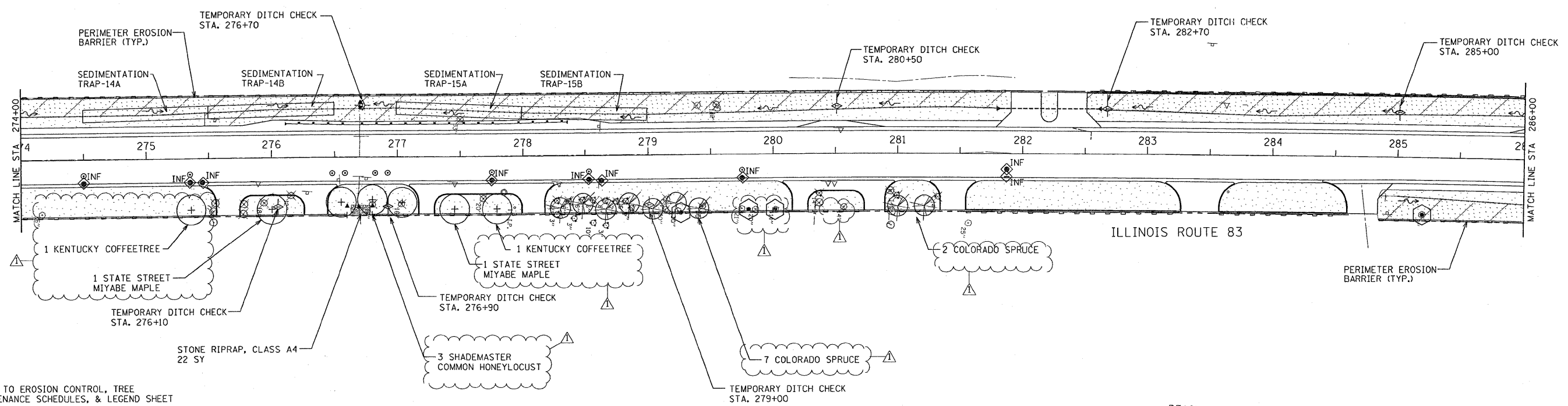
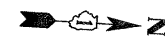

NOTE:  
REFER TO EROSION CONTROL, TREE MAINTENANCE SCHEDULES, & LEGEND SHEET

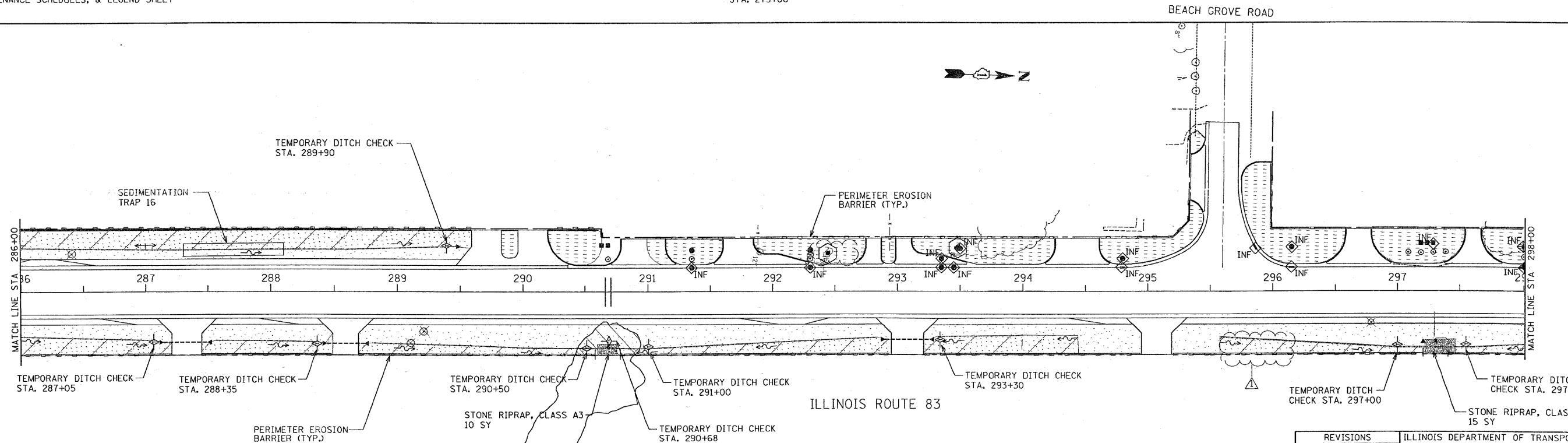

LANDSCAPING LEGEND

	= SODDING, SALT TOLERANT & 4" TOPSOIL
	= SEEDING, CLASS 2A WITH EROSION CONTROL BLANKET & 4" TOPSOIL
	= SEEDING CLASS 4 WITH 2" COMPOST AND EROSION CONTROL BLANKET

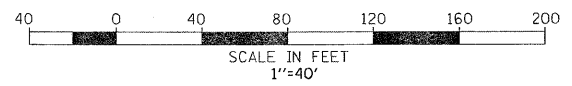

REVISIONS		ILLINOIS DEPARTMENT OF TRANSPORTATION ILLINOIS ROUTE 83 FROM THE WISCONSIN STATE LINE TO NORTH OF PETITE LAKE ROAD <b>LANDSCAPING &amp; EROSION CONTROL PLAN</b> STA 274+00 TO STA 298+00 DATE: 1/30/09
NAME	DATE	
REVISION 1	5-19-09	DRAWN BY: EUB CHECKED BY: MW

GRAEF, ANHALT, SCHLOEMER & ASSOCIATES, INC.  
CHICAGO, ILLINOIS

G:\2000\024\_N\ms\p\eriset\er\com06.dgn 2/20/2005 10:17:06 AM

F.A. ROUTE NO.	SECTION	COUNTY	TOTAL SHEETS	SHEET NO.
866	*	LAKE	554	106
FED. ROAD DIST. NO.		ILLINOIS FED. AID PROJECT		

\*(L-2[W,R];6,6A & 6 EXT) WRS-1

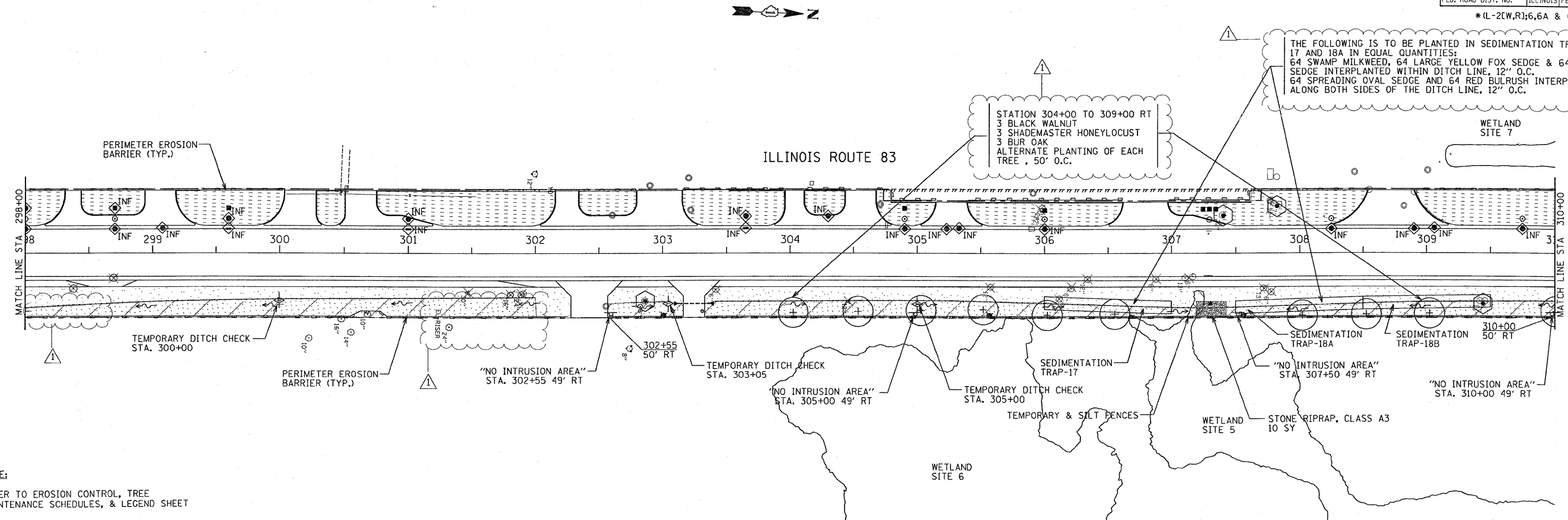

NOTE:  
REFER TO EROSION CONTROL, TREE MAINTENANCE SCHEDULES, & LEGEND SHEET

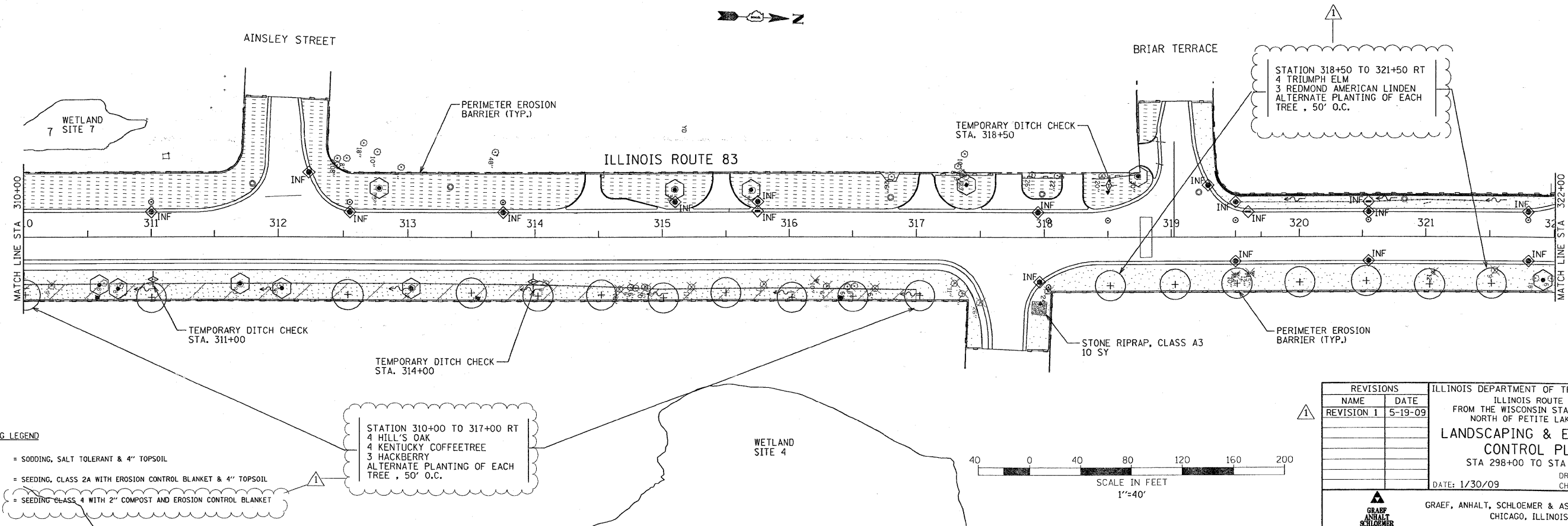

LANDSCAPING LEGEND

[Pattern]	= SODDING, SALT TOLERANT & 4" TOPSOIL
[Pattern]	= SEEDING, CLASS 2A WITH EROSION CONTROL BLANKET & 4" TOPSOIL
[Pattern]	= SEEDING CLASS 4 WITH 2" COMPOST AND EROSION CONTROL BLANKET

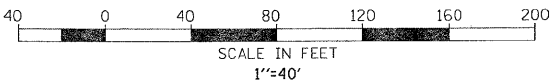

REVISIONS		ILLINOIS DEPARTMENT OF TRANSPORTATION ILLINOIS ROUTE 83 FROM THE WISCONSIN STATE LINE TO NORTH OF PETITE LAKE ROAD <b>LANDSCAPING &amp; EROSION CONTROL PLAN</b> STA 298+00 TO STA 322+00 DATE: 1/30/09 DRAWN BY: EUB CHECKED BY: MW GRAEF, ANHALT, SCHLOEMER & ASSOCIATES, INC. CHICAGO, ILLINOIS
NAME	DATE	
REVISION 1	5-19-09	

G:\20004024\Nms\p\p\sheet\er\con07.dgn 5/20/2009 10:55:54 AM

CONTRACT NO. 62700

F.A. ROUTE NO.	SECTION	COUNTY	TOTAL SHEETS	SHEET NO.
866	*	LAKE	554	107
FED. ROAD DIST. NO.	ILLINOIS	FED. AID PROJECT		
* (L-2[W,R];6,6A & 6 EXT) WRS-1				

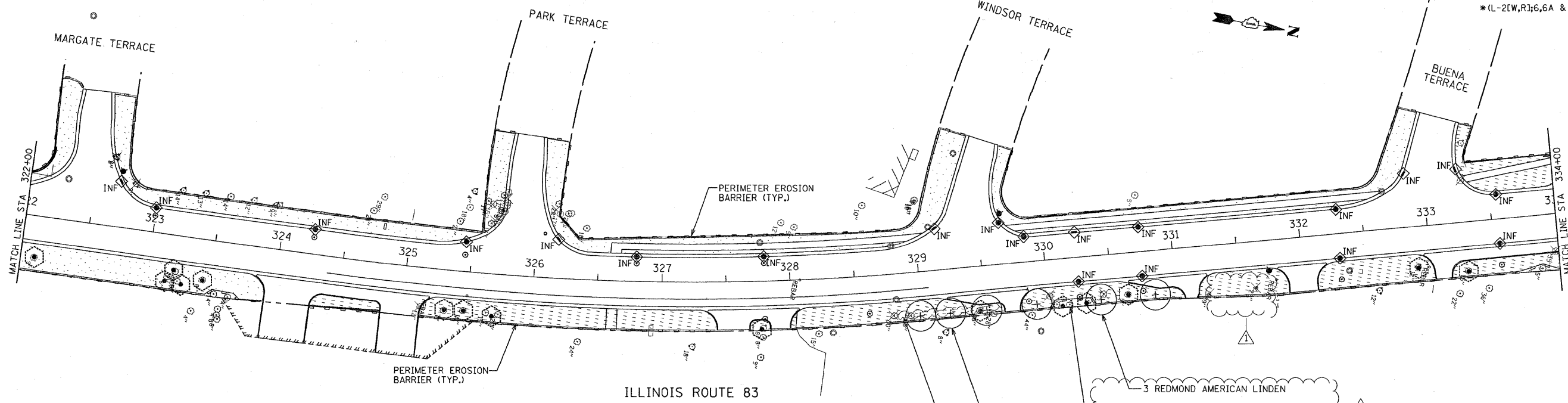

**LANDSCAPING LEGEND**

	= SODDING, SALT TOLERANT & 4" TOPSOIL
	= SEEDING, CLASS 2A WITH EROSION CONTROL BLANKET & 4" TOPSOIL
	= SEEDING CLASS 4 WITH 2" COMPOST AND EROSION CONTROL BLANKET

**NOTE:**  
REFER TO EROSION CONTROL, TREE MAINTENANCE SCHEDULES, & LEGEND SHEET

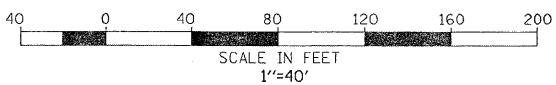
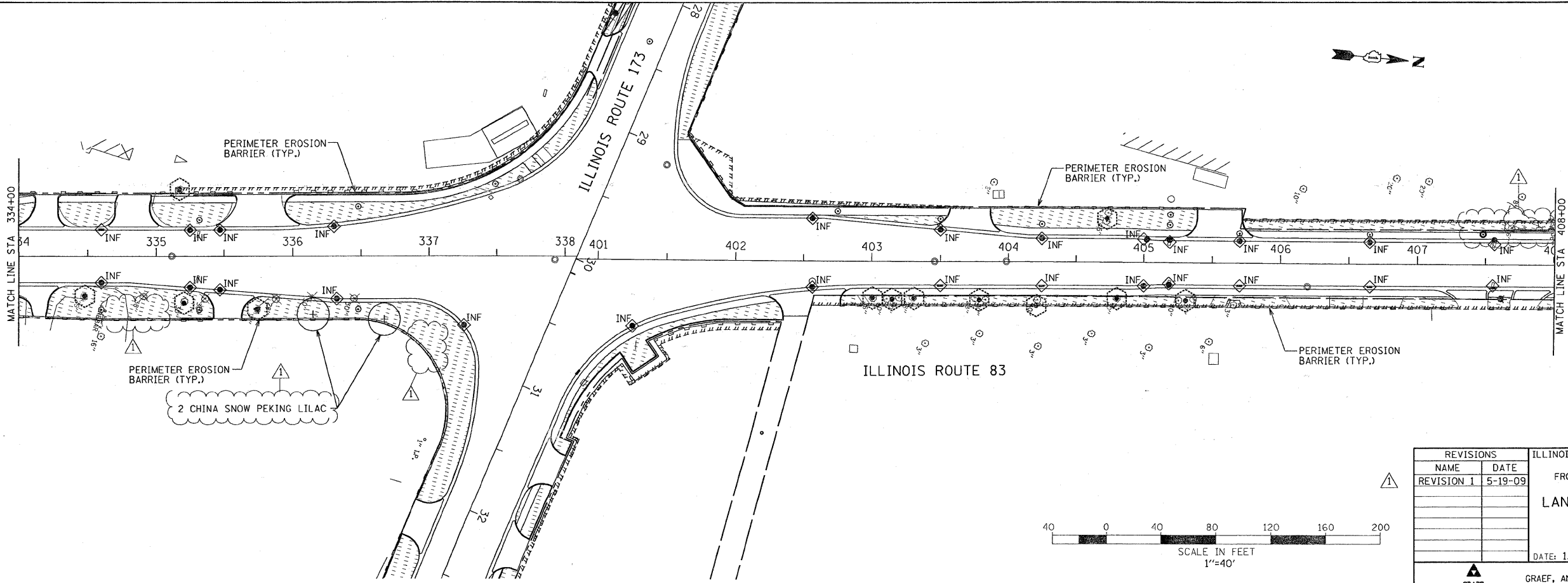

REVISIONS		ILLINOIS DEPARTMENT OF TRANSPORTATION ILLINOIS ROUTE 83 FROM THE WISCONSIN STATE LINE TO NORTH OF PETITE LAKE ROAD <b>LANDSCAPING &amp; EROSION CONTROL PLAN</b> STA 322+00 TO STA 408+00 DRAWN BY: EUB CHECKED BY: MW
NAME	DATE	
REVISION 1	5-19-09	DATE: 1/30/09

GRAEF, ANHALT, SCHLOEMER & ASSOCIATES, INC.  
CHICAGO, ILLINOIS

C:\2009\04024\_N\res\p\res\1\ver\con08.dgn  
 5/20/2009 10:28:35 AM

CONTRACT NO. 62700

F.A. ROUTE NO.	SECTION	COUNTY	TOTAL SHEETS	SHEET NO.
866	*	LAKE	554	110
FED. ROAD DIST. NO.		ILLINOIS FED. AID PROJECT		
*(L-2(W,R);6,6A & 6 EXT) WRS-1				

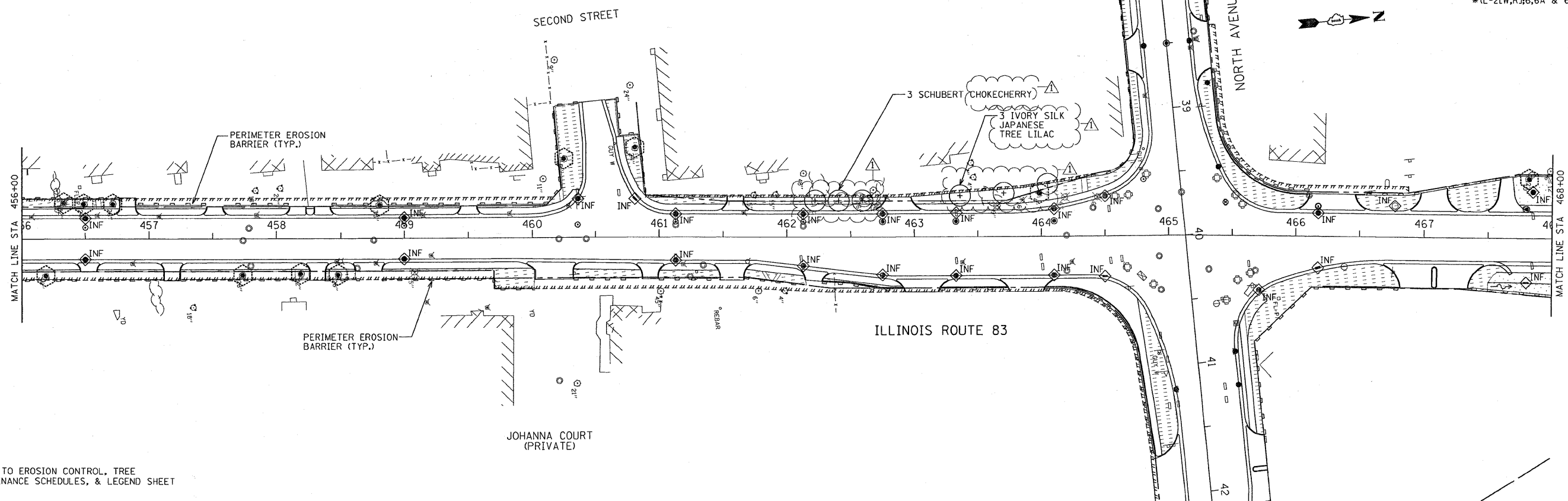

NOTE:  
REFER TO EROSION CONTROL, TREE MAINTENANCE SCHEDULES, & LEGEND SHEET

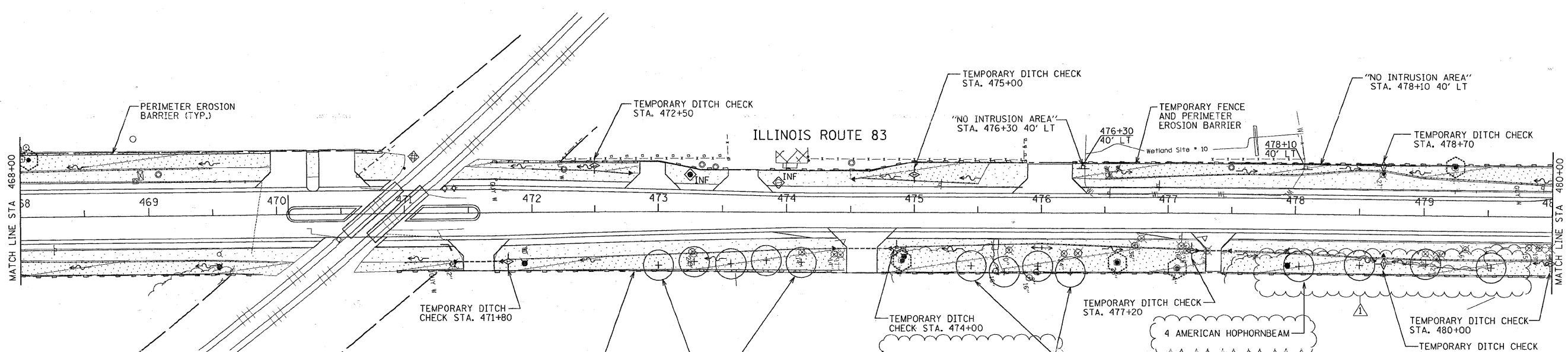

LANDSCAPING LEGEND

	= SODDING, SALT TOLERANT & 4" TOPSOIL
	= SEEDING, CLASS 2A WITH EROSION CONTROL BLANKET & 4" TOPSOIL
	= SEEDING CLASS 4 WITH 2" COMPOST AND EROSION CONTROL BLANKET

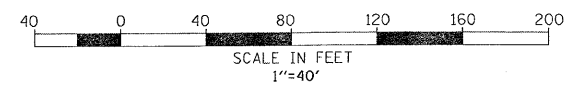

REVISIONS	
NAME	DATE
REVISION 1	5-19-09

ILLINOIS DEPARTMENT OF TRANSPORTATION  
ILLINOIS ROUTE 83  
FROM THE WISCONSIN STATE LINE TO  
NORTH OF PETITE LAKE ROAD  
**LANDSCAPING & EROSION CONTROL PLAN**  
STA 456+00 TO STA 480+00  
DRAWN BY: EUB  
CHECKED BY: MW  
DATE: 1/30/09

GRAEF, ANHALT, SCHLOEMER & ASSOCIATES, INC.  
CHICAGO, ILLINOIS

G:\2009\024\_M\ms\plans\erocntrl.dgn 10/24/09 AM

CONTRACT NO. 62700

F.A. ROUTE NO.	SECTION	COUNTY	TOTAL SHEETS	SHEET NO.
866	*	LAKE	554	111
FED. ROAD DIST. NO.	ILLINOIS FED. AID PROJECT			
*(L-2CW,R);6,6A & 6 EXT) WRS-1				

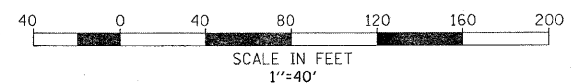
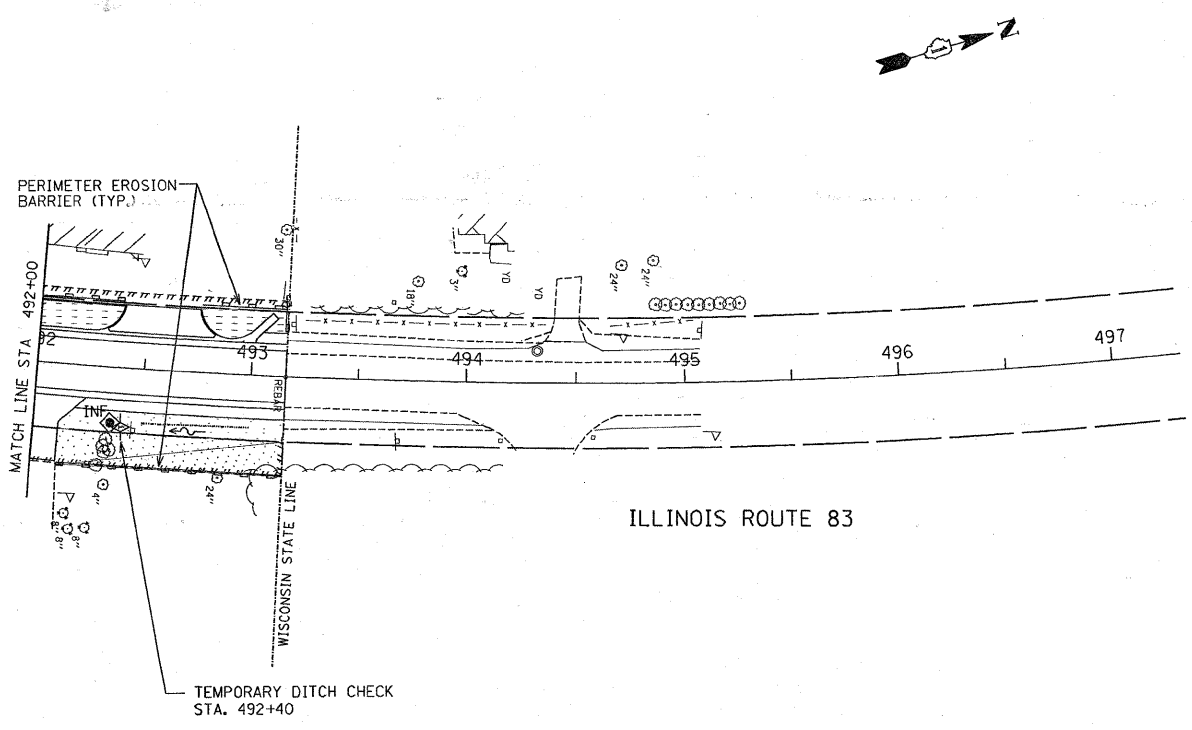
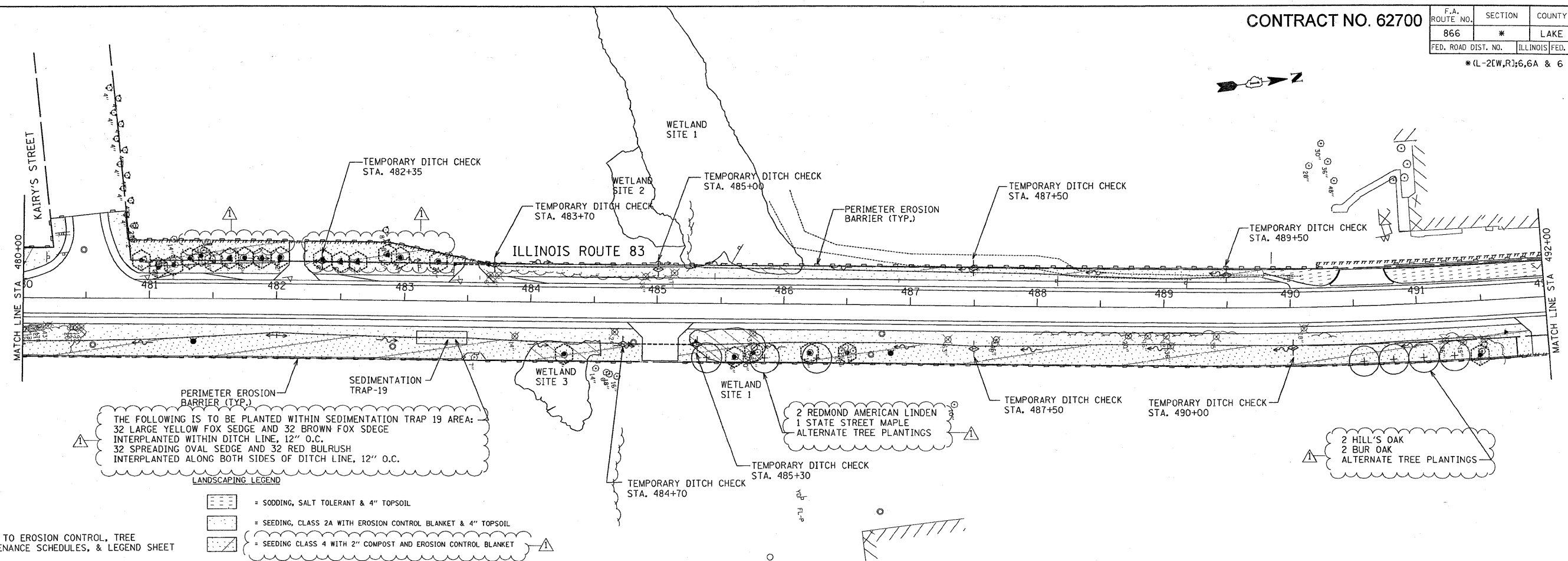

REVISIONS		ILLINOIS DEPARTMENT OF TRANSPORTATION ILLINOIS ROUTE 83 FROM THE WISCONSIN STATE LINE TO NORTH OF PETITE LAKE ROAD LANDSCAPING & EROSION CONTROL PLAN STA 480+00 TO STA 497+00 DRAWN BY: EUB CHECKED BY: MW
NAME	DATE	
REVISION 1	5-19-09	DATE: 01/30/09 GRAEF, ANHALT, SCHLOEMER & ASSOCIATES, INC. CHICAGO, ILLINOIS

G:\20004024\Nms\plan\set\_ver\con12.dgn  
 5/20/2009 10:44:50 AM