

CONTRACT NO. 62700

F.A. ROUTE NO.	SECTION	COUNTY	TOTAL SHEETS	SHEET NO.
866	*	LAKE	554	60
FED. ROAD DIST. NO.		ILLINOIS	FED. AID PROJECT	
*(L-2[W,R]:6,6A & 6 EXT) WRS-1				

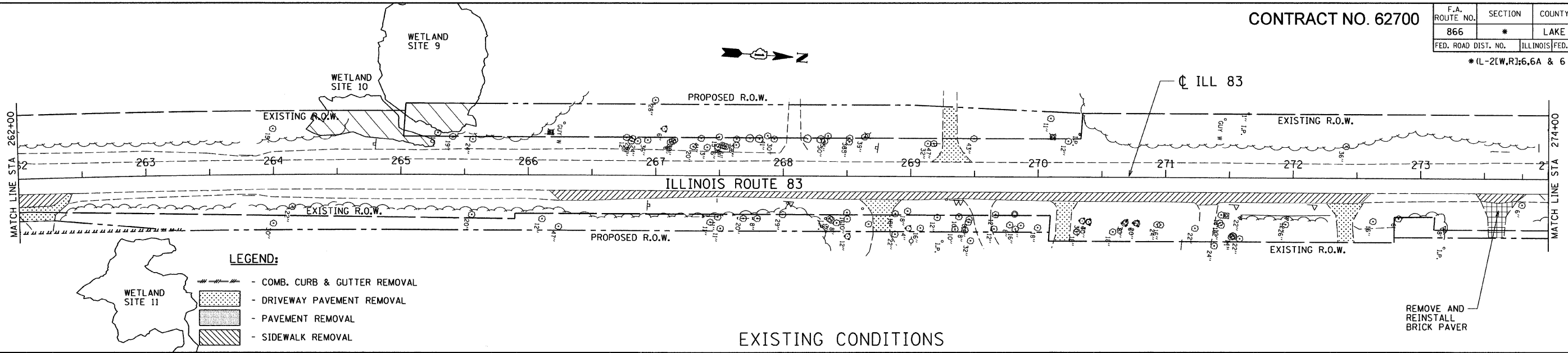

- LEGEND:**
- COMB. CURB & GUTTER REMOVAL
 - DRIVEWAY PAVEMENT REMOVAL
 - PAVEMENT REMOVAL
 - SIDEWALK REMOVAL
 - CLASS D PATCHES
 - PAVEMENT WIDENING
 - PAVED SHOULDER REMOVAL

EXISTING CONDITIONS

CURVE 1-6
 P.I. STA = 261+98.13
 $\Delta = 3^\circ 47' 23''$ (RT)
 $D = 0^\circ 35' 51''$
 $R = 9587.53$
 $T = 317.19$
 $L = 634.15$
 $E = 5.24$
 P.C. STA = 258+80.94
 P.T. STA = 265+15.09
 S.E. = N/A

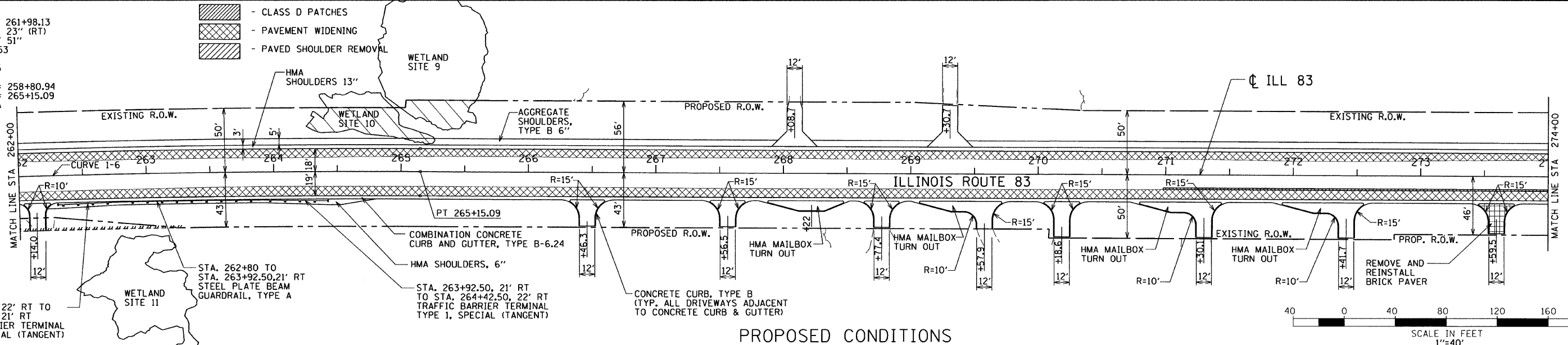

PROPOSED CONDITIONS

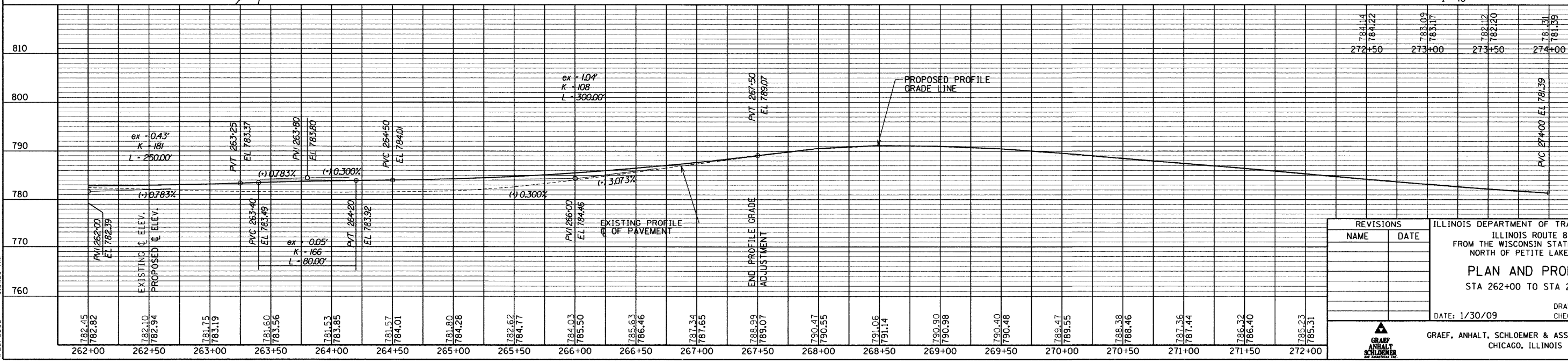
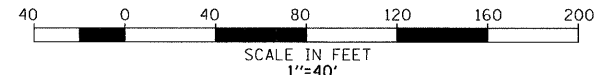

REVISIONS	
NAME	DATE

ILLINOIS DEPARTMENT OF TRANSPORTATION
 ILLINOIS ROUTE 83
 FROM THE WISCONSIN STATE LINE TO
 NORTH OF PETITE LAKE ROAD
PLAN AND PROFILE
 STA 262+00 TO STA 274+00

DATE: 1/30/09
 DRAWN BY: WS
 CHECKED BY: MW

GRAEF, ANHALT, SCHLOEMER & ASSOCIATES, INC.
 CHICAGO, ILLINOIS

G:\2000\0424.N\ms\plan\set\plan0.dgn 4/29/2009 9:51:53 AM