

CONTRACT NO. 62700

F.A. ROUTE NO.	SECTION	COUNTY	TOTAL SHEETS	SHEET NO.
866	*	LAKE	554	76
FED. ROAD DIST. NO.		ILLINOIS	FED. AID PROJECT	

\* (L-2[W,R];6.6A & 6 EXT) WRS-1

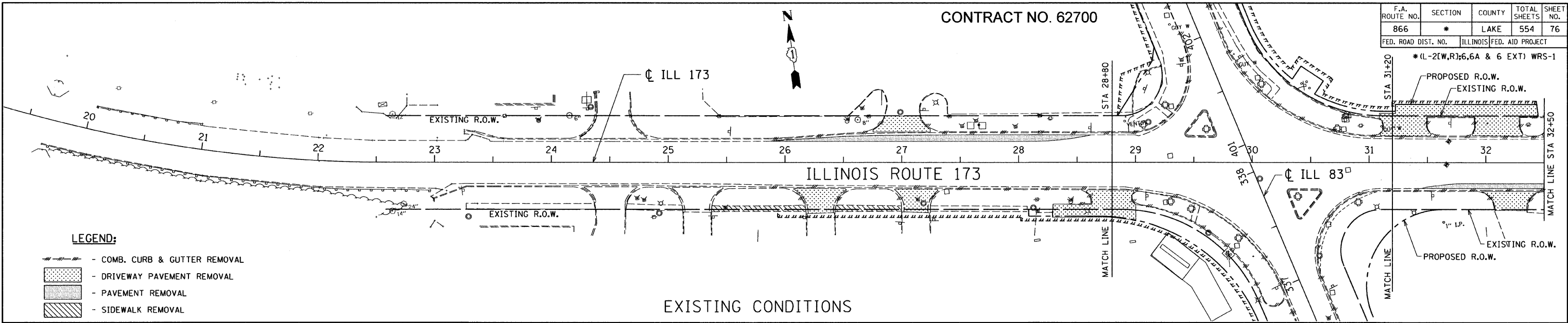

**LEGEND:**

- COMB. CURB & GUTTER REMOVAL
- DRIVEWAY PAVEMENT REMOVAL
- PAVEMENT REMOVAL
- SIDEWALK REMOVAL
- CLASS D PATCHES
- PAVEMENT WIDENING

EXISTING CONDITIONS

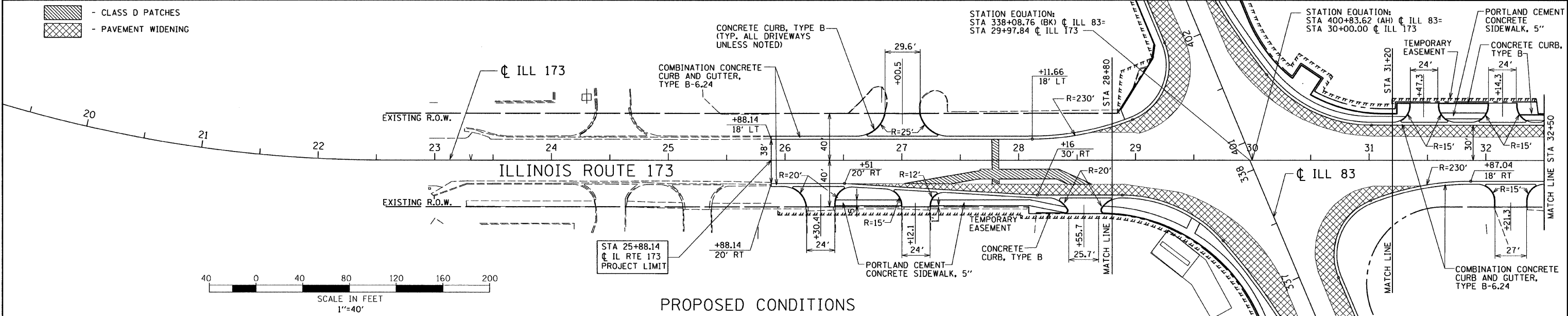

PROPOSED CONDITIONS

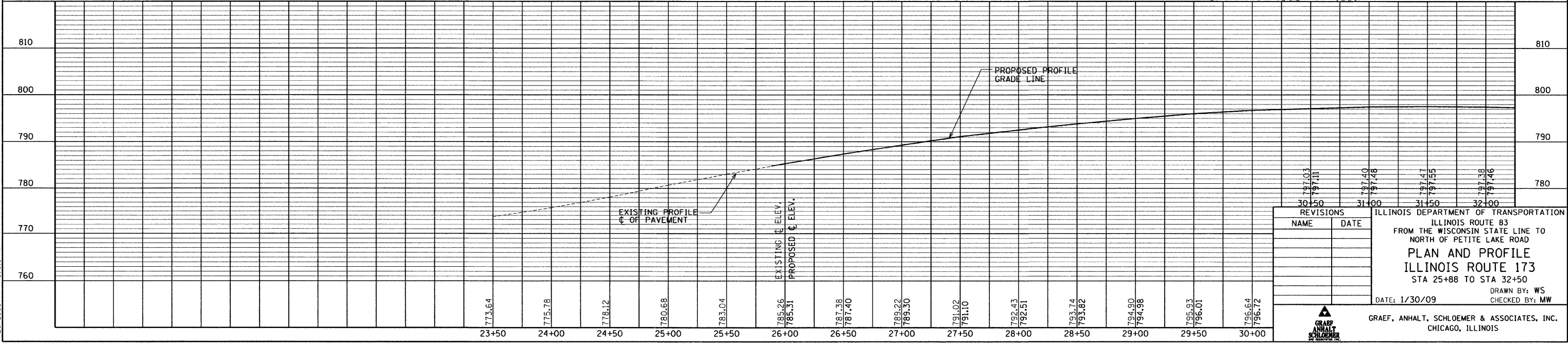

REVISIONS	
NAME	DATE

ILLINOIS DEPARTMENT OF TRANSPORTATION  
 ILLINOIS ROUTE 83  
 FROM THE WISCONSIN STATE LINE TO  
 NORTH OF PETITE LAKE ROAD  
**PLAN AND PROFILE**  
 ILLINOIS ROUTE 173  
 STA 25+88 TO STA 32+50  
 DATE: 1/30/09  
 DRAWN BY: WS  
 CHECKED BY: MW

GRAEF, ANHALT, SCHLOEMER & ASSOCIATES, INC.  
 CHICAGO, ILLINOIS

G:\20004024\_N\ms\plan\plan21.dgn  
 4/29/2009 10:30:01 AM