

CONTRACT NO. 62700

F.A. ROUTE NO.	SECTION	COUNTY	TOTAL SHEETS	SHEET NO.
866	*	LAKE	554	77
FED. ROAD DIST. NO.	ILLINOIS	FED. AID PROJECT		

*(L-2(W,R);6.6A & 6 EXT) WRS-1

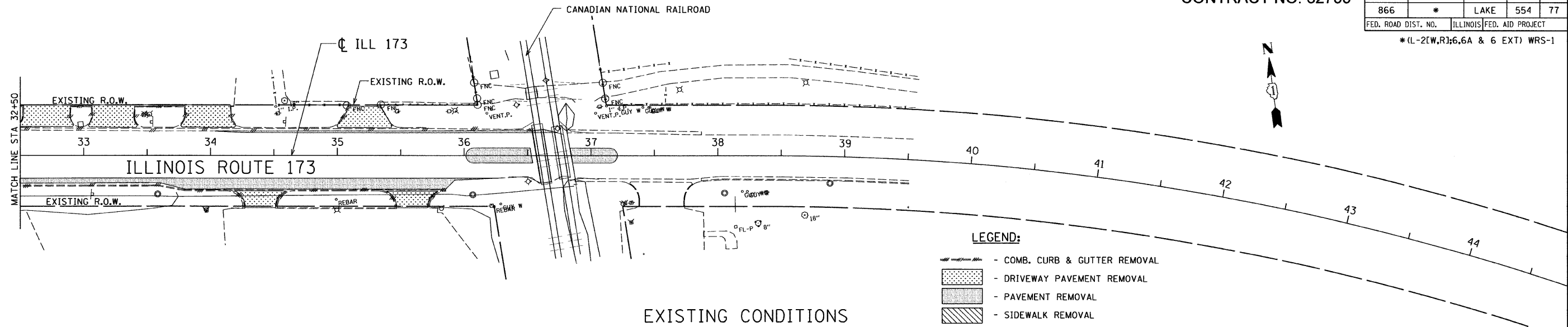

- LEGEND:**
- COMB. CURB & GUTTER REMOVAL
 - DRIVEWAY PAVEMENT REMOVAL
 - PAVEMENT REMOVAL
 - SIDEWALK REMOVAL
 - CLASS D PATCHES
 - PAVEMENT WIDENING

PROVIDE M4 CURB ON THE DEPARTURE SIDE OF THE RAILROAD CROSSING FOR A MAXIMUM LENGTH OF 75 FEET FOR BOTH COMBINATION CONCRETE CURB & GUTTER, TYPE B-6.12 AND B-6.24. THE WORK WILL BE PAID AS CCC&G TYPE B-6.12 AND B-6.24 RESPECTIVELY.

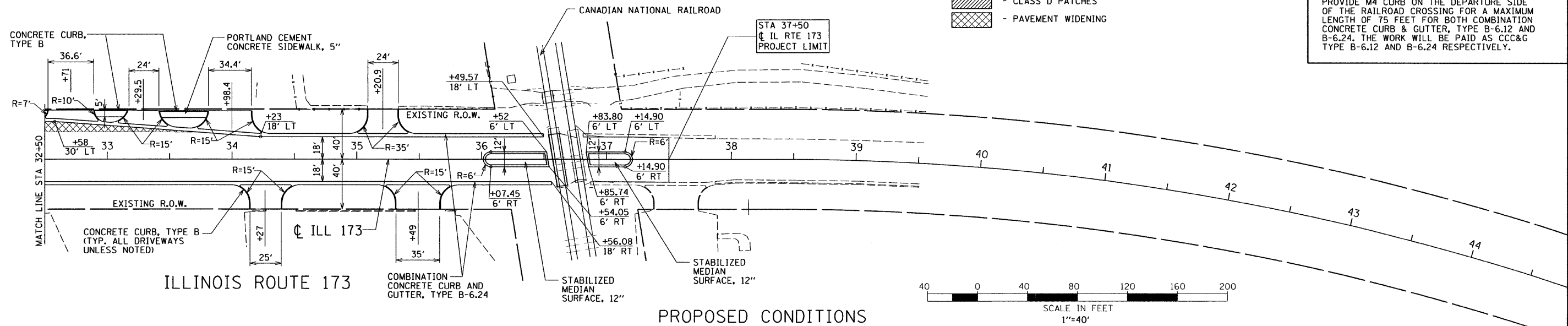

PROPOSED CONDITIONS

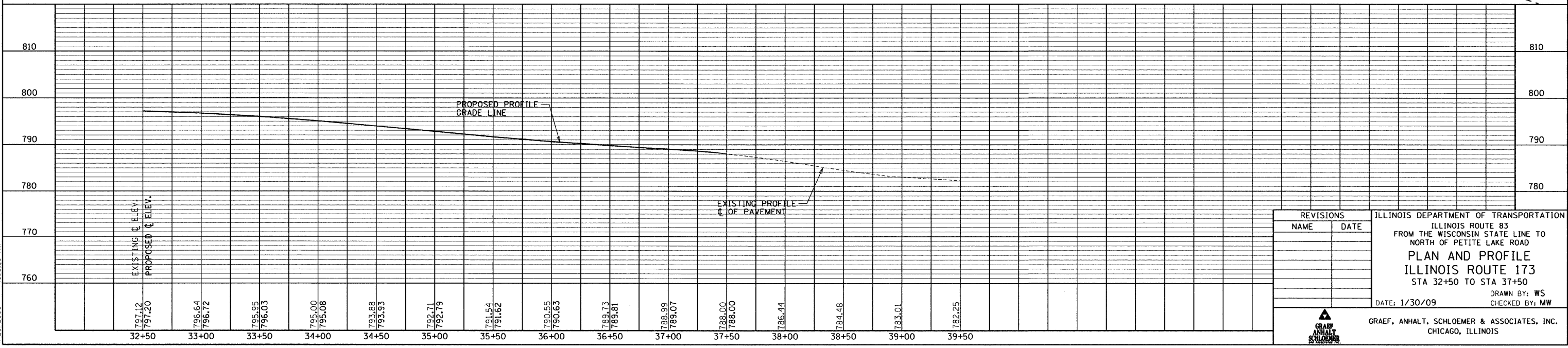
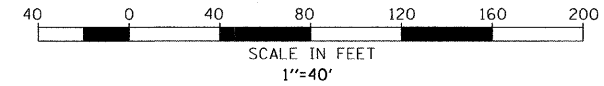

REVISIONS	
NAME	DATE

ILLINOIS DEPARTMENT OF TRANSPORTATION
 ILLINOIS ROUTE 83
 FROM THE WISCONSIN STATE LINE TO
 NORTH OF PETITE LAKE ROAD
PLAN AND PROFILE
 ILLINOIS ROUTE 173
 STA 32+50 TO STA 37+50
 DATE: 1/30/09
 DRAWN BY: WS
 CHECKED BY: MW

GRAEF, ANHALT, SCHLOEMER & ASSOCIATES, INC.
 CHICAGO, ILLINOIS

G:\20040424.N\ms\plan\set\plan28.dgn
 4/29/2009 10:13:35 AM