

B.M. 29 = " " on top of Concrete Headwall at Southwest corner Route 83 and Town Line Rd. Sta. 241+29.71, 33.14 Lt., Elev. 781.89

CONTRACT NO. 62700

ROUTE NO.	SECTION	COUNTY	TOTAL SHEETS	SHEET NO.	SHEET NO. 1 OF
F.A.P. 866	*	LAKE	554	306	7 SHEETS
FED. ROAD DIST. NO. 7	ILLINOIS	FED. AID PROJECT			

\* (L-2[W,R];6,6A & 6 EXT) WRS-1

**GENERAL NOTES**

Reinforcement bars shall conform to the requirements of ASTM A 706 Gr 60 (IL Modified). See Special Provisions.  
For Total Bill of Material see Sheet 5 of 7.

**DESIGN SPECIFICATIONS**

1996 AASHTO w/1997, 1998, 1999, 2000 & 2002 Interims.

**DESIGN STRESSES**

**FIELD UNITS**

$f'_c = 3,500$  psi  
 $f_y = 60,000$  psi (Reinf.)  
 $f_y = 38,500$  psi (Sheet Piling)

**LEGEND**

⊕ - Soil Boring  
RW-1

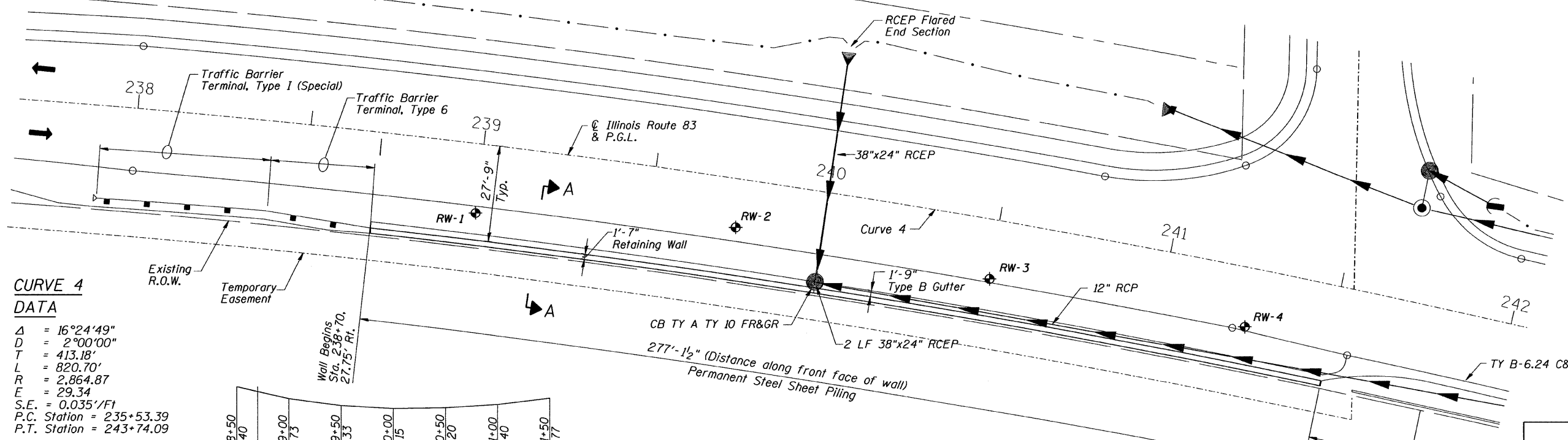
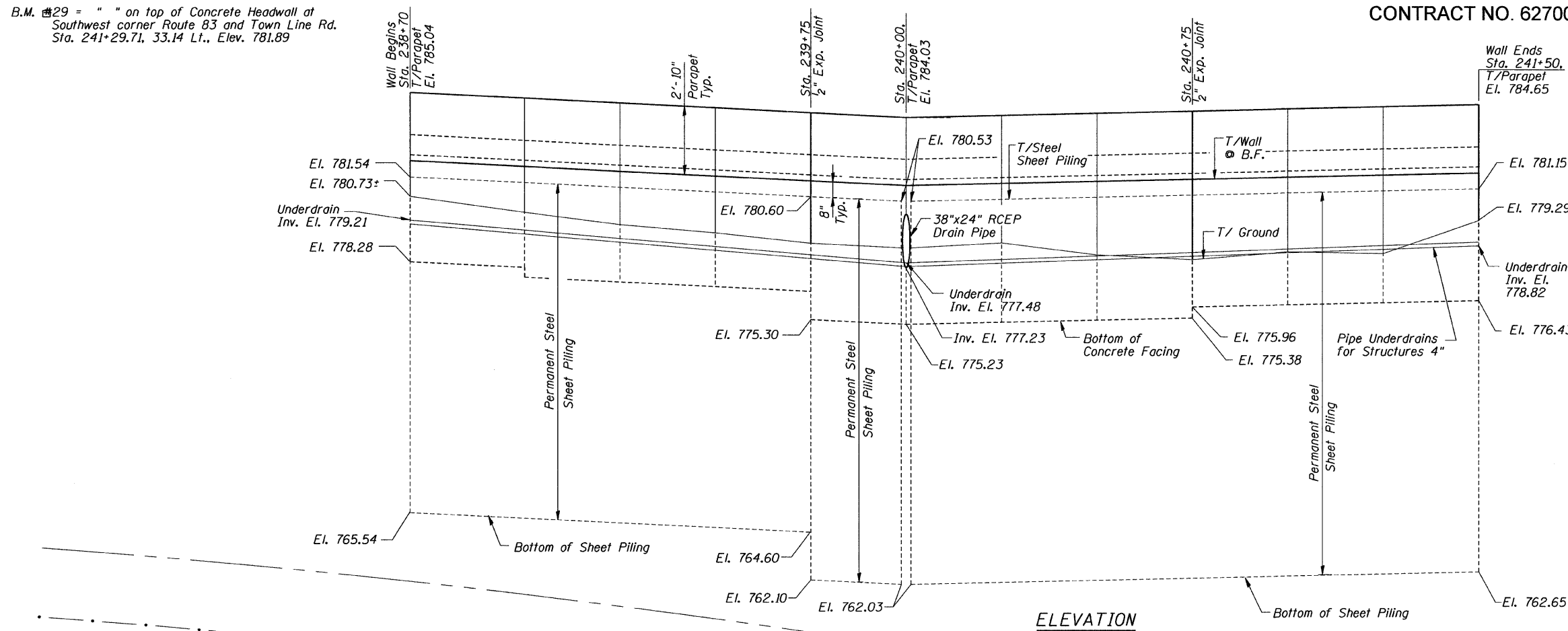

**CURVE 4 DATA**

$\Delta$	= 16°24'49"
$D$	= 2°00'00"
$T$	= 413.18'
$L$	= 820.70'
$R$	= 2,864.87'
$E$	= 29.34'
S.E.	= 0.035'/ft
P.C. Station	= 235+53.39
P.T. Station	= 243+74.09

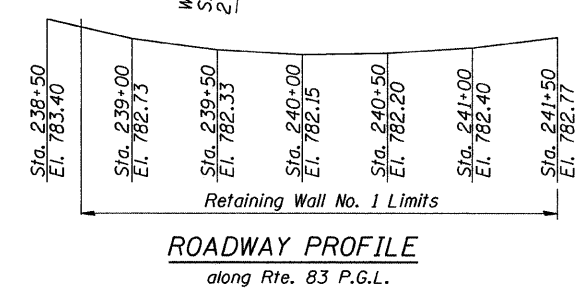

**RETAINING WALL NO. 1  
PLAN & ELEVATION**  
ILLINOIS ROUTE 83  
F.A.P. ROUTE 866  
LAKE COUNTY  
Sta. 238+70 to Sta. 241+50  
DATE: 4/22/09  
GRAEF, ANHALT, SCHLOEMER & ASSOCIATES INC  
CHICAGO ILLINOIS