

PROFILE SURVEYED BY DATE  
 CHECKED BY  
 NOTE BOOK NO. NOTED BY  
 STRUCTURE NOTATIONS CHFD

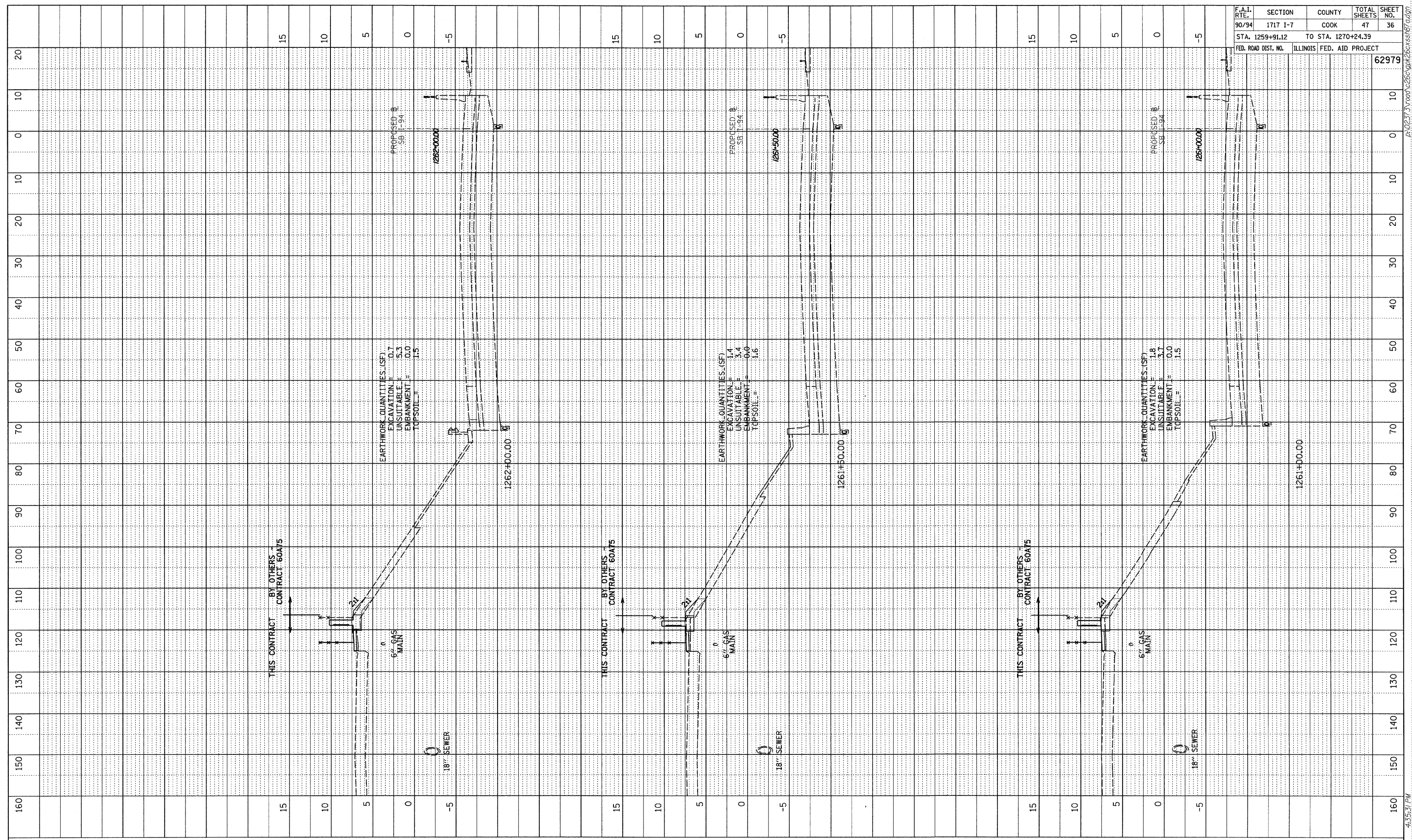

F.A.I. RTE.	SECTION	COUNTY	TOTAL SHEETS	SHEET NO.
90/94	1717 I-7	COOK	47	36
STA. 1259+91.12		TO STA. 1270+24.39		
FED. ROAD DIST. NO.	ILLINOIS FED. AID PROJECT		62979	

TYLIN INTERNATIONAL

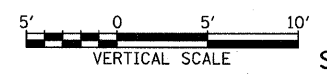
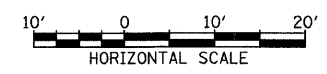

SB I-94 (DAN RYAN EXPRESSWAY)  
 STA. 1261+00.00 TO STA. 1262+00.00

10/16/2008 4:35:31 PM P:\02313\road\c26\gpk26\ss\h7.rdw