

**CURVE EKWELLO1**  
P.I. STA= 9+04.39  
N= 1,861,874.35  
E= 1,176,076.45  
Δ= 10° 52' 16"  
D= 5° 40' 05"  
R= 1,010.83'  
T= 96.18'  
L= 191.79'  
E= 4.56'  
e= N/A  
T.R.= N/A  
S.E. RUN= N/A  
P.C. STA= 8+08.21  
N= 1,861,778.19  
E= 1,176,078.94  
P.T. STA= 10+00.00  
N= 1,861,968.30  
E= 1,176,055.87

**CURVE EKWELLO2**  
P.I. STA= 10+99.36  
N= 1,862,065.35  
E= 1,176,034.61  
Δ= 23° 41' 58"  
D= 21° 47' 07"  
R= 263.00'  
T= 55.18'  
L= 108.78'  
E= 4.56'  
e= N/A  
T.R.= N/A  
S.E. RUN= N/A  
P.C. STA= 10+44.17  
N= 1,862,011.45  
E= 1,176,002.13  
P.T. STA= 11+52.96  
N= 1,862,109.97  
E= 1,176,002.13

**CURVE EKWELLO3**  
P.I. STA= 12+18.75  
N= 1,862,163.15  
E= 1,175,963.41  
Δ= 2° 58' 46"  
D= 2° 15' 54"  
R= 2,529.60'  
T= 65.78'  
L= 131.54'  
E= 0.85'  
e= N/A  
T.R.= N/A  
S.E. RUN= N/A  
P.C. STA= 11+52.96  
N= 1,862,109.97  
E= 1,176,002.13  
P.T. STA= 12+84.51  
N= 1,862,218.28  
E= 1,175,927.50

**CURVE EKWELLO4**  
P.I. STA= 13+72.28  
N= 1,862,291.83  
E= 1,175,879.60  
Δ= 5° 48' 38"  
D= 3° 18' 45"  
R= 1,729.58'  
T= 87.77'  
L= 175.40'  
E= 2.22'  
e= N/A  
T.R.= N/A  
S.E. RUN= N/A  
P.C. STA= 12+84.51  
N= 1,862,218.28  
E= 1,175,927.50  
P.T. STA= 14+59.61  
N= 1,862,369.86  
E= 1,175,839.39

**CURVE EKWELLO5**  
P.I. STA= 19+10.50  
N= 1,862,770.39  
E= 1,175,632.97  
Δ= 12° 45' 31"  
D= 6° 11' 38"  
R= 925.00'  
T= 103.41'  
L= 205.97'  
E= 5.76'  
e= N/A  
T.R.= N/A  
S.E. RUN= N/A  
P.C. STA= 18+07.09  
N= 1,862,678.46  
E= 1,175,680.34  
P.T. STA= 20+13.07  
N= 1,862,870.51  
E= 1,175,607.06

**CURVE EKWELLO6**  
P.I. STA= 21+01.89  
N= 1,862,957.45  
E= 1,175,589.82  
Δ= 5° 16' 59"  
D= 6° 48' 23"  
R= 841.78'  
T= 38.83'  
L= 77.62'  
E= 0.89'  
e= N/A  
T.R.= N/A  
S.E. RUN= N/A  
P.C. STA= 20+63.05  
N= 1,862,918.90  
E= 1,175,594.54  
P.T. STA= 21+40.67  
N= 1,862,996.27  
E= 1,175,588.66

**BENCH MARK NO. 3528 ELEV. 16.20**  
DESCRIPTION:  
CROSS CUT ON NORTHWESTERLY BOLT OF FIRE HYDRANT AT THE NORTHWEST CORNER OF 45TH ST AND WENTWORTH AVE

**BENCH MARK NO. 3530 ELEV. 18.18**  
DESCRIPTION:  
CROSS CUT ON SOUTHEAST BOLT OF LIGHT POLE BASE AT THE NORTHWEST CORNER OF 51ST ST AND WELLS ST

**BENCH MARK NO. 3531 ELEV. 17.55**  
DESCRIPTION:  
CROSS CUT ON NORTHEASTERLY FLANGE BOLT OF FIRE HYDRANT AT THE NORTHEAST CORNER OF GARFIELD BLVD AND WELLS ST

**BENCH MARK NO. 3532 ELEV. 18.84**  
DESCRIPTION:  
HORIZONTAL BOLT ON CTA "EL" STRUCTURE, EAST SIDE OF WELLS ST ABOUT 50 FEET NORTH OF 59TH PL.

**BENCH MARK NO. 3533 ELEV. 19.71**  
DESCRIPTION:  
BRASS DISK (CTA MONUMENT) AT THE SOUTHWEST CORNER OF 63RD ST AND HARVARD ST

**BENCH MARK NO. 3535 ELEV. 19.31**  
DESCRIPTION:  
FOUND CROSS CUT ON SOUTHERLY FLANGE BOLT OF FIRE HYDRANT AT THE NORTHEAST CORNER OF 59TH ST AND WENTWORTH AVE

**BENCH MARK NO. 3536 ELEV. 18.37**  
DESCRIPTION:  
CROSS CUT ON SOUTHEASTERLY FLANGE BOLT OF FIRE HYDRANT AT THE SOUTHEAST CORNER OF GARFIELD BLVD AND WENTWORTH AVE

**BENCH MARK NO. 3537 ELEV. 17.71**  
DESCRIPTION:  
CROSS CUT ON NORTHEASTERLY FLANGE BOLT OF FIRE HYDRANT AT THE NORTHEAST CORNER OF 51ST ST AND WENTWORTH AVE

**BENCH MARK NO. 3538 ELEV. 17.31**  
DESCRIPTION:  
CROSS CUT ON EASTERLY FLANGE BOLT OF FIRE HYDRANT AT THE NORTHEAST CORNER OF 47TH ST AND LASALLE ST

**NOTES:**  
1. AVERAGE GRID TO GROUND CONVERSION FACTOR = 1.000010988654360

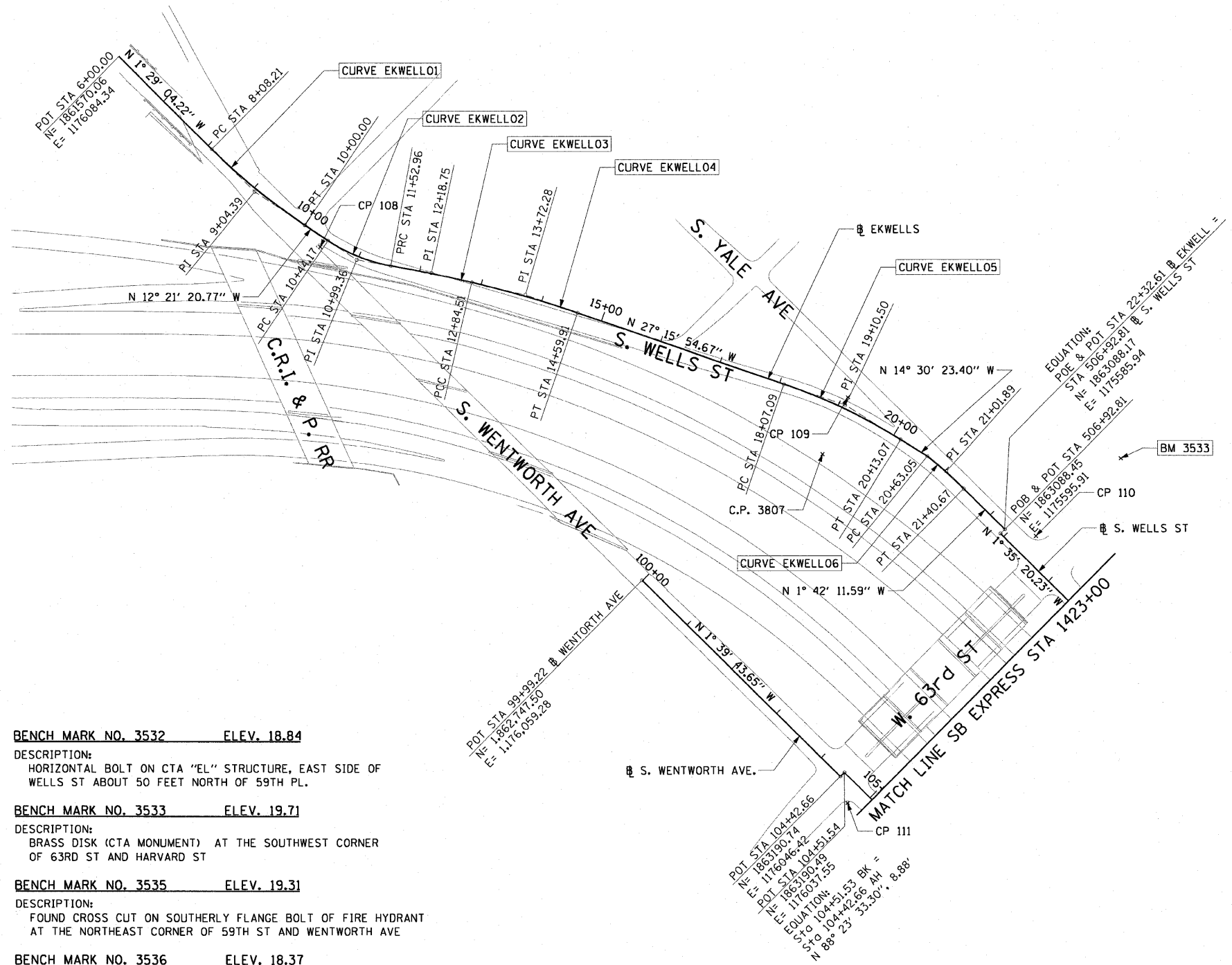

REVISIONS	
NAME	DATE

1/13/2009 12:26:06 PM \\scigrp207\p40468\p40468\civil\28-rree-wall\Fence\contract\30\030002\0317