

MATCH LINE STA. 799+97.54 EXT. -97.42

MATCH LINE STA. 814+00.12

ILLINOIS
31
M1-1100
24"x24"
W1-7
24"x12"
RIGHT LANE
MUST
TURN RIGHT
R3-7R
24"x12"

MOUNTED ON TRAFFIC
SIGNAL POST

12" WHITE 45° DIAGONALS
SPACED @ 3' C-C (TYP.)
SEE DISTRICT 1 TC-13 FOR DETAILS

LETTERS AND SYMBOLS
SPACED AS SHOWN IN DISTRICT 1
STANDARD TC-13 (TYPICAL)

6" WHITE SKIP DASH
LANE LINE
2' DASH, 6' SKIP (TYP.)

ALL EXISTING SIGNS LOCATED WITHIN THE COUNTY RIGHT-OF-WAY SHALL BE REMOVED
BY THE KDOT SIGN SHOP. THE CONTRACTOR SHALL CONTACT RAY JOHNSON (630) 669-7912
A MINIMUM OF 72 HOURS PRIOR TO THE DESIRED TIME OF REMOVAL.

ALL NEW SIGNS TO BE LOCATED WITHIN THE COUNTY RIGHT-OF-WAY SHALL BE SUPPLIED AND
INSTALLED BY THE KDOT SIGN SHOP. THE CONTRACTOR SHALL CONTACT RAY JOHNSON
(630) 669-7912 A MINIMUM OF FIFTEEN (15) WORKING DAYS PRIOR TO THE DESIRED TIME
OF INSTALLATION.

FOR ADDITIONAL PAVEMENT MARKINGS
SEE DRAWING PM-2

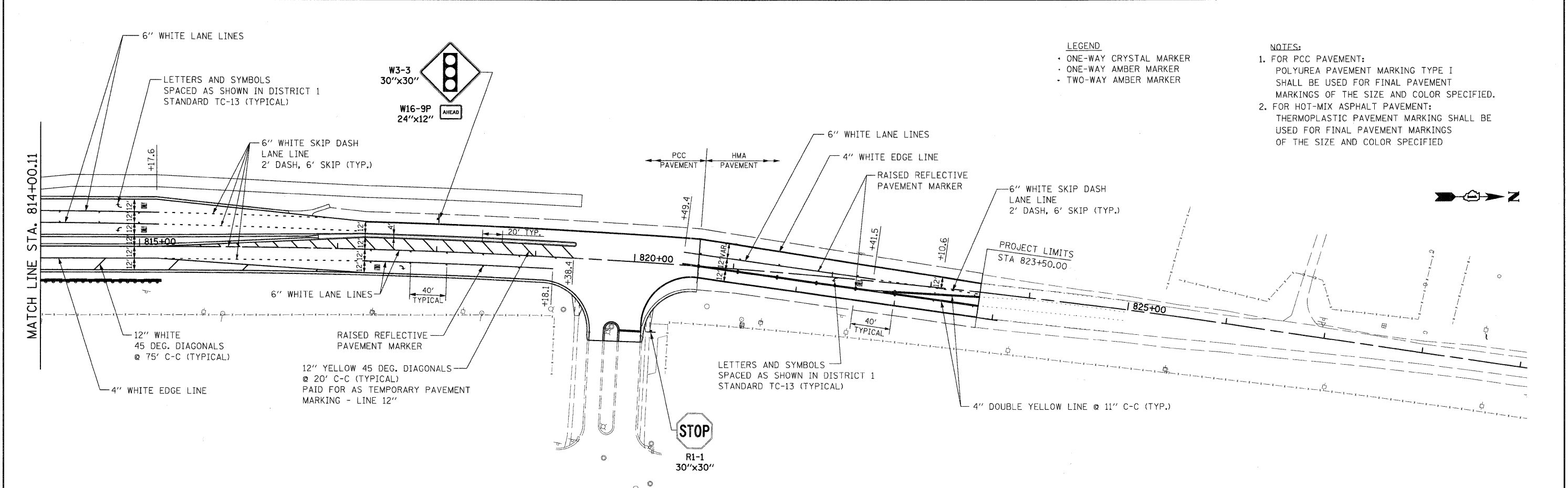

MATCH LINE STA. 814+00.11

LEGEND
• ONE-WAY CRYSTAL MARKER
• ONE-WAY AMBER MARKER
• TWO-WAY AMBER MARKER

NOTES:
1. FOR PCC PAVEMENT:
POLYUREA PAVEMENT MARKING TYPE I
SHALL BE USED FOR FINAL PAVEMENT
MARKINGS OF THE SIZE AND COLOR SPECIFIED.
2. FOR HOT-MIX ASPHALT PAVEMENT:
THERMOPLASTIC PAVEMENT MARKING SHALL BE
USED FOR FINAL PAVEMENT MARKINGS
OF THE SIZE AND COLOR SPECIFIED

LETTERS AND SYMBOLS
SPACED AS SHOWN IN DISTRICT 1
STANDARD TC-13 (TYPICAL)

W3-3
30"x30"
W16-9P
24"x12"
AHEAD

12" WHITE
45 DEG. DIAGONALS
@ 75' C-C (TYPICAL)

12" YELLOW 45 DEG. DIAGONALS
@ 20' C-C (TYPICAL)
PAID FOR AS TEMPORARY PAVEMENT
MARKING - LINE 12"

LETTERS AND SYMBOLS
SPACED AS SHOWN IN DISTRICT 1
STANDARD TC-13 (TYPICAL)

STOP
R1-1
30"x30"

FILE NAME =
I:\Dgn\Civil\Sheet\pm01.dgn

USER NAME = tthornton
DRAWN -
CHECKED -
DATE = 3/27/09

DESIGNED -
DRAWN -
CHECKED -
DATE = 3/27/09

REVISED -
REVISED -
REVISED -
REVISED -

STATE OF ILLINOIS
DEPARTMENT OF TRANSPORTATION

PAVEMENT MARKING AND SIGNING PLAN

SCALE: 1"=50' SHEET NO. OF SHEETS STA. TO STA.

F.A.P. RTE.	SECTION	COUNTY	TOTAL SHEETS	SHEET NO.
361	06-00214-10-BR	KANE	219	63
CONTRACT NO. 63073				
FED. ROAD DIST. NO. 1 ILLINOIS FED. AID PROJECT				