

DATE	
BY	
FINISHED SURVEY	
PLOTTED	
NOTE BOOK	
AREAS CHECKED	
NO.	

DATE	
BY	
ORIGINAL SURVEY	
PLOTTED	
NOTE BOOK	
AREAS CHECKED	
NO.	

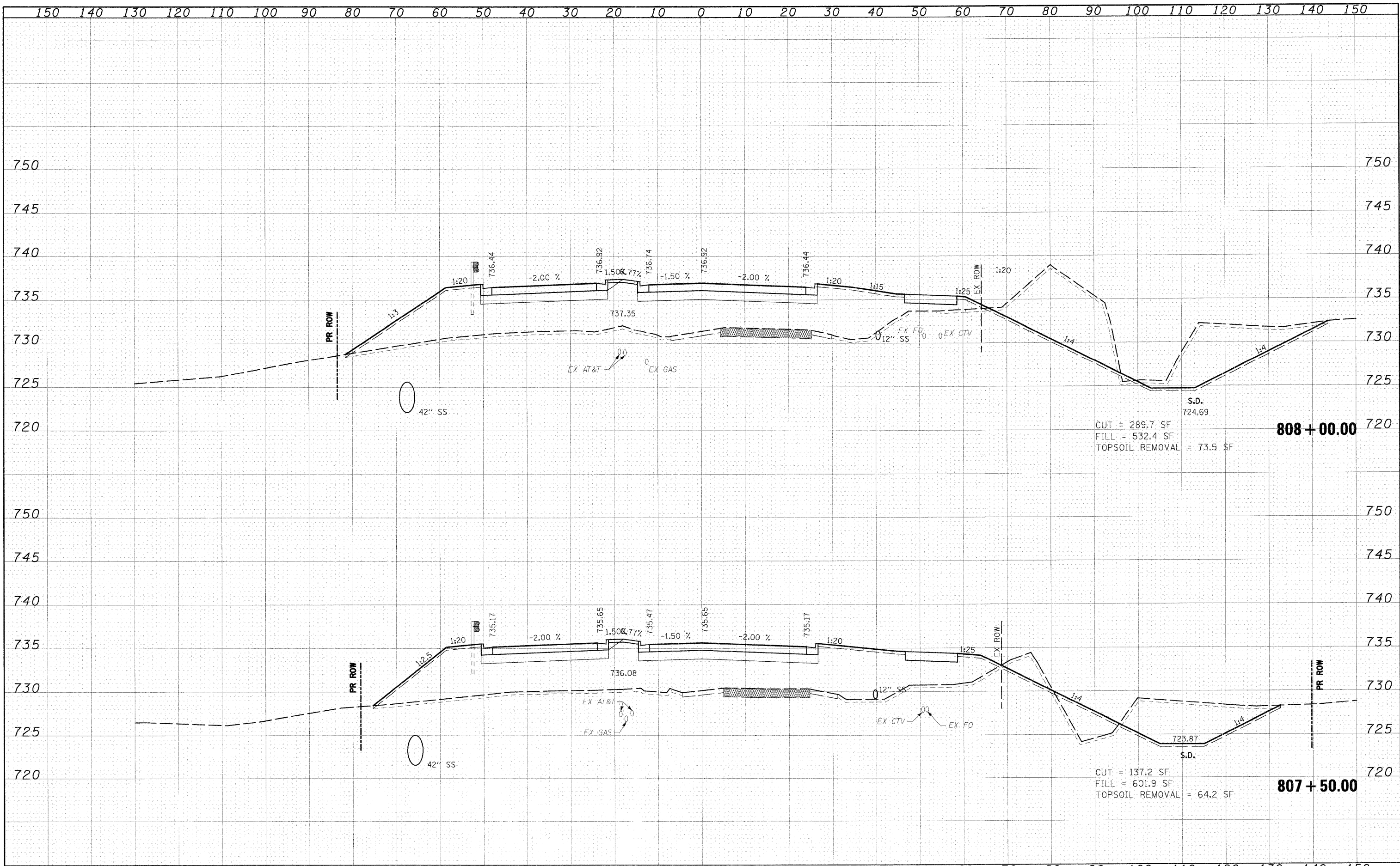

808 + 00.00
 S.D. 724.69
 CUT = 289.7 SF
 FILL = 532.4 SF
 TOPSOIL REMOVAL = 73.5 SF

807 + 50.00
 S.D. 723.87
 CUT = 137.2 SF
 FILL = 601.9 SF
 TOPSOIL REMOVAL = 64.2 SF

FILE NAME =	USER NAME = JFigueroa
I:\Dgn\Civil\Sheet\ks001.dgn	

DESIGNED - JWM	REVISIONS
DRAWN - JWM	REVISIONS
CHECKED - MJT	REVISIONS
DATE - 3/27/09	REVISIONS

DESIGNED - JWM	REVISIONS
DRAWN - JWM	REVISIONS
CHECKED - MJT	REVISIONS
DATE - 3/27/09	REVISIONS

**KANE COUNTY
DEPARTMENT OF TRANSPORTATION**

MCLEAN CROSS SECTIONS

SCALE: 1"=10'H H1"=5'V SHEET NO. OF 17 SHEETS STA. 807+50.00 TO STA. 808+00.00

F.A.P. RTE. 361	SECTION 06-00214-10-BR	COUNTY KANE	TOTAL SHEETS 219	SHEET NO. 205
FED. ROAD DIST. NO. 1 ILLINOIS FED. AID PROJECT			CONTRACT NO. 63073	