

Benchmark BM-24:  
 "Aluminum Disk" set in concrete, 0.50± mile east of Stearns Road and Dunham Road at the south side of Stearns Road. Elev. 762.678  
 Existing Structure: None  
 Precast alternate is not allowed.

STATE OF ILLINOIS  
 DEPARTMENT OF TRANSPORTATION

| ROUTE NO. | SECTION | COUNTY | TOTAL SHEETS | SHEET NO. |
|-----------|---------|--------|--------------|-----------|
|           |         | KANE   | 545          | 288       |

Contract #63074

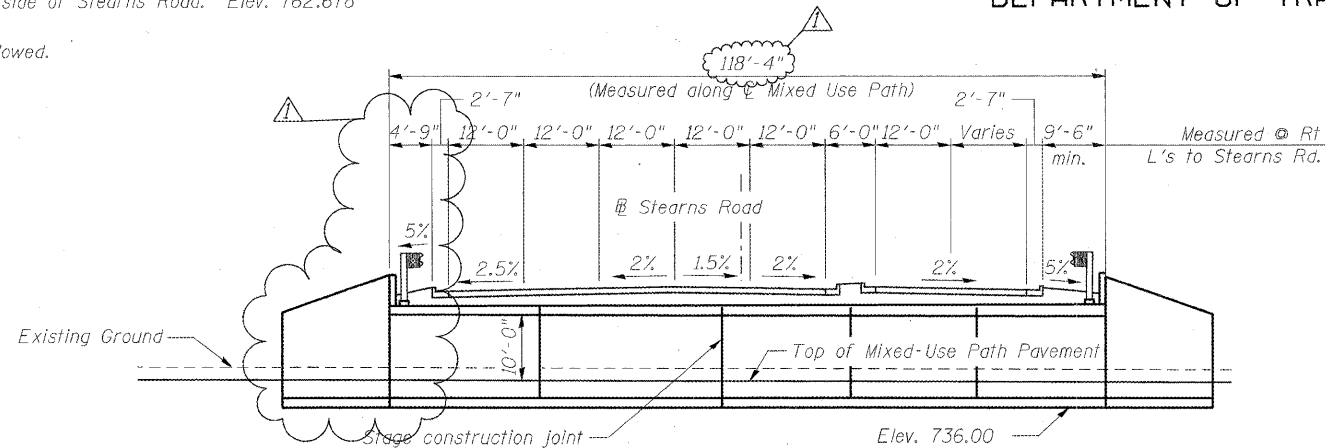

**ELEVATION**

Mixed Use Path along IL 25/Dunham Road  
 Under IL 25/Stearns Road, SN 045-3173

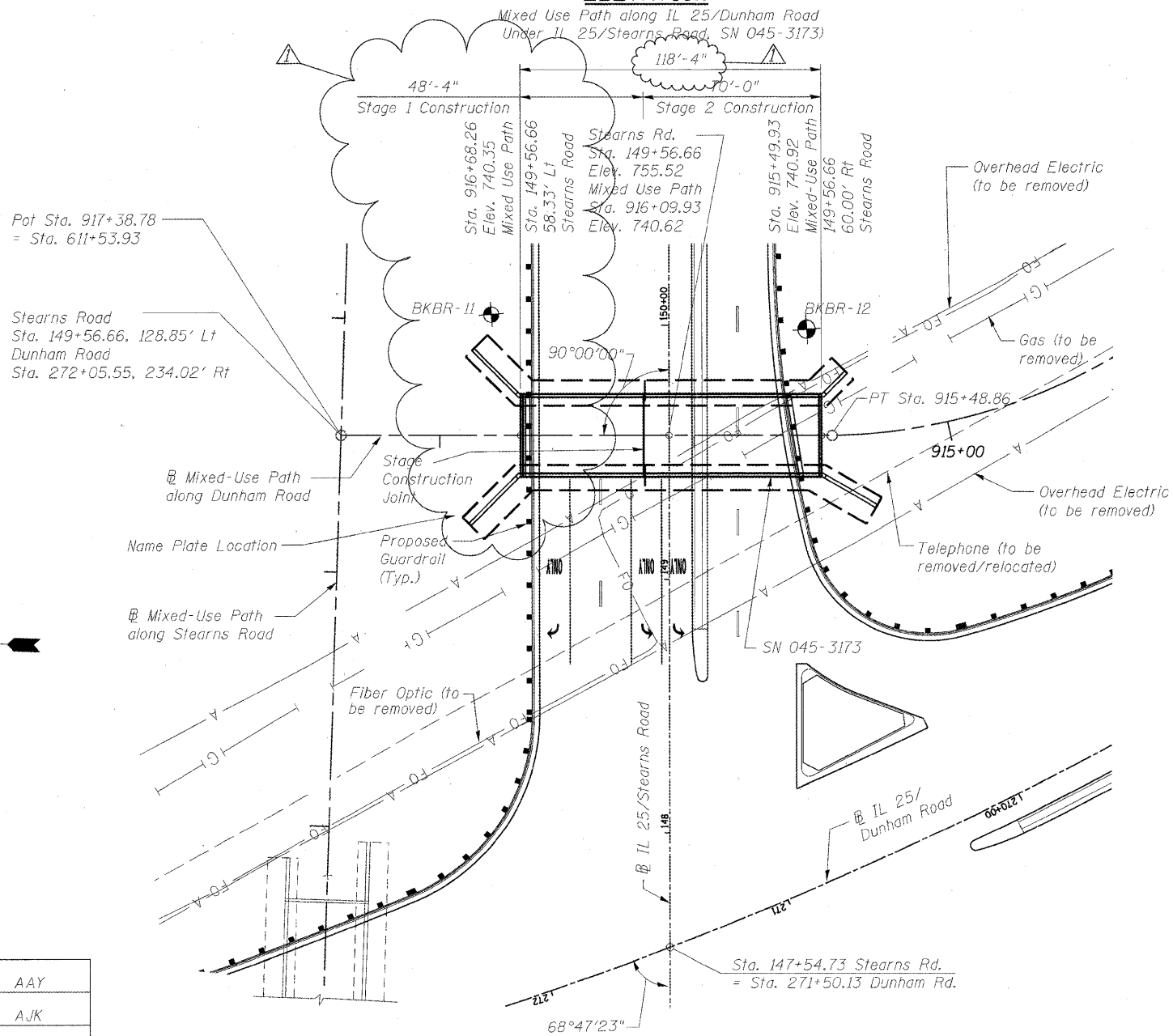

**GENERAL PLAN**

**LOADING HS-20**  
 Allow 50#/sq. ft. for future wearing surface.

**DESIGN SPECIFICATIONS**  
 AASHTO Standard Specifications for Highway Bridges, 17th edition

**DESIGN STRESSES**

**FIELD UNITS**  
 $f'_c = 3,500$  psi  
 $f_y = 60,000$  psi (Reinforcement)

**MAXIMUM APPLIED BEARING PRESSURE**  
 3,000 psf

**SEISMIC DATA**  
 Seismic Performance Category (SPC) = A  
 Bedrock Acceleration Coefficient (A) = 0.037 g  
 Site Coefficient (S) = 1.0

**NAME PLATE**  
 See std. 515001  
 See sheet SA-13 for location

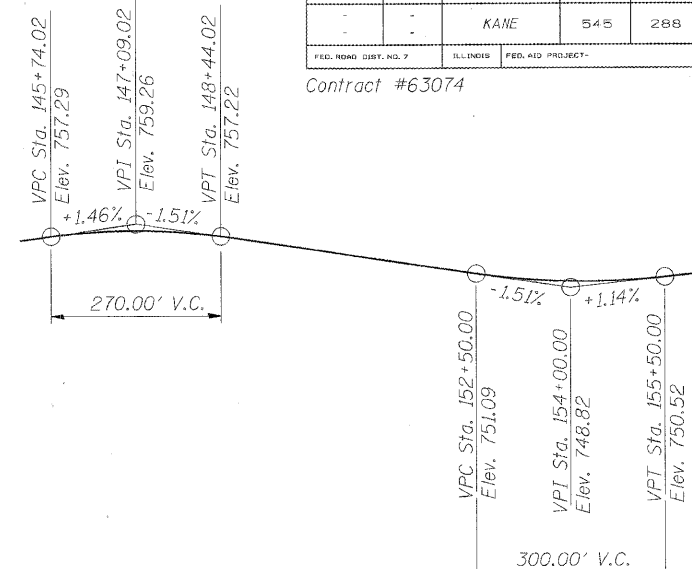

**PROFILE GRADE**  
 (IL 25/Stearns Road)

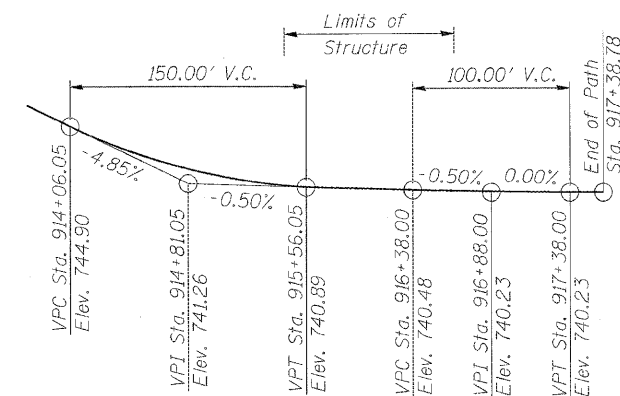

**PROFILE GRADE**  
 Mixed-Use Path Along Dunham Road  
 (Under Stearns Road)

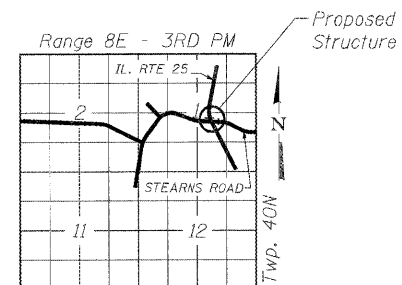

**LOCATION SKETCH**

**GENERAL PLAN AND ELEVATION**  
**MULTI-USE PATH UNDER**  
**IL 25/STEARNS ROAD**  
**F.A.P. 360 - SEC. 06-00214-15-BR**  
**KANE COUNTY**  
**STATION 916+09.93**  
**STRUCTURE NO. 045-3173**

|          |         |
|----------|---------|
| DESIGNED | AAY     |
| CHECKED  | AJK     |
| DRAWN    | VH      |
| CHECKED  | HMA/DMC |

Addendum #1 - 6/5/09

**benesch**  
 alfred benesch & company  
 Engineers • Surveyors • Planners  
 205 North Michigan Avenue, Suite 2400  
 Chicago, Illinois 60601  
 312-665-0460  
 Job # 3944

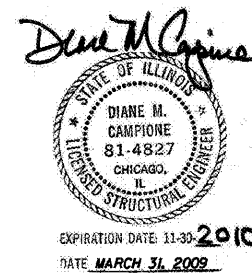

x:\39000s\3944\engineering\_documents\IL25\Stearns\_Road\_Path\_under\_IL25\Stearns\_SN045-3173\Final\0453173-63074-001-gps.dgn  
 6/3/2009 11:44:39 PM