

DATE	
BY	
FINAL SURVEY	SURVEYED
NOTE BOOK	PLOTTED
NO.	AREAS CHECKED

DATE	
BY	
ORIGINAL SURVEY	SURVEYED
NOTE BOOK	PLOTTED
NO.	AREAS CHECKED

x:\3900s\3944\Engineering\documents\Roadway\Cross Sections\sheet_abc_dun_xsl.dgn

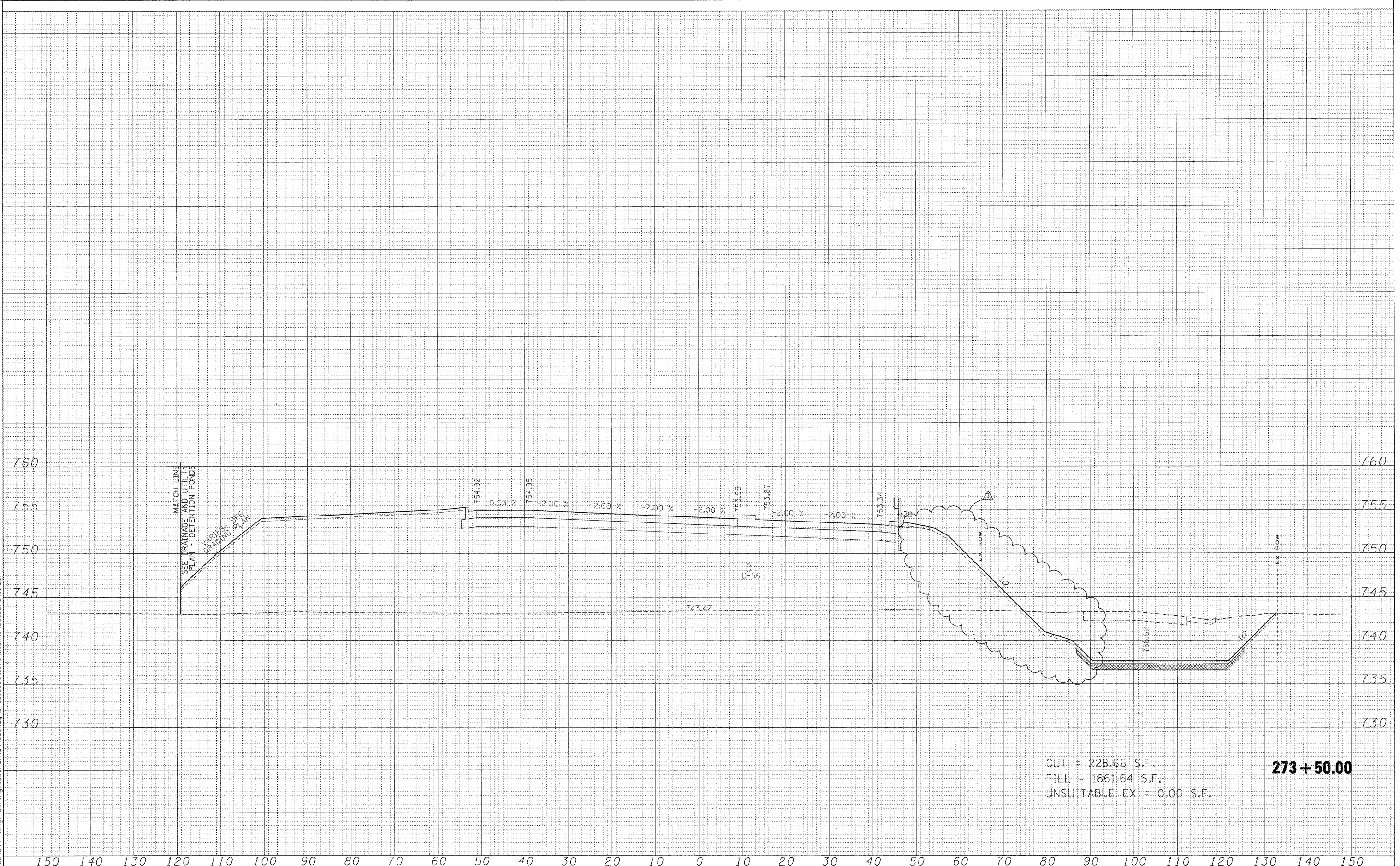

CUT = 228.66 S.F.
 FILL = 1861.64 S.F.
 UNSUITABLE EX = 0.00 S.F.

273+50.00

FILE NAME =	USER NAME = #USER#	DESIGNED - MAC	REVISED - Δ ADDENDUM 6/3/09	KANE COUNTY DIVISION OF TRANSPORTATION	DUNHAM ROAD CROSS SECTIONS			F.A. RTE. 361	SECTION 06-00214-15-BR	COUNTY KANE/DUPAGE	TOTAL SHEETS 545	SHEET NO. 413
#FILES#	PLOT SCALE = 10.0000' / IN.	DRAWN - MAC	REVISED -		SCALE:	SHEET NO.	OF	SHEETS	STA. 273+50.00	TO STA. 273+50.00	FED. ROAD DIST. NO.	ILLINOIS FED. AID PROJECT
	PLOT DATE = 5/14/2009	CHECKED - JUT	REVISED -		CONTRACT NO. 63074							
		DATE - 3/31/09	REVISED -									