

PR CURVE STNG
 PI STA. = 187+65.38
 $\Delta = 10^\circ 39' 18''$ (RT)
 $D = 0^\circ 55' 35''$
 $R = 6,184.67'$
 $T = 576.73'$
 $L = 1,150.13'$
 $E = 26.83'$
 $e = \text{-----}$
 $T.R. = \text{-----}$
 $S.E. \text{ RUN} = \text{-----}$
 P.C. STA = 181+88.65
 P.T. STA = 193+38.78

COORDINATE DATA			
STATION	NORTHING	EASTING	REMARKS
187+65.38	1934313.85	1005642.82	PI PR CURVE STNG
181+88.65	1934226.80	1005072.70	PC PR CURVE STNG
192+76.00	1934295.82	1006156.45	PR \odot STEARNS RD

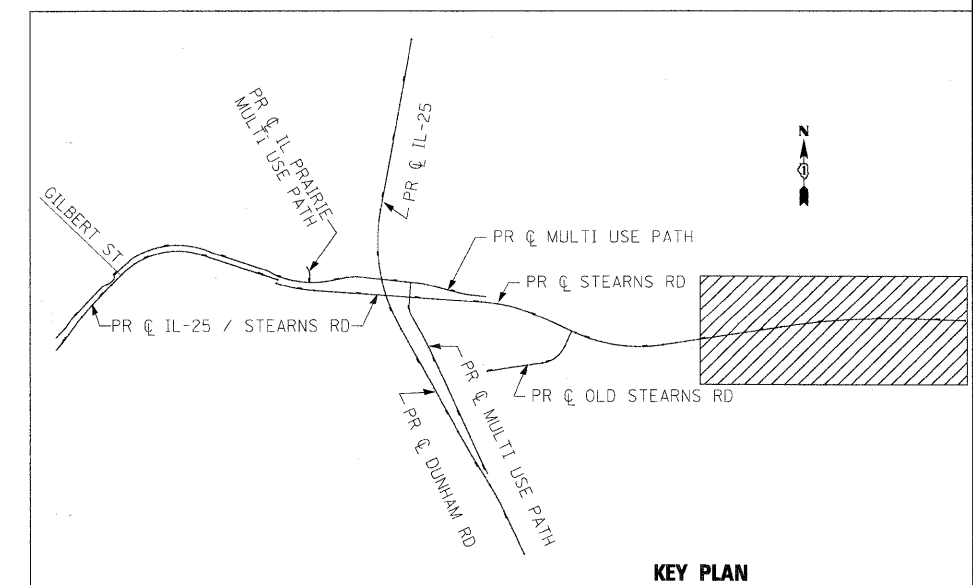
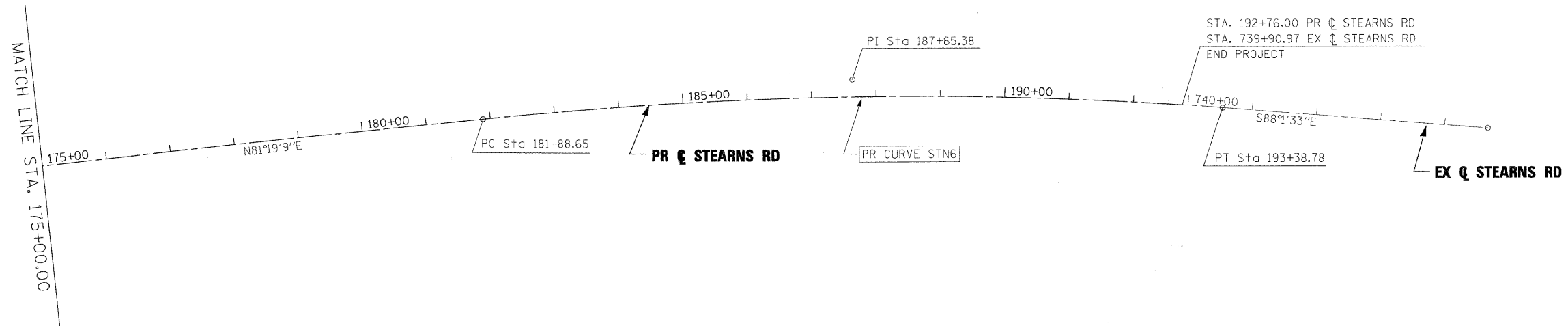
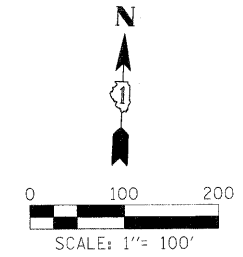

KEY PLAN

x:\3000s\3944\engineer\ng_documents\roadway\Alignment_end.tues\prp\in-ABC-STN_e1_03.dwg

FILE NAME =	USER NAME = @USER*	DESIGNED - JRM	REVISED -
#FILES*		DRAWN - NMM	REVISED -
	PLOT SCALE = 100.0000' / IN.	CHECKED - JNR	REVISED -
	PLOT DATE = 3/30/2009	DATE - 3/31/09	REVISED -

**KANE COUNTY
DIVISION OF TRANSPORTATION**

**ALIGNMENT PLAN
STEARNS ROAD**

SCALE: SHEET NO. OF SHEETS STA. 175+00.00 TO STA. 192+76.00

F.A. RTE.	SECTION	COUNTY	TOTAL SHEET SHEETS
361	06-00214-15-BR	KANE/DUPAGE	545 52
FED. ROAD DIST. NO.			ILLINOIS FED. AID PROJECT
			CONTRACT NO. 63074