



STAGE 3A

TRAFFIC:

IL 25, DUNHAM ROAD AND STEARNS ROAD CONTINUE TO UTILIZE THE PROPOSED INTERSECTION. WEST OF THE INTERSECTION, IL 25/STEARNS ROAD TRAFFIC IS SHIFTED TO THE NORTH HALF OF THE RECENTLY COMPLETED PAVEMENT.

CONSTRUCTION:

- ① BUILD SOUTHBOUND DUNHAM FROM 280+20 TO THE END OF PROJECT
- ② INSTALL STORM SEWER FROM 490+50 RT TO 492+50 RT
- ③ WIDEN EASTBOUND STEARNS ROAD (IL 25) FROM 484+83 TO 501+10
- ④ WIDEN AND RECONSTRUCT EASTBOUND STEARNS ROAD (IL 25) FROM 501+10 TO 505+50

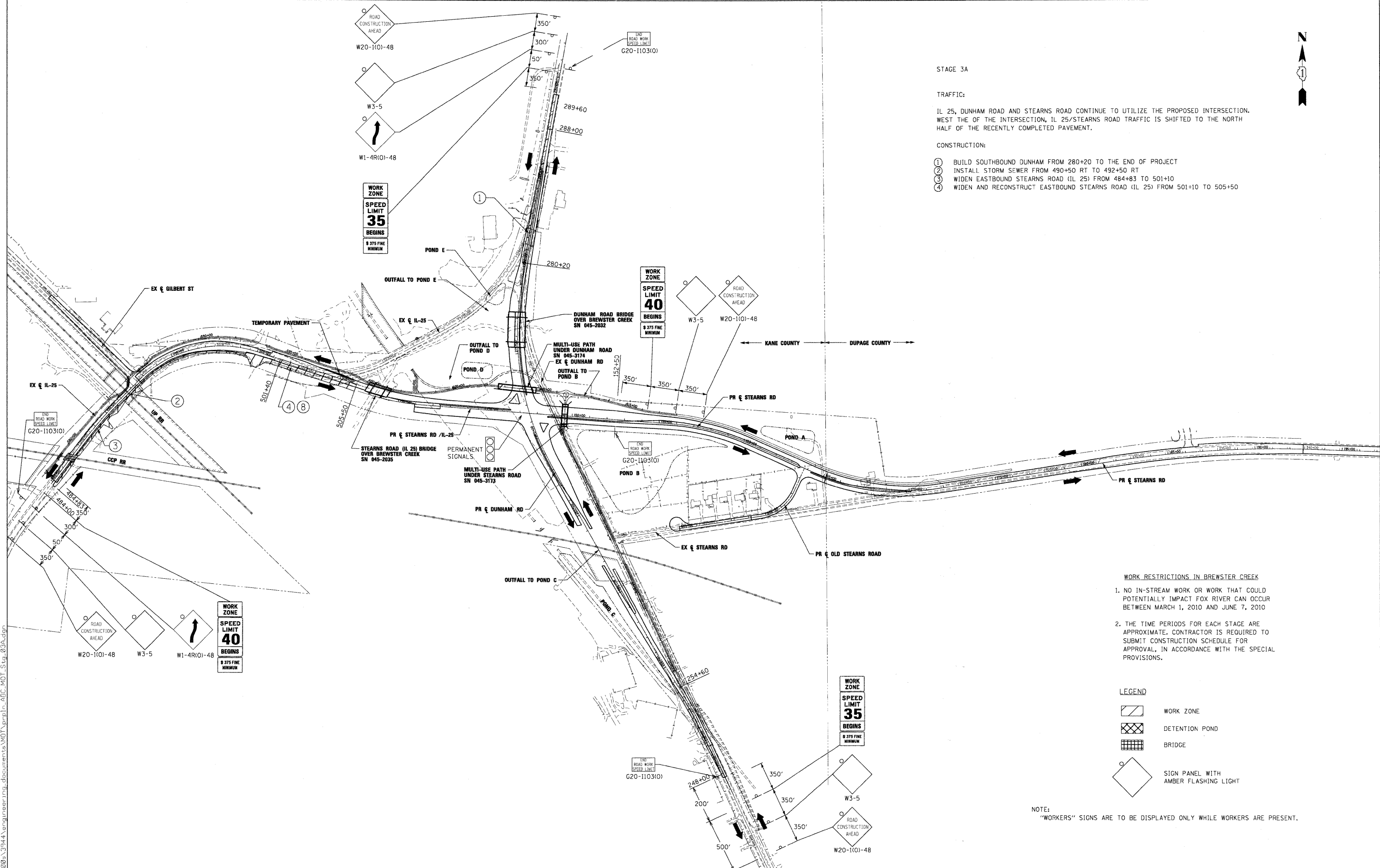

WORK RESTRICTIONS IN BREWSTER CREEK

- 1. NO IN-STREAM WORK OR WORK THAT COULD POTENTIALLY IMPACT FOX RIVER CAN OCCUR BETWEEN MARCH 1, 2010 AND JUNE 7, 2010
- 2. THE TIME PERIODS FOR EACH STAGE ARE APPROXIMATE. CONTRACTOR IS REQUIRED TO SUBMIT CONSTRUCTION SCHEDULE FOR APPROVAL, IN ACCORDANCE WITH THE SPECIAL PROVISIONS.

LEGEND

- WORK ZONE
- DETENTION POND
- BRIDGE
- SIGN PANEL WITH AMBER FLASHING LIGHT

NOTE: "WORKERS" SIGNS ARE TO BE DISPLAYED ONLY WHILE WORKERS ARE PRESENT.

x:\39080s\3944\engineer\mg_documents\101\prbln_AFC_MOT_Stage_03A.dgn

FILE NAME =	USER NAME = #USER#
#FILES#	

PLOT SCALE = 250.00' / IN.	DESIGNED - BJW
PLOT DATE = 3/30/2009	DRAWN - DMS
	CHECKED - JNR
	DATE - 3/31/09

REVISED -	REVISED -
REVISED -	REVISED -
REVISED -	REVISED -

**KANE COUNTY
DIVISION OF TRANSPORTATION**

MAINTENANCE OF TRAFFIC SEQUENCE OF CONSTRUCTION STAGE 3A			
SCALE:	SHEET NO. OF SHEETS	STA. TO STA.	

F.A. RTE.	SECTION	COUNTY	TOTAL SHEETS	SHEET NO.
361	06-00214-15-BR	KANE/DUPAGE	545	89
CONTRACT NO. 63074				
FED. ROAD DIST. NO. ILLINOIS FED. AID PROJECT				