

- NOTES:
1. FOR ADVANCE SIGNAGE SEE SEQUENCE OF CONSTRUCTION STAGE 3A.
  2. PERMANENT PAVEMENT MARKING WILL BE IN PLACE ON ALL OF GILBERT ROAD.
  3. ANY PAVEMENT MARKINGS BEYOND THE CONSTRUCTION LIMITS WILL BE TEMPORARY PAVEMENT MARKING TAPE.

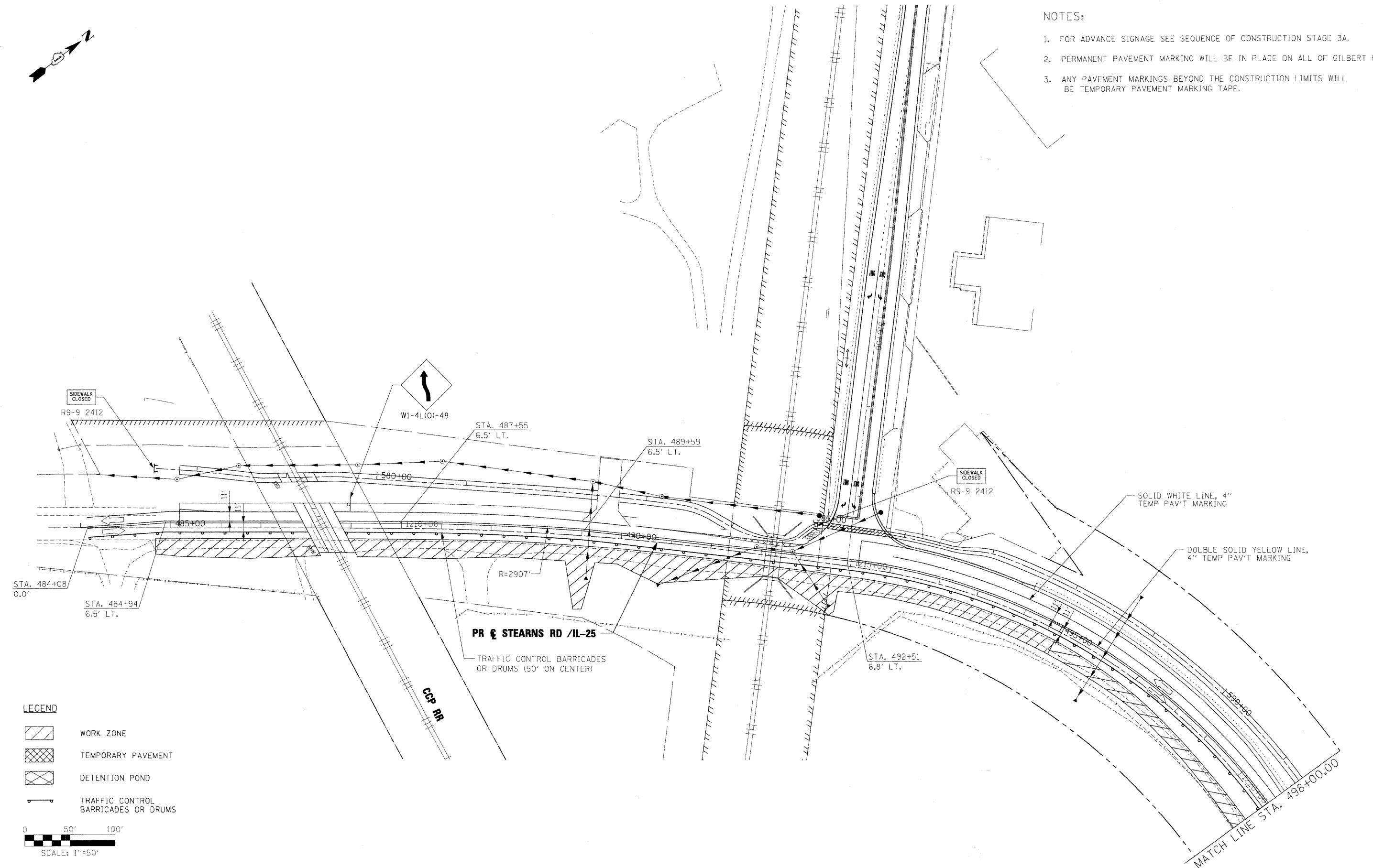

- LEGEND
- WORK ZONE
  - TEMPORARY PAVEMENT
  - DETENTION POND
  - TRAFFIC CONTROL BARRICADES OR DRUMS

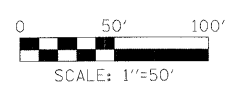

x:\2009s\3944\engineering\documents\M01\prp1r\_abc.stn\_no:3A\_01.dgn

FILE NAME =	USER NAME = #USER#	DESIGNED - BJW	REVISED -	<b>KANE COUNTY DIVISION OF TRANSPORTATION</b>	<b>MAINTENANCE OF TRAFFIC STEARNS ROAD STAGE 3A</b>			F.A. RTE. 361	SECTION 06-00214-15-BR	COUNTY KANE/DUPAGE	TOTAL SHEETS 545	SHEET NO. 118
#FILES#	PLOT SCALE = 50.00' / IN.	DRAWN - DMS	REVISED -		SCALE:	SHEET NO. OF SHEETS	STA. TO STA.	FED. ROAD DIST. NO.	ILLINOIS FED. AID PROJECT	CONTRACT NO. 63074		
	PLOT DATE = 3/30/2009	CHECKED - JNR	REVISED -									
		DATE - 3/31/09	REVISED -									