

STAGE 3B
 TRAFFIC:
 NORTH OF THE INTERSECTION, SHIFT SB DUNHAM ROAD TRAFFIC TO THE SB PAVEMENT COMPLETED STAGE 3A.
 CONSTRUCTION:
 CONSTRUCT REMAINING PORTION OF IL 25/DUNHAM ROAD OUTSIDE LANE
 STAGE CONSTRUCT ENTRANCE STA. 282+80 LT
 CONSTRUCT SB OUTSIDE SHOULDER STA. 283+66 TO THE END OF THE PROJECT

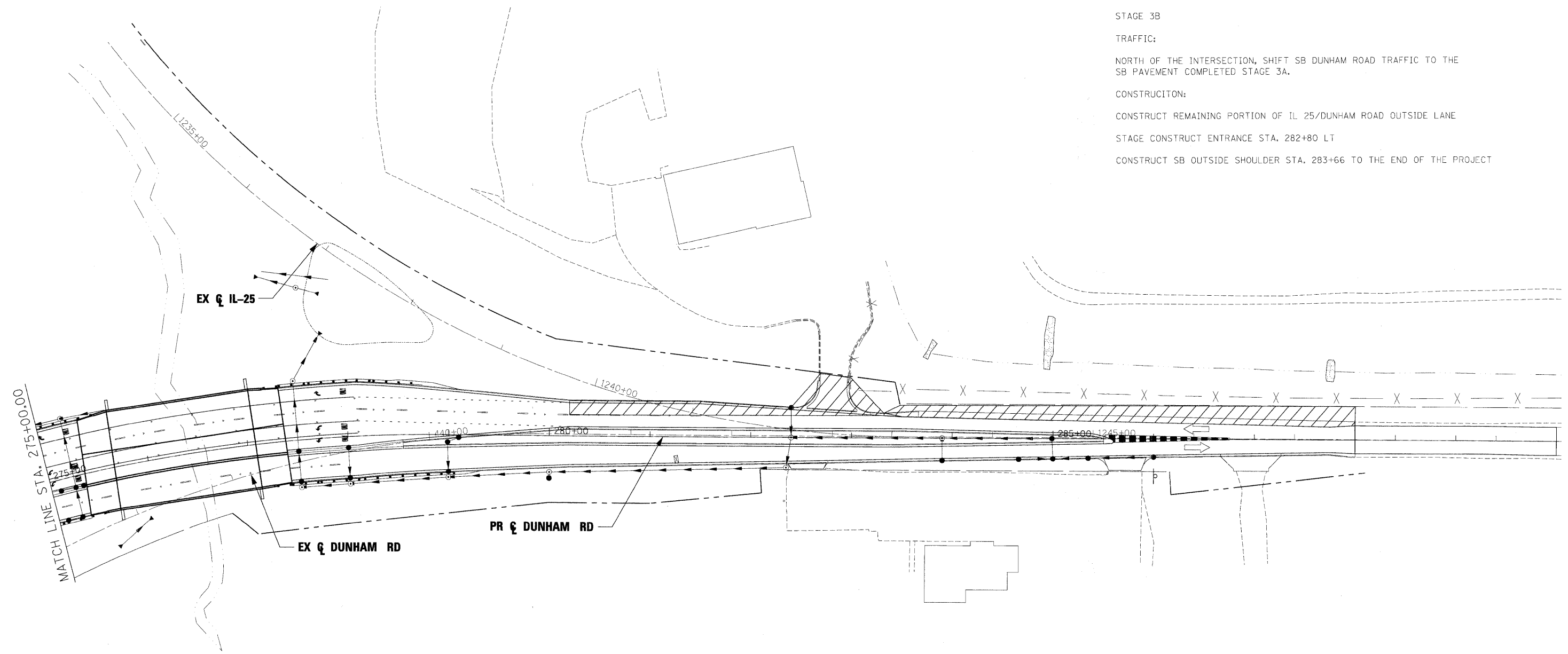

- LEGEND**
- WORK ZONE
 - TEMPORARY PAVEMENT
 - DETENTION POND
 - TRAFFIC CONTROL BARRICADES OR DRUMS

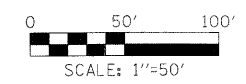

x:\3900s\3944\engineering\documents\MDT\prp\plc_abc_dun_dun_mst3B_03.dgn

FILE NAME = #FILES#	USER NAME = #USER#	DESIGNED - BJW	REVISED -	KANE COUNTY DIVISION OF TRANSPORTATION	MAINTENANCE OF TRAFFIC DUNHAM ROAD STAGE 3B			F.A. RTE. 361	SECTION 06-00214-15-BR	COUNTY KANE/DUPAGE	TOTAL SHEETS 545	SHEET NO. 120
	PLOT SCALE = 50.00' / IN.	CHECKED - JNR	REVISED -		SCALE:	SHEET NO. OF SHEETS	STA. TO STA.	CONTRACT NO. 63074				
	PLOT DATE = 3/30/2009	DATE - 3/31/09	REVISED -		FED. ROAD DIST. NO. ILLINOIS FED. AID PROJECT							