

FINAL SURVEY SUBMITTED SURVEY PLOTTED TEMPLATE NOTE BOOK AREAS CHECKED NO.

ORIGINAL SURVEY SUBMITTED SURVEY PLOTTED TEMPLATE NOTE BOOK AREAS CHECKED NO.

X:\3900\3944\engineering\documents\roadway\cross-sections\ssht.abc\dun_xsl.dgn

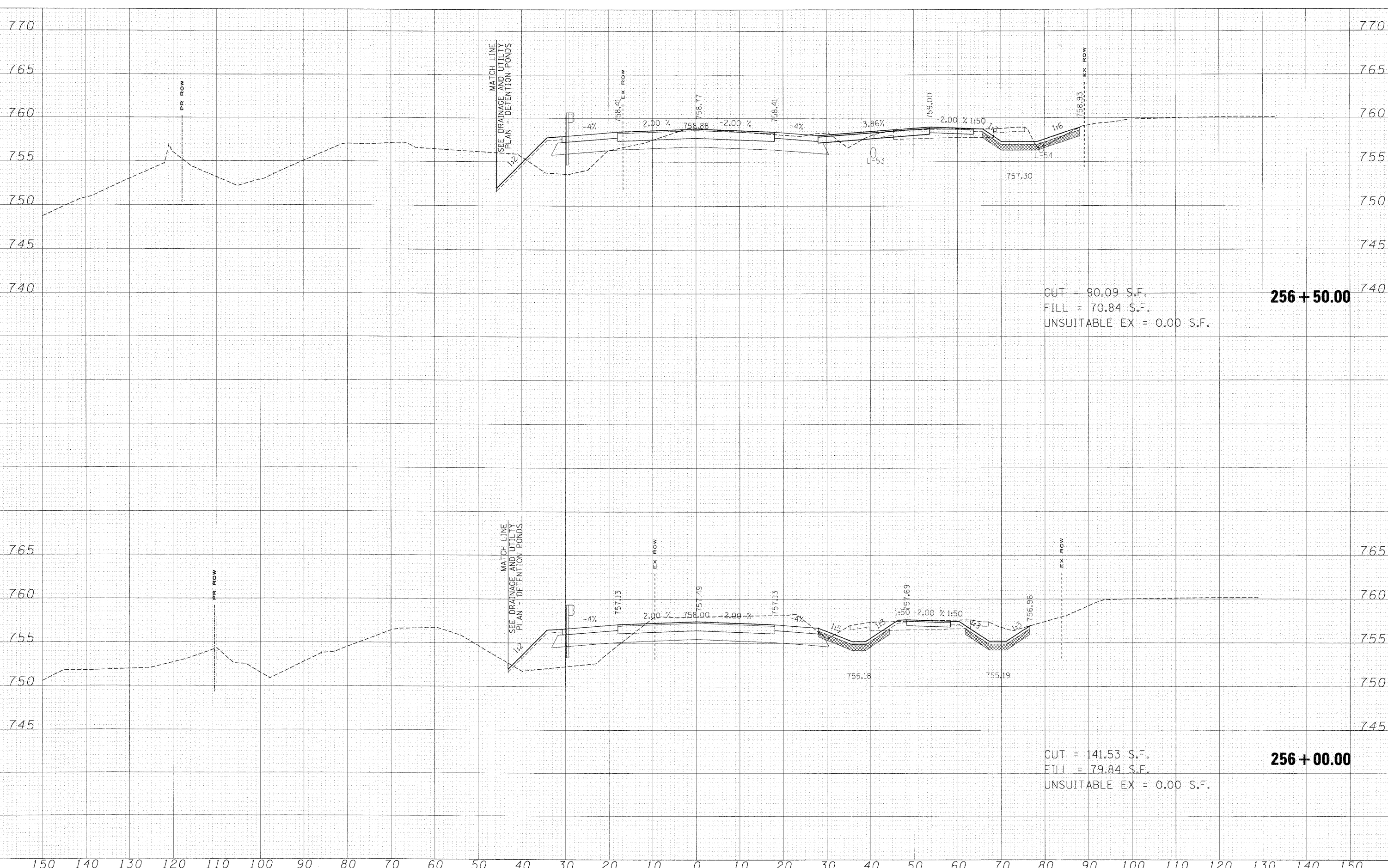

CUT = 90.09 S.F.
 FILL = 70.84 S.F.
 UNSUITABLE EX = 0.00 S.F.
256 + 50.00

CUT = 141.53 S.F.
 FILL = 79.84 S.F.
 UNSUITABLE EX = 0.00 S.F.
256 + 00.00

FILE NAME =	USER NAME = *USER*	DESIGNED - MAC	REVISED -	KANE COUNTY DIVISION OF TRANSPORTATION	DUNHAM ROAD CROSS SECTIONS			F.A. RTE.	SECTION	COUNTY	TOTAL SHEETS	SHEET NO.			
#FILES*		DRAWN - MAC	REVISED -		SCALE:	SHEET NO.	OF	SHEETS	STA. 256+00.00	TO STA. 256+50.00	361	06-00214-15-BR	KANE/DUPAGE	545	390
		CHECKED - JJT	REVISED -												
		DATE - 3/31/09	REVISED -												
								CONTRACT NO. 63074			FED. ROAD DIST. NO. [ILLINOIS] FED. AID PROJECT				