

FINAL SURVEY PLOTTED TEMPLATE NO. 3944

ORIGINAL SURVEY PLOTTED TEMPLATE NO. 3944

X:\3944\3944\engineering\documents\roadway\Cross Sections\sect L-68C.DUN.vst.dgn

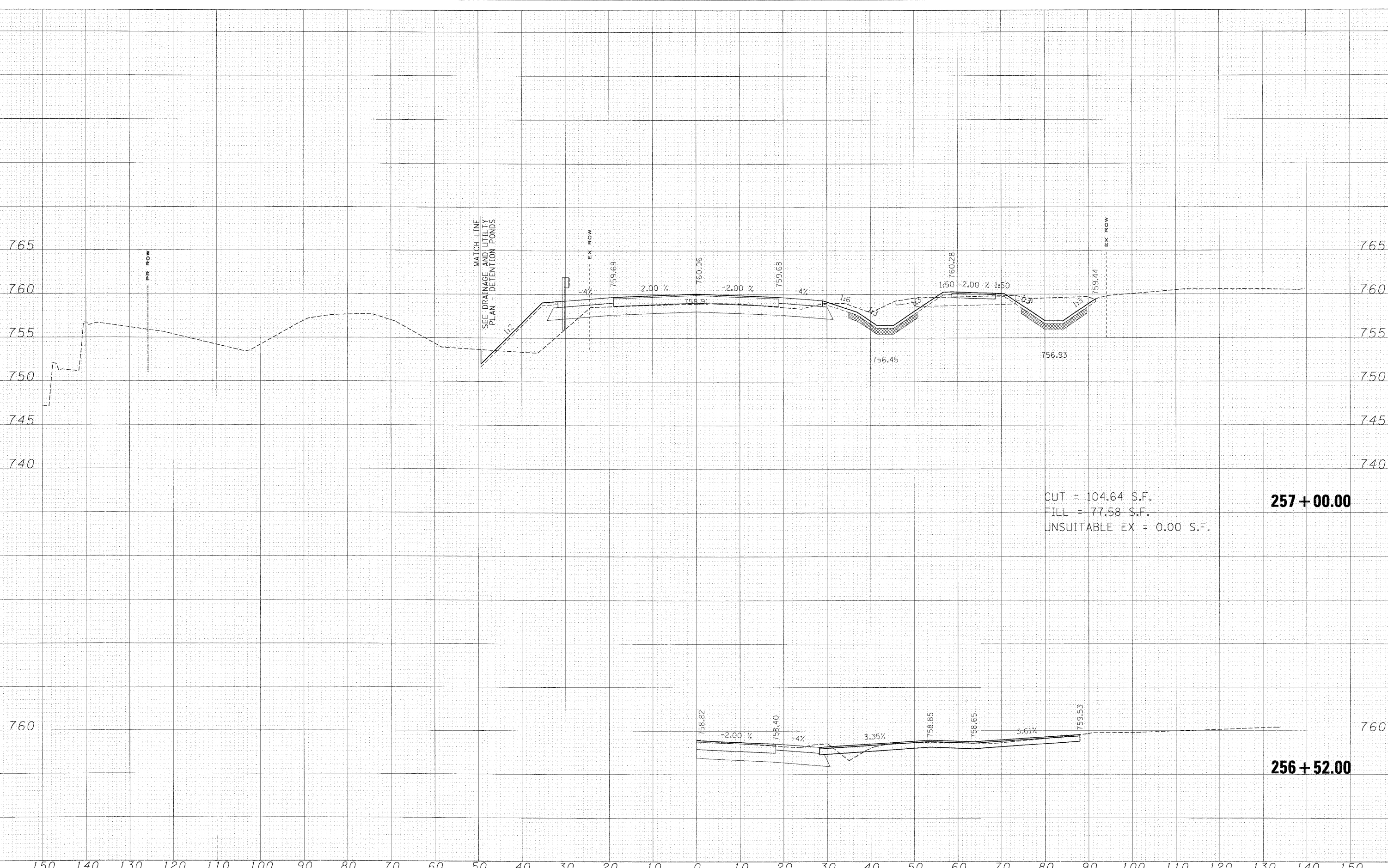

CUT = 104.64 S.F.
 FILL = 77.58 S.F.
 UNSUITABLE EX = 0.00 S.F.

257 + 00.00

256 + 52.00

FILE NAME =	USER NAME = #USER#	DESIGNED - MAC	REVISED -	KANE COUNTY DIVISION OF TRANSPORTATION	DUNHAM ROAD CROSS SECTIONS	F.A. RTE.	SECTION	COUNTY	TOTAL SHEETS	SHEET NO.	
#FILES#	PLOT SCALE = 10.0000' / IN.	DRAWN - MAC	REVISED -			361	06-00214-15-BR	KANE/DUPAGE	545	391	
	PLOT DATE = 3/30/2009	CHECKED - JJT	REVISED -			CONTRACT NO. 63074		FED. ROAD DIST. NO. [ILLINOIS] FED. AID PROJECT			
		DATE - 3/31/09	REVISED -			SCALE:	SHEET NO. OF SHEETS	STA. 256+52.00 TO STA. 257+00.00			