



**NOTE:**

ALL DIAMOND SHAPE CONSTRUCTION WARNING SIGNS SHALL BE 48" X 48" UNLESS OTHERWISE NOTED

TYPE I OR TYPE II BARRICADES ARE NOT PERMITTED ON RANDALL ROAD OR STEARNS ROAD FROM STA. 434+00 TO STA. 437+00, CONTRACTOR SHALL USE DRUMS ONLY

**LEGEND**

- ○ ○ TYPE I OR II BARRICADES (OR DRUMS) WITH MONO-DIRECTIONAL STEADY-BURN LIGHTS @ 50' CENTERS (25' SPACING IN TAPERS, 10' SPACING IN CORNER RADII)
- ⊥ ⊥ TYPE III BARRICADE WITH FLASHING LIGHTS
- ⊥ TEMPORARY TRAFFIC SIGN
- ⇨ DIRECTION OF TRAFFIC
- FLASHING AMBER BEACON

SEE IDOT STANDARD DETAIL 701701-05

END ROAD WORK  
G20-2  
36" X 18"

R3-8B  
48" X 30"

4" WHITE SKIP DASH  
(2' DASH - 6' SKIP)

REMOVE CONFLICTING PAVEMENT MARKINGS (TYP.)

4" WHITE SKIP DASH  
(2' DASH - 6' SKIP)

R3-5R  
30" X 36"

LETTERS & SYMBOLS, WHITE

4" WHITE SKIP DASH  
(2' DASH - 6' SKIP)

REMOVE CONFLICTING PAVEMENT MARKINGS (TYP.)

REMOVE CONFLICTING PAVEMENT MARKINGS

4" WHITE SKIP DASH  
(2' DASH - 6' SKIP)

REMOVE CONFLICTING PAVEMENT MARKINGS

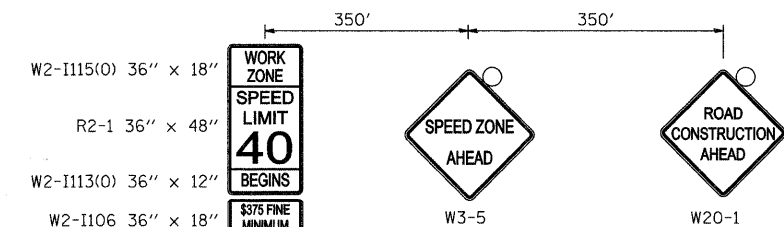
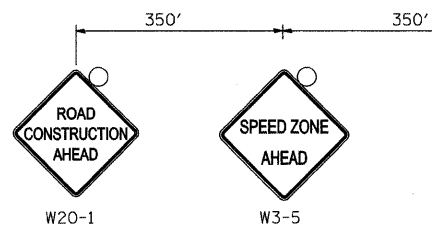

END WORK ZONE SPEED LIMIT  
G20-1103(O)  
60" X 36"

SHOULDER CLOSED AHEAD  
W21-5B(R)

END WORK ZONE SPEED LIMIT  
G20-1103(O)  
60" X 36"

SEE SHEET NO. 39  
STEARNS ROAD MOT

FILE NAME = 	USER NAME = jsm DESIGNED - JSM DRAWN - JSM CHECKED - DNM PLOT DATE = 3/30/2009	REVISED - REVISED - REVISED - REVISED -	<b>KANE COUNTY DIVISION OF TRANSPORTATION</b>	<b>MAINTENANCE OF TRAFFIC - MCDONALD ROAD &amp; RANDALL ROAD STAGE 2A &amp; 2B</b>	F.A. RTE. = 361 SECTION = 06-00214-25-BR COUNTY = KANE TOTAL SHEETS = 220 SHEET NO. = 38 CONTRACT NO. 63076
	SCALE: 1" = 50'    SHEET NO. 2 OF 14 SHEETS    STA. TO STA. 436+00				
	FEDERAL ROAD DIST. NO. 1 (ILLINOIS) FED. AID PROJECT				
	SEE SHEET NO. 39 STEARNS ROAD MOT				