

MATCH LINE B
(SEE SHEET 1 OF 2)

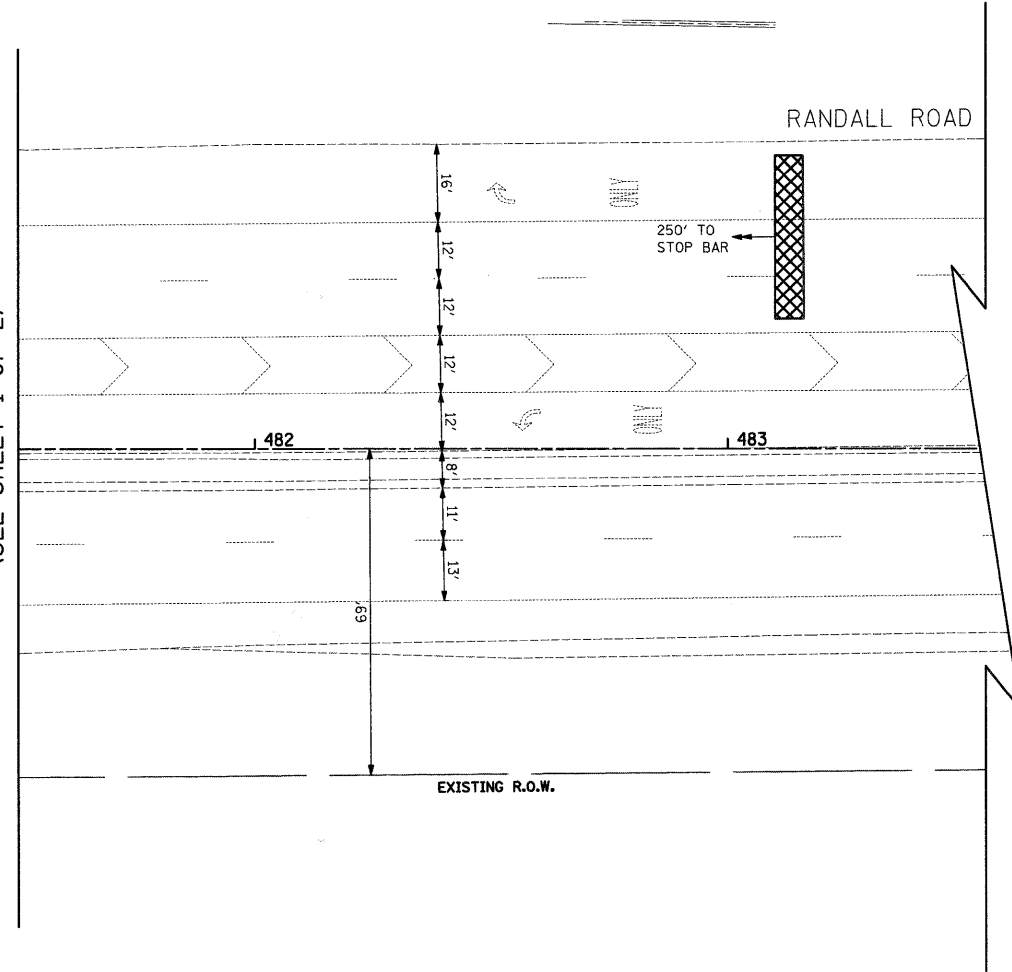

MATCH LINE A
(SEE SHEET 1 OF 2)

TEMPORARY TRAFFIC SIGNAL LEGEND

- TEMPORARY TRAFFIC SIGNAL HEAD SPAN WIRE MOUNTED ORIGINAL LOCATION
- TEMPORARY TRAFFIC SIGNAL HEAD SPAN WIRE MOUNTED SECONDARY LOCATION
- TEMPORARY WOOD POLE (CLASS 5 OR BETTER) 45 FOOT (13.7m) MINIMUM
- TEMPORARY CONTROLLER CABINET
- TEMPORARY SPAN WIRE, TETHER WIRE, AND CABLE
- TEMPORARY SERVICE INSTALLATION
- TEMPORARY PEDESTRIAN SIGNAL HEAD, BRACKET MOUNTED
- TEMPORARY PEDESTRIAN PUSHBUTTON DETECTOR
- VIDEO VEHICLE DETECTOR
- PTZ CAMERA
- EMERGENCY VEHICLE LIGHT DETECTOR
- CONFIRMATION BEACON
- VEHICLE DETECTOR, INDUCTION LOOP
- COMMON TRENCH
- UNIT DUCT
- G.S. CONDUIT IN TRENCH OR PUSHED
- HANDHOLE
- HEAVY-DUTY HANDHOLE
- TEMPORARY DETECTION ZONE
- ETHERNET RADIO ANTENNA

EXISTING EQUIPMENT TO BE REMOVED LEGEND

- EXISTING TEMPORARY POLE TO BE REMOVED "E"
- EXISTING CONTROLLER TO BE RELOCATED "R"
- EXISTING HANDHOLE TO BE REMOVED "E"
- EMERGENCY VEHICLE LIGHT DETECTOR TO BE RELOCATED "R"
- CONFIRMATION BEACON TO BE RELOCATED "R"
- TRAFFIC SIGNAL HEAD TO BE RELOCATED "R"
- LUMINAIRE TO BE RELOCATED "R"
- VIDEO VEHICLE DETECTOR TO BE RELOCATED "R"
- PTZ CAMERA TO BE RELOCATED "R"

NOTE:
THE TRAFFIC SIGNAL CONTROLLER EQUIPMENT FOR THIS PROJECT SHALL BE "EAGLE" TO MATCH THE EXISTING ADJACENT SYSTEM.

RESTORATION OF WORK AREA.
RESTORATION OF THE TRAFFIC SIGNAL WORK AREA SHALL BE INCIDENTAL TO THE RELATED PAY ITEM SUCH AS FOUNDATION, CONDUIT, HANDHOLE, TRENCH AND BACKFILL, ETC., AND NO EXTRA COMPENSATION SHALL BE ALLOWED. ALL ROADWAY SURFACES SUCH AS SHOULDER, MEDIAN, SIDEWALKS, PAVEMENT, ETC. SHALL BE REPLACED IN KIND. ALL DAMAGE TO MOWED LAWNS SHALL BE REPLACED WITH AN APPROVED SALT TOLERANT SOD, AND ALL DAMAGE TO UNMOWED FIELDS SHALL BE SEEDED IN ACCORDANCE WITH STANDARD SPECIFICATIONS 252 AND 250 RESPECTIVELY.

	FILE NAME =	USER NAME = CIVILTECH ENGINEERING, INC.	DESIGNED - JSH	REVISED -	KANE COUNTY DIVISION OF TRANSPORTATION	TEMPORARY TRAFFIC SIGNAL MODIFICATION AND REMOVAL PLAN (SHEET 2 OF 2) RANDALL ROAD & MC DONALD ROAD			F.A.P. RTE. 361	SECTION 06-00214-25-BR	COUNTY KANE	TOTAL SHEETS 220	SHEET NO. 100
	PLOT SCALE = 20	CHECKED - BRD	REVISIONS	SCALE: 1"=20'		SHEET NO. 2 OF 23 SHEETS STA. TO STA.			CONTRACT NO. 63076				
	PLOT DATE = 3/24/2009	DATE - 3/30/09	REVISIONS	FED. ROAD DIST. NO. 7 ILLINOIS FED. AID PROJECT									