

PLAN	SURVEYED	DATE
	PLOTTED	BY
	NOTED	
	CAD FILE NAME	

PROFILE	SURVEYED	DATE
	GRADES CHECKED	BY
	STRUCTURE NOTATIONS CHKD	

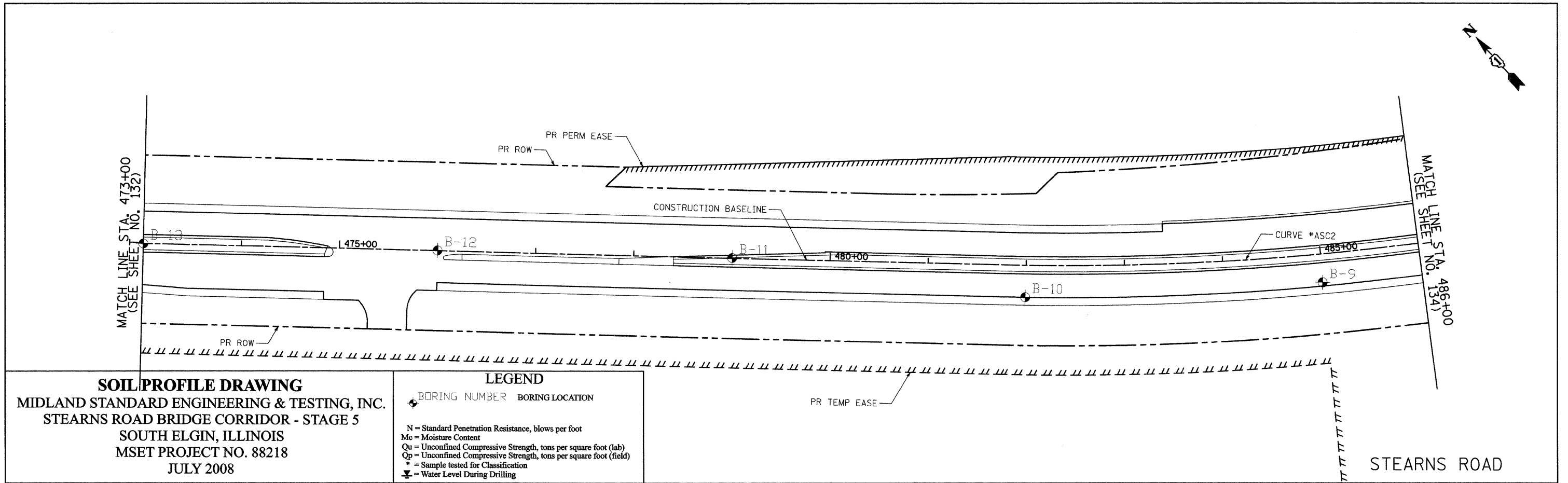

**SOIL PROFILE DRAWING**  
 MIDLAND STANDARD ENGINEERING & TESTING, INC.  
 STEARNS ROAD BRIDGE CORRIDOR - STAGE 5  
 SOUTH ELGIN, ILLINOIS  
 MSET PROJECT NO. 88218  
 JULY 2008

**LEGEND**  
 BORING NUMBER BORING LOCATION  
 N = Standard Penetration Resistance, blows per foot  
 Mc = Moisture Content  
 Qu = Unconfined Compressive Strength, tons per square foot (lab)  
 Qp = Unconfined Compressive Strength, tons per square foot (field)  
 \* = Sample tested for Classification  
 ▽ = Water Level During Drilling

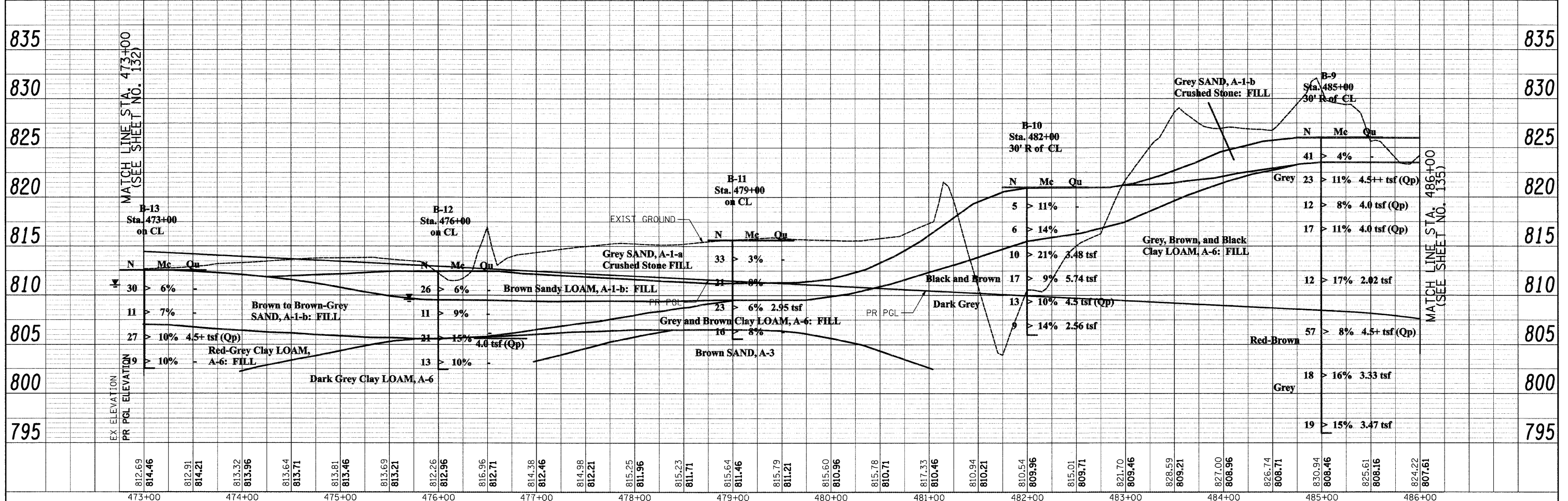

FILE NAME =	USER NAME = jsm	DESIGNED - MSET	REVISED -	<b>KANE COUNTY DIVISION OF TRANSPORTATION</b>	<b>SOIL BORING LOCATION PLAN &amp; SOIL PROFILE</b>		F.A. RTE. 361	SECTION 06-00214-25-BR	COUNTY KANE	TOTAL SHEETS 220	SHEET NO. 133	
	PLOT SCALE = 50.0000' / IN.	CHECKED - MSET	REVISED -		SCALE: 1"=50'	SHEET NO. 4 OF 7 SHEETS	STA. 473+00 TO STA. 486+00	CONTRACT NO. 63076				
	PLOT DATE = 3/27/2009	DATE - 3/30/09	REVISED -		FED. ROAD DIST. NO. 1 ILLINOIS FED. AID PROJECT							