

SOIL PROFILE DRAWING
MIDLAND STANDARD ENGINEERING & TESTING, INC.
STEARNS ROAD BRIDGE CORRIDOR - STAGE 5
SOUTH ELGIN, ILLINOIS
MSET PROJECT NO. 88218
JULY 2008

LEGEND
 ◆ BORING NUMBER BORING LOCATION
 N = Standard Penetration Resistance, blows per foot
 Mc = Moisture Content
 Qu = Unconfined Compressive Strength, tons per square foot (lab)
 Qp = Unconfined Compressive Strength, tons per square foot (field)
 * = Sample tested for Classification
 ▽ = Water Level During Drilling

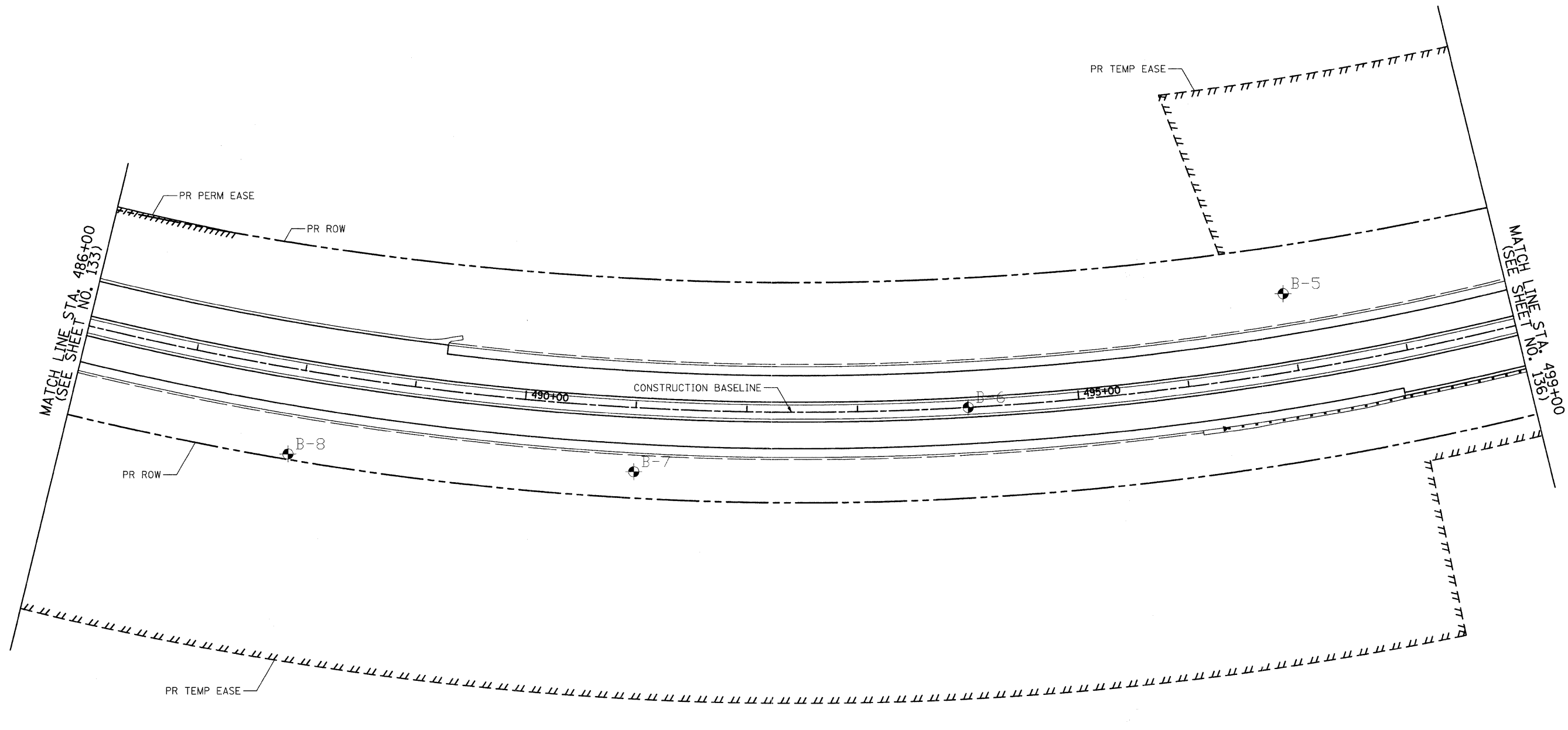

STEARNS ROAD

FILE NAME =	USER NAME = jsm	DESIGNED - MSET	REVISED -	KANE COUNTY DIVISION OF TRANSPORTATION	SOIL BORING LOCATION PLAN & SOIL PROFILE		F.A. RTE. 361	SECTION 06-00214-25-BR	COUNTY KANE	TOTAL SHEETS 220	SHEET NO. 134
		DRAWN - MSET	REVISED -				CONTRACT NO. 63076				
	PLOT SCALE = 58.0000' / IN.	CHECKED - MSET	REVISED -		SCALE: 1"=50'	SHEET NO. 5 OF 7 SHEETS	STA. 486+00	TO STA. 499+00	FED. ROAD DIST. NO. 1 ILLINOIS FED. AID PROJECT		
	PLOT DATE = 3/27/2009	DATE - 3/30/09	REVISED -								