

DATE \_\_\_\_\_  
 BY \_\_\_\_\_  
 SURVEYED \_\_\_\_\_  
 PLOTTED \_\_\_\_\_  
 TEMPLATE \_\_\_\_\_  
 NOTE BOOK \_\_\_\_\_  
 NO. \_\_\_\_\_  
 AREAS CHECKED \_\_\_\_\_

DATE \_\_\_\_\_  
 BY \_\_\_\_\_  
 SURVEYED \_\_\_\_\_  
 PLOTTED \_\_\_\_\_  
 TEMPLATE \_\_\_\_\_  
 NOTE BOOK \_\_\_\_\_  
 NO. \_\_\_\_\_  
 AREAS CHECKED \_\_\_\_\_

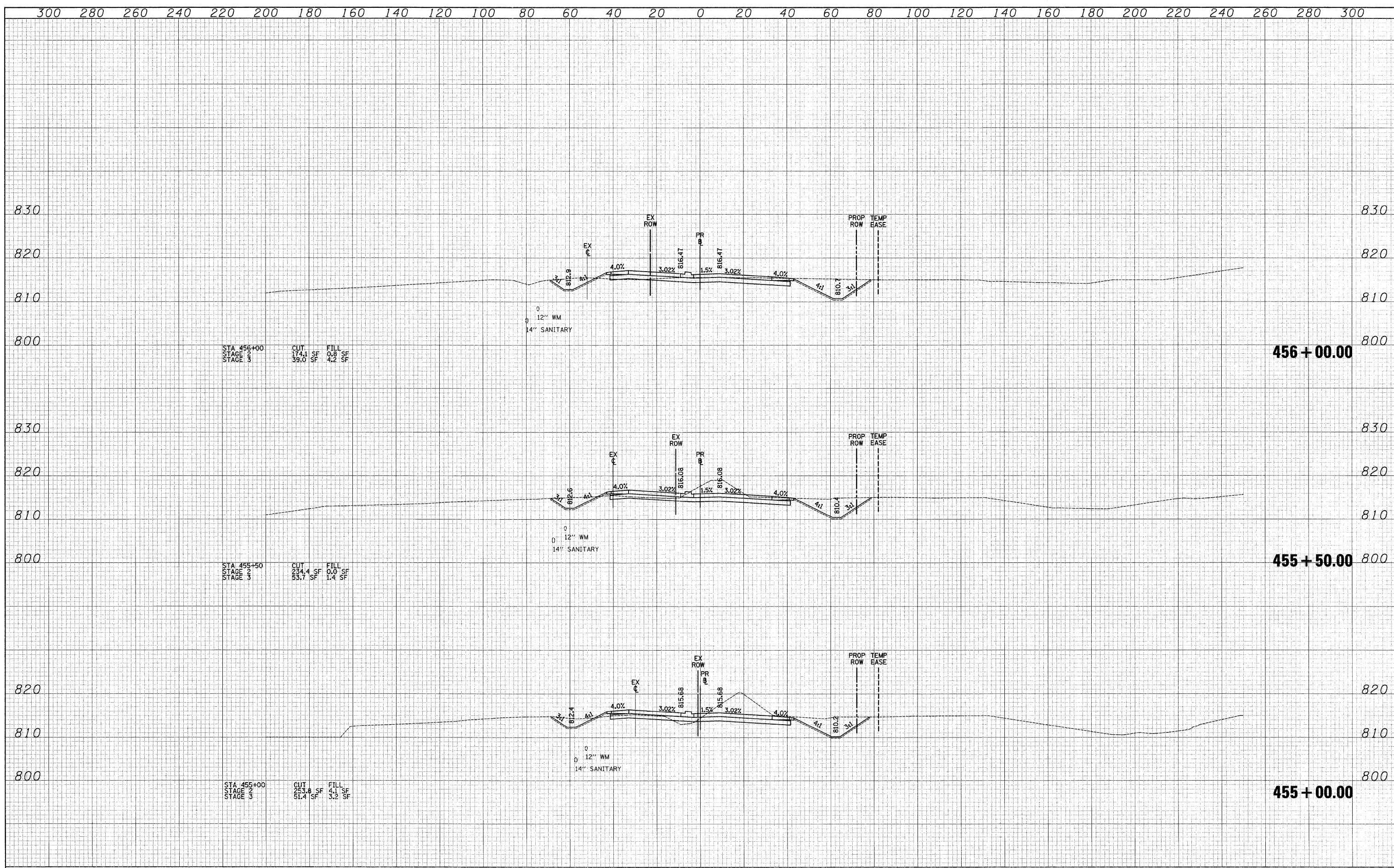

FILE NAME =	USER NAME = ead	DESIGNED - JSM	REVISED -	<b>KANE COUNTY          DEPARTMENT OF TRANSPORTATION</b>	<b>CROSS SECTIONS - STEARNS ROAD</b>		FILE RTE. 361	SECTION 06-00214-25-BR	COUNTY KANE	TOTAL SHEETS 220	SHEET NO. 161	
	PLOT SCALE = 20.0000' / IN.	CHECKED - DNM	REVISED -		SCALE: 1"=10'V/20'H	SHEET NO. 16 OF 63 SHEETS	STA. 455+00.00 TO STA. 456+00.00	CONTRACT NO. 63076				
	PLOT DATE = 3/27/2009	DATE - 3/30/09	REVISED -		FED. ROAD DIST. NO. 1   ILLINOIS   FED. AID PROJECT							