

DATE	
BY	
SURVEYED	
PLOTTED	
TEMPLATE	
NOTE BOOK	
AREAS CHECKED	
NO.	

DATE	
BY	
SURVEYED	
PLOTTED	
TEMPLATE	
NOTE BOOK	
AREAS CHECKED	
NO.	

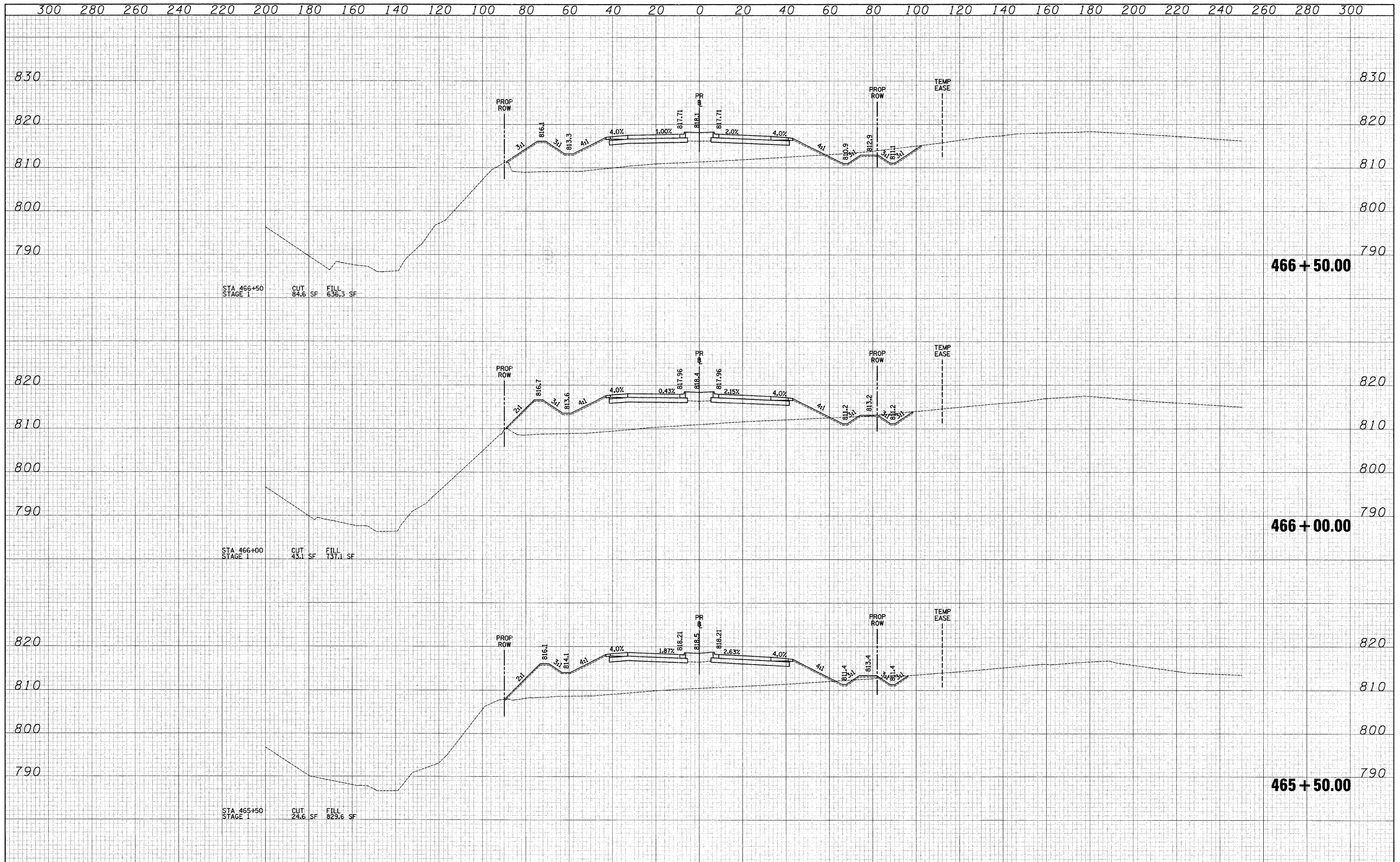

FILE NAME =	USER NAME = eod	DESIGNED - JSM	REVISED -	KANE COUNTY DEPARTMENT OF TRANSPORTATION	CROSS SECTIONS - STEARNS ROAD	F.A. RTE. 361	SECTION 06-00214-25-BR	COUNTY KANE	TOTAL SHEETS 220	SHEET NO. 168	
	PLLOT SCALE = 20.0000' / IN.	DRAWN - JSM	REVISED -			SCALE: 1"=10'V/20'H SHEET NO. 23 OF 63 SHEETS	STA. 465+50.00 TO STA. 466+50.00	CONTRACT NO. 63076		FED. ROAD DIST. NO. 1 ILLINOIS FED. AID PROJECT	
	PLLOT DATE = 3/27/2009	CHECKED - DNM	REVISED -								
		DATE - 3/30/09	REVISED -								

