

DATE	
BY	
SURVEYED	
PLOTTED	
TEMPLATE	
NOTE BOOK	
AREAS CHECKED	
NO.	

DATE	
BY	
SURVEYED	
PLOTTED	
TEMPLATE	
NOTE BOOK	
AREAS CHECKED	
NO.	

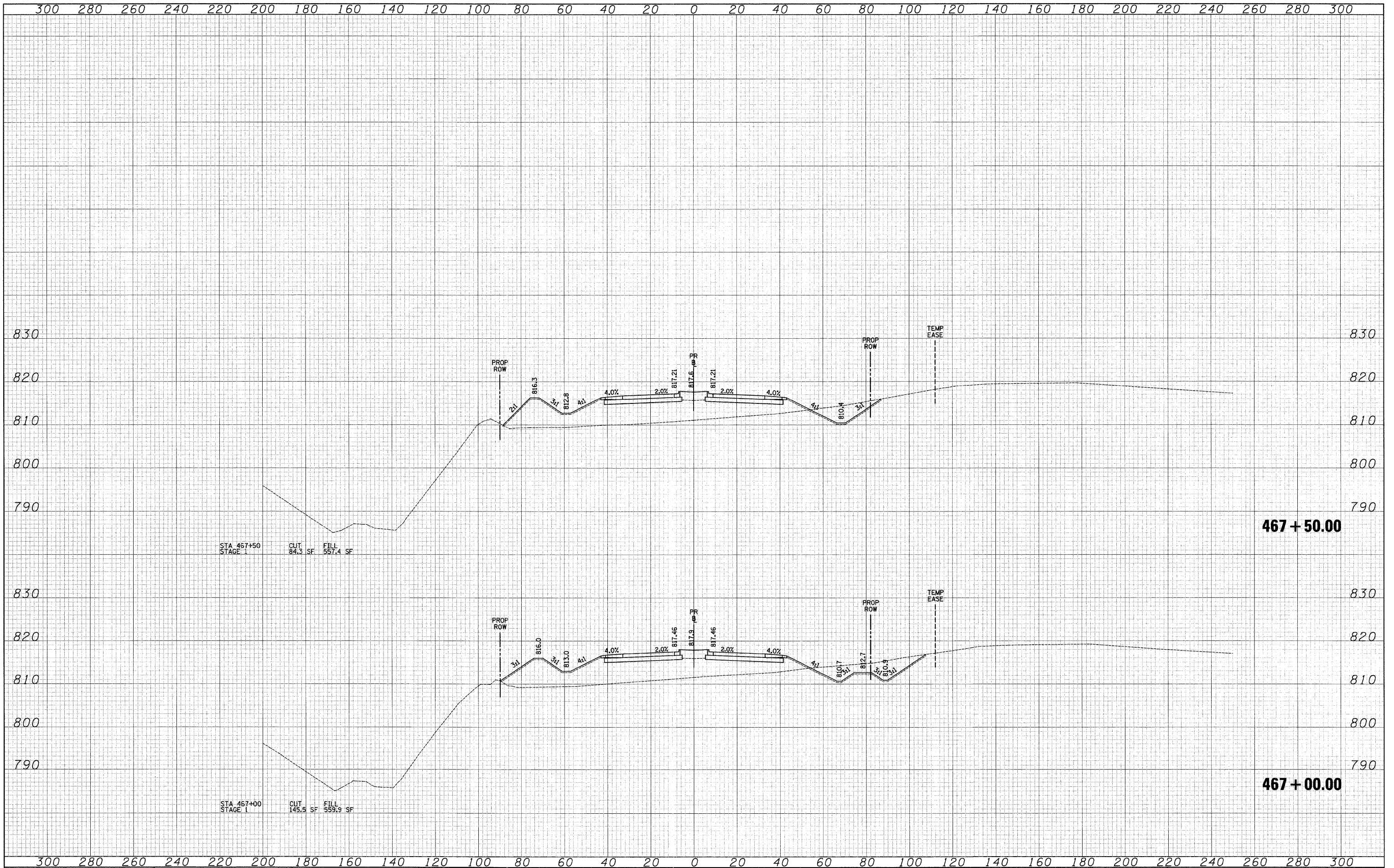

STA 467+50
STAGE 1
CUT 84.3 SF
FILL 557.4 SF

467 + 50.00

STA 467+00
STAGE 1
CUT 145.5 SF
FILL 559.9 SF

467 + 00.00

FILE NAME =
CIVILTECH

USER NAME = ead
DESIGNED - JSM
DRAWN - JSM
CHECKED - DNM
DATE - 3/30/09

REVISED -
REVISED -
REVISED -
REVISED -

**KANE COUNTY
DEPARTMENT OF TRANSPORTATION**

CROSS SECTIONS - STEARNS ROAD
SCALE: 1"=10'V/20'H SHEET NO. 24 OF 63 SHEETS
STA. 467+00.00 TO STA. 467+50.00

F.A. RTE.	SECTION	COUNTY	TOTAL SHEETS	SHEET NO.
361	06-00214-25-BR	KANE	220	169
CONTRACT NO. 63076				
FED. ROAD DIST. NO. 1 ILLINOIS FED. AID PROJECT				